

SEAL:

**THIS DOCUMENT IS NOT
FOR REGULATORY
APPROVAL, PERMITTING,
OR CONSTRUCTION.**

FOR BIDDING ONLY

09/03/2020

NO. DATE REMARKS
REVISIONS



**7-ELEVEN
STORE #41559**

1245 S. VOLUSIA AVENUE
Orlando City, FL 32763

PROJECT NO: 2019.0743
DATE: APRIL 7, 2020

A0.2
LIFE SAFETY PLAN

CHECKED: RW DRAWN: JM

GENERAL NOTES

- A. FIRE EXTINGUISHER: 10# ABC WITH UL RATING 4A-60BC. SURFACE MOUNTED ON WALL WITH MANUFACTURER'S ALL STEEL WALL BRACKET. J.L. INDUSTRIES INC. (COSMIC 10E) OR APPROVED EQUAL WITH INSPECTION TAG AS REQUIRED BY LOCAL CODES.
- B. SIGNS STATING THE MAXIMUM OCCUPANT CONTENT SHALL BE CONSPICUOUSLY POSTED IN EACH AREA OF ASSEMBLY, ASSEMBLY ROOM, OR ROOM USED FOR SIMILAR PURPOSE.
- C. MAXIMUM EFFORT TO OPERATE DOORS SHALL NOT EXCEED: 5.0 L.B.F. FOR INTERIOR DOORS.
- D. ALL DOORS SHALL BE KEYLESS IN DIRECTION OF EGRESS.

KEY NOTES

- 1. PROVIDE LEVEL LANDINGS EACH SET OF DOORS PER FBC 1008.1. PROVIDE A MAXIMUM THRESHOLD HEIGHT OF 1/2" WITH BEVELED EDGE PER FBC-ACCESSIBILITY, 303.3.
 - 1.1 - LANDING AREA TO BE 54" WIDE X 60" DEEP. 18" CLEAR AT PULL SIDE OF DOOR, 18" CLEAR AT PUSH SIDE.
 - 1.2 - LANDING AREA TO BE 72" WIDE X 48" DEEP. 12" CLEAR AT PUSH SIDE OF DOOR, 18" CLEAR AT PULL SIDE.
 - 1.3 - LANDING AREA TO BE 72" WIDE X 60" DEEP. 12" CLEAR AT PUSH SIDE OF DOOR, 18" CLEAR AT PULL SIDE.
- ALTERNATE LOCKED EMERGENCY SHUT-OFF FOR FUEL (SEE ELECT. DWGS.)

LEGEND

- EXISTING EXIT SIGN
- EXISTING FIRE EXTINGUISHER
- EXISTING EMERGENCY LIGHT
- 36" EGRESS PATH (MIN.)
- 44" EGRESS PATH (MIN.)

OCCUPANCY LOAD

OCCUPANT LOAD ANALYSIS (2017 FL. FIRE PREVENTION CODE 6TH ED. NFPA 101)

| | |
|----------------------------|--------------------|
| MERCHANDISE | 1689/30 = 57 |
| SALES | 275/100 = 3 |
| OFFICE | 62/100 = 1 |
| WORK ROOM | 300/300 = 1 |
| COOLER VAULT | 440/300 = 2 |
| BEER CAVE | 170/300 = 1 |
| TOTAL OCCUPANT LOAD | = 65 PEOPLE |

MINIMUM NUMBER OF EXITS: 2 REQUIRED AND X PROVIDED.
 EGRESS WIDTH REQUIRED = .2 X OCCUPANT LOAD
 = .2 X 65 = 13 INCHES
 EGRESS WIDTH PROVIDED = 102 INCHES
 MAXIMUM TRAVEL DISTANCE TO AN EXIT:
 DOES NOT EXCEED 200' (UNSPRINKLED CRITERIA)
 FIRE EXTINGUISHERS: PROVIDE (2) 4A,60-BC F.E., BRACKET MOUNTED-
 VERIFY LOCATIONS W/ LOCAL FIRE INSPECTOR.

ROOF LOADS

TRAVEL DISTANCE

| | |
|--|--|
| | DIAGONAL BUILDING DISTANCE & DISTANCE BETWEEN EXITS. |
| | TRAVEL PATH "A" = 79'-5" |
| | TRAVEL PATH "B" = 63'-10" |
| | TRAVEL PATH "C" = 54'-2" |
| | TRAVEL PATH "D" = 69'-6" |
| | TRAVEL PATH "E" = 75'-4" |
| | TRAVEL PATH "G" = 36'-7" |

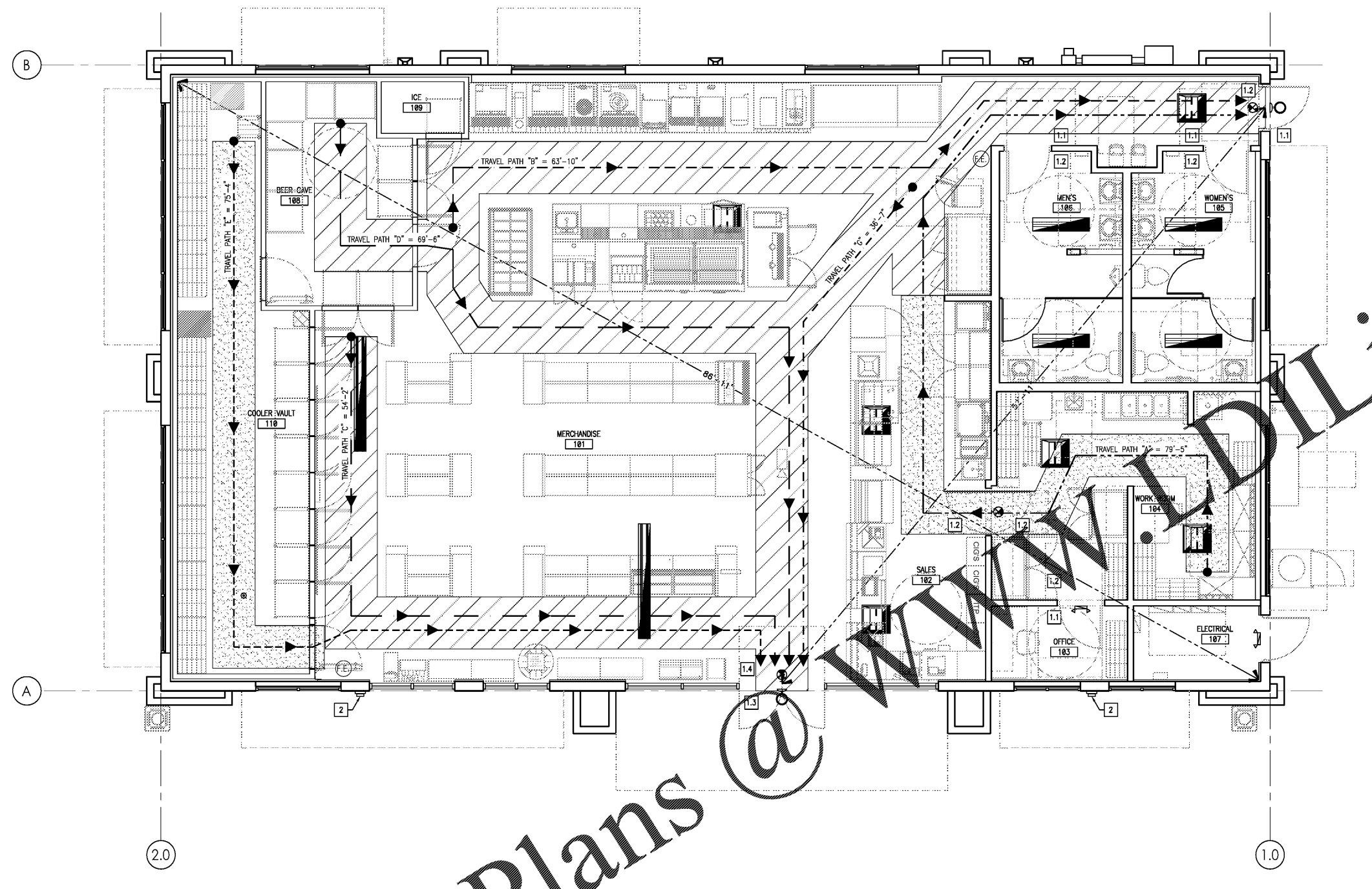

LIFE SAFETY PLAN

1/4" = 1'-0"

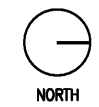

Order Plans @

Watermark DiLine