



Architecture Planning Interiors Research
50 South B.B. King Boulevard
Memphis, Tennessee 38103
Telephone 901.521.1440
Fax 901.525.2760
E-mail info@lrk.com

Client:
McCormack Baron Salazar

720 Olive St Suite 2500
St. Louis, MO 63101

Issues and Revisions

Date	Issued / Revised
3/16/2020	50% CONSTRUCTION DOCS
5/18/2020	80% CONSTRUCTION DOCS
7/13/2020	PERMIT SUBMISSION

BUILDING ADDRESSES

TYPE G-2	442, 444, 446, 448 RATLIFF LANE 324, 236, 238, 330 SHAWNEE PLACE
TYPE A-4	378, 448 VANCE AVE 316, 304 FOOT LANE 388 S DANNY THOMAS BLVD
TYPE A-5	368, 481 VANCE AVE 378 SHAWNEE PLACE
TYPE A-6	321 SHAWNEE PLACE 450, 380 FOOT LANE 345 S DANNY THOMAS BLVD
TYPE A-7	402, 406 FOOT LANE

©2020 LRK, Inc.
Drawings, written material, and design concepts shall not be used or reproduced in whole or part in any form or format without prior written consent of LRK, Inc. Do not scale drawings. Use given dimensions only. If not shown, verify correct dimensions with the Architect. Contractor shall check and verify all dimensions and conditions of job site.

Seal



LRK Project Number: 01.15100.03

Project Name:
South City CNI Phase 4
Memphis TN

Drawing Name:
GROUND FLOOR PLAN

Drawn By: ADB
Checked By: HJU

MA-A101

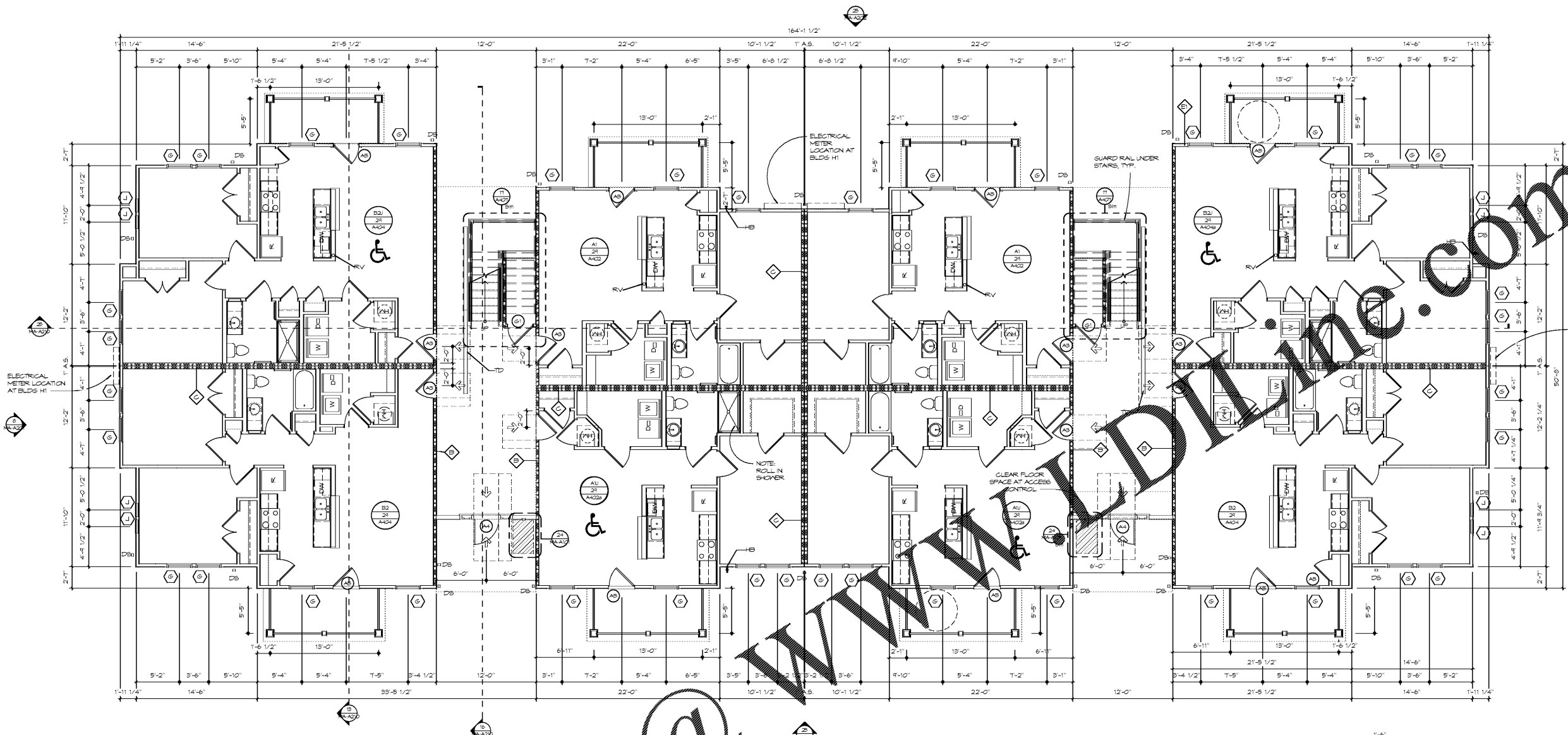

19 MA GROUND FLOOR
SCALE 3/16" = 1'-0"

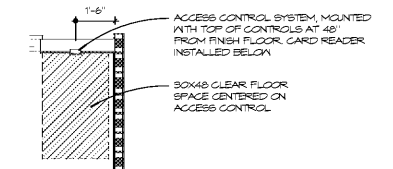

24 MA - AIPHONE
SCALE 3/8" = 1'-0"

- PLAN NOTES:
- ALL DIMENSIONS ON PLANS ARE TO OUTSIDE FACE OF STUD UNLESS NOTED OTHERWISE. STUDS NOT DIMENSIONED ARE 2X4 WOOD STUDS TYPICAL UNLESS NOTED OTHERWISE.
 - ALL WORK AND CONSTRUCTION SHALL MEET OR EXCEED ALL APPLICABLE CODES.
 - ALL DIMENSIONS ARE BASED ON 5/8" GYPSUM BOARD AT ALL INTERIOR BEARINGS AND NON-BEARING PARTITIONS.
 - REFER TO FINISH SCHEDULE FOR CLOSET, PANTRY, AND LINEN SHELVING REQUIREMENTS.
 - VERIFY EXACT DIMENSIONS REQUIRED TO INSTALL HVAC AND WATER HEATING EQUIPMENT WITH MANUFACTURER BEFORE BUILDING ENCLOSURE WALLS AND FLOOR DONE.
 - VERIFY FRAMING OPENING DIMENSIONS SHOWN FOR TUBS AND SHOWERS WITH ACTUAL TUB AND SHOWER SUPPLIED. ADJUST AS REQUIRED.
 - NON-PAPER FACED GYPSUM BOARD TO BE INSTALLED AT WALLS AND CEILINGS OF FULL BATHS.
 - WATER-RESISTANT GYPSUM BOARD TO BE INSTALLED AT KITCHEN SINKS, HALF-BATH WET WALLS, AND LAUNDRY WET WALLS.
 - ALL INTERIOR UNIT WALLS AND CEILINGS ARE PAINTED 5/8" GYP. BOARD UNLESS NOTED OTHERWISE.
 - ALL INTERIOR UNIT WALLS TO HAVE PAINTED WOOD BASE TRIM INCLUDING MECHANICAL UTILITY AND COAT CLOSETS UNLESS NOTED OTHERWISE. SEE FINISH SCHEDULE FOR LOCATION OF QUARTER ROUND TRIM.
 - REFER TO REFLECTED CEILING PLANS FOR TYPICAL CEILING HEIGHT AND SOFFIT LOCATIONS.
 - REFER TO PROJECT DATA SHEET FOR PROJECT SQUARE FOOTAGE INFORMATION.
 - REFER TO CODE SUMMARY AND PARTITION TYPES FOR INSULATION REQUIREMENTS AT EXTERIOR WALLS. ALL EXTERIOR WALLS ARE TYPE B1 UNLESS OTHERWISE NOTED.
 - PROVIDE FINISH PANELS AT ALL EXPOSED END CONDITIONS OF CABINETS.
 - INSULATE ALL PLUMBING RISERS IN WALL WITH BATT INSULATION.
 - FIRE EXTINGUISHERS TO BE MOUNTED ON BRACKET IN KITCHEN SINK CABINETS, TYP.
 - INSTALL WASHER AND DRYER AND FIXTURE CONNECTIONS SO THAT WASHER IS ALWAYS LOCATED ON THE LEFT-HAND SIDE AND DRYER IS ALWAYS LOCATED ON THE RIGHT OF THE CLOSET WHEN FACING APPLIANCES.
 - PROVIDE EMERGENCY DRAIN PAN UNDER WASHERS IN SECOND FLOOR LAUNDRY ROOMS.

NOTE: SEE ARCH AND STRUCTURAL FOUNDATION DETAILS FOR ADDITIONAL RADON LOOP DETAILS. RISERS TO BE ROUTED TO LOCATIONS SHOWN ON FLOOR PLANS. ABOVE TRUSS BEARINGS, ROUTE RISERS TO REAR ROOF BELONG RIDGE AND FREELOCK PIPES THAT MUST PENETRATE DRAFTSTOPPING PARTITIONS.

- EXTERIOR:
- DOWNPOUTS: AT ALL LOCATIONS, PROVIDE CORRUGATED PVC EXTENSIONS ROUTED TO EDGE OF PLANTING BEDS TO DIRECT STORM WATER TO SITE STORM SYSTEM.
 - SLOPE SLAB ON GRADE TO TRENCH DRAIN IN BREAKDOWN AND TIE INTO SITE STORM SYSTEM, RE: PLUMBING AND CIVIL.

Order Plans @

25 MA RADON PLAN
SCALE 1/8" = 1'-0"

