



Architecture Planning Interiors Research
50 South B.B. King Boulevard
Memphis, Tennessee 38103
Telephone 901 521 1440
Fax 901 525 2760
E-mail info@lrk.com

Client:
McCormack Baron Salazar

720 Olive St Suite 2500
St. Louis, MO 63101

Issues and Revisions

Date	Issue / Revised
3/16/2020	50% C.D.
5/15/2020	80% C.D.
7/13/2020	Permit Submission

BUILDING ADDRESSES

- TYPE G.E. 442, 444, 446, 448 BATLIF LANE
- TYPE H.A. 324, 226, 228, 330 ISHMAEL PLACE
- TYPE I.A. 373, 440 VANCE AVE
- TYPE I.C. 315, 364 FOOTE LANE
- TYPE I.C. 333 S DANNY THOMAS BLVD
- TYPE L.A. 365, 431 VANCE AVE
- TYPE L.A. 313 ISHMAEL PLACE
- TYPE L.A. 327 ISHMAEL PLACE
- TYPE M.A. 420, 525 FOOTE LANE
- TYPE M.A. 340 S DANNY THOMAS BLVD
- TYPE M.A. 402, 426 FOOTE LANE

©2020 LRK Inc.
Drawings, written material, and design concepts shall not be used or reproduced in whole or part in any form or format without prior written consent of LRK Inc. Do not scale drawings. Use given dimensions only. If not shown, verify correct dimensions with the Architect. Contractor shall check and verify all dimensions and conditions at job site.

Seal



LRK Project Number: 01.15100.03

Project Name:
South City CNI Phase 4
Memphis, TN

Drawing Name:
FOUNDATION PLAN

Drawn By: MAC
Checked By: KEM

LA-S101

Order Plans @ www.alldilaine.com

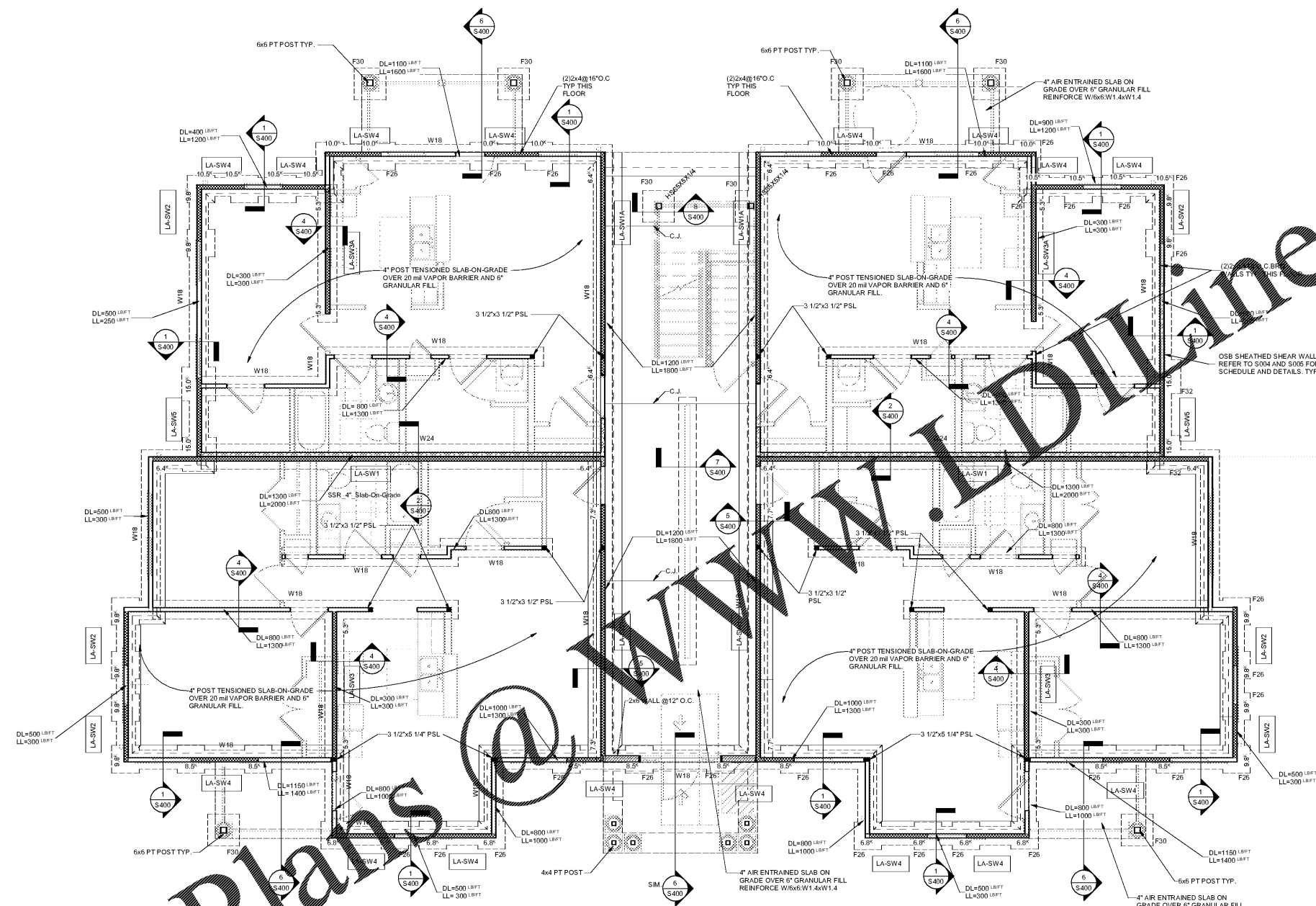

FOUNDATION PLAN - LA
1/4" = 1'-0"

1. WALLS THIS FLOOR, INTERIOR AND EXTERIOR, SHALL BE (2)2x4'S @ 16" O.C.
2. EXTERIOR TOP OF FOOTING SHALL BE 1'-0" BELOW FINISHED FLOOR TYP.
3. WALL FOOTING INDICATE STRIP AND SPREAD FOOTINGS RESPECTIVELY SEE FOUNDATION SCHEDULE ON S002 FOR SIZE AND REINFORCING.
4. REFER TO WINDOW SCHEDULE #5003 FOR OPENING AND FRAMING DETAILS FOR ALL DOORS AND WINDOWS.
5. SW# INDICATES SHEAR WALLS SEE SHEETS S004, S005, AND S006 FOR SHEAR WALL SCHEDULE AND CONSTRUCTION DETAILS.

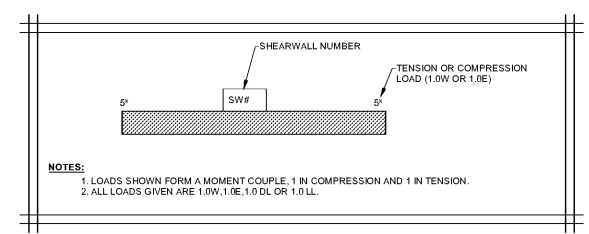

SHEARWALL LOADING KEY

- NOTES:
1. LOADS SHOWN FORM A MOMENT COUPLE, 1 IN COMPRESSION AND 1 IN TENSION.
 2. ALL LOADS GIVEN ARE 1.0W, 1.0E, 1.0 DL OR 1.0 LL.