



Architecture Planning Interiors Research  
50 South B.B. King Boulevard  
Memphis, Tennessee 38103  
Telephone 901.521.1440  
Fax 901.525.2760  
E-mail info@lrk.com

Client:  
**McCormack Baron Salazar**

720 Olive St Suite 2500  
St. Louis, MO 63101

Issues and Revisions

| Date      | Issued / Revised      |
|-----------|-----------------------|
| 3/16/2020 | 50% CONSTRUCTION DOCS |
| 5/18/2020 | 80% CONSTRUCTION DOCS |
| 7/13/2020 | PERMIT SUBMISSION     |

BUILDING ADDRESSES

|          |   |
|----------|---|
| TYPE G-2 | 442, 444, 446, 448 RATLIFF LANE<br>324, 236, 238, 330 SHAWNEE PLACE |
| TYPE L-A | 378, 448 VANCE AVE<br>316, 304 FOOT LANE<br>388 S DANNY THOMAS BLVD |
| TYPE L-C | 368, 481 VANCE AVE<br>378 SHAWNEE PLACE                             |
| TYPE L-A | 321 SHAWNEE PLACE<br>400, 300 FOOT LANE<br>315 S DANNY THOMAS BLVD  |
| TYPE L-A | 402, 406 FOOT LANE  |

©2020 LRK Inc.  
Drawings, written material, and design concepts shall not be used or reproduced in whole or part in any form or format without prior written consent of LRK Inc. Do not scale drawings. Use given dimensions only. If not shown, verify correct dimensions with the Architect. Contractor shall check and verify all dimensions and conditions of job site.

Seal



LRK Project Number: 01.15100.43

Project Name:  
**South City CNI Phase 4**  
Memphis TN

Drawing Name:  
**ROOF PLAN**

Drawn By: ADB  
Checked By: HJU

**LA-A104**

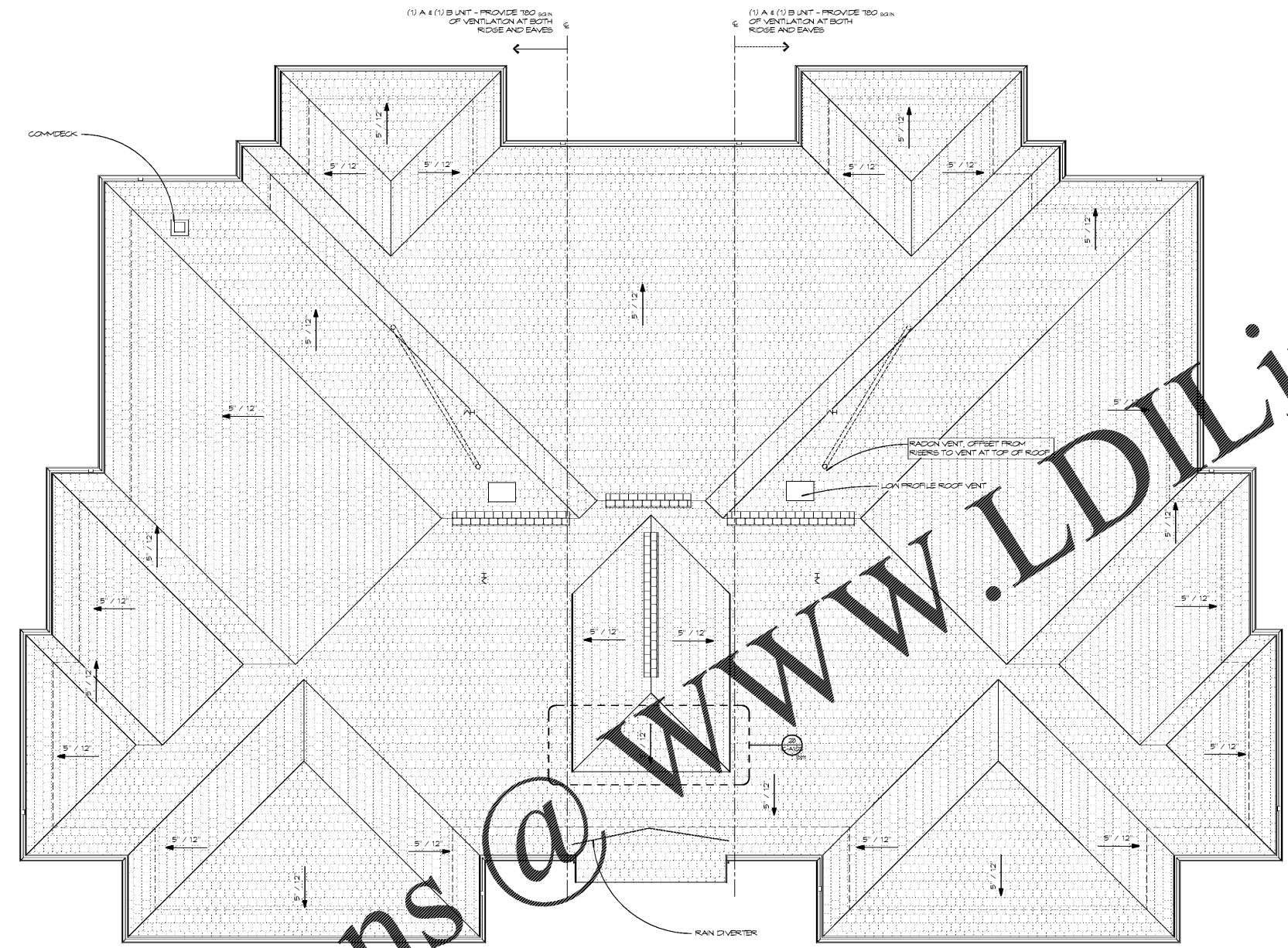

19 LA ROOF PLAN  
SCALE 1/4" = 1'-0"

Order Plans @

WWW.LRKLINELINE.COM

**ROOF NOTES**

- PROVIDE VENTILATION IN ROOF SHEATHING AT NOTED LOCATIONS PER RIDGE VENT DETAIL. WHERE RIDGE VENT IS INTERRUPTED BY FIRE RATED ROOF SHEATHING AT TORNHOUSES, INSTALL CONTINUOUS RIDGE VENT BUT DO NOT CUT ROOF DECK. AT RIDGE, VENT SHOULD APPEAR CONTINUOUS. SHINGLES TO BE INSTALLED WITH PROVEN VALLEYS AND SELF-ADHERING ICE DAM EXTENDING 15" UP EACH SIDE OF VALLEY.
- REFER TO VENT DRAWINGS FOR LOCATION OF ROOF PENETRATIONS.
- ALL ROOF VENTS TO OCCUR ON NON-STREET FACING ROOF SLOPES, AND MUST BE BLACK ABS WITH BLACK NEOPRENE FLASHING BOOT.
- EXTERIOR WALL SHEATHING TO EXTEND TO UNDERSIDE OF ROOF DECK. PROVIDE OPENINGS TO ALLOW FOR ATTIC VENTILATION. SEE BELOW.
- PROVIDE ROOF-OUT FLASHING AT ALL WALL TO EAVE CONDITIONS. SEE ROOF DETAIL FOR FLASHING CHAIRMAN.
- SOFFITS TO BE VENTILATED DEADEND VINYL AT ALL ROOF SOFFITS AND PORCH CEILINGS. SEE DETAILS AND SPEC'S.
- DORMER WINDOWS DESIGNED TO ALLOW AIR TO FLOW FROM ATTIC OUT THROUGH THE DORMER RIDGE VENT. DO NOT CONSTRUCT AS 'OVERBUILD' ON ROOF SHEATHING. SEE ELEVATIONS FOR DORMER WINDOW TYPES AND LOCATIONS.
- THE END OF ANY RADON VENT STACK PIPE SHALL BE 10 FT OR MORE AWAY FROM ANY WINDOW, DOOR, OR OTHER OPENING INTO CONDITIONED OR OTHERWISE OCCUPYABLE SPACE.

PER IBC 1209 AND IRC 506:  
ENCLOSED ATTICS SHALL HAVE VENTILATION FOR EACH SEPARATE SPACE BY OPENINGS PROTECTED AGAINST ENTRANCE OF RAIN AND SNOW. NET AREA SHALL BE NOT LESS THAN 1/150TH OF AREA OF SPACE VENTILATED.

CONTRACTOR TO VERIFY NET FREE AREA OF RIDGE VENT PROVIDES SPECIFIED VENTILATION AREA. BELOW, WHERE MULTIPLE UNITS ARE ENCLOSED IN A SINGLE ATTIC SPACE, ADD REQUIRED VENTILATION AREAS TOGETHER. WHERE LINEAR LENGTH OF RIDGE DOES NOT PROVIDE ADEQUATE VENTILATION AREA, PROVIDE LOW-PROFILE ROOF VENTS WITHIN 3' BELOW THE RIDGE OR HIGHEST POINT OF ROOF. ALL VENTS TO BE LOCATED ON REAR/NON-STREET FACING SIDE OF ROOF.

| UNIT BASE | MAX AREA | 1/150  | 1/150             | RIDGE VENT (SOFFIT) VENTILATION AREA (PROVIDE AT BOTH LOCATIONS) |
|-----------|----------|--------|-------------------|--|
| A         | 109 SF   | 4.1 SF | 2.38 SF/331 SQ IN |  |
| B         | 471 SF   | 6.1 SF | 3.06 SF/441 SQ IN |  |
| C1        | 286 SF   | 3.9 SF | 4.22 SF/597 SQ IN |  |
| C2        | 680 SF   | 4.2 SF | 2.10 SF/309 SQ IN |  |
| D1        | 286 SF   | 5.1 SF | 2.38 SF/331 SQ IN |  |