

Order Plans @ WWW.DILine.com

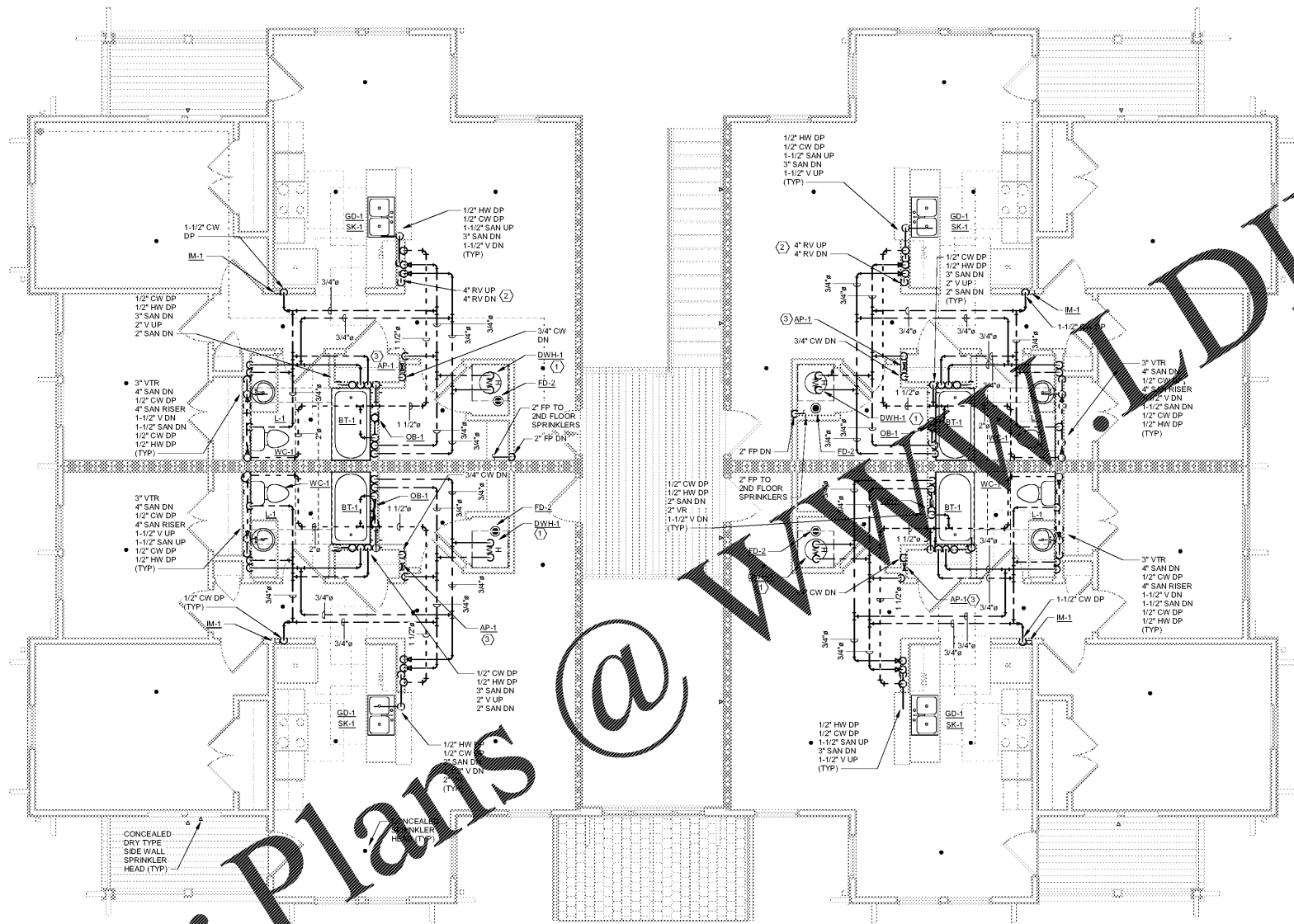

1 PLUMBING SECOND FLOOR PLAN - BUILDING H-A
1/4" = 1'-0"

GENERAL NOTES:

A. FLOOR DRAINS IN MECHANICAL CLOSETS SHALL NOT BE LOCATED UNDER WATER HEATER DRAN PANS OR UNDER AIR HANDLING UNITS. FLOOR DRAINS SHALL BE LOCATED IN AN EASILY ACCESSIBLE LOCATION BETWEEN AIR HANDLER AND WATER HEATER. OVERFLOW DRAIN FROM WATER HEATER SHALL BE PIPED TO FLOOR DRAIN. WATER HEATER DRAIN PIPE AND CONDENSATE DRAIN PIPE SHALL BE SECURED TO FLOOR DRAIN STRAINER WITH ZIP-TIES. CONDENSATE AND OVERFLOW PIPING SHALL BE RUN SO THAT IT IS OUT OF THE PATH OF TRAVEL.

KEY NOTES:

- 1 PROVIDE 3/4" CW & 3/4" HW TO DWH-1. SEE DETAIL 6 ON SHEET P103 FOR TYPICAL DOMESTIC WATER HEATER PIPING ARRANGEMENT.
2 ROUTE RADON VENT PIPING UP TO ATTIC SPACE AND CAP FOR FUTURE CONNECTION OF EXHAUST FAN AND EXTENSION UP TO ROOF.
3 (2) 3/4" CW DP TO AP-1.



Architecture Planning Interiors Research
50 South B.B. King Boulevard
Memphis, Tennessee 38103
Telephone 901 521 1440
Fax 901 525 2760
E-mail info@lrk.com

Client:
McCormack Baron Salazar

720 Olive St, Suite 2500
St. Louis, MO 63101

Issues and Revisions

Table with 3 columns: Date, Issued / Revised, and Description. Row 1: 03/16/2020, 50% CONSTRUCTION DOCUMENTS. Row 2: 05/18/2020, 80% CONSTRUCTION DOCUMENTS. Row 3: 07/13/2020, PERMIT.

Table with 2 columns: TYPE and ADDRESS. Lists various building addresses such as 442, 444, 446, 448 BATHURF LANE and 324, 226, 228, 230 SHWAMEL PLACE.

©2020 LRK Inc. Drawings, written material, and design concepts shall not be used or reproduced in whole or part in any form or format without prior written consent of LRK Inc. Do not scale drawings. Use given dimensions only. If not shown, verify correct dimensions with the Architect. Contractor shall check and verify all dimensions and conditions at job.

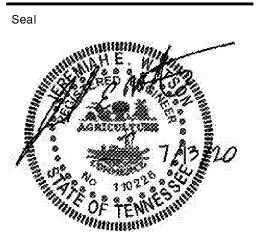

LRK Project Number: 01.15100.02

Project Name: South City CNI Phase 4 Memphis TN

Drawing Name: PLUMBING BUILDING H-A SECOND FLOOR PLAN

Drawn By: EDM
Checked By: JEW

HA-P203