

DRAWING NOTES

- A. PLEASE REFER TO SHEET E001 FOR PROJECT NOTES, LEGEND, AND ABBREVIATIONS.
- B. FINAL PUBLIC STREET LIGHT LOCATIONS SHALL BE DESIGNED BY MLGW. PLACEMENT SHOWN ON DRAWINGS ARE SUGGESTED LOCATIONS USED FOR SITE PHOTOMETRIC CALCULATIONS.
- C. PARKING LOT LIGHTING IS INCLUDED IN THE CONTRACTOR'S SCOPE OF WORK.
- D. PROVIDE ENGRAVED NAME PLATES ON ALL METERS IDENTIFYING THE APARTMENT ADDRESS.
- E. SEE CIVIL DRAWINGS FOR ELECTRICAL SERVICE FEEDERS FROM UTILITY POLES TO TRANSFORMERS AND FROM TRANSFORMERS TO METERS.
- F. EC TO PROVIDE UNDERGROUND FEED FROM ELECTRIC METER TO INDIVIDUAL UNIT PANELS. SEE INDIVIDUAL BUILDING TYPE PLANS FOR PANEL LOCATIONS.
- G. SITE LIGHTS ON EACH BUILDING SHALL BE TIED TO THE HOUSE METER ON THAT BUILDING. POLE LIGHTS IN EACH BLOCK SHALL BE SPLIT BETWEEN TWO CIRCUITS ON SEPARATE HOUSE METERS.

KEY NOTES

- 1 PROPOSED LOCATION OF MLGW TRANSFORMER (TYPICAL). CONTRACTOR SHALL COORDINATE EXACT LOCATION WITH MLGW. UTILITY TRANSFORMERS SHALL BE PROVIDED BY MLGW. SEE CIVIL DRAWINGS FOR FINAL TRANSFORMER LOCATIONS AND PRIMARY AND SECONDARY ROUTING.
- 2 PEDESTRIAN GATE LOCATION. PROVIDE POWER AND DATA FOR ACCESS CONTROL AND FUTURE SECURITY CAMERA(S).
- 3 PROVIDE POWER FOR OPENER AND POWER AND DATA FOR DRIVE GATE ACCESS CONTROL AND FUTURE SECURITY CAMERA(S).
- 4 PROVIDE DUPLEX WEATHER PROOF GFCI OUTLET STUBBED UP ABOVE CONCRETE PAD TO SERVICE MAIL KIOSKS. RUN POWER FROM CLOSEST HOUSE PANEL. PROVIDE 3/4" CONDUIT FROM SPRINKLER CLOSEST TO MAIL KIOSK FOR DATA.
- 5 STREET LIGHTS SHALL BE DESIGNED AND INSTALLED BY MLGW. LIGHT LOCATIONS ARE SHOWN FOR COORDINATION AND PHOTOMETRIC CALCULATIONS ONLY.
- 6 PARKING AND AREA LIGHTS. PROVIDE 2" CONDUIT FOR ALL UNDERGROUND FEEDS FOR THE LIGHTING. EACH CIRCUIT SHALL BE FED FROM NEAREST HOUSE PANEL.



Architecture Planning Interiors Research
50 South B.B. King Boulevard
Memphis, Tennessee 38103
Telephone 901 521 1440
Fax 901 525 2760
E-mail info@lrk.com

Client:
McCormack Baron Salazar

720 Olive St, Suite 2500
St. Louis, MO 63101

Issues and Revisions

Date	Issued / Revised
03/16/2020	50% CONSTRUCTION DOCUMENTS
05/18/2020	80% CONSTRUCTION DOCUMENTS
07/13/2020	PERMIT

BUILDING ADDRESSES

TYPE G.E.	TYPE H.A.	TYPE L.C.	TYPE L.A.	TYPE M.A.
442, 444, 446, 448 RATLIFF LANE	324, 226, 228, 230 SHWAMEL PLACE	365, 431 VANCE AVE	327 SHWAMEL PLACE	420, 525 FOOTE LANE
323, 440 VANCE AVE	315, 364 FOOTE LANE	313 SHWAMEL PLACE	420, 525 FOOTE LANE	346 S DANNY THOMAS BLVD
353 S DANNY THOMAS BLVD	365, 431 VANCE AVE	313 SHWAMEL PLACE	327 SHWAMEL PLACE	420, 525 FOOTE LANE
				402, 426 FOOTE LANE

©2020 LRK, Inc.
Drawings, written material, and design concepts shall not be used or reproduced in whole or part in any form or format without prior written consent of LRK, Inc. Do not scale drawings. Use given dimensions only. If not shown, verify correct dimensions with the Architect. Contractor shall check and verify all dimensions and conditions at job site.

Seal



LRK Project Number 01.15100.02

Project Name:
South City CNI Phase 4
Memphis TN

Drawing Name:
ELECTRICAL SITE PLAN PHASE 4

Drawn By: PIH
Checked By: RJH

E002

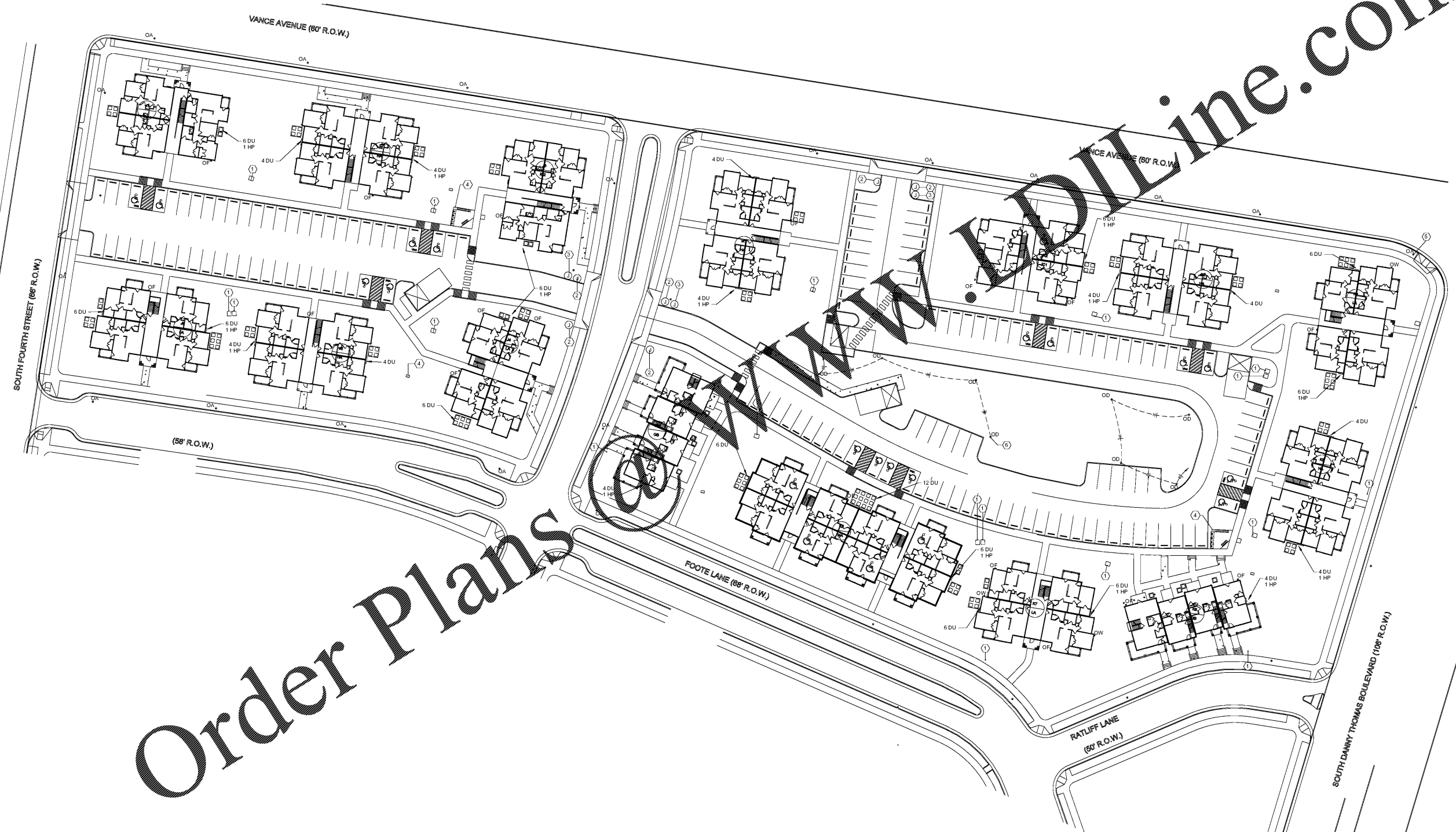

Order Plans

