

Architecture Planning Interiors Research  
50 South B.B. King Boulevard  
Memphis, Tennessee 38103  
Telephone 901.521.1440  
Fax 901.523.2760  
E-mail info@lrk.com

Client:

**McCormack Baron  
Salazar**

720 Olive St, Suite 2500  
St. Louis, MO 63101

**Issues and Revisions**

▲	Date	Issued / Revised
1	03/16/2020	50% CONSTRUCTION DOCUMENTS
2	05/18/2020	80% CONSTRUCTION DOCUMENTS
3	07/13/2020	PERMIT

**BUILDING ADDRESSES**

<b>TYPE G.B.</b>	442, 444, 446, 448 BATHURFF LANE 324, 226, 228, 230 ISHMAEL PLACE
<b>TYPE H.A.</b>	373, 440 VANCE AVE 315, 364 FOOTE LANE 383 S DANNY THOMAS BLVD
<b>TYPE L.C.</b>	365, 431 VANCE AVE 315 ISHMAEL PLACE
<b>TYPE L.A.</b>	327 ISHMAEL PLACE 420, 353 FOOTE LANE 345 S DANNY THOMAS BLVD
<b>TYPE M.A.</b>	402, 428 FOOTE LANE

©2020 LRK Inc.  
Drawings, written material, and design concepts shall not be used or reproduced in whole or part in any form or format without prior written consent of LRK Inc. Do not scale drawings. Use given dimensions only. If not shown, verify correct dimensions with the Architect. Contractor shall check and verify all dimensions and conditions at job

Seal



LRK Project Number: 01.15100.42

Project Name:  
**South City CNI  
Phase 4**  
Memphis TN

Drawing Name:  
**MECHANICAL SECTIONS  
& DETAILS**

Drawn By: QWW  
Checked By: RJH

**M002**

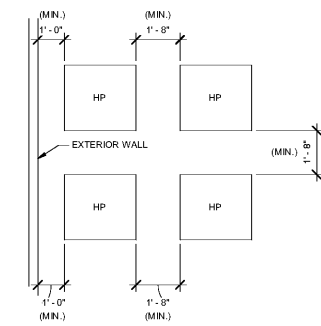

PROVIDE ONE LARGE CONCRETE SLAB FOR EACH GROUP OF CONDENSING UNITS. PAD MUST BE AT LEAST 4" THICK AND EXTEND AT LEAST 6" OUT FROM EACH SIDE OF CONDENSING UNIT. CONDENSING UNITS MUST BE SECURED TO PAD.

1 MANUF. REQ. FOR OUTSIDE UNITS  
N.T.S.

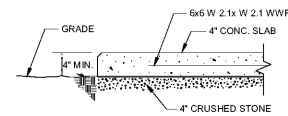

NOTE: FINAL OVERALL DIMENSIONS SHALL BE DETERMINED BY CLEARANCES AND SIZES OF EQUIPMENT. CONDENSING UNITS MUST BE SECURED TO PAD.

2 CONCRETE PAD DETAIL  
N.T.S.

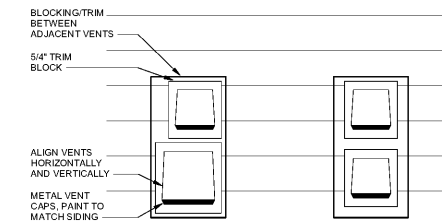

3 TYPICAL FIBER-CEMENT SIDING PENETRATION DETAIL  
N.T.S.

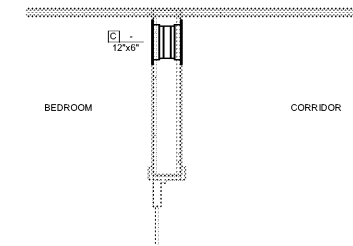

4 TYPICAL SECTION VIEW OF BEDROOM TRANSFER AIR GRILLES  
1" = 1'-0"

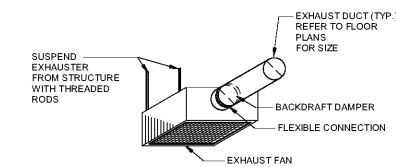

5 CEILING EXHAUST FAN DETAIL  
N.T.S.

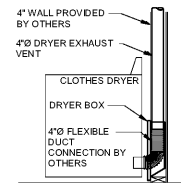

THIS DETAIL REPRESENTS THE INSTALLATION OF A MODEL 425 DRYER BOX BY IN-DVATE TECHNOLOGIES, INC. THE LOCATION IN WALL MUST BE FIELD VERIFIED USING THE INSTALLATION INSTRUCTIONS FOR THE DRYERS THAT WILL BE INSTALLED IN EACH UNIT. THE 4" DRYER DISCHARGE MUST BE ENTIRELY WITHIN THE 9 1/2" INSIDE WIDTH OF THE BOX. COORDINATION WITH OTHER TRADES TO SECURE THE PROPER LOCATION OF THE BOX IS THE RESPONSIBILITY OF THE MECHANICAL CONTRACTOR AND GENERAL CONTRACTOR.

6 ALT. DRYER VENT CONNECTION (IF REQUIRED)  
N.T.S.

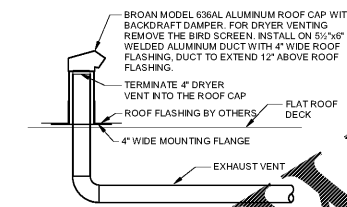

7 DRYER AND BATH FAN ROOF VENT  
N.T.S.

Order Plans @ [www.LDILine.com](http://www.LDILine.com)