

WINDOW LEGEND
 SCALE: 1/2" = 1'-0"

- WINDOW NOTES**
- WINDOWS BASED ON THE ENERGY STAR SERIES 1100 WINDOWS. CONTRACTOR TO OBTAIN PRICING ESTIMATE FOR INCREASED SOUND PERFORMANCE (BOTH STC 31 AND STC 34) AT GROUND LEVEL BEDROOM WINDOWS ADJACENT TO 5 OR MORE CONDENSING UNITS. SEE SITE PLAN.
 - WINDOWS AND GLAZING TO BE ULTRA LOW-E/ARGON FILLED AND MEET OR EXCEED ENERGY PERFORMANCE REQUIREMENTS OF ENERGY STAR FOR HOMES.
 - SEE EXTERIOR BUILDING ELEVATIONS FOR MULLION STYLES.
 - PROVIDE FIXED WINDOW AT ALL DORMER WINDOWS. PROVIDE SPANDREL GLAZING OR INSTALL BLACK PAINTED PLYWOOD ON INTERIOR TO OBTURE VIEW OF ROOF FRAMING.
 - SAFETY GLAZING REQUIRED IN HAZARDOUS LOCATIONS PER IRC 2406.4.5:
 A. ADJACENT TO A DOOR WHERE THE NEAREST VERTICAL EDGE OF GLAZING IS WITHIN 24" OF THE VERTICAL EDGE OF A DOOR AND THE BOTTOM EXPOSED EDGE OF THE GLAZING IS LESS THAN 60" ABOVE THE FLOOR.
 B. THE BOTTOM EDGE OF GLAZING IS LESS THAN 18" ABOVE THE FLOOR.
 PROVIDE WINDOW LIMIT STOPS FOR ALL ABOVE GRADE WINDOWS PER IRC 1013.8.1.
 - WINDOW CONTROLS IN UPAS UNITS TO BE AT OPERABLE HEIGHT, 54" MAX PER UPAS 4.2.6. BY USE OF ADA-COMPLIANT LOCK BY MANUFACTURER OR ADA LOCK ADAPTER.
 - PER IRC 2015 1030.2 AND IRC R310.2.1, ALL EMERGENCY ESCAPE AND RESCUE OPENINGS SHALL HAVE A MINIMUM NET CLEAR OPENING OF 5.7 SQUARE FEET, WITH A NET CLEAR OPENING OF 24" MIN IN HEIGHT AND 20" MIN IN WIDTH.
 - ALL WINDOWS SHALL RECEIVE 2" FAUX WOOD HORIZONTAL WINDOW BLINDS.
 - PROVIDE INSET SCREENS AT ALL WINDOWS.
 - PROVIDE SECURITY FILM OVER GLASS WHERE WINDOWS ARE LOCATED ADJACENT TO DOORS.
 - PROVIDE VINYL TEAR-AWAY TRIM FOR INTERIOR PERIMETER OF ALL WINDOWS.

FLASHING INSTALLATION FOR WINDOWS

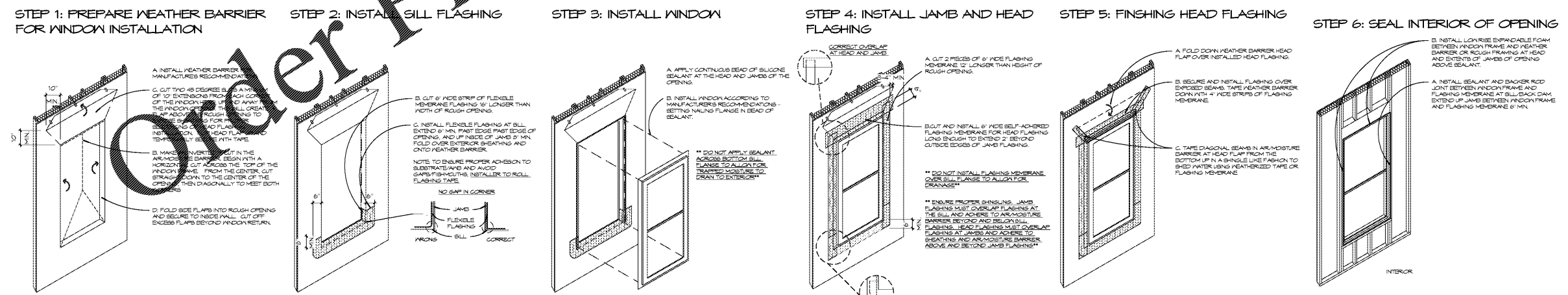

WINDOW FLASHING INSTALLATION
 SCALE: 3/8" = 1'-0"



Architecture Planning Interiors Research
 50 South B.B. King Boulevard
 Memphis, Tennessee 38103
 Telephone 901 521 1440
 Fax 901 525 2760
 E-mail info@lrk.com

Client:
McCormack Baron Salazar

720 Olive St Suite 2500
 St. Louis, MO 63101

Issues and Revisions

Date	Issued / Revised
3/16/2020	50% CONSTRUCTION DOCS
5/18/2020	80% CONSTRUCTION DOCS
7/13/2020	PERMIT SUBMISSION

BUILDING ADDRESSES

TYPE 6B	342, 444, 446, 448 RATLIFF LANE 324, 236, 238, 330 SHAWNEE PLACE
TYPE 6A	378, 448 VANCE AVE 316, 304 FOOTER AVE 333 S DANNY THOMAS BLVD
TYPE 6C	368, 481 VANCE AVE 375 SHAWNEE PLACE
TYPE 6A	321 SHAWNEE PLACE 450, 390 FOOTER LANE 315 S DANNY THOMAS BLVD
TYPE 6A	402, 406 FOOTER LANE

©2020 LRK, Inc.
 Drawings, written material, and design concepts shall not be used or reproduced in whole or part in any form or format without prior written consent of LRK, Inc. Do not scale drawings. Use given dimensions only. If not shown, verify correct dimensions with the Architect. Contractor shall check and verify all dimensions and conditions of job site.

Seal



LRK Project Number: 01.15100.43

Project Name:
South City CNI Phase 4
 Memphis TN

Drawing Name:
WINDOW LEGEND & FLASHING SEQUENCE

Drawn By: ADB
 Checked By: HJL

A601