

GENERAL NEW WORK NOTES

- 1 CONTRACTOR SHALL FIELD VERIFY ALL DIMENSIONS AND SITE CONDITIONS BEFORE COMMENCING WORK.
- 2 THIS CONTRACT REQUIRES COMPLETE FINISHED WORKABLE PROJECT OF THE AREAS INDICATED BY THE CONTRACT DOCUMENTS, AND SHALL INCLUDE ALL MATERIALS AND LABOR NECESSARY TO COMPLETE SAME, REGARDLESS OF WHETHER OR NOT EACH AND EVERY NECESSARY WORK OR ITEM IS SPECIFICALLY INDICATED ON ANY OTHER PORTION OF THE DRAWING AND/OR NOTES.
- 3 ALL DETAILS AND SECTIONS SHOWN ON THE DRAWINGS ARE INTENDED TO BE TYPICAL AND SHALL BE CONSTRUED TO APPLY TO ANY SIMILAR SITUATION ELSEWHERE ON THE PROJECT, EXCEPT WHERE A DIFFERENT DETAIL IS SHOWN.
- 4 CONTRACTOR SHALL FURNISH ALL ADDITIONAL DATA AND DOCUMENTATION TO SECURE ALL REQUIRED PERMITS AND SHALL COORDINATE THIS DATA WITH THE CONSTRUCTION DOCUMENTS WHERE REQUIRED.
- 5 AS A MINIMUM, ALL WORK SHALL CONFORM TO THE APPLICABLE BUILDING CODE ADOPTED BY THE JURISDICTION OF THE WORK, WHERE MORE STRINGENT CODES ARE ADOPTED, THEY SHALL GOVERN THE WORK.
- 6 ALL WORK SHALL CONFORM TO APPLICABLE FEDERAL, STATE, COUNTY AND LOCAL CODES AND ORDINANCES.
- 7 TO PROVIDE ACCESSIBILITY FOR THE PHYSICALLY HANDICAPPED, ALL WORK SHALL CONFORM TO PUBLIC LAW 101-336 (AMERICANS WITH DISABILITIES ACT OF 1990).
- 8 ALL WORK SHALL CONFORM TO THE APPLICABLE NFPA 101 LIFE SAFETY CODE ADOPTED BY THE JURISDICTION OF THE WORK.
- 9 AROUND ALL EXPOSED PIPES, CONDUIT OR DUCTS, INSTALL ENCLOSURES OF THE SAME MATERIAL AND FINISH AS ADJACENT WORK, UNLESS NOTED OTHERWISE.
- 10 LOUVERS, GRILLES, VENTILATORS AND FANS SHALL BE BUILT SNUGLY INTO OPENINGS. ALL SUCH ASSEMBLIES TO BE FLASHED, WATERSTOPPED AND SEALED.
- 11 FIELD CHECK ALL ROUGH AND/OR FINISH DIMENSIONS FOR ACCURATE FITTING OF EQUIPMENT, PANELS, COUNTERS, FIXTURES AND ACCESSORIES BEFORE FABRICATION. PROVIDE AND INSTALL ALL NECESSARY FILLERS, SCRIBE STRIPS, PANELS, BASES OR TRIM TO COMPLETE AND FINISH INSTALLATIONS.
- 12 ALL SWITCHES, OUTLETS, THERMOSTATS, CLOCKS, SPEAKERS OR OTHER WALL MOUNTED DEVICES, CONTROLS SHALL BE INSTALLED IN LOCATIONS WHICH ARE UNOBSTRUCTED BY CABINETS, COUNTERS, RACKS, FIXTURES, FURNISHINGS OR EQUIPMENT. ITEMS INTENDED FOR WALL MOUNTING SHALL NOT BE INSTALLED ON, THROUGH OR INTO ANY OTHER EQUIPMENT UNLESS SPECIFICALLY CALLED FOR BY MOUNTING HEIGHTS WITH ADA REQUIREMENTS.
- 13 PROVIDE AND INSTALL ALL NECESSARY HARDWARE, BRACKETS, SPACERS, ANCHORS, BOLTS, SET SCREWS, BLOCKING, FURNISH OR OTHER SUPPLEMENTARY ITEMS NEEDED TO COMPLETE INSTALLATION OF EQUIPMENT, FIXTURES AND ACCESSORIES.
- 14 ALL CONTRACTORS ARE TO COORDINATE THE WORK OF EACH OTHER, SO THAT THE WORK AND SCHEDULE ARE NOT IMPEDED. SCHEDULE WORKS THROUGHOUT THE ENTIRE PROJECT TO PREVENT CONFLICTS AND INTERFERENCE. ALL NECESSARY INFORMATION SUCH AS SIZES, LOCATIONS, TEMPLATES, LAYOUT, DIMENSIONS AND ALL OTHER INFORMATION NECESSARY FOR A PROPER AND WELL COORDINATED INSTALLATION PRIOR TO INSTALLATION OF ITEMS, CONFER WITH EACH CONTRACTOR EXACT LOCATION OF ALL ITEMS.
- 15 WHERE MATERIALS REFERRED TO IN THE DRAWINGS OR NECESSARY TO COMPLETE THE WORK OF THIS CONTRACT ARE NOT SPECIFIED, PROVIDE QUALITY MATERIALS. WHERE MATERIALS ARE INTENDED TO MATCH EXISTING, PROVIDE CLOSEST POSSIBLE MATCH, SUBJECT TO OWNER'S APPROVAL. ALL ITEMS AND WORK ON EXISTING ARE NEW UNLESS INDICATED OTHERWISE. ALL WORK WHICH HAS BEEN DAMAGED SHALL BE REPAIRED OR REPLACED. WHERE ITEM CANNOT BE REPAIRED TO A "NEW CONDITION", OR WHERE THE STRUCTURAL INTEGRITY HAS BEEN AFFECTED, ITEM SHALL BE REPLACED.
- 16 CONTRACTOR SHALL OBTAIN FROM OWNER ALL REQUIREMENTS FOR INSTALLATION OF OWNER PROVIDED EQUIPMENT INCLUDING SCHEDULING DIAGRAMS, INSTALLATION INSTRUCTIONS, ELECTRICAL SCHEMATICS, TEMPLATES, LAYOUTS AND DIMENSIONS AND ALL OTHER INFORMATION NECESSARY FOR A PROPER, WELL COORDINATED INSTALLATION. PRIOR TO ROUGH-IN SERVICES, CONFER WITH OWNER EXACT LOCATION OF ALL ITEMS.
- 17 DESIGN WINDSPEED FOR THE PROJECT IS 130MPH. ALL LOUVERS MUST RESIST POSITIVE AND NEGATIVE WIND LOADS ATTRIBUTED TO THE WINDSPEED BY ASCE 7-05 AND FACTORY MUTUAL DATA SHEETS 1-28 & 1-29 UNLESS OTHERWISE SPECIFIED. MORE STRINGENT.
- 18 PRODUCTS CONTAINING SILICONE ARE PROHIBITED FROM USE ON THIS PROJECT UNLESS SPECIFICALLY APPROVED IN ADVANCE BY THE OWNER.

DRAWING NOTES

- 1 LOCATION OF HAIR INTERCEPTOR BELOW. MAINTAIN ACCESS TO REMOVABLE SEDIMENT BASKET AND SECONDARY SCREEN FOR CLEANING AND MAINTENANCE.
- 2 2" VENT DOWN. DO NOT CUT REINFORCING IN BOND BEAMS. SEE STRUCTURAL DRAWINGS FOR ADDITIONAL INFORMATION CONCERNING BOND BEAMS.

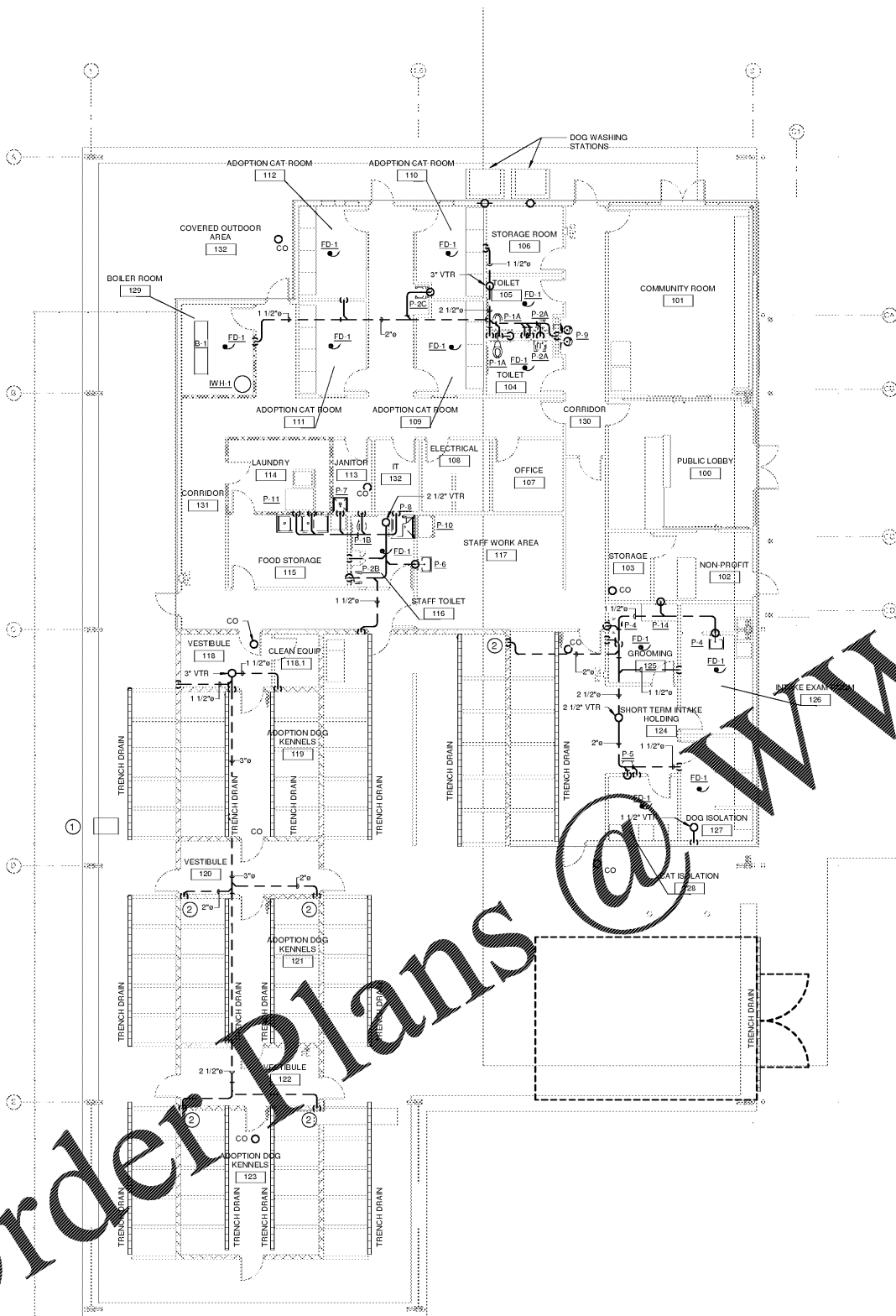

Order Plans @

WWW.LDINTEGRITY.COM

FIRE RATED WALL

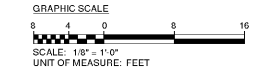

JACKSON COUNTY
ANIMAL RESCUE CENTER AND GREEN ENERGY PARK
 DILLSBORO, NORTH CAROLINA

SHEET NO.	DATE	DESCRIPTION	BY
1	09/02/2020	ISSUE FOR BID + PERMIT	RMF

PRINCIPAL IN CHARGE:
 PROJECT ARCHITECT:
 DRAWN BY: MRT

SHEET TITLE:
**FIRST FLOOR PLAN
 - WASTE AND VENT**

SHEET NO. PROJ. NO.
019216.00

P111