

2 TYP. BOND BEAM REINFORCING (CONTROL JOINT) SCALE: 1" = 1'-0"
4 TYP. BOND BEAM REINFORCING (WALL INTERSECTION) SCALE: 1" = 1'-0"
3 TYP. BOND BEAM REINFORCING (CORNER) SCALE: 1" = 1'-0"
5 TYP. BOND BEAM REINFORCING (WALL OPENING) SCALE: 1" = 1'-0"

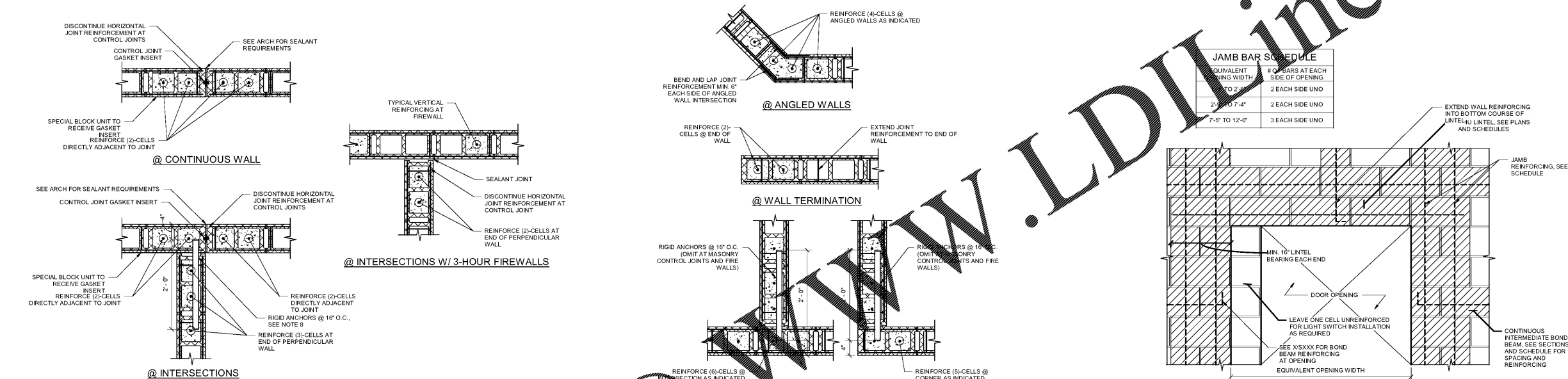

JAMB BAR SCHEDULE

OPENING WIDTH	# OF BARS AT EACH SIDE OF OPENING
1'-4" TO 2'-0"	2 EACH SIDE UNO
2'-0" TO 7'-4"	2 EACH SIDE UNO
7'-5" TO 12'-0"	3 EACH SIDE UNO

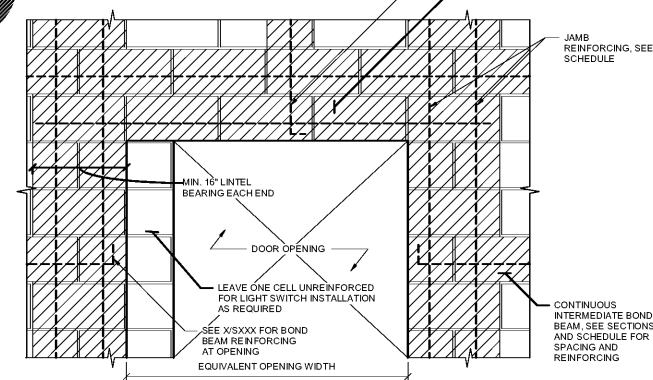

NOTES:
1. JAMB BAR SIZE SHALL MATCH TYPICAL ADJACENT WALL REINFORCING SIZE
2. PROVIDE HORIZONTAL JOINT REINFORCEMENT @ 16" O.C. VERTICALLY AND FIRST COURSE ABOVE AND BELOW OPENING. EXTEND MIN. OF 24" PAST OPENING
3. LINTELS SHALL BE CONSTRUCTED OF STANDARD "U" SHAPED UNITS (NOT BOND BEAM UNITS)
4. JAMB REINFORCING SHALL BE CONTINUOUS FROM FOOTING, GIRT, OR DIAPHRAGM LEVEL BELOW TO DIAPHRAGM LEVEL, GIRT OR TOP OF WALL ABOVE
5. DETAIL IS TYPICAL. ALL OPENINGS GREATER THAN 1'-0" WIDE
6. COORDINATE JAMB BARS WITH SPECIFIC CMU PIER DETAILS WHERE INDICATED

NOTES:
1. LOCATE CONTROL JOINTS SUCH THAT THE MAXIMUM STRAIGHT RUN OF CMU IS 40'-0" WHERE NOT SPECIFICALLY INDICATED ON PLAN.
2. PROVIDE CONTROL JOINTS WHERE SPECIFICALLY INDICATED ON PLAN OR ARCHITECTURAL DETAILS
3. DO NOT LOCATE CONTROL JOINT WITHIN 16" EITHER SIDE OF CENTERLINE OF BEAM OR JOIST BEARING LOCATION
4. DO NOT LOCATE CONTROL JOINT WITHIN THE REGION OF CMU OR STEEL LINTEL BEARING, OR ASSOCIATED JAMB REINFORCING
5. SEE TYPICAL BOND BEAM REINFORCING DETAILS FOR TERMINATION OF BOND BEAM REINFORCING AT CONTROL JOINTS
6. SEE ARCHITECTURAL DRAWINGS FOR JOINT FILLER REQUIREMENTS AT RATED WALLS
7. SEE SPECIFICATIONS AND GENERAL NOTES FOR REBAR POSITIONER REQUIREMENTS

NOTES:
1. COORDINATE THESE TYPICAL DETAILS WITH SPECIFIC PIER DETAILS
2. SEE SCHEDULES AND SECTIONS FOR TYPICAL CMU WALL VERTICAL REINFORCING
3. SEE SPECIFICATIONS AND GENERAL NOTES FOR REBAR POSITIONER REQUIREMENTS

8 TYP. CMU CONTROL JOINT SCALE: 1" = 1'-0"
1 TYP. CMU VERTICAL REINFORCING SCALE: 1" = 1'-0"
6 TYP. CMU CONSTRUCTION (@ DOOR) SCALE: 1" = 1'-0"

JAMB BAR SCHEDULE

OPENING WIDTH	# OF BARS AT EACH SIDE OF OPENING
1'-4" TO 2'-0"	1 EACH SIDE UNO
2'-0" TO 7'-4"	2 EACH SIDE UNO
7'-5" TO 12'-0"	3 EACH SIDE UNO

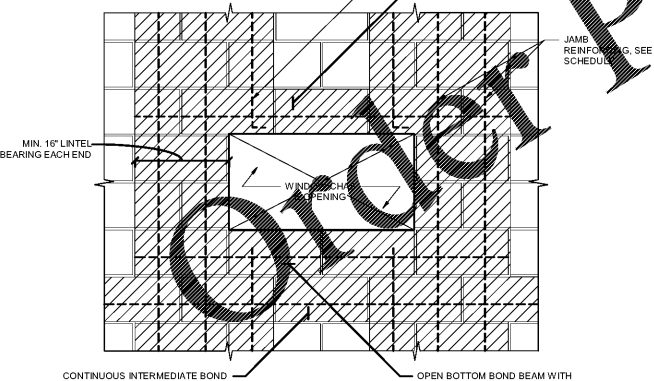

NOTES:
1. JAMB BAR SIZE SHALL MATCH TYPICAL ADJACENT WALL REINFORCING SIZE
2. PROVIDE HORIZONTAL JOINT REINFORCEMENT @ 16" O.C. VERTICALLY AND FIRST COURSE ABOVE AND BELOW OPENING. EXTEND MIN. OF 24" PAST OPENING
3. LINTELS SHALL BE CONSTRUCTED OF STANDARD "U" SHAPED UNITS (NOT BOND BEAM UNITS)
4. JAMB REINFORCING SHALL BE CONTINUOUS FROM FOOTING, GIRT, OR DIAPHRAGM LEVEL BELOW TO DIAPHRAGM LEVEL, GIRT OR TOP OF WALL ABOVE
5. DETAIL IS TYPICAL. ALL OPENINGS GREATER THAN 1'-0" WIDE
6. COORDINATE JAMB BARS WITH SPECIFIC CMU PIER DETAILS WHERE INDICATED

7 TYP. CMU CONSTRUCTION (@ OPENING) SCALE: 1" = 1'-0"

Order Plans

WWW.LDIDLINE.COM