

1. THIS PROJECT WILL COMPLY WITH ALL APPLICABLE FEDERAL, STATE AND LOCAL REGULATIONS REGARDING HANDICAPPED ACCESS INCLUDING ANS STANDARDS.
2. PROTECTIVE MEASURES FOR TREES, INSTALLATION METHODS FOR NEW PLANT MATERIAL, AND MAINTENANCE OF LANDSCAPED AREAS WILL COMPLY WITH THE STANDARDS ESTABLISHED BY THE TREE PROTECTION AND LANDSCAPE ORDINANCE MANUAL AND THE CITY HORTICULTURIST.
3. NO TOPPING OR HEADING BACK OF A TREE SHALL BE PERMITTED WHICH INVOLVES THE CUTTING OF LIMBS BACK TO A SHRUB, BUD, OR LATERAL BRANCH NOT LARGE ENOUGH TO ASSUME THE TERMINAL ROLE. CROWN REDUCTION SHALL BE USED TO REDUCE THE SIZE OF A TREE AND IS BEST ACCOMPLISHED BY CUTTING LIMBS BACK TO LATERALS THAT ARE AT LEAST ONE-THIRD THE DIAMETER OF THE PARENT LIMB.
4. EXISTING TREES TO BE SAVED WILL BE MULCHED WITH AT LEAST 3 INCHES OF MULCH (PINE STRAW, BARK OR OTHER ORGANIC MATERIAL).
5. AN AUTOMATIC IRRIGATION SYSTEM MUST BE INSTALLED TO WATER ALL NEW LANDSCAPED AREAS. THE SYSTEM MUST REMAIN OPERATIONAL AND HAVE A TIMER TO WATER PLANTINGS TO KEEP THEM ALIVE.
6. ALL LANDSCAPED AREAS TO BE COVERED IN 4 INCHES OF ASED MEDIUM-SIZE DOUBLE-MULLES HARDWOOD BARK, OR OTHER APPROVED MATERIAL.
7. TREE MAINTENANCE SHALL TAKE INTO ACCOUNT THE NATURAL SHAPE AND GROWTH PATTERNS OF THE TREE. TREES INTENDED TO GROW TO THE GROUND SHALL NOT BE LIMBED UP. TREES SHALL NOT BE TOPPED OR PRUNED TO GROW AS SHRUBS OR BUSHES.
8. ALL REQUIRED TREES SHALL BE GROWN WITHIN ONE CLIMATIC ZONE OF AGEN, SC.
9. ALL REQUIRED TREES SHALL BE NURSERY GROWN, TYPICAL OF THEIR SPECIES OR VARIETY, WITH NORMAL, DENSELY DEVELOPED BRANCHES AND VIGOROUS, FIBROUS ROOT SYSTEMS. TREES SHALL BE SOUND, HEALTHY, VIGOROUS, FREE FROM DEFECTS, FREE FROM POSING ROOTS, FREE FROM SUN SCALD INJURIES, FROST DAMAGE AND/OR ABRASSIONS OF THE BARK, AND FREE FROM PLANT DISEASES, INSECT EGGS, BORERS, AND ALL FORMS OF INFESTATION. ALL TREES SHALL HAVE FULLY DEVELOPED FORM WITHOUT HOLES AND OPEN SPACES. TREES SHALL NOT BE LOOSE IN THE CONTAINER OR ROOT BALL. IT IS RECOMMENDED THAT DUG TREES SHALL HAVE BEEN ROOT PRUNED AT LEAST ONCE.
10. ALL REQUIRED TREES SHALL BE SET IN THE PLANTING PIT TO PROPER GRADE AND ALIGNMENT, AND SHALL BE SET UPRIGHT, PLUMB AND FACED TO GIVE THE BEST APPEARANCE OR RELATIONSHIP TO OTHER TREES. EACH TREE SHALL BE SET 1'-2" ABOVE THE FINISH GRADE AND BACKFILL SHALL BE BROUGHT EVEN WITH THE TOP OF THE ROOT BALL. NO FILL SHALL BE ESTIMATED AT THE ROOT BALL.
11. ALL BURLAP, ROPES, STRAPS, AND WIRES SHALL BE REMOVED FROM THE ROOT BALL. IF IT IS NOT POSSIBLE TO REMOVE THE BURLAP AND WIRE FROM THE BOTTOM OF THE ROOT BALL, THE BURLAP AND WIRE SHALL BE CUT AWAY FROM THE SIDES AND REMOVED FROM THE HOLE.
12. AFTER REQUIRED TREES ARE SET, THE BACKFILL SHALL BE MULCHED AROUND THE BASE OF THE ROOT BALL AND ALL HOLES SHALL BE FILLED.
13. ALL REQUIRED TREES SHALL HAVE THEIR PLANTING PITS MULCHED WITH APPROVED MULCHING MATERIAL IMMEDIATELY AFTER PLANTING. THE MULCHED AREAS SHALL BE THOROUGHLY WATERED. MULCH SHALL BE PLACED TO A MAXIMUM THICKNESS OF 3" EXCEPT AT THE TRUNK, WHERE IT SHALL BE NO MORE THAN 1".
14. IF STAKING AND SUPPORTS HAVE BEEN INSTALLED ON THE REQUIRED TREES, ALL STAKING AND SUPPORTS SHALL BE REMOVED AFTER ONE GROWING SEASON.
15. ALL REQUIRED TREES SHALL HAVE STRAIGHT, SINGLE CENTRAL LEADERS. TREES THAT HAVE A MAIN TRUNK FORMING A "Y" SHAPE AND NOT QUITE 90 DEGREES THAT ARE NOT FULLY BRANCHED WILL NOT BE ACCEPTED. TREES SHALL HAVE NO BARK DAMAGE AND SHALL NOT BE LEANING OR HAVE A SIGNIFICANT SWEET, CROOK OR BEND. TREES SHALL HAVE A MINIMUM 1" CALIBER AND 8' IN HEIGHT AND SHALL HAVE NO BRANCH MORE THAN HALF THE DIAMETER THAN THE MAIN LEADER AND SHALL HAVE A STRAIGHT, UNBRANCHED TRUNK TO 6'. TREES SPECIFIED AS "MULTI-STEMMED" SHALL HAVE A MINIMUM 3 AND A MAXIMUM OF 9 SEPARATE CANES A MINIMUM OF 1" CALIBER EACH COMING FROM THE ROOT BALL AND MUST BE PRUNED INTO TREE FORM WITH PRUNED INTO TREE FORM WITH NO BRANCHES ON THE LOWER HALF OF THE TREE. MULTIPLE PLANTS SHALL NOT BE USED AS A "MULTI-STEMMED" PLANT.
16. ALL CREPE MYRTLES OR OTHER MULTI-STEMMED TREES SHALL HAVE A MINIMUM OF 3 AND A MAXIMUM OF 9 SEPARATE CANES A MINIMUM OF 1" CALIBER EACH COMING FROM THE ROOT BALL AND MUST BE PRUNED INTO TREE FORM WITH PRUNED INTO TREE FORM WITH NO BRANCHES ON THE LOWER HALF OF THE TREE. MULTIPLE PLANTS SHALL NOT BE USED AS A MULTI-STEMMED PLANT.
17. SET CROWN PLAN FOR LIGHTING REQUIREMENTS.
18. CONTRACTOR TO PROVIDE/REPLACE IRRIGATION IN KIND AND PROVIDE AN IRRIGATION PLAN FOR REVIEW. ALL LANDSCAPED AREAS SHALL BE IRRIGATED.

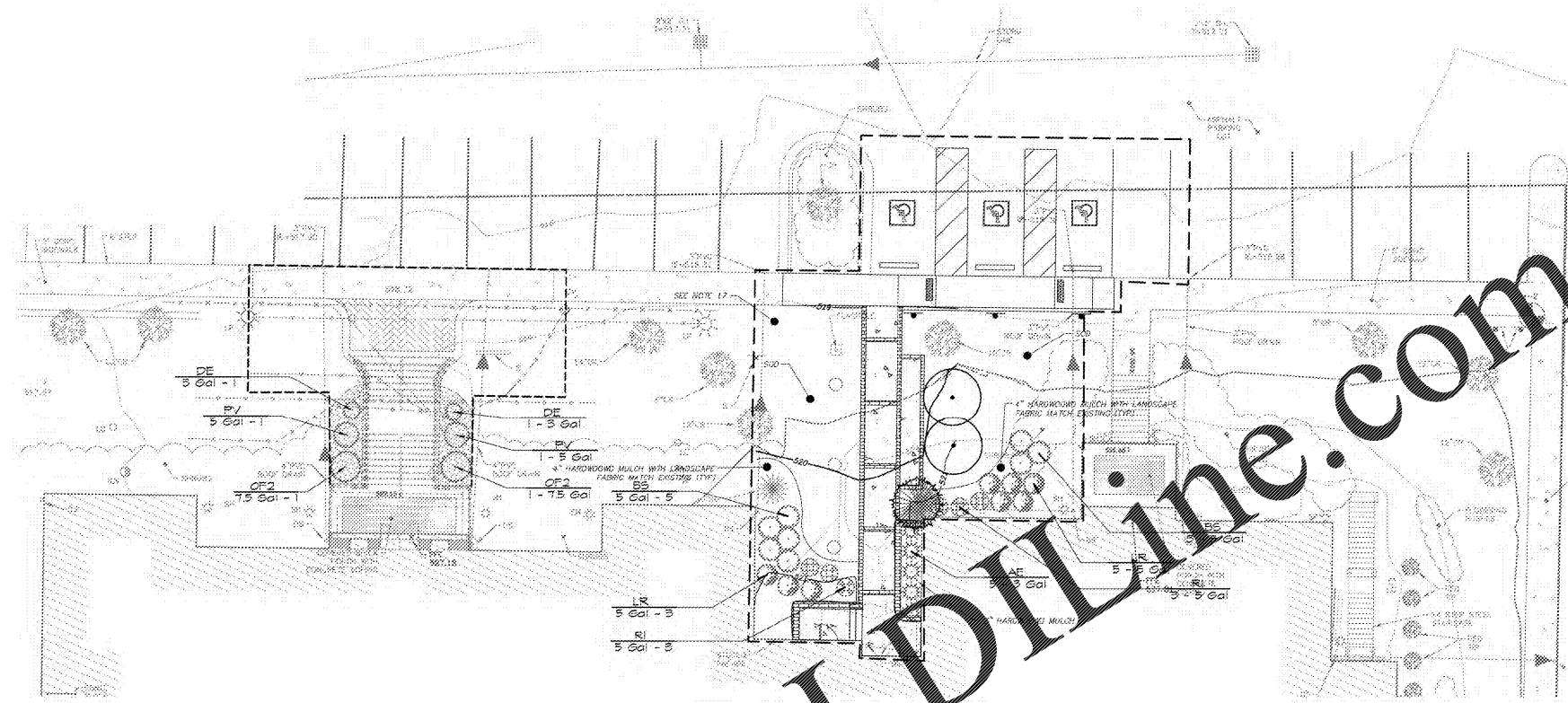

PLANT SCHEDULE

TREES	CODE	BOTANICAL / COMMON NAME	CAL	QTY
IS	IS	Ilex x alternata 'Savannah' Savannah Holly	3"	1
LI	LI	Lagerstroemia indica Crepe Myrtle	3"	2
SHRUBS	CODE	BOTANICAL / COMMON NAME	CAL	QTY
AE	AE	Agave attenuata Cast Iron Plant	3 Gal	5
BS	BS	Buxus sempervirens American Boxwood	5 Gal	8
DE	DE	Diastylum x 'Vintage Seeds' Vintage Jester Diastylum	3 Gal	2
LR	LR	Liriodendron chinense rubrum Chinese Fringe Flower	5 Gal	5
DFZ	DFZ	Dianthus fragrans Sweet Olive	7.5 Gal	2
PV	PV	Philosporum tenuifolium 'Variegatum' Toughberry	5 Gal	2
RI	RI	Rhododendron indicum Indica Azalea	6"	6

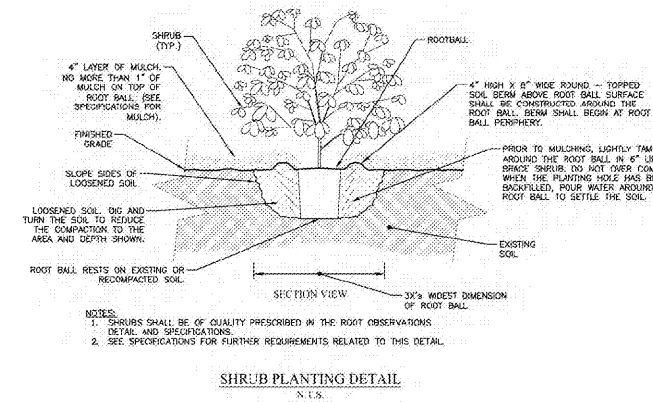
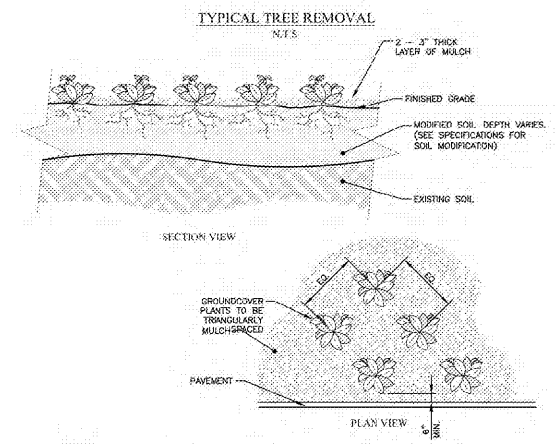
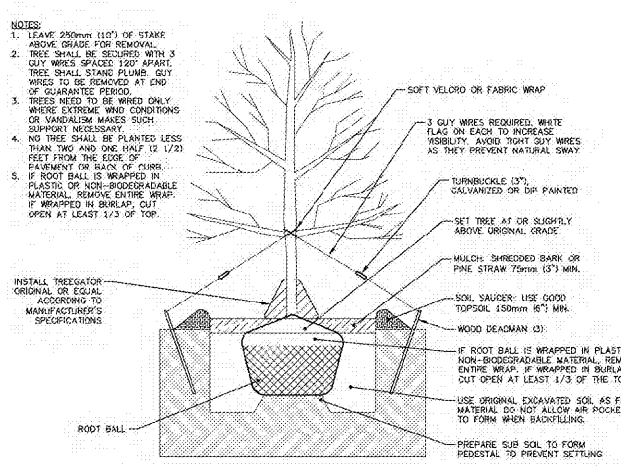
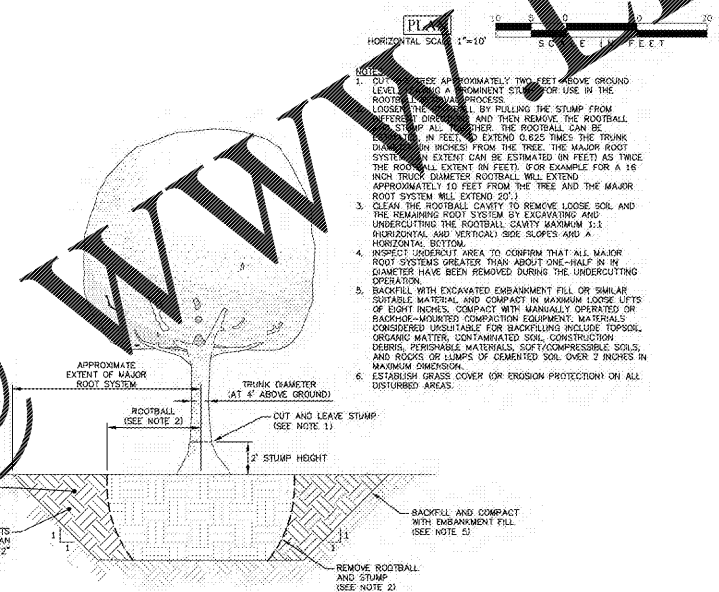

Order Plans @ WWW.WADLINE.COM

AIKEN COUNTY
AIKEN PUBLIC LIBRARY & NORTH WING
RENOVATION

314 CHESTERFIELD ST., AIKEN, SC

SHEET ISSUE:

NO.	DATE	DESCRIPTION	BY
D	04/10/2020	PERMIT SET	TMP
E	07/02/2020	ISSUE FOR BID	TMP

ISSUE FOR BID: 05/20/2020

PRINCIPAL CHARGED: ISSW
PROJECT ENGINEER: TMP
DRAWN BY: MAB

SHEET TITLE:
LANDSCAPE PLAN & DETAILS

SHEET NO.: C201
PRCL NO.: 01947.01