

**LIFE SAFETY LEGEND**

NOTE: EXISTING LOAD BEARING EXTERIOR WALLS  
2 HOUR PER CONSTRUCTION TYPE

NEW RATED WALL - 1 HOUR  
EXISTING RATED WALL - 1 HOUR

TRAVEL DISTANCE  
MAX TRAVEL DISTANCE PER BELOW

EGRESS PATH OF TRAVEL

COMMON PATH  
A M 75  
B S 100

TRAVEL DISTANCE  
A M 250  
B S 300

FUTURE TENANT UNOCCUPIED WORK AREA EGRESS BASED ON  
BUSINESS OCCUPANCY

100' - 0" EXIT SEPARATION PROVIDE

10' DIAGONAL DISTANCE SEPARATION DISTANCE

100' - 0" (33' - 4") OCCUPANT LOAD

STAR EXIT OCCUPANT CAPACITY

STAR CLEAR EXIT WIDTH (N INCHES)

DOOR EXIT OCCUPANT LOAD

DOOR EXIT OCCUPANT CAPACITY

170 [36] 240 ALL EGRESS DOORS W/ PANIC HARDWARE FULLY  
COMPLIANT WITH SECTION 1010.1.10

DOOR CLEAR EXIT WIDTH (N INCHES)

ROOM OR USE NAME

OCCUPANT LOAD  
150 SF / SF PER OCCUPANT

EXISTING RECESSED OR SEMI-RECESSED  
FIRE EXTINGUISHER CABINET - RELOCATE  
WITHIN WALL SUCH THAT TOP OF  
CABINET IS LESS THAN 48" AFF

NO WORK AREA - NOT IN SCOPE -  
(does not indicate mechanical or  
data scope)

NEW WORK:  
RED - (CUT VIEW)  
PINK - (PROJECTION VIEW)



CONSULTANT LOGO

SEALS



AIKEN COUNTY  
AIKEN PUBLIC LIBRARY & NORTH WING  
RENOVATION  
314 CHESTERFIELD ST S, AIKEN, SC

SHEET ISSUE		
NO.	DATE	DESCRIPTION
B	03/06/2020	DD SET
D	04/10/2020	PERMIT SET
E	07/02/2020	ISSUED FOR BIDS

ISSUED FOR BIDS 07/02/2020  
PRINCIPAL IN CHARGE DRM  
PROJECT ARCHITECT TA  
DRAWN BY JTP

SHEET TITLE:  
**LIFE SAFETY PLAN  
AND CALCULATIONS**

SHEET NO. PROJ. NO.  
018477.01

**G120**

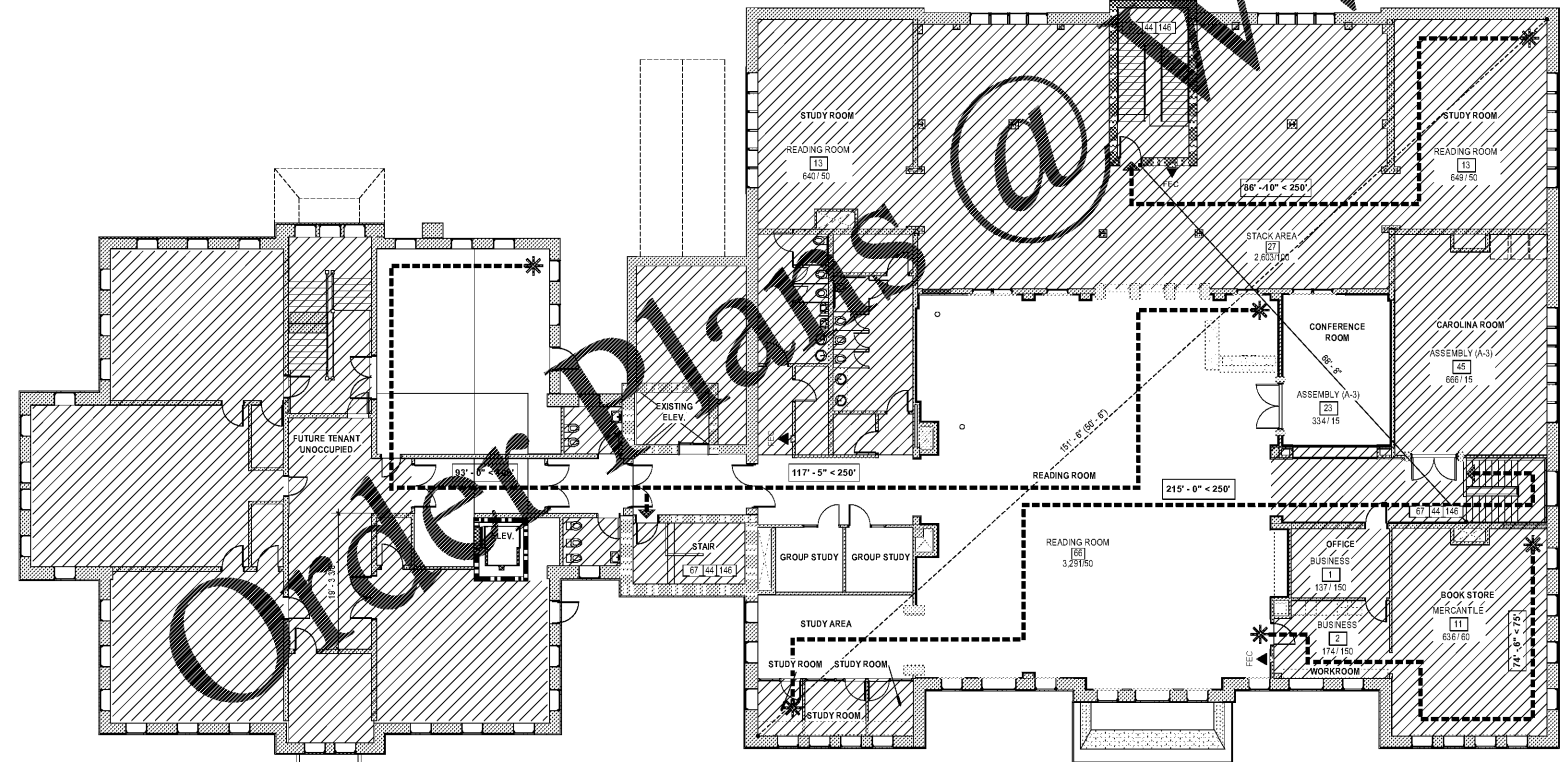

**A1 SECOND FLOOR PLAN LIFE SAFETY PLAN**  
1" = 10'-0"

www.LDILine.com