

ARCHITECTURE ENGINEERING, P.C. SHALL RETAIN ALL COMMON LAW, STATUTORY AND OTHER RESERVED RIGHTS, INCLUDING THE COPYRIGHT THEREIN. PROGRESSIVE ARCHITECTURE ENGINEERING, P.C. SHALL RETAIN ALL COMMON LAW, STATUTORY AND OTHER RESERVED RIGHTS, INCLUDING THE COPYRIGHT THEREIN.

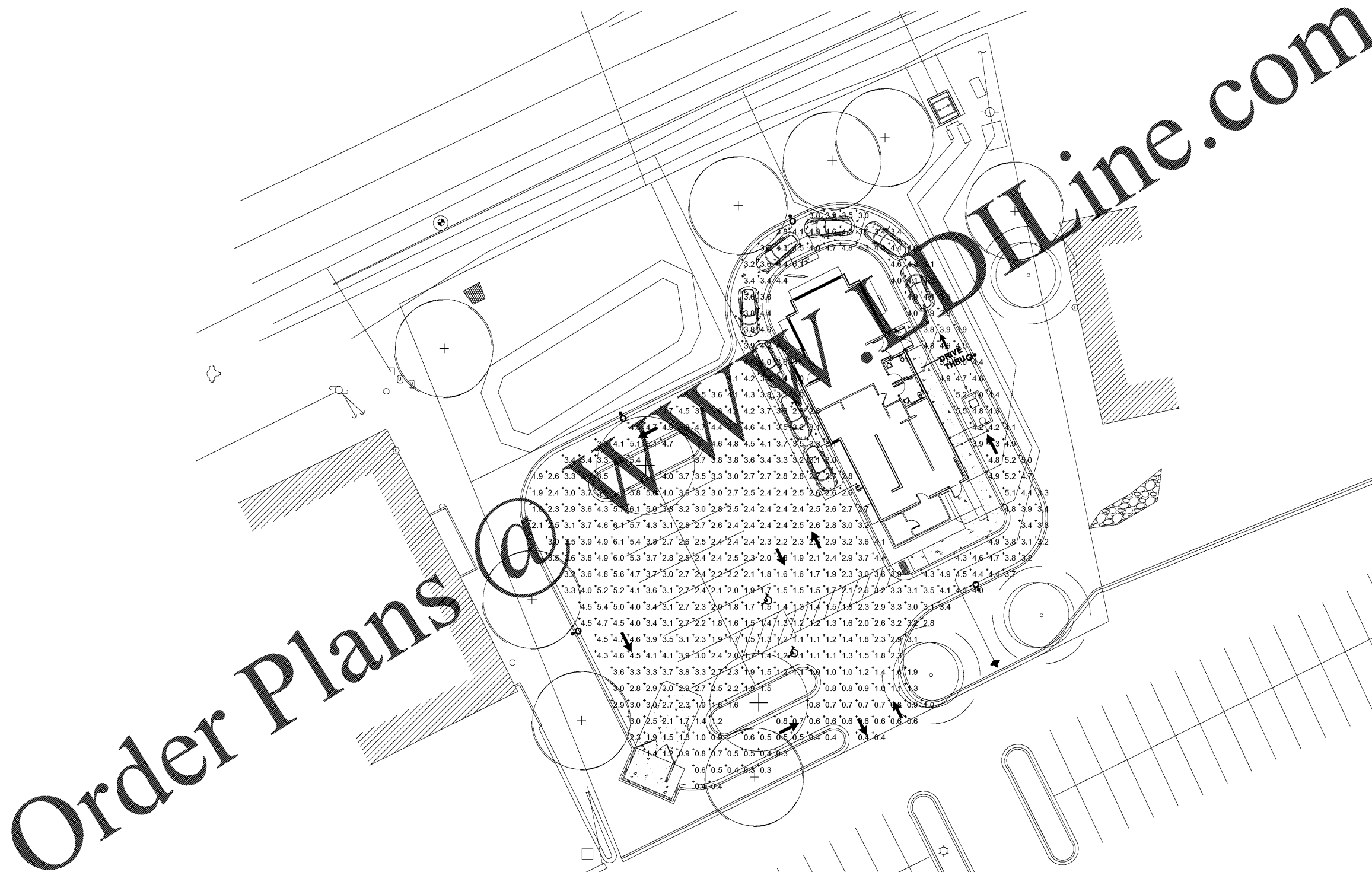

1 ELECTRICAL SITE PLAN – PHOTOMETRIC
SCALE: 1/16" = 1'-0"



POPEYE'S

LEBLON FRANCHISING HOLDINGS, LLC. POPEYE'S LOUISIANA KITCHEN 921 CONCORD PARKWAY SOUTH, CONCORD, NC, 28027



FOR CONSTRUCTION

ISSUANCE PERMIT SUBMITTAL 08/14/2020

REVISIONS

NO.	DATE	DESCRIPTION
1		

FILE NUMBER 86560010

PROJECT MANAGER	RM
PROFESSIONAL	MPA
DRAWN BY	TLW
CHECKED BY	RM

ELECTRICAL SITE PLAN - PHOTOMETRIC

E3