

# Order Plans

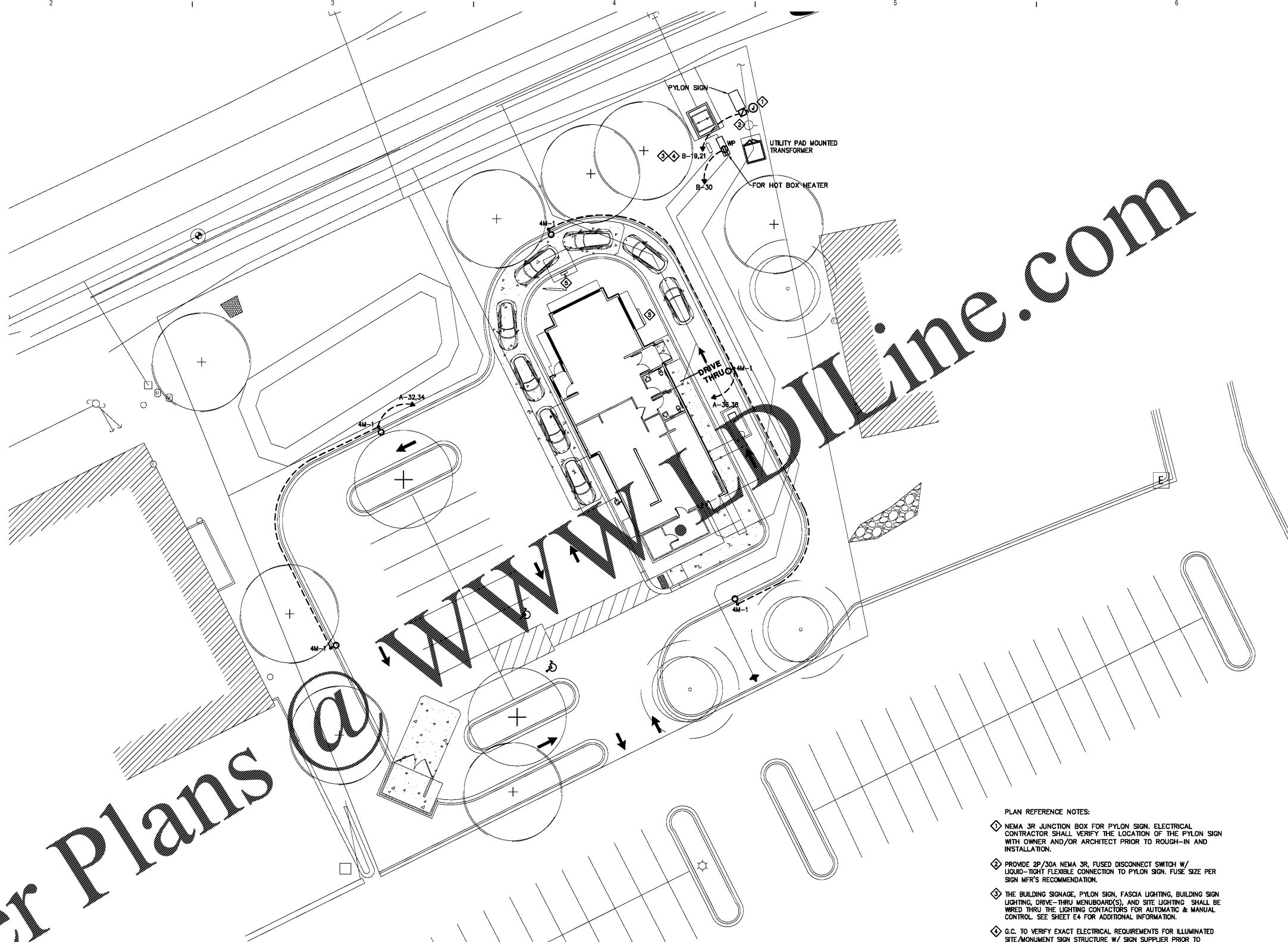

## SITE LIGHTING FIXTURE SCHEDULE

TYPE	DESCRIPTION	MANUFACTURER	MANUFACTURER CATALOG NO.	COLOR	LAMPS/NOTES
4M-1	166W LED SITE HEAD 25' SQUARE STEEL POLE	CREE	OSQ-A-NM-4ME-T-57K-UL-BZ with OSQ-AABZ	DARK BRONZE DARK BRONZE	166W LED N/A

## 1 ELECTRICAL SITE PLAN

SCALE: 1/16" = 1'-0"

### PLAN REFERENCE NOTES:

- ◆ NEMA 3R JUNCTION BOX FOR PYLON SIGN. ELECTRICAL CONTRACTOR SHALL VERIFY THE LOCATION OF THE PYLON SIGN WITH OWNER AND/OR ARCHITECT PRIOR TO ROUGH-IN AND INSTALLATION.
- ◆ PROVIDE 2P/30A NEMA 3R, FUSED DISCONNECT SWITCH W/ LIQUID-TIGHT FLEXIBLE CONNECTION TO PYLON SIGN. FUSE SIZE PER SIGN MFR'S RECOMMENDATION.
- ◆ THE BUILDING SIGNAGE, PYLON SIGN, FASCIA LIGHTING, BUILDING SIGN LIGHTING, DRIVE-THRU MENUBOARD(S), AND SITE LIGHTING SHALL BE WIRED THRU THE LIGHTING CONTACTORS FOR AUTOMATIC & MANUAL CONTROL. SEE SHEET E4 FOR ADDITIONAL INFORMATION.
- ◆ G.C. TO VERIFY EXACT ELECTRICAL REQUIREMENTS FOR ILLUMINATED SITE/MONUMENT SIGN STRUCTURE W/ SIGN SUPPLIER PRIOR TO INSTALLATION. G.C. TO PROVIDE FINAL ELECTRICAL HOOK-UP.
- ◆ REFER TO SHEET E4 FOR POWER TO MENU BOARDS.

### GENERAL NOTES:

1. CONDUCTOR SIZES SHOWN ON PLANS SHALL BE USED FOR ENTIRE LENGTH OF RUN.
2. RACEWAY SHALL BE SCHEDULE 40 PVC. RACEWAY SHALL BE BURIED MINIMUM 24" UNDERGROUND WHERE ROUTED UNDER PLANNED ROADWAY.
3. UNLESS NOTED OTHERWISE, FEEDER CONDUCTORS SHALL BE COPPER, THHN/THWN-2 INSULATION. WHERE APPROVED, ALUMINUM CONDUCTORS SHALL BE COMPACT, AA-8000 SERIES, XHHW-2, 90°C.
4. ADDITIONAL EQUIPMENT REQUIRED:
  - a) CL-SSP-4011-25-01-BZ (25' x 4' x 11 ga STEEL SQUARE POLE)
  - b) PB-24ABZ TWIN TENON
  - c) OSQ-AABZ ADJUSTABLE ARM MOUNT
  - d) PROPOSED POLES MEET 100 MPH SUSTAINED WIND LOADS
5. FIXTURE MOUNTING HEIGHT SHALL BE 27' A.F.G. (25' POLE + 2' BASE)



08-14-2020  
FOR  
CONSTRUCTION

If this document is sealed and signed in a digital or electronic format and is received from someone other than the sealing professional identified in the document, you must contact the sealing professional in writing to validate authenticity of the document. The sealing professional disclaims the seal and signature and shall not be liable for any liability associated with it where the authenticity of any digital or electronic seal or signature has not been validated in this manner.

ISSUANCE  
PERMIT SUBMITTAL 08/14/2020

REVISIONS  
NO. DATE DESCRIPTION

FILE NUMBER 86560010  
PROJECT MANAGER RM  
PROFESSIONAL MPA  
DRAWN BY TLW  
CHECKED BY RM

ELECTRICAL  
SITE PLAN

E2



POPEYE'S

LEBLON FRANCHISING  
HOLDINGS, LLC.  
**POPEYE'S**  
LOUISIANA KITCHEN  
921 CONCORD PARKWAY SOUTH,  
CONCORD, NC, 28027

progressive | ae

PROGRESSIVE ARCHITECTURE ENGINEERING, PC  
330 South Tryon St Suite 500 | Charlotte, NC 28202 | 704.731.8800 | www.progressiveae.com