

1 DIGITAL MENUBOARD ELECTRICAL RECEPTACLE LOCATIONS
A12a 1/2"=1'-0"

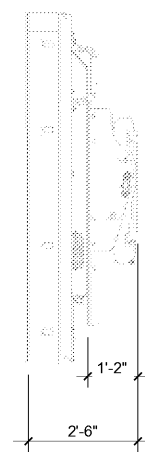

5 MONITOR BRACKET DETAILS (SIDE)
A12a NTS *FOR REFERENCE ONLY

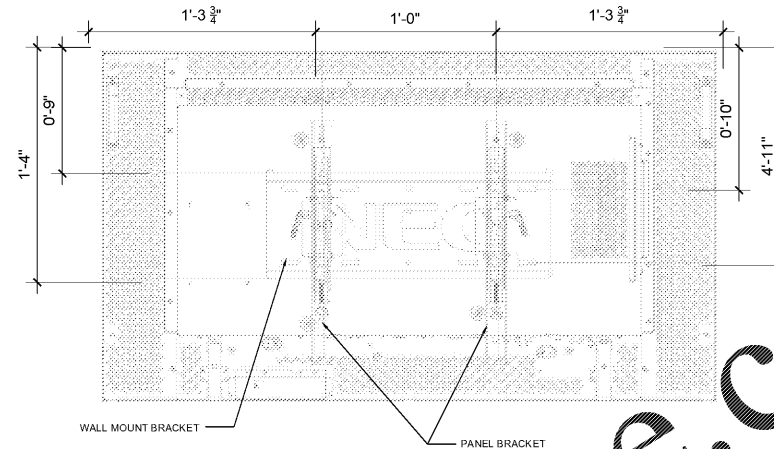

6 MONITOR BRACKET DETAILS (REAR)
A12a NTS *FOR REFERENCE ONLY

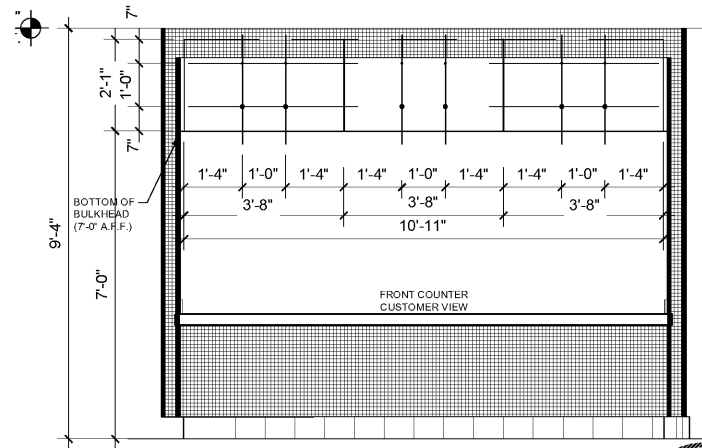

2 DIGITAL MENUBOARD LOCATION DIAGRAM
A12a 1/2"=1'-0"

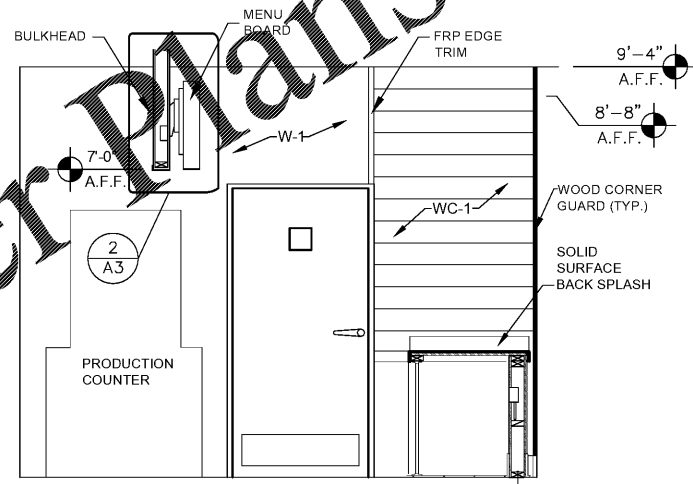

4 FRONT COUNTER SECTION
A12a 1/2"=1'-0"

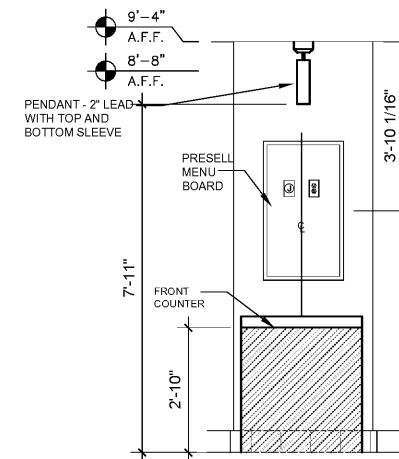

7 PRE-SALE BOARD ELEVATION @ FRONT COUNTER
A12a 1/2"=1'-0"

Order Plans @

WWW.LDILINE.COM

ARCHITECTURE ENGINEERING, P.C. SHALL RETAIN ALL COMMON LAW, STATUTORY AND OTHER RESERVED RIGHTS, INCLUDING THE COPYRIGHT THEREIN. PROGRESSIVE ARCHITECTURE ENGINEERING, P.C. SHALL RETAIN ALL COMMON LAW, STATUTORY AND OTHER RESERVED RIGHTS, INCLUDING THE COPYRIGHT THEREIN.

progressive | ae
 PROGRESSIVE ARCHITECTURE ENGINEERING, P.C.
 330 South Tryon St, Suite 500 | Charlotte, NC 28202 | 704.731.8880 | www.progressiveae.com



POPEYE'S

LEBLON FRANCHISING
 HOLDINGS, L.L.C.
POPEYE'S
 LOUISIANA KITCHEN
 921 CONCORD PARKWAY SOUTH
 CONCORD, NC, 28027



08/14/2020

FOR CONSTRUCTION

If this document is sealed and signed in a digital or electronic format and is received from someone other than the sealing professional identified in the document, you must contact the sealing professional in writing to validate the authority of the document. The sealing professional disclaims the seal and signature and shall not be liable for any liability associated with it where the authority of any digital or electronic seal or signature has not been validated in this manner.

ISSUANCE
 PERMIT SUBMITTAL 08/14/2020

REVISIONS
 NO. DATE DESCRIPTION

FILE NUMBER 86560010
 PROJECT MANAGER DRG
 PROFESSIONAL JRD
 DRAWN BY DRG
 CHECKED BY DS

**DIGITAL
 MENUBOARD
 ELEVATIONS &
 DETAILS
 A12a**