

FREEZER W/ FLOOR SUPPLIED BY K.E.S. FREEZER FLOOR TO SET ON TOP OF FLOOR TILE. SEE SECTION DETAIL 10-A14.



1 FINISH FLOOR PLAN

A2 1/4"=1'-0"

SPECIFICATIONS:

DIVISION 9: FINISHES

SECTION 9B: TILE

GENERAL PROVISIONS

- SCOPE: FURNISH AND INSTALL ALL TILE FLOORS AND WALLS.
- QUALITY CONTROL: ALL TILE MATERIALS AND INSTALLATIONS SHALL CONFORM TO THE RECOMMENDED PRACTICES OF THE TILE COUNCIL OF AMERICA, INC.
- REFER TO THE POPEYES VENDOR DIRECTORY FOR APPROVED SUPPLIERS.

MATERIALS

- USE CERAMIC AND QUARRY TILE AS SHOWN ON FINISH SCHEDULE.
- GROUT:
 - A. JOINTS IN FLOOR WALLS, AND BASE: EPOXY IS REQUIRED - HYDROMENT V-POXY AARI OR APPROVED ALTERNATE HYDROMENT SANDED JOINT FILLER AS MANUFACTURED BY THE UPCO COMPANY OR EQUAL CUSTOM BUILDING PRODUCTS. COLOR AS SHOWN ON FINISH SCHEDULE.
 - B. JOINTS IN FLOOR AND BASE JOINTS IN FLOORS AND BASE IN FOOD PREP, SUPPLY, SALES, UTILITY WASH, AND TOILETS TO BE INSTALLED IN ACCORDANCE WITH THE TILE COUNCIL METHOD OF DRY SET MORTAR WITH EPOXY GROUT IN LIEU OF CEMENT BASE GROUT. GROUT SHALL BE HYDROMENT V-POXY AARI. ALTERNATE "HYDROMENT JOINT FILLER" BY THE UPCO CO. IN ACCORDANCE WITH MANUFACTURER'S DIRECTIONS. JOINTS SHALL BE 1/4" WIDE AND COMPLETELY FILLED LEVEL WITH THE SHOULDER OF THE TILE AND THEN TOOLED TO A SMOOTH DENSE FINISH.
 - C. JOINTS IN WALL TILE SHALL BE GROUTED WITH HYDROMENT JOINT FILLER IN ACCORDANCE WITH MANUFACTURER'S INSTRUCTIONS AND SHALL BE DAMP CURED. THE TILE SHALL BE CLEANED OF SURFACE GROUT AS WORK PROCEEDS USING DRY GROUT AND BURLAP CLOTH. NO ACID CLEANER SHALL BE USED.
 - D. JOINTS IN WALL TILE SHALL BE GROUTED WITH HYDROMENT JOINT FILLER IN ACCORDANCE WITH MANUFACTURER'S INSTRUCTIONS AND SHALL BE DAMP CURED. THE TILE SHALL BE CLEANED OF SURFACE GROUT AS WORK PROCEEDS USING DRY GROUT AND BURLAP CLOTH. NO ACID CLEANER SHALL BE USED.
 - E. CLEAR SILICONE SEALANT AROUND PERIMETER TILE EDGES WHEN ABUTTING TO OTHER MATERIALS.

PERFORMANCE

- INSTALLATION:
 - A. INTERIOR CERAMIC WALL TILE SHALL BE INSTALLED IN ACCORDANCE WITH TILE COUNCIL METHOD W 243 GYPSUM BOARD OR GIBBOURTE PORTLAND CEMENT BOND MORTAR WITH HYDROMENT MATE 710 WITH FLEX-A-LESTIC ADDITIVE.
 - B. INTERIOR FLOOR TILE AND BASE SHALL BE INSTALLED IN ACCORDANCE WITH TILE COUNCIL METHOD F113 DRY SET MORTAR OR LATEX PORTLAND CEMENT MORTAR WITH HYDROMENT MATE 760 WITH FLEX-A-LESTIC ADDITIVE. IN ALL AREAS EXCEPT UNDER COUNTERSINKS, PUTTY SHALL BE APPLIED TO THE THICK SET METHOD AS DESCRIBED BELOW IN ITEM #2.
 - C. JOINTS IN FLOOR AND BASE JOINTS IN FLOORS AND BASE IN FOOD PREP, SUPPLY, SALES, UTILITY WASH, AND TOILETS TO BE INSTALLED IN ACCORDANCE WITH THE TILE COUNCIL METHOD OF DRY SET MORTAR WITH EPOXY GROUT IN LIEU OF CEMENT BASE GROUT. GROUT SHALL BE HYDROMENT V-POXY AARI. ALTERNATE "HYDROMENT JOINT FILLER" BY THE UPCO CO. IN ACCORDANCE WITH MANUFACTURER'S DIRECTIONS. JOINTS SHALL BE 1/4" WIDE AND COMPLETELY FILLED LEVEL WITH THE SHOULDER OF THE TILE AND THEN TOOLED TO A SMOOTH DENSE FINISH.
 - D. JOINTS IN WALL TILE SHALL BE GROUTED WITH HYDROMENT JOINT FILLER IN ACCORDANCE WITH MANUFACTURER'S INSTRUCTIONS AND SHALL BE DAMP CURED. THE TILE SHALL BE CLEANED OF SURFACE GROUT AS WORK PROCEEDS USING DRY GROUT AND BURLAP CLOTH. NO ACID CLEANER SHALL BE USED.
 - E. CLEAR SILICONE SEALANT AROUND PERIMETER TILE EDGES WHEN ABUTTING TO OTHER MATERIALS.

2. THICK-SET FLOOR INSTALLATION METHOD (OPTIONAL)

THICK-SET FLOOR INSTALLATION IN ACCORDANCE WITH TILE COUNCIL METHOD F112 CEMENT MORTAR MAY BE USED WITH 1/2" SETTING BED IN LIEU OF THIN-SET METHOD AT THE CONTRACTOR'S OPTION THROUGHOUT. PROVIDING FINISH FLOOR ELEVATIONS REMAIN AS SHOWN AND SLABS ARE DEPRESSED 2" TO COMPENSATE FOR 1 1/2" MINIMUM BED THICKNESS. FOR KITCHEN & RESTROOM AREAS ONLY (SEE ITEM 'C' ABOVE) SEE SHEET S-1 FOR DEPRESSED SLAB LOCATIONS WHERE THIS METHOD IS REQUIRED.

SECTION 9B: PAINTING

GENERAL PROVISIONS

- SCOPE: SUPPLY ALL LABOR, MATERIALS, AND EQUIPMENT NECESSARY FOR THE PROPER PAINTING AND FINISHING OF THE BUILDING.

MATERIALS

- PAINT BRANDS AND COLORS AS SHOWN IN THE FINISH SCHEDULE TO SHOW EXACT COLOR. ADHESIVE: MARLITE BRAND C-375 WATERPROOF ADHESIVE. THINNER, ETC., SHALL BE PER THE BEST QUALITY OBTAINABLE. ALL MATERIALS SHALL BE USED WITHOUT ALTERATIONS AND ONLY AS SPECIFIED BY THE PAINT MANUFACTURER.
- PUTTY AND FILLS SHALL BE AS RECOMMENDED BY THE PAINT MANUFACTURER.
- COVERING MATERIAL SHALL BE "MONO" ACRYLIC TERPOLYMER SEALANT. WHEN COLOR, BY TREMCO MANUFACTURING CO., CLEVELAND, OH. OR APPROVED EQUAL.

PERFORMANCE

- WORKMANSHIP: ALL SURFACES TO BE PAINTED SHALL BE CLEAN AND FREE OF DIRT, DUST, OR GRIT BEFORE PAINTING IS STARTED. PAINTING SHALL NOT BE DONE WHEN THERE IS SWEEPING OR EXCESSIVE DUST IN THE AIR. ALL PATCH STREAKS, RESIN, SPOTS, ETC., SHALL BE CLEANED OF ALL RESIDUE AND TOUCHED UP WITH SHELLAC BEFORE PAINTING. PUTTY ALL NAIL HOLES, CRACKS, ETC., IN WOODWORK AFTER THE FIRST COAT IS APPLIED. WHERE THE WOOD DOES NOT DRY TO A UNIFORM SHEEN OVER THE ENTIRE SURFACE, SPOT PRIME THE AREAS THAT INDICATE SUCTION BEFORE APPLYING FINISH COATS. UNDERCOATS OF PAINT SHALL BE TINTED TO A COLOR APPROXIMATING THE FINISH COATS, WITH ENOUGH VARIATION IN COLOR TO PERMIT VISUAL INSPECTION OF MATERIALS DURING THIS WORK. ALL MATERIALS SHALL BE EVENLY SPREAD AND FLOWED ON WITHOUT RUNS, SAP, OR EXCESSIVE BRUSH MARKS. LEVEL 4 DRYWALL FINISH MINIMUM.
- STEEL DOORS, FRAMES, GATES, PIPE GUARDS, LIGHT POLES, EXPOSED SIGN SUPPORTS, GAS PIPES, HANDRAILS, AND OTHER FREE-STANDING METAL ACCESSORIES:
 - A. PRE-PRIMED: TWO (2) ADDITIONAL COATS OF EXTERIOR ENAMEL BENJAMIN MOORE IRON CLAD #163 OVER FINELY-SANDED PRIMER. SEE FINISH SCHEDULE FOR COLOR.
 - B. BARE METAL: TWO (2) COATS BENJAMIN MOORE IRON CLAD #163 OVER TWO (2) COATS FINELY-SANDED METAL PRIMER. SEE FINISH SCHEDULE FOR COLOR.
 - NOTE: GAS PIPE SHALL BE PAINTED ONLY AFTER PRESSURE TESTED.
- ALUMINUM LIGHT POLES: POLES SHALL BE PROVIDED BY HERMITAGE LIGHTING AS A PART OF THEIR LIGHTING PACKAGE. THESE POLES COME PREFINISHED IN DARK BRONZE, AND IS INSTALLED BY THE SITE LIGHTING CONTRACTOR. CONCRETE POLES ARE ALLOWED IF REQUIRED BY THE LOCAL JURISDICTION, AND SHALL BE SEALED OR FINISHED ACCORDING TO THE LOCAL CODE.
- SIGN POLES: SIGN POLES SHALL BE PRIMED AND PAINTED WITH TWO COATS. REFER TO FINISH SCHEDULE FOR FINISH.

SECTION 9C: PREFINISHED PANELS

GENERAL PROVISIONS

SCOPE: FURNISH AND INSTALL PANELS AND MATCHING TRIM, INTERIOR PREFINISHED PANELS, TRIM, CORNER GUARDS, AND ACCESSORIES.

- NOTES: REFER TO NATIONAL ACCOUNT DIRECTORY.

MATERIALS

- MARLITE PLANKS AND TRIM, 16" X 8"-0" X 1/4". COLOR AND TEXTURE AS SHOWN ON FINISH SCHEDULE. ADHESIVE: MARLITE BRAND C-375 WATERPROOF ADHESIVE. CAULKING: MARLITE BRAND CAULKING.
- FIBERGLASS REINFORCED PANELS:
 - A. MARLITE TYPE 1200 TOS FRP PANELS, 4' X 8' X 0.10". AND MATCHING TRIM, CLASS C/111. (USE 10' LENGTHS FOR CEILINGS > 8') COLOR: SEE FINISH SCHEDULE. ADHESIVE: MARLITE BRAND C-375 WATERPROOF SOLVENT-BASED ADHESIVE. CAULKING: MARLITE SILICONE BRAND SEALANT.
 - B. WHERE REQUIRED BY CODE ONLY, FIRE-RATED FRP PANELS WITH CLASS A/1 ARE AVAILABLE FOR MARLITE.
- STAINLESS STEEL CORNER GUARDS:
 - A. EXTRA DUTY CORNER GUARDS AT OUTSIDE WALL CORNERS IN FOOD PREP, POT WASH, AND STORAGE AREAS AS SHOWN SHALL BE STAINLESS STEEL, AND SHALL EXTEND FROM TOP OF TILE BASE TO THE CEILING, WITH CONCEALED FASTENERS. CLEAR CAULK.

ACCEPTABLE MANUFACTURER:

PROVIDE ALL CORNER GUARDS FROM A SINGLE SOURCE.

MATERIALS

STAINLESS STEEL: CORNER GUARDS SHALL BE MANUFACTURED FROM TYPE 304, 16 GAUGE STAINLESS STEEL.

MARLITE PANELS:

- PERFORMANCE
- INSTALL MARLITE PANELS IN ACCORDANCE WITH MANUFACTURER'S INSTRUCTIONS. APPLY MATCHING TRIM BEFORE INSTALLING PANELS. FLUE UP PANELS ON GYPSUM BOARD, SETTING ALL PANELS INTO TRIM IN A BED OF CLEAR CAULK. USE MARLITE SOLVENT-BASED ADHESIVE. C-375 OR EQUAL APPROVED BY MANUFACTURER. DO NOT APPLY WHEN TEMPERATURE IS LESS THAN 40 DEGREES F. CAULK AROUND ALL JOINTS, TRIM, AND ABUTTING EDGES WITH CLEAR SILICONE.

SECTION 9G: LAMINATE WALLS

- FURNISH AND INSTALL PANELS PER MANUFACTURER'S INSTALLATION REQUIREMENTS. REFER TO FINISH SCHEDULE.
- APPLY LAMINATE TO 1/2" PLYWOOD SUBSTRATE AND ADHERE PANELS WITH MANUFACTURER'S RECOMMENDED GLUE AND ANCHORS.
- ALL JOINTS TO BE BUTTED TOGETHER.

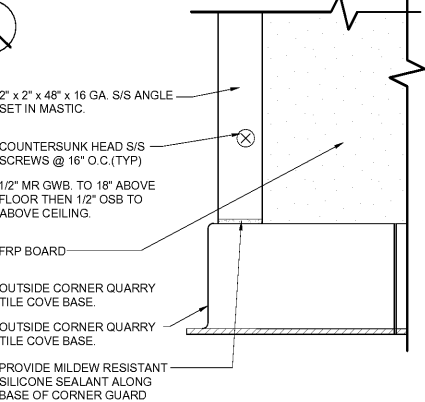

2 KITCHEN CORNER GUARD ELEVATION VIEW

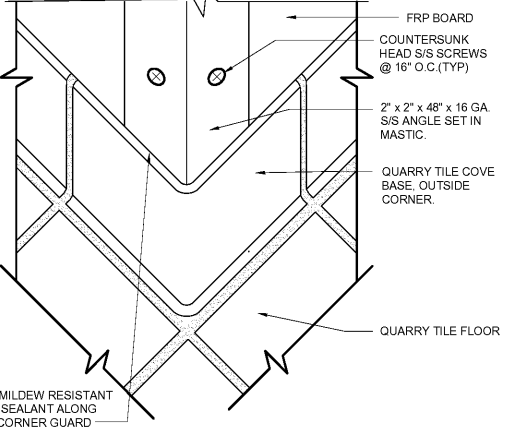

3 KITCHEN CORNER GUARD ISOMETRIC VIEW

DINING

- INTERIOR DOOR FINISH**
 EXTERIOR: POPEYES ARCHITECTURE ENGINEERING, PC
 INTERIOR: POPEYES ARCHITECTURE ENGINEERING, PC
 FINISH: POPEYES ARCHITECTURE ENGINEERING, PC
- WALL PAINTS**
 POPEYES ARCHITECTURE ENGINEERING, PC
 FINISH: POPEYES ARCHITECTURE ENGINEERING, PC
- NANTUCKET BEARBOARD - F-1**
 FINISH: POPEYES ARCHITECTURE ENGINEERING, PC
- BRICK VENEER - BR-1**
 FINISH: POPEYES ARCHITECTURE ENGINEERING, PC
- WINDYW GILLS**
 FINISH: POPEYES ARCHITECTURE ENGINEERING, PC
- DINING FLOOR**
 FINISH: POPEYES ARCHITECTURE ENGINEERING, PC

RESTROOM

- FINISH SCHEDULE**
 FINISH: POPEYES ARCHITECTURE ENGINEERING, PC
- FLOOR TILE - T-3**
 FINISH: POPEYES ARCHITECTURE ENGINEERING, PC
- FINISH SCHEDULE**
 FINISH: POPEYES ARCHITECTURE ENGINEERING, PC

KITCHEN

- FINISH SCHEDULE**
 FINISH: POPEYES ARCHITECTURE ENGINEERING, PC
- FINISH SCHEDULE**
 FINISH: POPEYES ARCHITECTURE ENGINEERING, PC
- FINISH SCHEDULE**
 FINISH: POPEYES ARCHITECTURE ENGINEERING, PC

INDEX SPECIFICATIONS

- METAL FSC CANOPY**
 FINISH: POPEYES ARCHITECTURE ENGINEERING, PC
- METAL WALLS AND CEILING DIVIDERS**
 FINISH: POPEYES ARCHITECTURE ENGINEERING, PC

GRAPHIC SPECIFICATIONS

- GRAPHICS - INTERIOR WALL GRAPHICS**
 FINISH: POPEYES ARCHITECTURE ENGINEERING, PC
- GRAPHICS - NEON GRAPHICS**
 FINISH: POPEYES ARCHITECTURE ENGINEERING, PC

LIGHTING SPECIFICATIONS

- LIGHTING**
 FINISH: POPEYES ARCHITECTURE ENGINEERING, PC
- COMMUNITY TABLE**
 FINISH: POPEYES ARCHITECTURE ENGINEERING, PC
- PERIMETER WALL BOOTHS**
 FINISH: POPEYES ARCHITECTURE ENGINEERING, PC
- DINING FSC RESTROOM (NOT SHOWN BY SCH)**
 FINISH: POPEYES ARCHITECTURE ENGINEERING, PC

SEATING SPECIFICATIONS

- SEATING**
 FINISH: POPEYES ARCHITECTURE ENGINEERING, PC
- SEATING & BAR SEATING**
 FINISH: POPEYES ARCHITECTURE ENGINEERING, PC
- TABLES**
 FINISH: POPEYES ARCHITECTURE ENGINEERING, PC
- MILLWORK**
 FINISH: POPEYES ARCHITECTURE ENGINEERING, PC
- FRANK COUNTER**
 FINISH: POPEYES ARCHITECTURE ENGINEERING, PC
- FRONT SERVICE COUNTER**
 FINISH: POPEYES ARCHITECTURE ENGINEERING, PC
- DRINK STATION**
 FINISH: POPEYES ARCHITECTURE ENGINEERING, PC
- FRONT SERVICE COUNTER**
 FINISH: POPEYES ARCHITECTURE ENGINEERING, PC
- METAL PANELS FOR METAL WALL CURB**
 FINISH: POPEYES ARCHITECTURE ENGINEERING, PC

LIGHTING

- LIGHTING**
 FINISH: POPEYES ARCHITECTURE ENGINEERING, PC

GRAPHICS

- METAL: LOVE THAT CHOPHEN SET**
 FINISH: POPEYES ARCHITECTURE ENGINEERING, PC

PROGRESSIVE ARCHITECTURE ENGINEERING, PC SHALL RETAIN ALL COMMON LAW, STATUTORY AND OTHER RESERVED RIGHTS, INCLUDING THE COPYRIGHT THEREIN, AND SHALL RETAIN ALL COMMON LAW, STATUTORY AND OTHER RESERVED RIGHTS, INCLUDING THE COPYRIGHT THEREIN.

progressive | ae
 PROGRESSIVE ARCHITECTURE ENGINEERING, PC
 330 South Tryon Street Suite 500 | Charlotte, NC 28202 | 704.731.8880 | www.progressiveae.com



Popeyes

LEBLON FRANCHISING HOLDINGS, LLC.
POPEYES'S
 LOUISIANA KITCHEN
 921 CONCORD PARKWAY SOUTH,
 CONCORD, NC, 28027

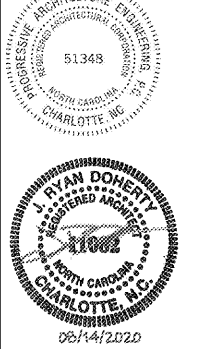

FOR CONSTRUCTION

If this document is sealed and signed in a digital or electronic format and is received from someone other than the sealing professional identified in the document, you must contact the sealing professional in writing to validate authenticity of the document. The sealing professional disclaims the seal and signature and shall not be liable for any liability associated with it where the authenticity of any digital or electronic seal or signature has not been validated in this manner.

ISSUANCE PERMIT SUBMITTAL 08/14/2020

NO.	DATE	DESCRIPTION
1		

FILE NUMBER: 86560010
 PROJECT MANAGER: DRG
 PROFESSIONAL: JRD
 DRAWN BY: DRG
 CHECKED BY: DS

FINISH PLAN
A2