

CONCORD PARKWAY SOUTH (US HWY. 29)  
120' PUBLIC R/W  
(NCDOT REF. PROJECT #6587)  
MB. 61-54

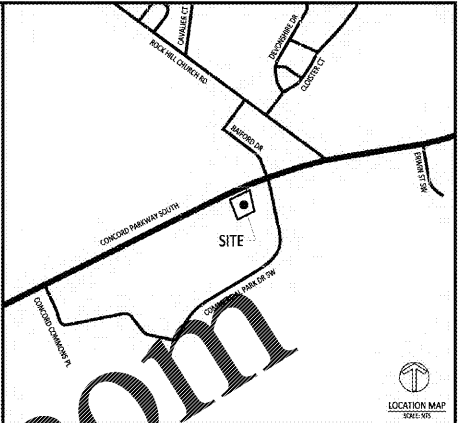

**STIPULATION FOR REUSE**  
THIS DRAWING WAS PREPARED FOR USE ON THE SPECIFIC SITE, NAMED HEREON, CORRESPONDINGLY WITH ITS ISSUE DATE AS LISTED, HEREON AND IT IS NOT SUITABLE FOR USE ON A DIFFERENT PROJECT SITE OR AT A LATER TIME. USE OF THIS DRAWING FOR REFERENCE OR EXAMPLE ON ANOTHER PROJECT REQUIRES THE SERVICES OF PROPERLY LICENSED ARCHITECTS AND ENGINEERS. REPRODUCTION OF THIS DRAWING FOR REUSE ON ANOTHER PROJECT IS NOT AUTHORIZED AND MAY BE CONTRARY TO THE LAW.

POPEYE'S  
915 CONCORD PARKWAY SOUTH  
CONCORD, NC 28027

**MODIFICATION LOG**

NO.	DATE	DESCRIPTION

JOB NUMBER: C200030  
CHECKED BY: CMJ  
DRAWN BY: CDA  
DATE: 8-19-2020

AMERICAN Engineering  
American Engineering Associates - Southeast, P.A.  
8009 Corporate Center Dr., Suite 110  
Charlotte, NC 28226  
704-375-4438  
FIRM # C-3981

EXISTING CONDITIONS

SHEET: C2.1

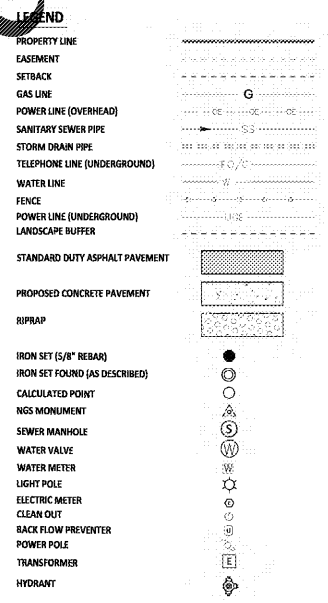

**NOTES**

- TOPOGRAPHIC AND BOUNDARY INFORMATION TAKEN FROM A SURVEY "ALTA/NSPS LAND TITLE SURVEY" LOCATED IN 921 CONCORD PARKWAY SOUTH CITY OF CONCORD - CABARRUS CO. - NC. PREPARED BY LAWRENCE J. WHITAKER, NCPLS No. L-4538, OF GPA PROFESSIONAL LAND SURVEYORS DATED 05/20/2020.

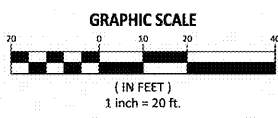
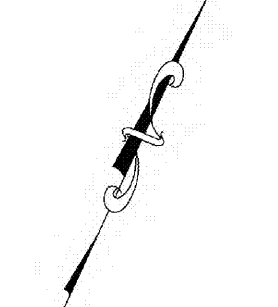

**North 811**  
Carolina  
\*\*\* 3 Days Before Digging \*\*\*  
North Carolina 811  
811 or 1-800-632-4999  
Remove Ticket Entry  
<http://nc811.org/owners/industry.htm>

Order Plans @ [www.LDILine.com](http://www.LDILine.com)