

These drawings are the property of Watson Tate Savory, Inc. and may not be used in whole or in part without written consent of the architect and any copyright is subject to legal action.

8/21/2024 4:45:34 PM B:\19-20653\Jordan Hall\1911\NCSU Jordan Hall - A19.rvt

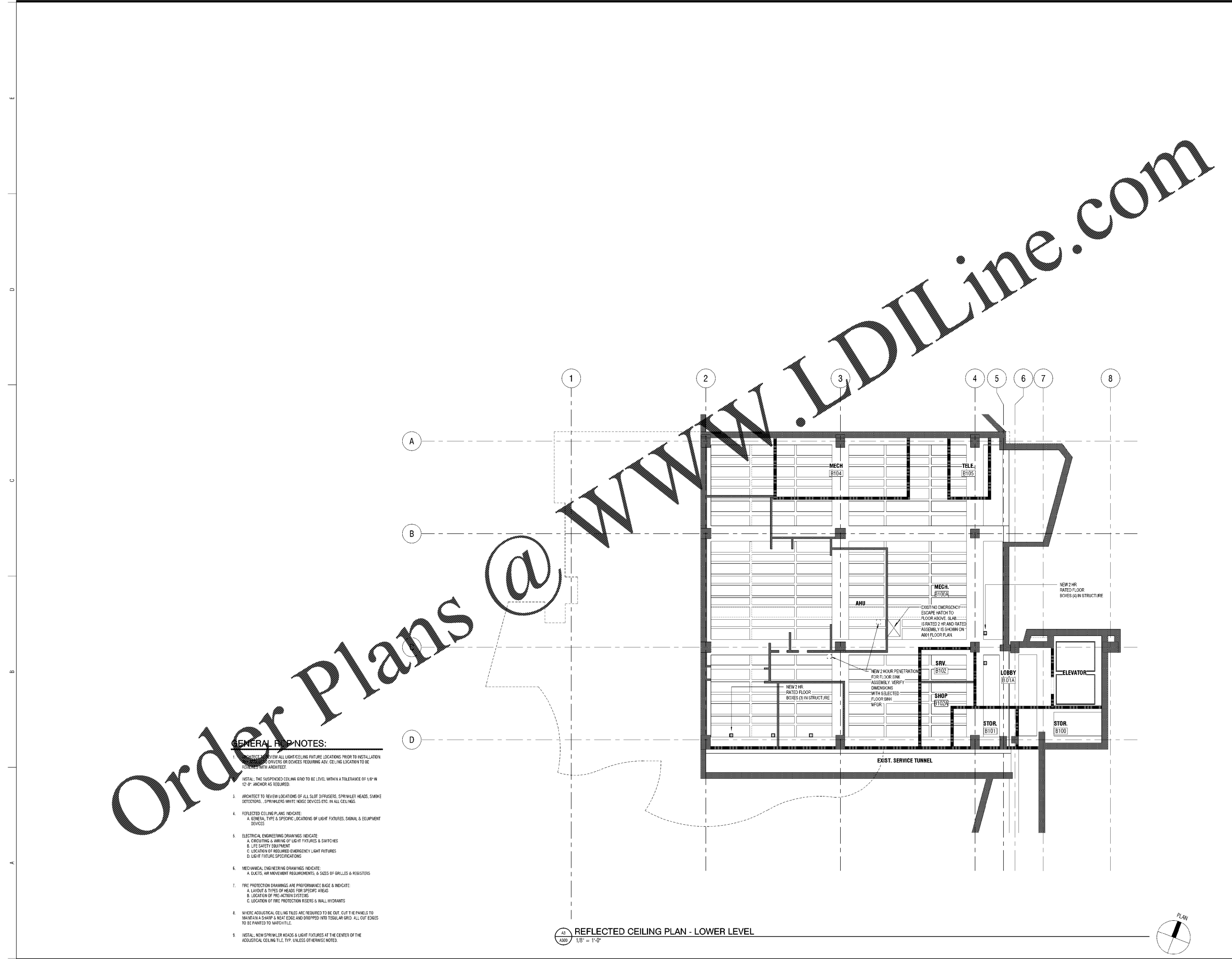

- GENERAL NOTES:**
1. CONTRACTOR TO REVIEW ALL LIGHT FIXTURE LOCATIONS PRIOR TO INSTALLATION AND VERIFY ALL DRIVERS OR DEVICES REQUIRING ADV. CEILING LOCATION TO BE PROVIDED BY ARCHITECT.
 2. INSTALL THE SUSPENDED CEILING GRID TO BE LEVEL WITHIN A TOLERANCE OF 1/8" IN 12'-0" ANCHOR AS REQUIRED.
 3. ARCHITECT TO REVIEW LOCATIONS OF ALL SLOT DIFFUSERS, SPRINKLER HEADS, SMOKE DETECTORS, SPRINKLER WHIRL NOISE DEVICES ETC. IN ALL CEILINGS.
 4. REFLECTED CEILING PLANS INDICATE:
 - A. GENERAL TYPE & SPECIFIC LOCATIONS OF LIGHT FIXTURES, SIGNAL & EQUIPMENT DEVICES.
 5. ELECTRICAL ENGINEERING DRAWINGS INDICATE:
 - A. CIRCUITING & WIRING OF LIGHT FIXTURES & SWITCHES.
 - B. LIFE SAFETY EQUIPMENT.
 - C. LOCATION OF REQUIRED EMERGENCY LIGHT FIXTURES.
 - D. LIGHT FIXTURE SPECIFICATIONS.
 6. MECHANICAL ENGINEERING DRAWINGS INDICATE:
 - A. DUCTS, AIR MOVEMENT REQUIREMENTS, & SIZES OF GRILLES & REGISTERS.
 7. FIRE PROTECTION DRAWINGS ARE PERFORMANCE BASE & INDICATE:
 - A. LAYOUT & TYPES OF HEADS FOR SPECIFIC AREAS.
 - B. LOCATION OF FIRE ACTION SYSTEMS.
 - C. LOCATION OF FIRE PROTECTION RISERS & WALL HYDRANTS.
 8. WHERE ADJUSTABLE CEILING TILES ARE REQUIRED TO BE CUT, CUT THE PANELS TO MAINTAIN A SHARP & NEAT EDGE AND DROPPED INTO TEGULAR GRID. ALL CUT EDGES TO BE PAINTED TO MATCH TILE.
 9. INSTALL NEW SPRINKLER HEADS & LIGHT FIXTURES AT THE CENTER OF THE ADJUSTABLE CEILING TILE, TYP. UNLESS OTHERWISE NOTED.

A3 REFLECTED CEILING PLAN - LOWER LEVEL 1/8" = 1'-0"



Order Plans @ www.LDILine.com

ARCHITECTURE
INTERIORS
PLANNING

WTS
WATSON TATE SAVORY

NC STATE
UNIVERSITY

LIBRARY RENOVATION - JORDAN HALL
N.C. STATE UNIVERSITY
RALEIGH, NC



ISSUE DATE: 08/24/2020
PHASE: BID SET

#	DATE	REVISION

REFLECTED
CEILING PLANS -
LOWER LEVEL

19-20653
STATE PROJECT NO.
NCSU #201920018
A/E PROJECT NO.
058
NCSU FACILITIES NO. SHEET

A300