

These drawings are the property of Watson Tate Savory, Inc. and may not be used, in whole or in part, without the written consent of the architect and any management is subject to legal action.

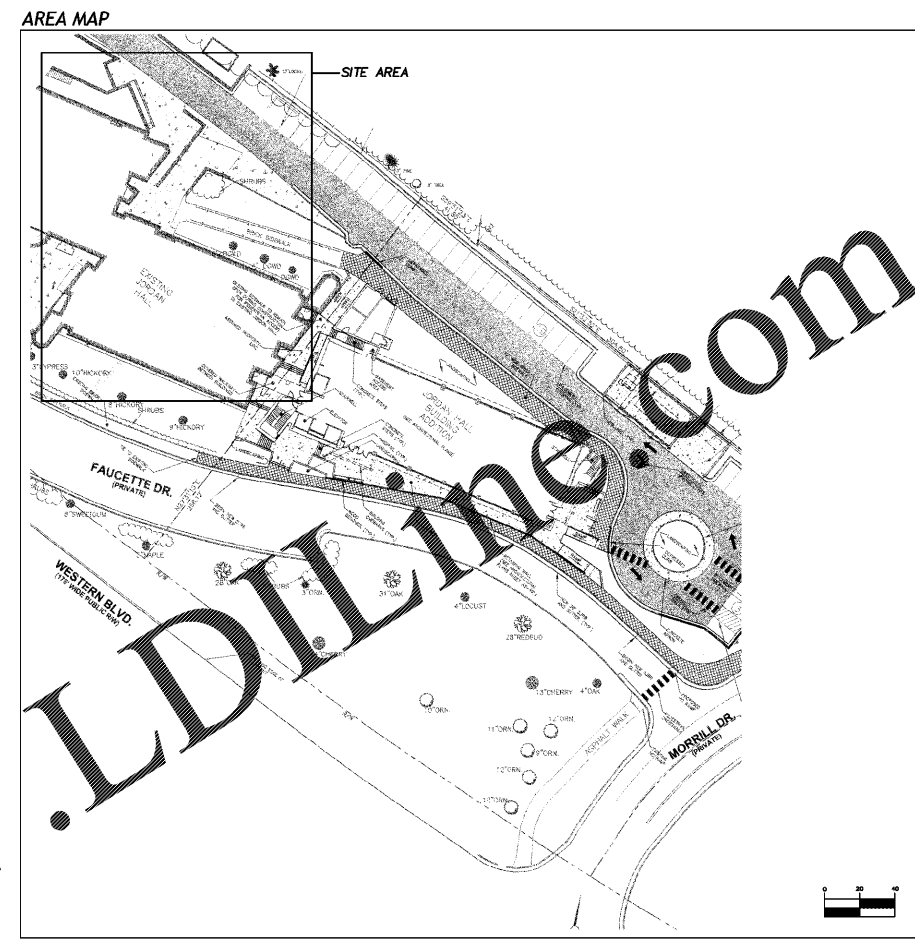
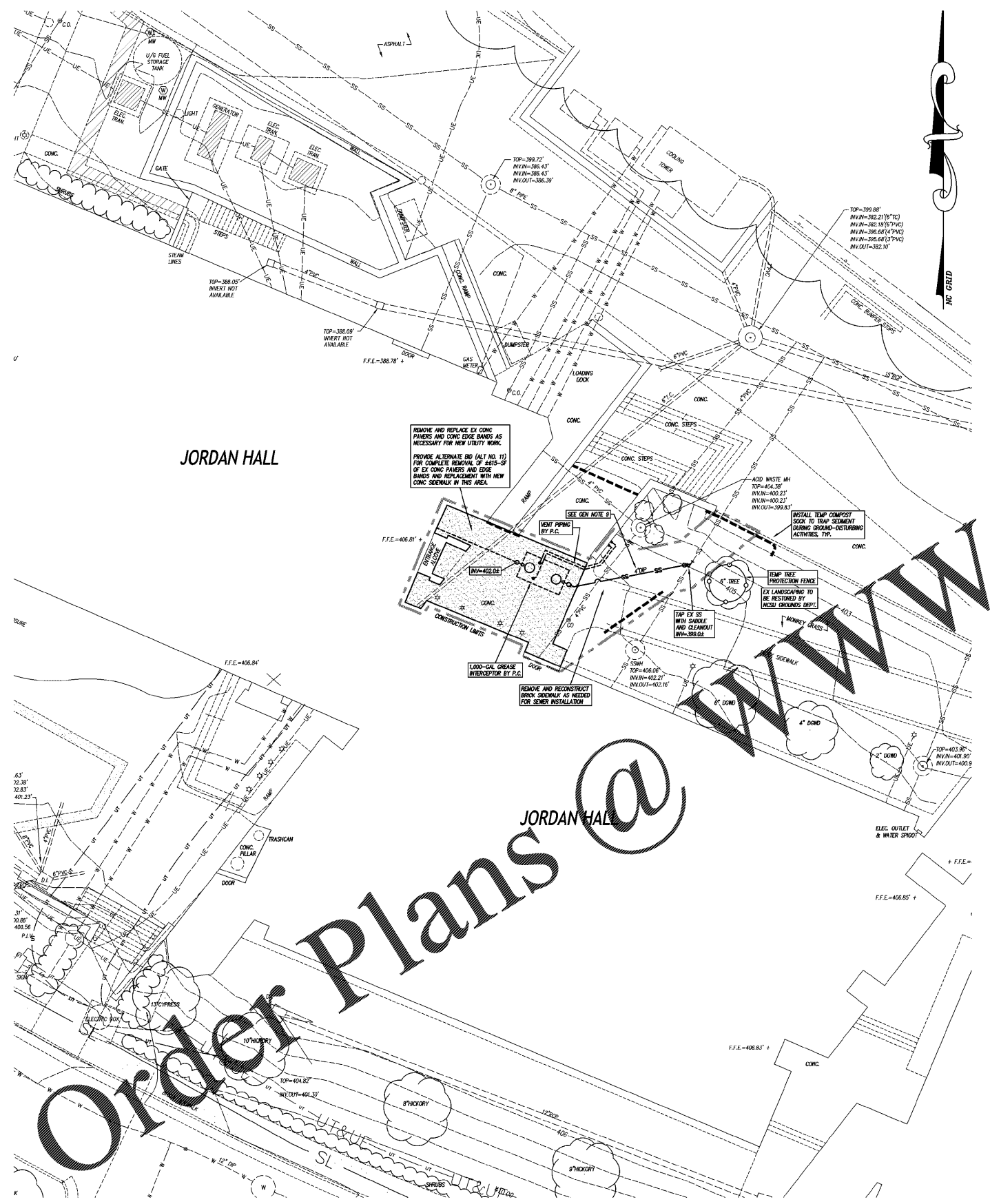

LDIline.com

Order Plans @

LEGEND

	EXISTING	PROPOSED
ELECT. (OVERHEAD)	— E —	— E —
ELECT. (UNDERGROUND)	— UE —	— UE —
CHILLED WATER	— CW —	— CW —
STEAM	— ST —	— ST —
SANITARY SEWER	— SS —	— SS —
UNDERGROUND TELEPHONE	— UT —	— UT —
WATER	— W —	— W —
STORM DRAIN	— SD —	— SD —
LIGHT POLE	☆ LP	☆ LP
LIGHT BOLLARD	☆	☆
UTILITY POLE	⊙ UP	⊙ UP
MANHOLE	⊙ MH	⊙ MH
CLEAN OUT	⊙ CO	⊙ CO
DROP INLET/CATCH BASIN	□ CB	□ CB
WATER VALVE	⊙ WV	⊙ WV
TEMP COMPOST SOOK, SEE C201	—	—
TEMP TREE PROTECTION FENCE, SEE C201	—	—
CONSTRUCTION LIMITS	—	—

- GENERAL NOTES**
- DISTURBED AREA - 1,300-SF (0.03-AC)
 - ALL CONSTRUCTION SHALL BE IN ACCORDANCE WITH ALL NCSU STANDARDS AND NONC AND CONN. REQUIREMENTS.
 - ALL EXISTING VAULTS, MANHOLES, STORM DRAIN STRUCTURES, VALVE BOXES, CLEANOUTS, ETC. WITHIN THE LIMITS OF CONSTRUCTION SHALL BE ADAPTED AS NEEDED TO MATCH FINISHED GRADE.
 - ALL BACKFILL, COMPACTION, SOILS TESTING, ETC. SHALL BE PERFORMED BY THE OWNER'S INDEPENDENT TESTING LABORATORY.
 - ALL PAVED SURFACES ADJACENT TO PROJECT SHALL BE KEPT CLEAN AT ALL TIMES OR A WASH STATION SHALL BE PROVIDED.
 - THE CONTRACTOR SHALL PROVIDE AN AS-BUILT SURVEY OF UTILITY IMPROVEMENTS FOLLOWING INSTALLATION.
 - REPAIR OF SURFACES, INCLUDING PAVEMENT PATTERNING, SHALL BE INCLUDED IN BASE BID FOR UTILITY INSTALLATIONS.
 - ALL UNDERGROUND UTILITY LINES OUTSIDE OF THE BUILDING FOOTPRINT, EXCEPT LAWN IRRIGATION LINES, SHALL BE PROVIDED WITH ELECTRICALLY OPERATED WARNING TAPE INSTALLED AT A DEPTH OF 12-24 INCHES BELOW FINISH GRADE DIRECTLY OVER PIPING.
 - WARNING TAPES SHALL BE MIN. 3-IN WIDE WITH LETTERING TO IDENTIFY BURIED LINE BELOW.
 - AN INSULATED COPPER TRAZER WIRE OR OTHER APPROVED CONDUCTOR SHALL BE INSTALLED ADJACENT TO UNDERGROUND NON-METALIC GAS LINES. ACCESS SHALL BE PROVIDED TO THE TRAZER WIRE OR THE TRAZER WIRE SHALL TERMINATE ABOVE-GROUND AT THE END OF THE NON-METALIC PIPING. THE TRAZER WIRE SIZE SHALL BE NOT LESS THAN 18-AWG AND THE INSULATION TYPE SHALL BE SUITABLE FOR DIRECT BURIAL.
 - INSTALL NEW SANITARY SEWER LINE AT 1.04% MIN SLOPE WITH 24-IN OF MIN COVER. INSTALL WITH 12-IN MIN VERTICAL SEPARATION AT CROSSING OF EX. ACID WASTE LINE. COORDINATE CONNECTION TO GREASE INTERCEPTOR WITH P.C. INVERTS OF NEW SEWER LINE ARE APPROXIMATE AND SHALL BE CONFIRMED IN THE FIELD PRIOR TO INSTALLATION.

- DEMOLITION NOTES**
- INSTALL TEMP COMPOST SOOKS AND TREE PROTECTION FENCING PRIOR TO BEGINNING ANY GROUND DISTURBANCE. LIMIT GROUND DISTURBANCE TO ONLY AREAS NECESSARY TO PERMIT NEW CONSTRUCTION.
 - DEMOLITION AND PAVING OF SIDEWALKS, PATIERS AND OTHER EXISTING PAVED SURFACES, IN ADDITION TO THAT INDICATED ON THIS PLAN, SHALL BE PERFORMED AS NECESSARY TO CONSTRUCT NEW WORK AND INSTALL NEW UTILITIES. ALL SUCH DEMOLITION AND PAVING SHALL BE INCLUDED IN THE BASE BID SCOPE OF WORK.
 - ALL CONCRETE TO BE REMOVED SHALL BE SAW CUT AT AN EXISTING JOINT TO PROVIDE A STRAIGHT AND UNIFORM JOINT FOR NEW PAVEMENT. REPAIR FOR THE SPECIFICATIONS AND DETAILS OR TO MATCH PRE- CONSTRUCTION CONDITIONS, WHICHEVER IS MORE STRINGENT.
 - CONCRETE AND BRICK PATIERS TO BE REMOVED AND REINSTALLED SHALL BE HANDED WITH EXTREME CARE TO AVOID DAMAGE. DAMAGED PATIERS SHALL BE REPLACED WITH NEW PATIERS TO MATCH EXISTING PATIERS. PATIERS SHALL BE REINSTALLED TO MATCH EXISTING CONDITIONS WITH REGARD TO SUBGRADE AND JOINTS.
 - ALL WASTE MATERIAL GENERATED FROM DEMOLITION ACTIVITIES SHALL BE DISPOSED OF OR RECYCLED OFF-SITE IN ACCORDANCE WITH ALL APPLICABLE RULES AND REGULATIONS. TRASH AND DEBRIS SHALL BE CONTAINED ON-SITE AND CLEARED-UP AT THE END OF EACH WORK DAY. UNDEVELOPED CONCRETE SHALL BE RESEGREGATED AND RECYCLED. EXCESS UNHARMED BRICK, NOT REUSED, SHALL BE PALLETIZED AND DELIVERED TO NCSU FACILITY WITHIN 5-MILE RADIUS OF SITE.
 - EXTREME CARE SHALL BE TAKEN TO PROTECT TREES AND LANDSCAPING TO REMAIN. CONTACT THE NCSU CAMPUS ARBORIST IN ADVANCE OF ANY EXCAVATION NEAR TREES.
 - VERIFY EXISTING CONDITIONS, CONNECTIONS AND CROSSING OF EXISTING UTILITIES, AND ALL ILLUSTRATED UNDERGROUND ELEMENTS. EXERCISE REASONABLE EFFORTS TO PROTECT ANY UNKNOWN UNDERGROUND ELEMENTS. NOTIFY THE ARCHITECT IMMEDIATELY IF UNKNOWN ELEMENTS ARE DISCOVERED THAT WOULD NECESSITATE MODIFICATION TO THE PROPOSED DESIGN. CONTACT NC-811 UTILITY LOCATING SERVICE AT LEAST 48-HRS PRIOR TO EXCAVATION.
 - ALL EXISTING VAULT TOPS, VALVE BOXES, CLEANOUTS, MANHOLES, STORM DRAIN STRUCTURES, ETC. WITHIN THE PROJECT LIMITS SHALL BE ADAPTED AS NEEDED TO MATCH NEW FINISH GRADES.
 - PROTECT ALL ADJACENT FACILITIES FROM DAMAGE DURING CONSTRUCTION. SHOULD DAMAGES OCCUR, REPAIR IMMEDIATELY AS DIRECTED BY THE ARCHITECT. TRADE CONTRACTOR WHO CAUSES DAMAGE TO EXISTING PROPERTY DURING CONSTRUCTION SHALL BE RESPONSIBLE FOR REPAIRS AT NO EXPENSE TO THE OWNER.
 - PROTECT ALL EXISTING BRICK OR CONCRETE WALKWAYS OR OTHER VULNERABLE SURFACES TO REMAIN WITH PLANKS OR TRACK MATS WHEN WORKING AROUND THESE ELEMENTS. PLYWOOD SHALL BE PLACED UNDER ANY CONSTRUCTION DUMPSTERS OR OTHER SIMILAR STORAGE CONTAINERS PLACED ON PAVED SURFACES IN ACCORDANCE WITH NCSU CONSTRUCTION GUIDELINES.
 - ACCESS TO LOADING ZONES AND DUMPSTERS SHALL REMAIN OPEN DURING CONSTRUCTION.
 - EXISTING SITE SURVEY INFORMATION WAS PROVIDED BY AL PRINCE & ASSOC., DATED 9/10/2020. THE DESIGNER ASSUMES NO LIABILITY FOR ANY EXISTING INFORMATION BOTH SHOWN AND NOT SHOWN ON THE PLAN. CONTRACTOR SHALL VERIFY ALL EXISTING SITE CONDITIONS PRIOR TO DEMOLITION AND CONSTRUCTION.
 - THIS SITE IS NOT LOCATED WITHIN ANY SPECIAL FLOOD HAZARD AREAS AS DETERMINED BY FEMA AND DEPICTED ON FEMA MAP #37207A300A DATED MAY 2, 2006.

- SCOPE OF LANDSCAPE WORK**
- THE GENERAL CONTRACTOR SHALL BE RESPONSIBLE FOR GRADING DISTURBED SURFACES OF SITE TO SUBGRADE ELEVATIONS IN LANDSCAPED AREAS. EXISTING SURFACES SHALL BE SET 3-IN BELOW THE FINISH GRADES.
 - THE GENERAL CONTRACTOR SHALL BE RESPONSIBLE FOR THE INSTALLATION, MAINTENANCE AND MAINTENANCE OF TEMPORARY SEEDING AS NEEDED FOR EROSION CONTROL.
 - THE GENERAL CONTRACTOR SHALL FURNISH AND INSTALL 3-IN OF IMPORTED TOPSOIL ON TOP OF GRADED SUBGRADE IN ALL LAWN, SOIL, MULCH AND LANDSCAPE AREAS AND SHALL PERFORM SEEDING PREPARATION AS OUTLINED ON C201.
 - THE OWNER WILL FURNISH AND INSTALL PERMANENT LAWN SEEDING, SOIL, ALL LANDSCAPE PLANT MATERIAL, AND LANDSCAPE MULCH.

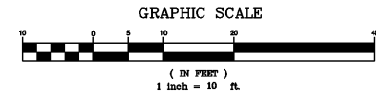

ARCHITECTURE
INTERIORS
PLANNING

WTS
WATSON TATE SAVORY

NC STATE UNIVERSITY

CLH DESIGN
CLH Design, PA
200 Lehigh Valley Forest Dr.
Suite 120
Corry, NC 27611
Phone: 818.319.8718
Fax: 818.319.7818
Lic. # 106, PE # 2-1988

LIBRARY RENOVATION - JORDAN HALL
N.C. STATE UNIVERSITY
RALEIGH, NC



ISSUE DATE: 08.24.2020
PHASE: Bid Set

#	DATE	REVISION

SITE PLAN

19-20653
STATE PROJECT NO.
NCSU #201920018
A/E PROJECT NO.
058
NCSU FACILITIES NO. SHEET

C101