

THIS DRAWING AND THE DESIGN SHOWN THEREON ARE THE PROPERTY OF JEFF LEWIS, AIA. THE REPRODUCTION, COPYING OR OTHER USE OF THIS DRAWING WITHOUT WRITTEN CONSENT OF JEFF LEWIS AIA IS PROHIBITED AND INFRINGEMENTS WILL BE SUBJECT TO LEGAL ACTION.

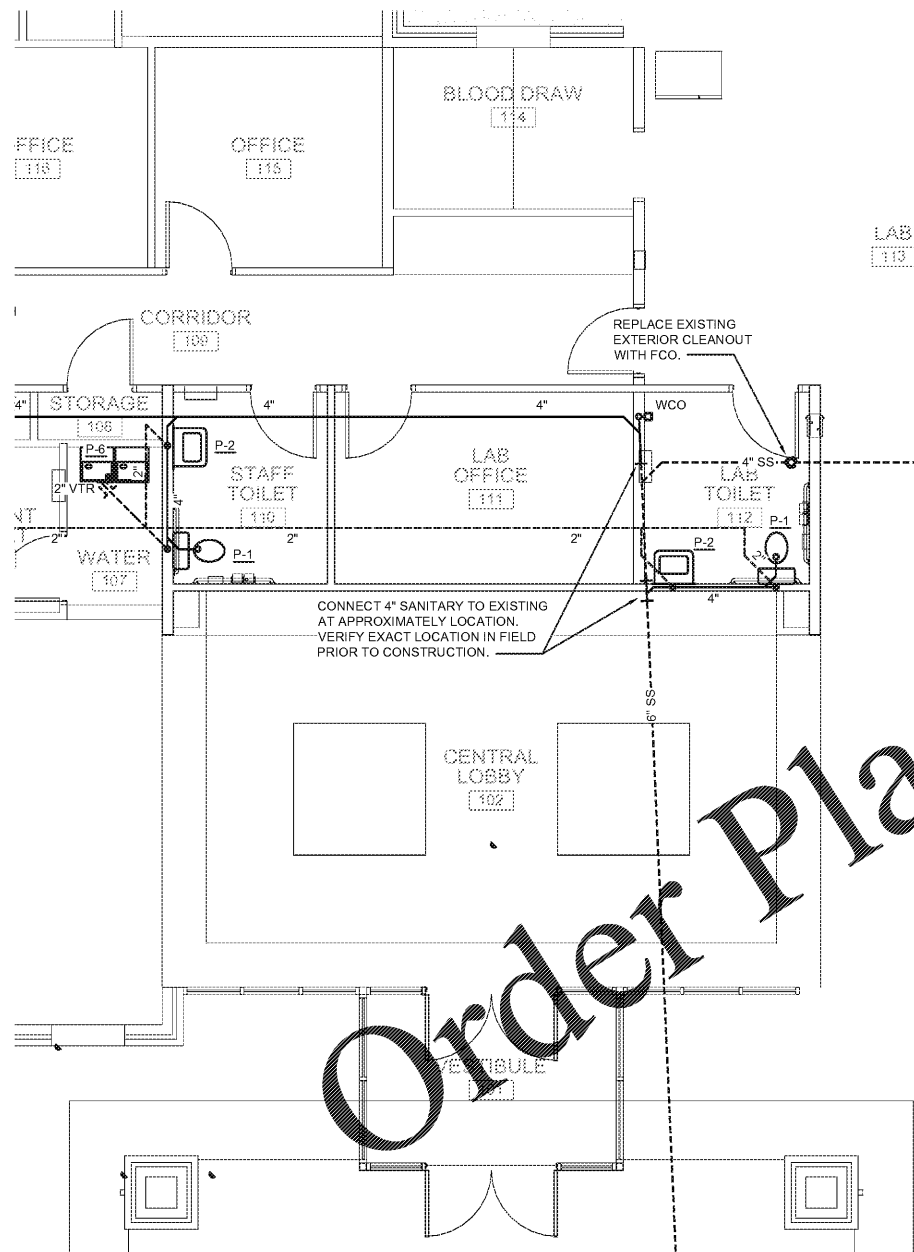

1 ENLARGED FIRST FLOOR PLUMBING PLAN - WASTE & VENT
P205 1/4" = 1'-0"

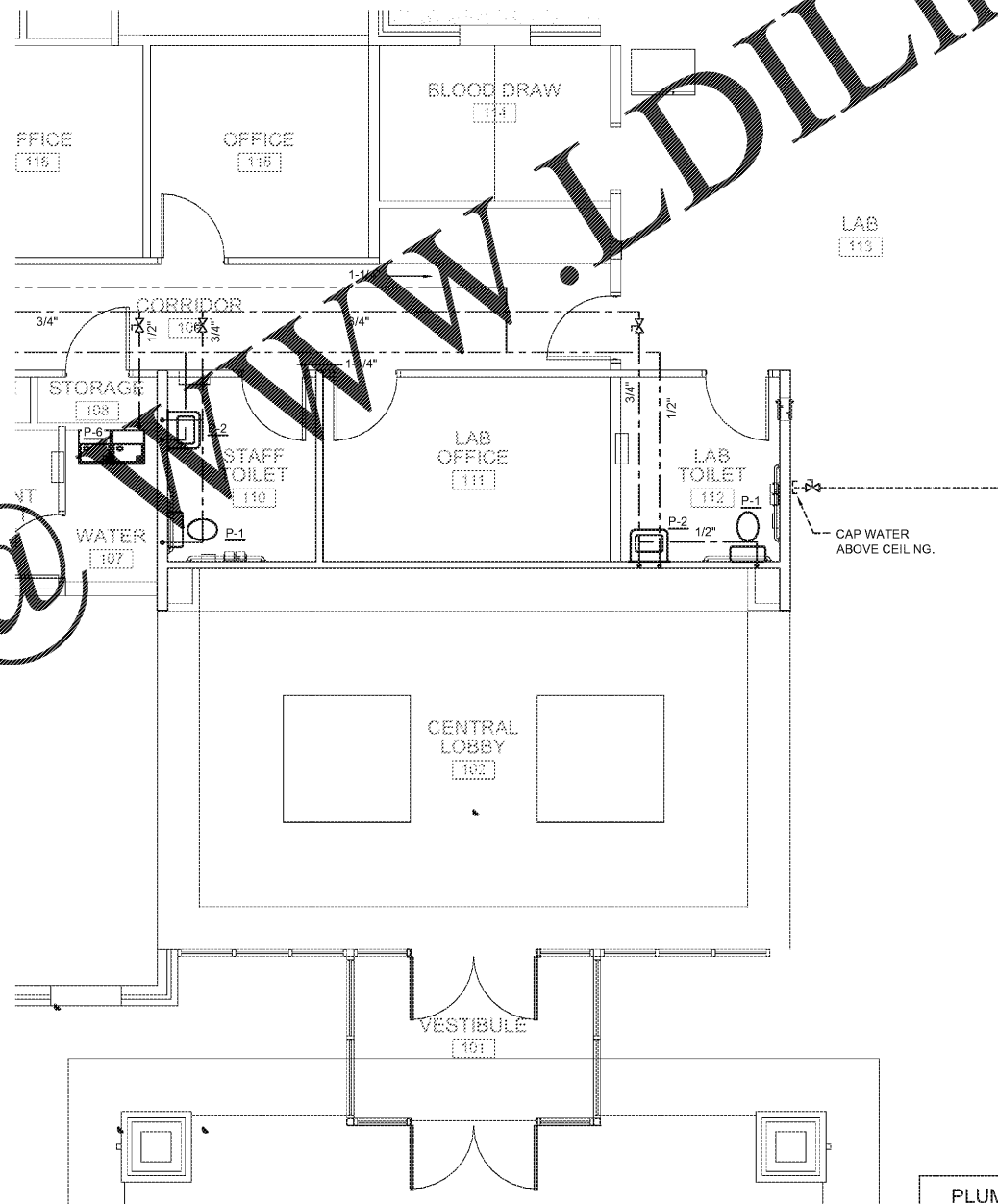

2 ENLARGED FIRST FLOOR PLUMBING PLAN - WATER SUPPLY
P205 1/4" = 1'-0"

PLUMBING LINETYPE LEGEND	
	NEW SANITARY SEWER PIPING
	NEW VENT PIPING
	NEW COLD WATER PIPING
	NEW HOT WATER PIPING
	NEW GAS PIPING

PLUMBING LINETYPE LEGEND	
	NEW SANITARY SEWER PIPING
	NEW VENT PIPING
	NEW COLD WATER PIPING
	NEW HOT WATER PIPING
	NEW GAS PIPING

MECA
Mechanical Engineering
Consulting Associates, Inc.

Columbia Office
P.O. Box 50644
Columbia, South Carolina
Phone: (803) 765-9421

Designed: MAB
Approved: PPC
Job No: 116241L
Plot Date: 08/21/2019

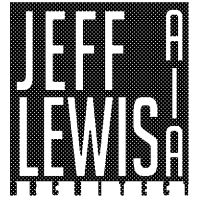

561 JACOBS MILL POND ROAD
ELGIN, SOUTH CAROLINA 29045
803.960.5026 / jeff@jefflewis.com

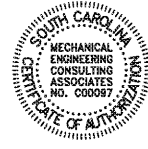

LUGOFF FACILITY EXPANSION
SANDHILLS MEDICAL FOUNDATION
28 BALDWIN AVENUE
LUGOFF, SOUTH CAROLINA 29078

REV.	DATE	DESCRIPTION

JOB #: 16-009-1 07.15.2019

P205

ENLARGED FIRST FLOOR PLUMBING PLAN - WASTE & VENT