

THIS DRAWING AND THE DESIGN SHOWN THEREON ARE THE PROPERTY OF JEFF LEWIS, AIA. THE REPRODUCTION, COPYING OR OTHER USE OF THIS DRAWING WITHOUT WRITTEN CONSENT OF JEFF LEWIS AIA IS PROHIBITED AND INFRINGEMENTS WILL BE SUBJECT TO LEGAL ACTION.

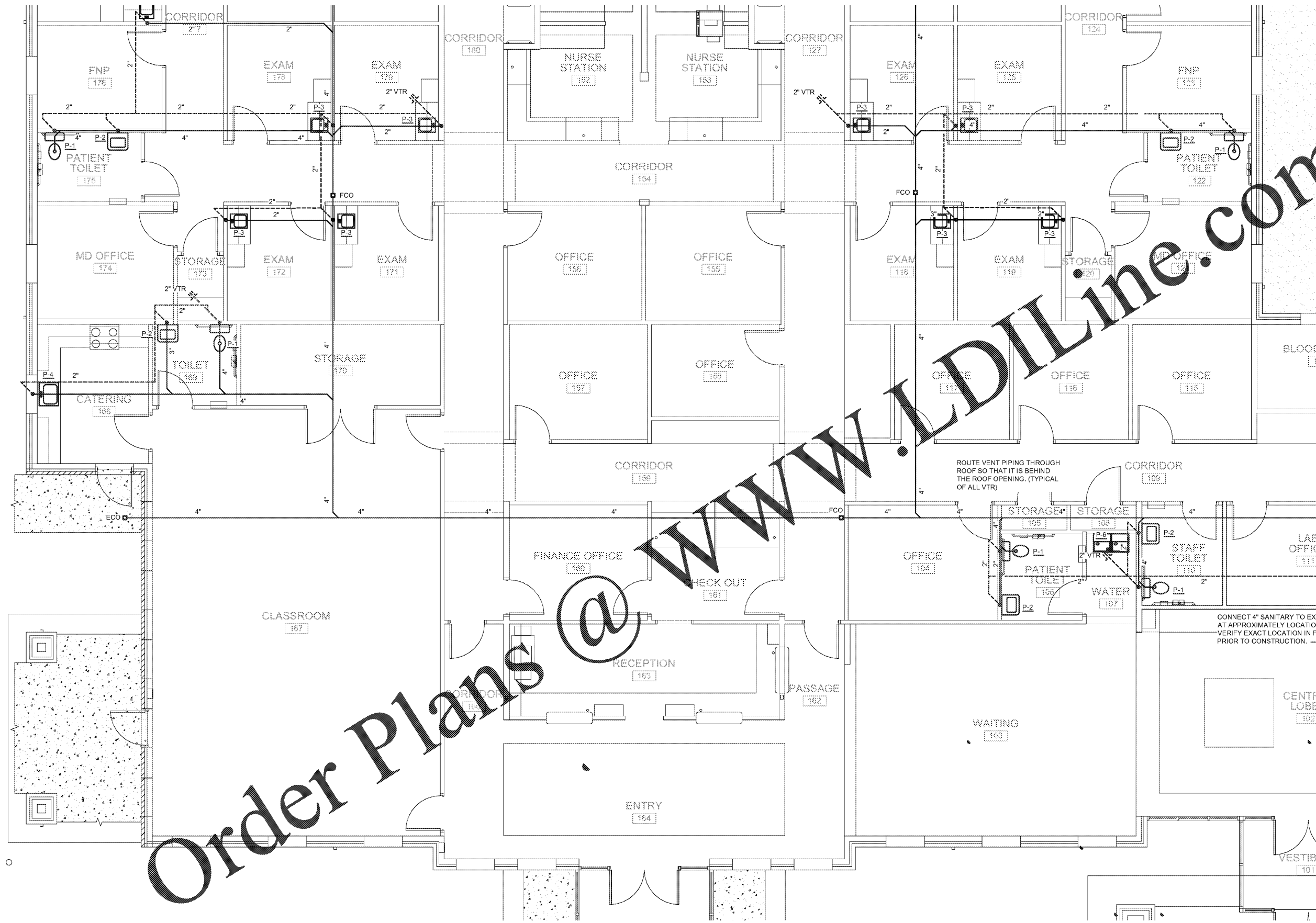

1 ENLARGED FIRST FLOOR PLUMBING PLAN - WASTE & VENT
P203 1/4" = 1'-0"

| PLUMBING LINETYPE LEGEND | |
|--------------------------|---------------------------|
| | NEW SANITARY SEWER PIPING |
| | NEW VENT PIPING |
| | NEW COLD WATER PIPING |
| | NEW HOT WATER PIPING |
| | NEW GAS PIPING |



Columbia Office
P.O. Box 50644
Columbia, South Carolina
Phone: (803) 765-9421

Designed: MAB
Approved: PPC
Job No: 116241L
Plot Date: 08/21/2019

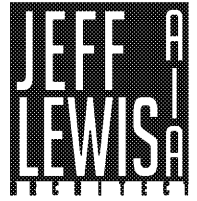

561 JACOBS MILL POND ROAD
ELGIN, SOUTH CAROLINA 29045
803.960.5026 / jeff@jefflewis.com



LUGOFF FACILITY EXPANSION
SANDHILLS MEDICAL FOUNDATION

28 BALDWIN AVENUE
LUGOFF, SOUTH CAROLINA 29078

| REV. | DATE | DESCRIPTION |
|------|------|-------------|
| | | |
| | | |
| | | |

JOB #: 16-009-1 07.15.2019

P203

ENLARGED FIRST FLOOR PLUMBING PLAN - WASTE & VENT