

THIS DRAWING AND THE DESIGN SHOWN THEREON ARE THE PROPERTY OF JEFF LEWIS, AIA. THE REPRODUCTION, COPYING OR OTHER USE OF THIS DRAWING WITHOUT WRITTEN CONSENT OF JEFF LEWIS AIA IS PROHIBITED AND INFRINGEMENTS WILL BE SUBJECT TO LEGAL ACTION.

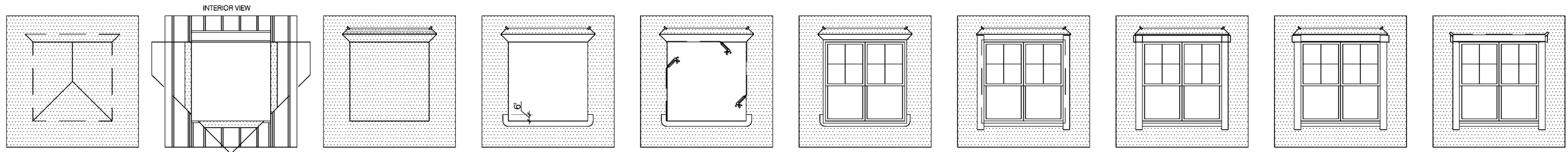

- 1. AT EACH OPENING CUT A MODIFIED "I" IN THE ENVIRONMENTAL BUILDING WRAP
- 2. FOLD SIDE AND BOTTOM FLAPS INTO OPENING AND SECURE EVERY 6". TRIM ANY EXCESS MATERIAL
- 3. CUT THE ENVIRONMENTAL BUILDING WRAP AT A 45° ANGLE FROM THE HEAD, FOLD UP AND TEMPORARILY TAPE.
- 4. APPLY FLEXIBLE SELF-ADHESIVE MEMBRANE AT THE SILL AND EXTEND UP JAMB 6" MIN.
- 5. CAULK THE ROUGH OPENING AT THE HEAD AND JAMB. POSITION SUCH THAT WINDOW FLANGE WILL CONTACT. DO NOT CAULK ACROSS THE BOTTOM OF THE ROUGH OPENING
- 6. INSTALL WINDOW PER MANUFACTURER'S INSTRUCTIONS
- 7. APPLY SELF-ADHESIVE MEMBRANE AT JAMB OVER WINDOW FLANGE
- 8. APPLY SELF-ADHESIVE MEMBRANE AT HEAD OVER WINDOW FLANGE
- 9. INSTALL HEAD FLASHING OVER WINDOW
- 10. FOLD ENVIRONMENTAL BUILDING WRAP OVER HEAD FLASHING AND TAPE WITH SELF-ADHESIVE MEMBRANE AT 45° ON SIDES. FIRST THE TAPE ACCESS FLASHING

1 BUILDING WRAP MODIFIED "I-CUT" @ WINDOW INSTALLATION
 A412 N.T.S. NOTE: WINDOW SHOWN FOR DEMONSTRATION PURPOSES ONLY & DOES NOT REFLECT ACTUAL WINDOW TYPE

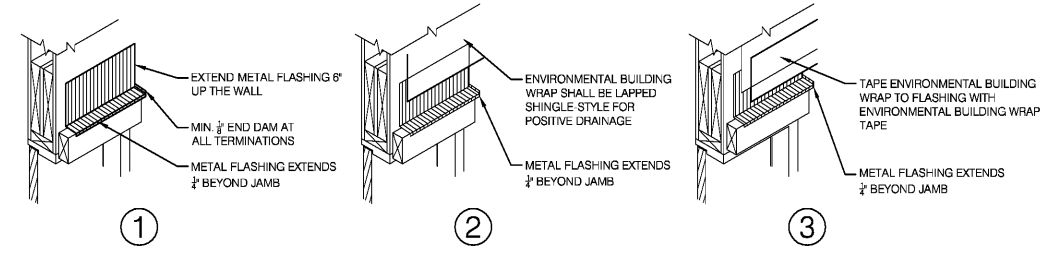

2 DOOR HEAD FLASHING ASSEMBLY
 A412 N.T.S. NOTE: DETAILS SHOWN TO ILLUSTRATE FLASHING CONFIGURATIONS. ACTUAL FLASHING DETAILS MAY VARY.

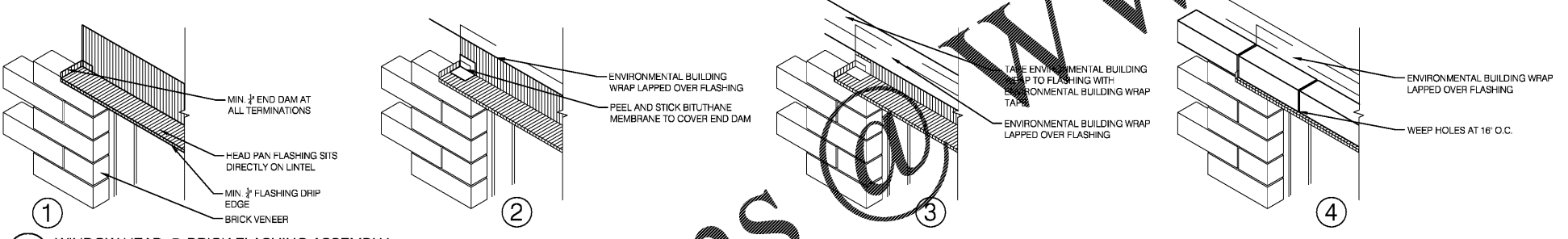

3 WINDOW HEAD @ BRICK FLASHING ASSEMBLY
 A412 N.T.S. NOTE: DETAILS SHOWN TO ILLUSTRATE FLASHING CONFIGURATIONS. ACTUAL FLASHING DETAILS MAY VARY.

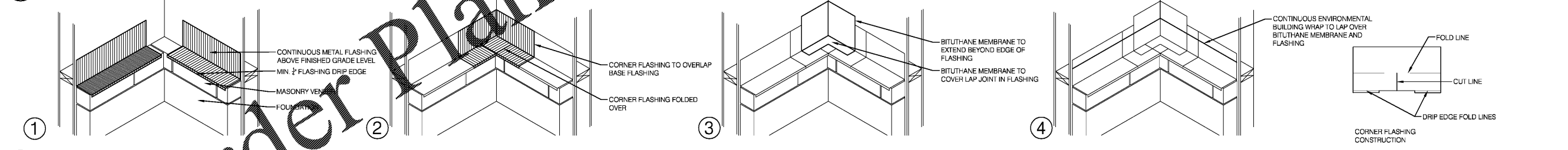

4 INSIDE CORNER MASONRY BASE FLASHING
 A412 N.T.S. NOTE: DETAILS SHOWN TO ILLUSTRATE FLASHING CONFIGURATIONS. ACTUAL FLASHING DETAILS MAY VARY.

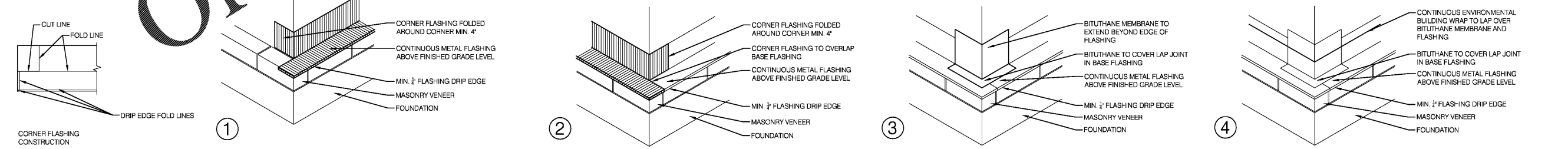

5 OUTSIDE CORNER MASONRY BASE FLASHING
 A412 N.T.S. NOTE: DETAILS SHOWN TO ILLUSTRATE FLASHING CONFIGURATIONS. ACTUAL FLASHING DETAILS MAY VARY.

GENERAL NOTES:

1. WEATHER BARRIER CUTS AT WINDOW & DOOR OPENINGS SHALL BE MADE WITH A MODIFIED "I" CUT WITH JAMBS AND SILLS FOLDING IN AND THE HEAD LAPPING OVER THE HEAD FLASHING.
2. A WEATHER BARRIER SHALL BE INSTALLED IN ACCORDANCE WITH MANUFACTURERS SPECIFICATIONS ON ALL EXTERIOR FRAMED WALLS AND SHALL BE EQUAL TO A SPUNBONDED OLEFIN, NON-WOVEN, NON-PERFORATED.
3. AREAS TO INCLUDE METAL FLASHING SHALL INCLUDE BUT ARE NOT LIMITED TO THE FOLLOWING: WINDOW HEAD, WINDOW SILL, DOOR HEAD, DOOR SILL, ROOF TO WALL, FLOOR TO ROOF, ANY WALL PENETRATIONS, ANY WALL MOUNTED EQUIPMENT, LOUVERS, VENTS, TOPS OF KNEE WALLS, AND TOPS OF EXPOSED BULKHEAD WALLS.
4. FLASHINGS & SEALANTS SHALL BE INSTALLED TO ENSURE A WATER-TIGHT BUILDING ENVELOPE.
5. ALL MASONRY CAPS AND TRANSITION PLATES SHALL SLOPE A MINIMUM OF 2:1.
6. END DAMS SHALL BE INSTALLED, WHEREVER NEEDED, TO PREVENT WATER INTRUSION.
7. THE FLASHING DETAILS ON THIS SHEET ARE A MINIMUM STANDARD REQUIREMENT FOR ALL CONDITIONS REQUIRING FLASHING & WATERPROOFING.
8. WALL SHEATHING WITHIN 2 FEET OF A ROOF TO WALL INTERSECTION SHALL BE PRESERVE TREATED.
9. THESE DETAILS SHALL BE REVIEWED BY THE CONTRACTOR AND MODIFIED TO FIT VARIOUS CONDITIONS THAT MIGHT BE SHOWN. CONSULT WITH ARCHITECT BEFORE PROCEEDING.
10. ALL FLASHING SHALL BE CONTINUOUS TO DAYLIGHT AND EXTEND MINIMUM 3/4" BEYOND END OF CONDITION.
11. ALL MEMBRANES AND FLASHINGS SHALL BE LAPPED IN THE DIRECTION OF MOISTURE FLOW (SHINGLED.)
12. ALL FLASHINGS SHALL BE INSTALLED IN ACCORDANCE WITH THE LATEST EDITION OF THE SMACNA MANUAL (SHEET METAL AND AIR CONDITIONING CONTRACTORS NATIONAL ASSOCIATION.)
13. ALL GUTTERS AND DOWNSPOUTS SHALL BE SIZED FOR RAINFALL INTENSITY DETERMINED BY STORM OCCURRENCE OF 1 IN 100 YEARS IN ACCORDANCE WITH THE LATEST EDITION OF THE SMACNA MANUAL (SHEET METAL AND AIR CONDITIONING CONTRACTORS NATIONAL ASSOCIATION.)
14. ALL SEALANT JOINTS OF 3/4" AND LESS SHALL BE INSTALLED W/ BOND BREAKER TAPE. NO 3-SIDED BONDS ARE ACCEPTABLE.
15. ALL AREAS TO GET SEALANT SHALL INCLUDE BUT ARE NOT LIMITED TO: CONTROL & EXPANSION JOINTS, MASONRY TO OTHER MATERIALS, LAP JOINTS IN SHEET METAL WORK, WINDOW AND DOOR FRAMES TO ADJACENT WORK, ANY DISSIMILAR MATERIALS INCLUDING: WOOD, METAL, STONE, BRICK, CMU, CONCRETE, VINYL, AND ALUMINUM

SPECIAL NOTE:

THRU-WALL FLASHING SHALL TERMINATE 1/2" BACK FROM FACE OF BRICK VENEER AT LOCATIONS WHERE WEEPS ARE PROVIDED AT 32" O.C. UNDER THIS CIRCUMSTANCE, THE FLASHING EXTENSION & "DRIP EDGE" IS NOT REQUIRED.



581 JACOBS MILL POND ROAD
 ELGIN, SOUTH CAROLINA 29045
 803.960.5026 / jeff@jefflewis.com

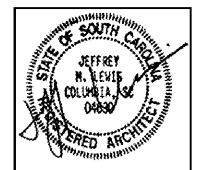

LUGOFF FACILITY EXPANSION
 SANDHILLS MEDICAL FOUNDATION

28 BALDWIN AVENUE
 LUGOFF, SOUTH CAROLINA 29078

FLASHING DETAILS & NOTES

REV.	DATE	DESCRIPTION

JOB # 16-039-1 07.15.2019

A412