

THIS DRAWING AND THE DESIGN SHOWN THEREON ARE THE PROPERTY OF JEFF LEWIS, AIA. THE REPRODUCTION, COPYING OR OTHER USE OF THIS DRAWING WITHOUT WRITTEN CONSENT OF JEFF LEWIS AIA IS PROHIBITED AND INFRINGEMENTS WILL BE SUBJECT TO LEGAL ACTION.

- NOTES:
1. REPLACE OR ADJUST EXISTING SIGNAGE AS NECESSARY ALONG BALDWIN AVENUE (TYP.)
 2. ALL MARKINGS WITHIN SCDOT R/W SHALL BE THERMOPLASTIC OR APPROVED PERMANENT EQUIVALENT (TYP.)
 3. REFER TO C8.0 FOR ASPHALT SECTION WITHIN SCDOT R/W.
 4. REFER TO G12.0 FOR DRIVEWAY PROFILE AND ADDITIONAL SCDOT TYPICAL DETAILS.
 5. CONTRACTOR SHALL BE RESPONSIBLE FOR UTILIZING ALL APPLICABLE AND CURRENT SCDOT STANDARD DRAWINGS INCLUDED, BUT NOT LIMITED TO, THE DRAWINGS INCLUDED WITHIN THESE PLANS AND THE APPROVED PERMIT PACKAGE.

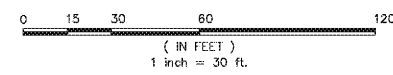

PROPOSED NEW
1 ENTRY, 1 EXIT
THREAT LENGTH
R/W WIDTH=66'
SPEED LIMIT (BALDWIN AVENUE)=40 MPH
REQUIRED SIGHT DISTANCE=445'
PROVIDED SIGHT DISTANCE (LEFT)= 540'
PROVIDED SIGHT DISTANCE (RIGHT)= 630'

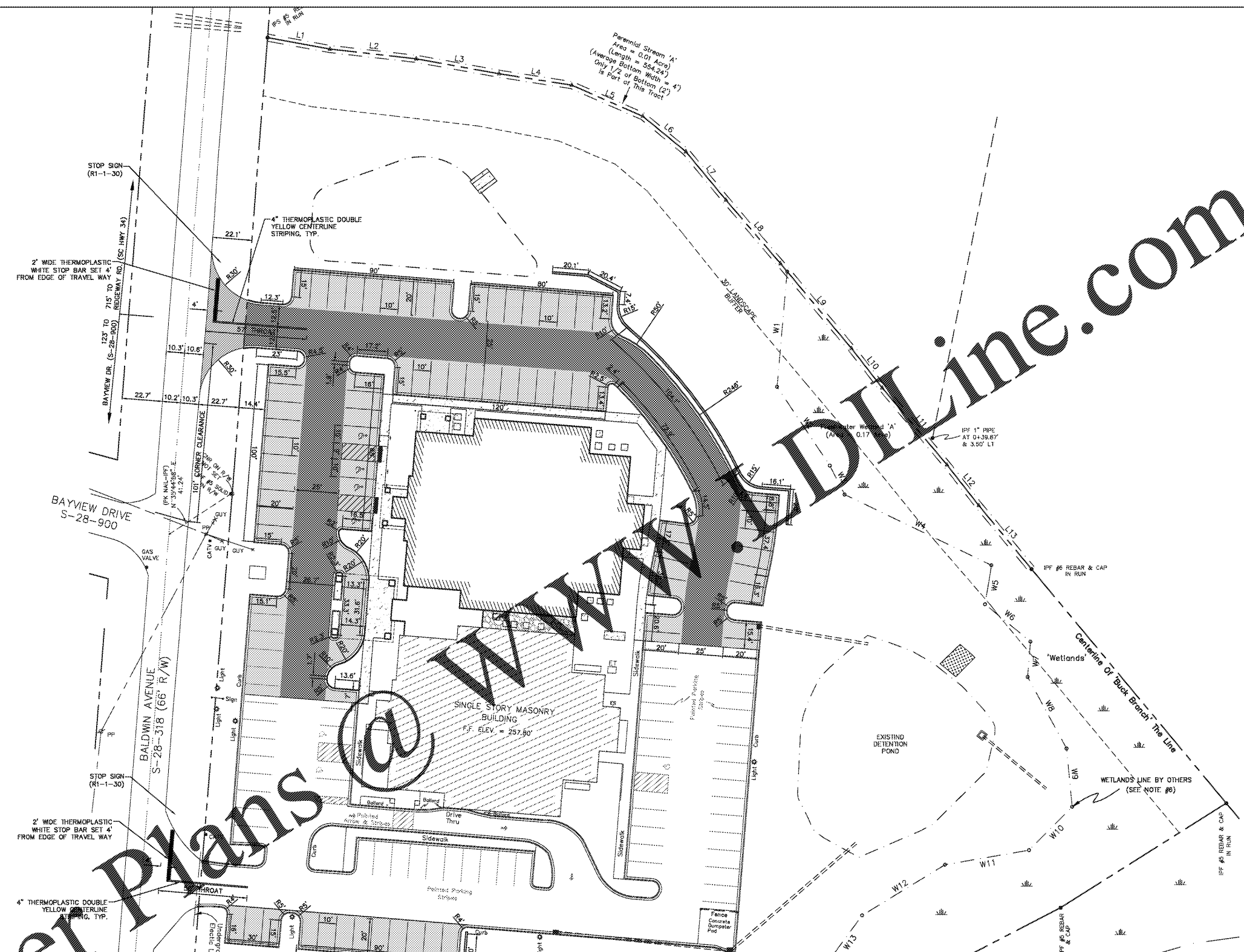
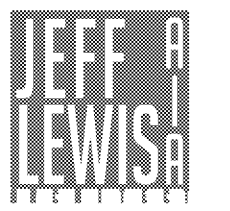
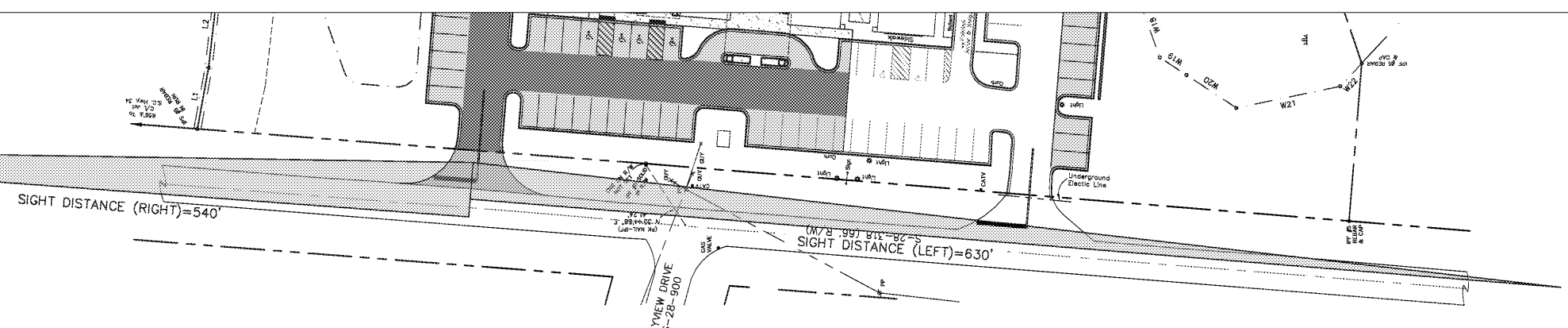
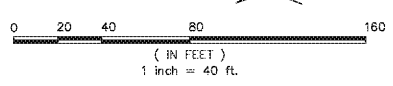

561 JACOBS MILL POND ROAD
ELGIN, SOUTH CAROLINA 29045
802.960.5025 / jeff@jefflewis.com

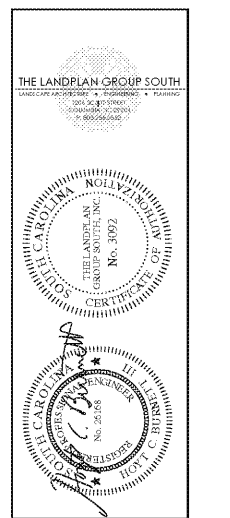

LUGOFF FACILITY EXPANSION
SANDHILLS MEDICAL FOUNDATION
28 BALDWIN AVENUE
LUGOFF, SOUTH CAROLINA 29078

REV.	DATE	DESCRIPTION
1.	11.22.19	Revised based on changes to FEMA flood maps.
2.	8.11.20	Big Sheet

JOB # 16-039-1 07.15.2019
TLPGS NO. 803-A
SCDOT
ENCROACHMENT
PLAN
C14.0