

**GENERAL JOINT LAYOUT NOTES**

- A. THIS PLAN IS FOR RELATIVE LAYOUT AND SCOPE OF WORK PURPOSES ONLY. REFER TO SITE PLAN FOR RELATIONSHIP OF THESE STRUCTURE TO EXISTING CONDITIONS AND REFERENCE POINTS.
- B. FOAM EXPANSION JOINT MATERIAL SHALL SURROUND THE CANOPY COLUMNS, U-BUMPERS, BOLLARDS AND DISPENSER ISLANDS AT GRADE. SEE TANK-PIPING PLANS (STANDARD YARD AND DRIVE DETAILS).
- C. SEE TANK-PIPING PLANS FOR NOTES ON REBAR REINFORCING AROUND UST MANHOLE.
- D. SEE TANK-PIPING PLANS FOR CONDUIT PIPING LAYOUT.
- E. DOWELED JOINTS SHALL BE LOCATED ON 12' CENTERS, ALONG THE INSIDE OF THE MOST EXTERIOR SLABS. DOWELS SHALL BE SMOOTH TYPE AND INSERTED INTO GREENSTREAK SPEED DOWEL FORMS. THE DOWEL IS LOCATED AT MID-SLAB DEPTH AND HELD IN PLACE LEVEL AND PERPENDICULAR TO THE JOINT USING THE SPEED DOWEL, WHICH REMAINS WITH THE FORM AFTER THE FORMS ARE STRIPPED. THE DOWELS SHOULD BE CHECKED TO ASSURE FULL INSERTION AND ALIGNMENT IN THE INITIAL SLAB BEFORE POURING THE ADJACENT SLAB. DOWELS OCCURRING UNDER AND PARALLEL TO CONTROL JOINTS SHOULD BE DELETED. SEE TANK-PIPING PLANS FOR ADDITIONAL INFORMATION. SEE TANK-PIPING PLANS FOR ADDITIONAL INFORMATION.

**GENERAL SITE NOTES - PAVING**

- A. CONCRETE ON ASPHALT UTILITY CUT REPAIR TO BE DYED TO MATCH SURROUND ASPHALT.
- B. UNLESS OTHERWISE SHOWN, CALLED OUT OR SPECIFIED HEREON ALL CURB AND GUTTER ADJACENT TO ASPHALT PAVING SHALL BE INSTALLED PER DETAIL S4 (SEE DETAILS SHEET C-11).
- C. PAVEMENT SHALL BE INSTALLED IN ACCORDANCE WITH THE RECOMMENDATIONS FOR THE GEOTECHNICAL REPORT PREPARED BY UNITED CONSULTING, DATED SEPTEMBER 30, 2019 AND THIS PAVING PLAN OVER THE ENTIRE PARKING LOT AREA AND ALL APPROACH DRIVES.
- D. SEE ASSOCIATED PLANS FOR CANOPY, COLUMN, PUMP ISLAND DETAILS AND LAYOUT.

**ADDITIONAL PAVING NOTES**

- 1. SURFACE COURSE, BASE, AND SUB-GRADE SHALL BE PER GEOTECHNICAL ENGINEER'S RECOMMENDATIONS FOR LOCAL SOILS OR DRAINAGE CONDITIONS AND/OR METHODS.
- 2. SUBGRADE SHALL BE COMPACTED TO 95% OF STANDARD PROCTOR OR AS SPECIFIED BY THE GEOTECHNICAL REPORT WHICHEVER IS MORE STRINGENT.
- 3. FOLLOW RECOMMENDATIONS IN GEOTECH REPORT FOR REINFORCEMENT OF CONCRETE SECTIONS.
- 4. FOLLOW RECOMMENDATIONS IN GEOTECH REPORT FOR PERMANENT UNDERDRAINS IN THE PAVEMENT AREAS.

N/F  
BARNYARD OF COLUMBIA, LLC  
DB 17808 - PG 45  
TAX PARCEL # 005597-01-014

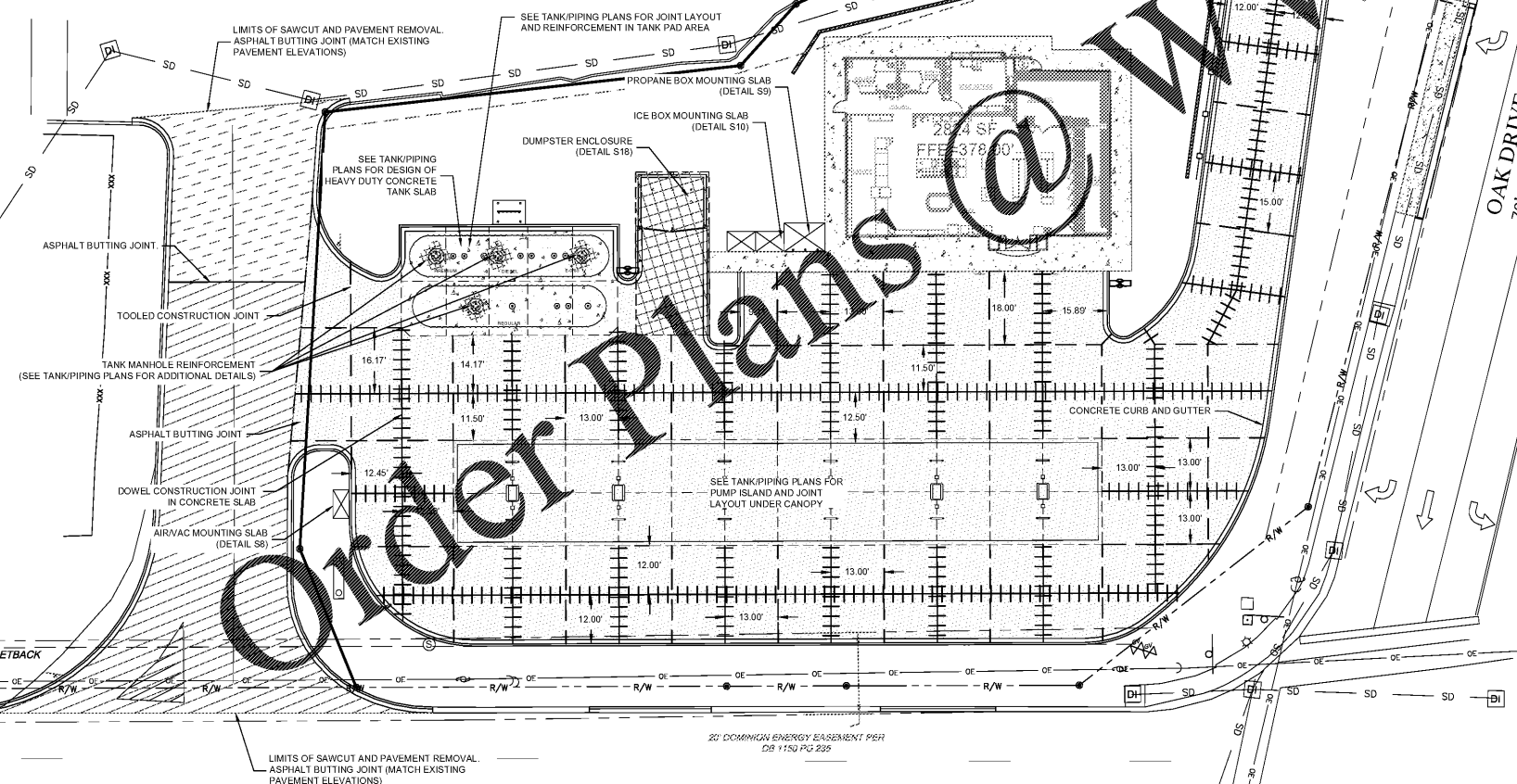

AUGUSTA ROAD - HWY 1  
75' PUBLIC R/W  
SPEED LIMIT: 45 MPH



**LEGEND**

EXISTING	SANITARY MANHOLE	POWER POLE	LIGHT POLE
SANITARY SEWER LINE	SEWER FORCE MAIN	WATER SERVICE	WATER VALVE
TEE	TAP	REDUCER	BLOWOFF
STUBOUT	WATERLINE	FIRE LINE	WELL
TYPE 9 CATCH BASIN	STORM DRAIN	MAJOR CONTOUR	MINOR CONTOUR
PROPOSED	MAJOR CONTOUR	MINOR CONTOUR	PROPOSED STORM SEWER PIPE
		LIMITS OF CONSTRUCTION	
		CURB AND GUTTER	
		DRAINAGE SLOPE AND DIRECTION	
		PROPOSED SWALE/DITCH	

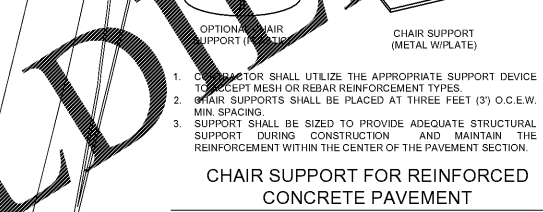

**CHAIR SUPPORT FOR REINFORCED CONCRETE PAVEMENT**  
N.T.S.

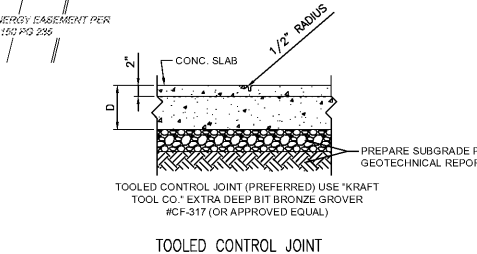

**TOOLED CONTROL JOINT**  
N.T.S.

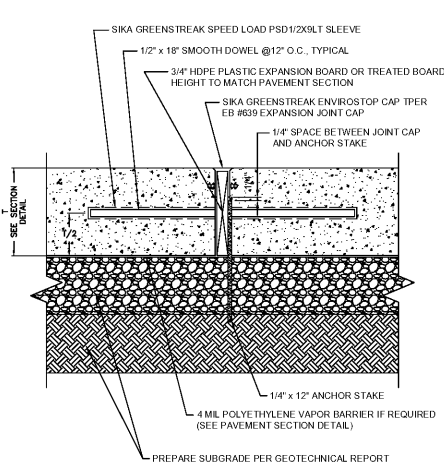

- INSTALLATION STEPS:**
1. TERMINATE STAKES BELOW THE TOP OF THE BOARD A DISTANCE EQUAL TO THE DEPTH OF THE JOINT CAP PROFILE PLUS 1/4" MIN.
  2. USE FACTORY FABRICATIONS FOR INTERSECTIONS AND CHANGES OF DIRECTION. ENSURE ALL SECTIONS TO BE SPICED ARE CUT SQUARE AND BOND TOGETHER USING G-SEAL ADHESIVE.
  3. SECURE JOINT CAP TO THE EXPANSION BOARD WITH STAPLES, NAILS, SCREWS BELOW THE PROFILE RIBS (APPROXIMATELY 18" ON CENTER) OR ADHESIVE TO PREVENT DISLOCATION DURING CONCRETE PLACEMENT.
  4. INSERT SPEED LOAD SLEEVES INTO HOLES DRILLED THROUGH EXPANSION BOARDS AT MINIMUM 2" BELOW TOP OF SLAB. ENSURE SPEED LOAD SLEEVES ARE SECURED IN EXPANSION BOARD WITH BASE FLANGE FLAT TO EXPANSION BOARD FACE.
  5. INSERT SMOOTH DOWEL INTO SPEED LOAD SLEEVES AND PLACE CONCRETE USING NORMAL PLACEMENT TECHNIQUES. UTILIZING THE JOINT CAP AS A SCREED RAIL, VIBRATE CONCRETE TO ENSURE GOOD CONSOLIDATION AROUND JOINT CAP, SPEED LOAD AND REBAR.

**DOWEL CONSTRUCTION JOINT IN CONCRETE SLAB**  
N.T.S.

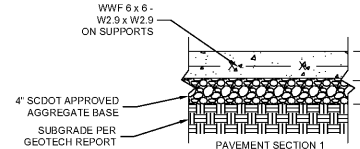

**PAVEMENT SECTION 1**  
5" CONCRETE PAVING

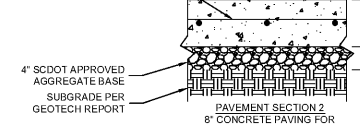

**PAVEMENT SECTION 2**  
8" CONCRETE PAVING FOR DUMPSTER PAD

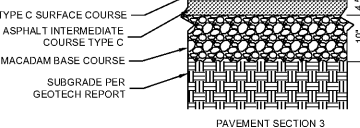

**PAVEMENT SECTION 3**  
HEAVY DUTY ASPHALT

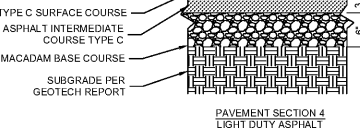

**PAVEMENT SECTION 4**  
LIGHT DUTY ASPHALT

**CONCRETE PAVING**  
N.T.S.

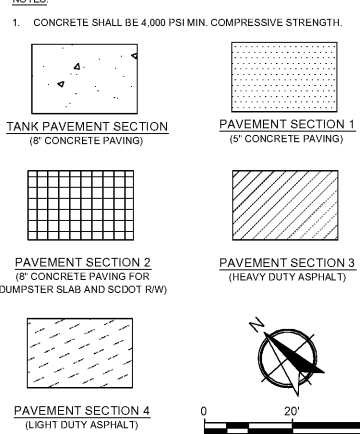

**PAVEMENT SECTION 4**  
(LIGHT DUTY ASPHALT)

NOTES:  
1. CONCRETE SHALL BE 4,000 PSI MIN. COMPRESSIVE STRENGTH.

SCALE: 1" = 20'

Sheet No. **C-7**

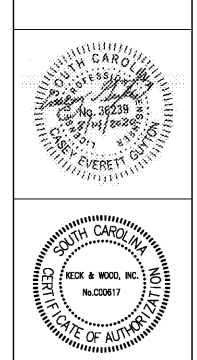

**Paving and Joint Plan**  
Murphy Express  
4404 Augusta Road  
Keck & Wood Project No. 180167

**Keck & Wood**  
COLLABORATION BY DESIGN  
4825 Palmetto Drive, Suite 210  
North Charleston, SC 29405  
(843) 278-8800

**MURPHY OIL USA, INC.**  
200 PEACH STREET  
EL DORADO, AR 71730  
**MURPHY USA**

This drawing and the design shown are the property of Keck & Wood, Inc. The reproduction, copying or other use of this drawing without written consent is prohibited and any infringement will be subject to legal action.  
© 2020 Keck & Wood, Inc.