

N/F
BARNYARD OF COLUMBIA, LLC
 DB 17808 - PG 45
 TAX PARCEL # 005597-01-014

LEGEND

EXISTING	<ul style="list-style-type: none"> SANITARY MANHOLE SANITARY SEWER LINE SANITARY SEWER SERVICE SEWER FORCE MAIN AIR RELEASE VALVE FIRE HYDRANT WATER SERVICE WATER VALVE TEE TAP REDUCER BLOWOFF STUBOUT WATERLINE FIRE LINE WELL TYPE 1 CATCH BASIN TYPE 9 CATCH BASIN DROP INLET STORM DRAIN JUNCTION BOX STORM DRAIN MAJOR CONTOUR MINOR CONTOUR 	<ul style="list-style-type: none"> LIGHT POLE POWER POLE GUY WIRE ELECTRICAL TRANSFORMER ELECTRICAL BOX TELEPHONE PEDESTAL TRANSMISSION TOWER OVERHEAD ELECTRIC UNDERGROUND ELECTRIC GAS VALVE GAS LINE UNDERGROUND TELEPHONE SIGN MAIL BOX TREES ROAD CENTER PROPOSED FUNDRAISER ROAD FEN ROAD CURB PERMANENT EASEMENT TEMPORARY EASEMENT RIGHT-OF-WAY
PROPOSED	<ul style="list-style-type: none"> SANITARY SEWER SERVICE WATER SERVICE 	<ul style="list-style-type: none"> SS WL

GENERAL NOTES

- ALL EXISTING WATER LINES FROM METER TOWARDS BUILDING SHALL BE SCHEDULE 40 PVC MEETING 1975 & D2665 SPECIFICATIONS AND SHALL BE RATED FOR USE WITH POTABLE WATER PER NSF ST. 61 WITH 36" MIN. COVER.
- ALL SANITARY SEWER LINES SHALL BE SCHEDULE 35 PVC UNLESS OTHERWISE SPECIFIED BY THE UTILITY COMPANY, PROVIDE 36" MINIMUM COVER.
- CONTRACTOR SHALL COORDINATE ANY DISRUPTIONS TO EXISTING UTILITY SERVICES WITH ADJACENT PROPERTY OWNERS.
- ALL ELECTRIC AND TELEPHONE EXTENSIONS INCLUDING SERVICE LINES SHALL BE CONSTRUCTED TO THE APPROPRIATE UTILITY COMPANY SPECIFICATIONS. ALL UTILITY DISCONNECTIONS SHALL BE COORDINATE WITH THE DESIGNATED UTILITY COMPANIES.
- CONSTRUCTION SHALL NOT START ON ANY PUBLIC UTILITY SYSTEM UNTIL WRITTEN APPROVAL HAS BEEN RECEIVED BY THE ENGINEER FROM THE APPROPRIATE GOVERNING AUTHORITY AND CONTRACTOR HAS BEEN NOTIFIED BY THE ENGINEER.
- PRIOR TO THE CONSTRUCTION OF OR CONNECTION TO ANY STORM DRAIN, SANITARY SEWER, WATER MAIN OR ANY OTHER UTILITIES, THE CONTRACTOR SHALL EXCAVATE, VERIFY AND CALCULATE ALL POINTS OF CONNECTION AND ALL UTILITY CROSSINGS AND INFORM CONSULTING ENGINEER(S) AND THE OWNER/DEVELOPER OF ANY CONFLICT OR REQUIRED DEVIATIONS FROM THE PLAN. NOTIFICATION SHALL BE MADE A MINIMUM OF (72) HOURS PRIOR TO CONSTRUCTION. CONSULTANT AND ITS CLIENTS SHALL BE HELD HARMLESS IN THE EVENT THAT THE CONTRACTOR FAILS TO MAKE SUCH NOTIFICATION.
- CONTRACTOR SHALL COMPLY COMPLETELY WITH THE LATEST STANDARDS OF OSHA DIRECTIVES OR ANY OTHER AGENCY HAVING JURISDICTION FOR EXCAVATION AND TRENCHING PROCEDURES. THE CONTRACTOR SHALL USE SUPPORT SYSTEMS, SLOPING, BENCHING AND OTHER MEANS OF PROTECTION, THIS IS TO INCLUDE, BUT NOT LIMITED TO ACCESS AND EGRESS FROM ALL EXCAVATION AND TRENCHING. CONTRACTOR IS RESPONSIBLE FOR COMPLYING WITH PERFORMANCE CRITERIA AS REQUIRED BY OSHA.

TRAFFIC CONTROL NOTES

- ALL SIGNAGE SHALL BE INSTALLED PER SCDOT STANDARDS AND SPECIFICATIONS. ALL SIGNAGE SHOWN IS A REPRESENTATION OF HOW TRAFFIC SHALL BE ROUTED DURING ROAD CLOSURE.
- 'DETOUR' SIGNS SHALL CONFORM TO SCDOT STANDARD DRAWING NO. 605-035-01.
- ALL BARRICADES TO BE TYPE II (8'8" PANELS) PER SCDOT STANDARD DRAWING NO. 604-005-00.
- FOR LANE CLOSURE WITHIN THE RIGHT-OF-WAY, SEE SCDOT STANDARD DRAWING NOS. 610-005-00, 610-025-00, AND 610-040-00.
- FOR SHOULDER CLOSURE WITHIN THE RIGHT-OF-WAY, SEE SCDOT STANDARD DRAWING NOS. 610-205-00 AND 610-210-00.

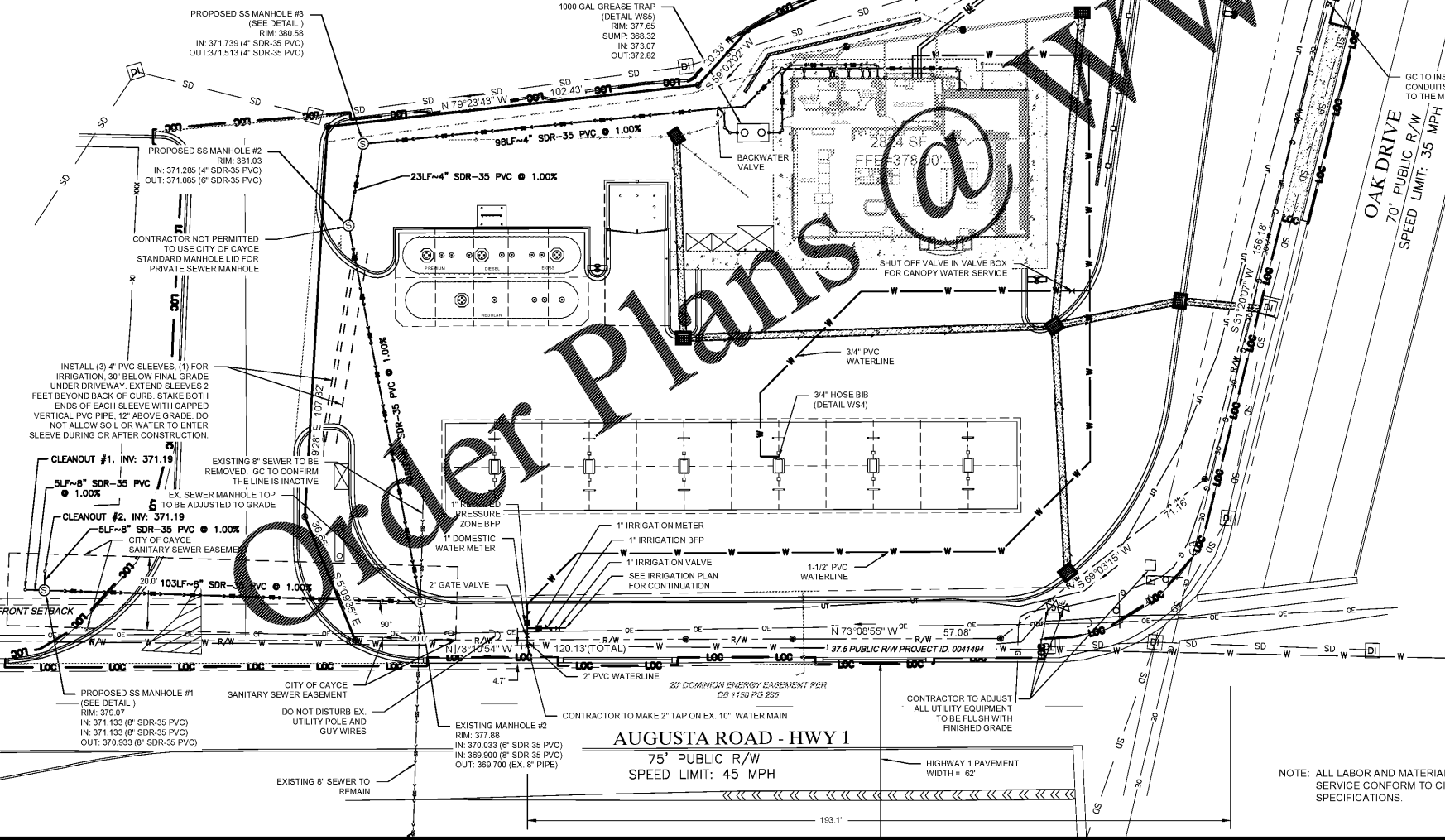

AUGUSTA ROAD - HWY 1
 75' PUBLIC R/W
 SPEED LIMIT: 45 MPH

NOTE: ALL LABOR AND MATERIAL FOR THE PROPOSED WATER SERVICE CONFORM TO CITY OF WEST COLUMBIA STANDARD SPECIFICATIONS.

GC TO VERIFY LOCATION, CONNECTION POINT AND DEPTH OF EXISTING UTILITIES PRIOR TO INSTALLING PROPOSED UTILITY.

ALL UTILITY FEES TO BE PAID BY OWNER AND ARE NOT REQUIRED TO BE INCLUDED IN BID.

REFER TO GALLOWAY SHEET PE-1 FOR SIZING, ROUTING, AND INSTALLATION REQUIREMENTS OF SITE LIGHTING CONDUIT AND WIRING AND PYLON SIGN CONDUIT AND WIRING.

SEE SHEET C-3.1 FOR BUILDING ROOF DRAINAGE AND CANOPY DRAINAGE.

UTILITY ROUTING NOTE:
 REFER TO PLUMBING PLAN (P1) FOR EXACT LOCATIONS OF UTILITY ENTRY POINTS TO BUILDING, ROUTING OF SEWER FLOWS, ETC.

UTILITY FEE SCHEDULE

FEES TO BE PAID BY MURPHY:

WATER:	IMPACT FEE	\$
	TAP FEE	\$
	METER FEE	\$
	TOTAL	\$
SEWER:	IMPACT FEE	\$
	TAP FEE	\$
	TOTAL	\$
ELECTRIC:	IMPACT FEE	\$
	DEPOSIT	\$
	CONNECTION CHARGE	\$
	TOTAL	\$

METER SIZES

DOMESTIC: 1"
 IRRIGATION: 1"

UTILITY CONFLICTS ADDITIONAL NOTES

GROUND PENETRATING RADAR (GPR) SHALL BE USED TO VERTICALLY/HORIZONTALLY LOCATE ALL CONFLICTING UTILITY LINES FOR WHICH THE SURVEY DOES NOT PROVIDE SUFFICIENT INFORMATION TO DETERMINE SAID LOCATION. SIZE OF LINE SHALL ALSO BE DETERMINED BY GPR.

UTILITY CONTACTS

WATER City of West Columbia 200 North 12th Street West Columbia, S.C. 29169 (803) 609-2489 Contact: Andy Zaengle	TELEPHONE Spectrum Business 3179 Erie Boulevard East Syracuse, N.Y. 13214 (315) 314-5178 Contact: Omar Baaz
SEWER City of Cayce 1800 12th Street Cayce, S.C. 29033 (803) 550-9515 Contact: Karalyn Miskie	ELECTRIC Dominion Energy 220 Operation Way Cayce, S.C. 29033 (803) 217-4647 Contact: Wendy Brown

- ### CITY OF CAYCE NOTES
- ALL LABOR AND MATERIAL FOR SANITARY SEWER SHALL CONFORM TO CITY OF CAYCE SPECIFICATIONS.
 - THE USE OF SLIDES FOR SEWER MANHOLES ARE NOT PERMITTED.
 - ALL SDR-35 SEWER PIPE IS TO BE GREEN.
 - ANY FUTURE SERVICE FROM THE ADJACENT LANDLORD OWNED PROPERTIES TO THE NEW SEWER MAIN WILL REQUIRE A NEW 208 CERTIFICATION/APPROVAL FROM THE CENTRAL MIDLANDS COUNCIL OF GOVERNMENTS AND CONSENT FROM THE TOWN OF LEXINGTON BEFORE THEY CAN BE SERVED BY THIS NEW SEWER MAIN AND THE CITY OF CAYCE.

Sheet No. **C-6**

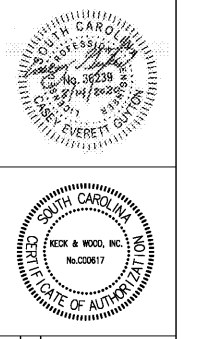

CG	DRW
CG	DES
GS	PM
MM	PRN
08/05/20	DATE
REV-5	

Utility Plan
 Murphy Express
 4404 Augusta Road
 Keck & Wood Project No. 180167

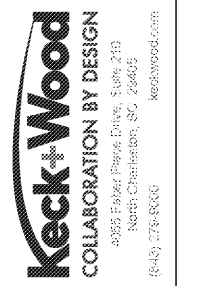

This drawing and the design shown are the property of Keck & Wood, Inc. The reproduction, copying or other use of this drawing without written consent is prohibited and any infringement will be subject to legal action.
 © 2020 Keck & Wood, Inc.