

**BMP MAINTENANCE NOTES**

ALL MEASURES STATED ON THIS SITE MAP, AND IN THE STORM WATER POLLUTION PREVENTION PLAN, SHALL BE MAINTAINED IN FULLY FUNCTIONAL CONDITION UNTIL NO LONGER REQUIRED FOR A COMPLETED PHASE OF WORK OR FINAL STABILIZATION OF THE SITE. ALL EROSION AND SEDIMENTATION CONTROL MEASURES SHALL BE CHECKED BY A QUALIFIED PERSON IN ACCORDANCE WITH THE CONTRACT DOCUMENTS OR THE APPLICABLE PERMIT, WHICHEVER IS MORE STRINGENT, AND REPAIRED IN ACCORDANCE WITH THE FOLLOWING:

1. INLET PROTECTION DEVICES AND BARRIERS SHALL BE REPAIRED OR REPLACED IF THEY SHOW SIGNS OF UNDERMINING OR DETERIORATION.
2. ALL SEEDED AREAS SHALL BE CHECKED REGULARLY TO SEE THAT GOOD STAND IS MAINTAINED. AREAS SHOULD BE FERTILIZED, WATERED, AND RESEED AS NEEDED.
3. SILT FENCES SHALL BE REPAIRED TO THEIR ORIGINAL CONDITIONS IF DAMAGED. SEDIMENT SHALL BE REMOVED FROM THE SILT FENCES WHEN IT REACHES ONE-HALF OF THE SILT FENCE.
4. THE CONSTRUCTION EXITS SHALL BE MAINTAINED IN A CONDITION WHICH WILL PREVENT TRACKING OR FLOW OF MUD ONTO PUBLIC RIGHTS-OF-WAY. THIS MAY REQUIRE PERIODIC TOP DRESSING OF THE CONSTRUCTION EXITS AS CONDITIONS DEMAND.
5. THE TEMPORARY PARKING AND STORAGE AREA SHALL BE KEPT IN GOOD CONDITION (SUITABLE FOR PARKING AND STORAGE); THIS MAY REQUIRE PERIODIC TOP DRESSING OF THE TEMPORARY PARKING AREA AS CONDITIONS DEMAND.
6. IF THE STONES IN THE GRAVEL INLET SEDIMENT FILTERS BECOME CLOGGED WITH SEDIMENT AND CAPACITY IS REDUCED BY HALF, THE STONES MUST BE PULLED AWAY, CLEANED, AND REPLACED.
7. UPON SOLIDIFYING, CONCRETE SHALL BE REMOVED FROM WASHOUT AREA AND PROPERLY DISPOSED OF TO PREVENT RUNOFF.
8. PRIOR TO LEAVING THE SITE, ALL VEHICLES SHALL BE CLEANED OF DEBRIS. ANY DEBRIS AND/OR SEDIMENT REACHING THE PUBLIC STREET SHALL BE CLEANED IMMEDIATELY BY A METHOD OTHER THAN FLUSHING.

I HAVE PLACED MY SIGNATURE AND SEAL ON THE DESIGN DOCUMENTS SUBMITTED SIGNIFYING THAT I ACCEPT THE RESPONSIBILITY FOR THE DESIGN OF THE SYSTEM. FURTHER, I CERTIFY TO THE BEST OF MY KNOWLEDGE AND BELIEF THAT THE DESIGN IS CONSISTENT WITH THE REQUIREMENTS OF TITLE 48, CHAPTER 14 OF THE CODE OF LAWS OF SC, 1976 AS AMENDED, PURSUANT TO REGULATION 72-300 ET SEQ. (IF APPLICABLE), AND IN ACCORDANCE WITH THE TERMS AND CONDITIONS OF SCR100000.

**CONSTRUCTION SEQUENCE**

- PHASE 1 (~3 WEEKS)**
1. DEMARK ANY SENSITIVE AREAS SLATED FOR PROTECTION SUCH AS TREES, WETLANDS, STREAMS, ETC.
  2. REMOVE HARD SURFACES AS NECESSARY TO INSTALL STABILIZED CONSTRUCTION ENTRANCE.
  3. INSTALL STABILIZED CONSTRUCTION ENTRANCE.
  4. PREPARE TEMPORARY PARKING AND STORAGE AREA.
  5. INSTALL ALL PERIMETER SEDIMENT CONTROL BMP'S.
  6. DEMO EXISTING BUILDING, ASPHALT, ETC. PER DEMOLITION PLAN.
  7. BEGIN GRADING.
- PHASE 2 (~8 WEEKS)**
1. START CONSTRUCTION OF BUILDING PAD, STRUCTURES, AND OFF-SITE IMPROVEMENTS.
  2. TEMPORARILY SEED DENUDEED AREAS.
  3. INSTALL UTILITIES, UNDERDRAINS, STORM SEWERS, CURBS AND GUTTERS.
  4. INSTALL INLET/FLOWLINE PROTECTION DEVICES.
  5. PREPARE SITE FOR PAVING.
  6. PAVE SITE.
  7. COMPLETE GRADING AND INSTALL PERMANENT SEEDING, SOD AND PLANTING.
  8. REMOVE EROSION AND TEMPORARY SEDIMENT CONTROL DEVICES AFTER FINAL STABILIZATION IS ACHIEVED.

**GENERAL EROSION CONTROL NOTES**

- A. IF NECESSARY, SLOPES WHICH EXCEED EIGHT (8) FEET SHOULD BE STABILIZED WITH SYNTHETIC OR VEGETATIVE MATS. IN ADDITION TO HYDROSEEDING, IT MAY BE NECESSARY TO INSTALL TEMPORARY SLOPE DRAINS DURING CONSTRUCTION. TEMPORARY BERMS MAY BE NEEDED DAILY UNTIL THE SLOPE IS BROUGHT TO GRADE.
- B. STABILIZATION MEASURES SHALL BE INITIATED AS SOON AS PRACTICABLE IN PORTIONS OF THE SITE WHERE CONSTRUCTION ACTIVITIES HAVE TEMPORARILY OR PERMANENTLY CEASED, BUT IN NO CASE MORE THAN FOURTEEN (14) DAYS AFTER WORK HAS CEASED, EXCEPT AS STATED BELOW:
  - WHERE STABILIZATION BY THE 14TH DAY IS PRECLUDED BY SNOW COVER OR FROZEN GROUND CONDITIONS, STABILIZATION MEASURES MUST BE INITIATED AS SOON AS PRACTICABLE.
  - WHERE CONSTRUCTION ACTIVITY ON A PORTION OF THE SITE IS TEMPORARILY CEASED, AND EARTH-DISTURBING ACTIVITIES WILL BE RESUMED WITHIN 14 DAYS, TEMPORARY STABILIZATION MEASURES DO NOT HAVE TO BE INITIATED ON THAT PORTION OF THE SITE.
- C. ALL SEDIMENT AND EROSION CONTROL DEVICES SHALL BE INSPECTED EVERY SEVEN (7) DAYS AND WITHIN 24 HOURS AFTER EACH RAINFALL OCCURRENCE THAT EXCEEDS ONE-HALF (0.5) INCH. IF SITE INSPECTIONS OR OTHER INFORMATION IDENTIFY BMP'S THAT ARE DAMAGED, INAPPROPRIATELY OR INCORRECTLY INSTALLED, OR NOT OPERATING EFFECTIVELY, THEN MAINTENANCE MUST BE PERFORMED AS SOON AS PRACTICABLE, OR AS REASONABLY POSSIBLE AND NO LESS THAN 48 HOURS FROM THE TIME OF IDENTIFICATION (PREFERABLY BEFORE THE NEXT STORM EVENT).
- D. PROVIDE SILT FENCE AND/OR OTHER CONTROL DEVICES AS MAY BE REQUIRED TO CONTROL SOIL EROSION DURING UTILITY CONSTRUCTION. ALL DISTURBED AREAS SHALL BE CLEANED, GRADED AND STABILIZED WITH GRASSING IMMEDIATELY AFTER THE UTILITY INSTALLATION. FILL COVER AND TEMPORARY SEEDING AT THE END OF EACH DAY ARE RECOMMENDED. IF WATER IS ENCOUNTERED WHILE TRENCHING, THE WATER SHOULD BE FILTERED TO REMOVE ANY SEDIMENTS BEFORE BEING PUMPED BACK INTO ANY EXISTING WATERWAYS, WATER COURSES AND WATERS OF THE STATE (WOS) OR WATERS OF THE UNITED STATES (WOUS).
- E. ALL EROSION CONTROL DEVICES SHALL BE PROPERLY MAINTAINED DURING ALL PHASES OF CONSTRUCTION UNTIL THE COMPLETION OF ALL CONSTRUCTION ACTIVITIES AND ALL DISTURBED AREAS HAVE BEEN STABILIZED. ADDITIONAL CONTROL DEVICES MAY BE REQUIRED DURING CONSTRUCTION IN ORDER TO CONTROL EROSION AND/OR OFF-SITE SEDIMENTATION. TEMPORARY CONTROL DEVICES SHALL BE REMOVED ONCE CONSTRUCTION IS COMPLETE AND THE SITE IS STABILIZED.
- F. THE CONTRACTOR MUST TAKE NECESSARY ACTION TO MINIMIZE TRACKING OF MUD ONTO PAVED ROADWAY FROM CONSTRUCTION AREAS AND THE GENERATION OF DUST. THE CONTRACTOR SHALL REMOVE MUD FROM PAVED ROADWAY AS NECESSARY. PAVEMENT, AS MAY BE REQUIRED.
- G. RESIDENTIAL SUBDIVISIONS REQUIRE EROSION CONTROL MEASURES FOR INFRASTRUCTURE AS WELL AS FOR INDIVIDUAL LOT CONSTRUCTION. INDIVIDUAL PROPERTY OWNERS SHALL FOLLOW THESE REQUIREMENTS DURING CONSTRUCTION OR OBTAIN APPROVAL OF AN INDIVIDUAL PLAN IN ACCORDANCE WITH SC REG. 72-300 SEC AND SCR100000.
- H. TEMPORARY DIVERSION BERMS AND/OR DRAINS WILL BE PROVIDED AS NEEDED DURING CONSTRUCTION TO PROTECT WORK AREAS FROM UPSLOPE RUNOFF AND/OR DIVERT SEDIMENT AND WATERS TO APPROPRIATE TRAPS OR STABLE OUTLETS.
- I. ALL WOUS OR WOUS, INCLUDING WETLANDS, ARE TO BE FLAGGED OR OTHERWISE CLEARLY MARKED IN THE FIELD. A DOUBLE ROW OF SILT FENCE IS TO BE INSTALLED AT ALL WOUS. A 100-FOOT BUFFER CANNOT BE MAINTAINED BETWEEN THE DISTURBED AREA AND ALL WOUS AND A 150-FOOT MINIMUM BUFFER FOR WOUS. A 100-FOOT NO DISTURBANCE ZONE SHALL BE MAINTAINED BETWEEN THE LAST ROW OF SILT FENCE AND ALL WOUS AND A MINIMUM 50-FOOT NO DISTURBANCE ZONE FOR WOUS. BUFFERS AND NO DISTURBANCE ZONES SHALL BE MEASURED FROM TOP OF CREEK.
- J. LITTER, CONSTRUCTION DEBRIS, SOILS, FUELS AND BUILDING PRODUCTS WITH SIGNIFICANT POTENTIAL FOR IMPACT (SUCH AS STOCKPILES OF FRESHLY TREATED LUMBER AND CONSTRUCTION CHEMICALS THAT COULD BE EXPOSED TO STORM WATER MUST BE PREVENTED FROM BECOMING A POLLUTION SOURCE IN STORM WATER DISCHARGES.
  - A COPY OF THE SWPPP (INCLUDING CIVIL CONSTRUCTION PLANS AND SUPPORTING DOCUMENTS), INSPECTIONS RECORDS, AND RAINFALL DATA MUST BE MAINTAINED AT THE CONSTRUCTION SITE OR A NEARBY LOCATION EASILY ACCESSIBLE DURING NORMAL BUSINESS HOURS, FROM THE DATE OF COMMENCEMENT OF CONSTRUCTION ACTIVITIES TO THE DATE THAT FINAL STABILIZATION IS REACHED.
  - LITTER STABILIZATION MEASURES ON ANY EXPOSED STEEP SLOPE (3H:1V OR GREATER) WHERE LAND-DISTURBING ACTIVITIES HAVE TEMPORARILY OR TEMPORARILY CEASED, AND WILL NOT RESUME FOR A PERIOD OF SEVEN (7) CALENDAR DAYS.
- K. MINIMIZE SOIL COMPACTION AND, UNLESS INFEASIBLE, PRESERVE AND STOCKPILE TOPSOIL FOR REUSE.
- L. THE FOLLOWING DISCHARGES FROM SITES ARE PROHIBITED:
  - WASTEWATER FROM WASHOUT AND CLEANOUT OF STUCCO, PAINT, FORM RELEASE OILS, CURING COMPOUNDS AND OTHER CONSTRUCTION MATERIALS, FUELS, OILS, OR OTHER POLLUTANTS USED IN VEHICLE AND EQUIPMENT OPERATION AND MAINTENANCE; AND SOAPS OR SOLVENTS USED IN VEHICLE AND EQUIPMENT WASHING.
  - AFTER CONSTRUCTION ACTIVITIES BEGIN, INSPECTIONS MUST BE CONDUCTED AT A MINIMUM OF AT LEAST ONCE EVERY CALENDAR WEEK AND MUST BE CONDUCTED UNTIL FINAL STABILIZATION IS REACHED ON ALL AREAS OF THE CONSTRUCTION SITE.
  - IF EXISTING BMP'S NEED TO BE MODIFIED OR IF ADDITIONAL BMP'S ARE NECESSARY TO COMPLY WITH THE REQUIREMENTS OF THIS PERMIT AND/OR SC'S WATER QUALITY STANDARDS, IMPLEMENTATION MUST BE COMPLETED BEFORE THE NEXT STORM EVENT WHENEVER PRACTICABLE. IF IMPLEMENTATION BEFORE THE NEXT STORM EVENT IS IMPRACTICABLE, THE SITUATION MUST BE DOCUMENTED IN THE SWPPP AND ALTERNATIVE BMP'S MUST BE IMPLEMENTED AS SOON AS REASONABLY POSSIBLE.
  - A PRE-CONSTRUCTION CONFERENCE MUST BE HELD FOR EACH CONSTRUCTION SITE WITH AN APPROVED ON-SITE SWPPP PRIOR TO THE IMPLEMENTATION OF CONSTRUCTION ACTIVITIES. FOR NON-LINEAR PROJECTS THAT DISTURB 10 ACRES OR MORE THIS CONFERENCE MUST BE HELD ON-SITE UNLESS THE DEPARTMENT HAS APPROVED OTHERWISE.
  - MINIMIZE THE DISCHARGE OF POLLUTANTS FROM EQUIPMENT AND VEHICLE WASHING, WHEEL WASH WATER, AND OTHER WASH WATERS. WASH WATERS MUST BE TREATED IN A SEDIMENT BASIN OR ALTERNATIVE CONTROL THAT PROVIDES EQUIVALENT OR BETTER TREATMENT PRIOR TO DISCHARGE.
  - MINIMIZE THE DISCHARGE OF POLLUTANTS FROM DEWATERING OF TRENCHES AND EXCAVATED AREAS. THESE DISCHARGES ARE TO BE ROUTED THROUGH APPROPRIATE BMP'S (SEDIMENT BASIN, FILTER BAG, ETC.).
  - SHOW BMP MEASURES FOR CONCRETE TRUCK WASHOUT AREA, OR ADD THE FOLLOWING NOTES:
    - CONCRETE TRUCKS SHALL NOT TYPICALLY BE WASHED OUT ON SITE. IF CONCRETE TRUCK WASHOUT IS PERMITTED ON SITE, COORDINATE LOCATION AND BMP'S WITH SITE INSPECTOR.
    - DO NOT DISPOSE OF CONCRETE TRUCK WASHOUT WASTE BY DUMPING INTO A SANITARY SEWER, STORM DRAIN OR ONTO SOIL OR PAVEMENT THAT CARRIES STORM WATER RUNOFF.
    - CONCRETE TRUCK WASHOUT SHALL BE DISPOSED OF IN ACCORDANCE WITH THE FOLLOWING:
      - DESIGNATED AREA THAT WILL LATER BE BACKFILLED (SLURRY PIT)
      - DESIGNATED AREA WHERE CONCRETE WASH CAN HARDEN AND BE DISPOSED OF AS SOLID WASTE.
      - LOCATION THAT IS NOT SUBJECT TO WATER RUNOFF, AND MORE THAN 50 FEET AWAY FROM A STORM DRAIN, OPEN DITCH, OR RECEIVING WATER WAY.
      - PUMP EXCESS CONCRETE IN CONCRETE PUMP BIN BACK INTO CONCRETE MIXER TRUCK.
      - CONCRETE WASHOUT FROM CONCRETE PUMPER BINS CAN BE WASHED INTO CONCRETE PUMPER TRUCKS AND DISCHARGED INTO DESIGNATED WASHOUT AREA OR PROPERLY DISPOSED OF OFF-SITE.
  - M. THE FOLLOWING DISCHARGES FROM SITES ARE PROHIBITED:
    - WASTEWATER FROM WASHOUT OF CONCRETE, UNLESS MANAGED BY AN APPROPRIATE CONTROL.
    - WASTEWATER FROM WASHOUT AND CLEANOUT OF STUCCO, PAINT, FORM RELEASE OILS, CURING COMPOUNDS AND OTHER CONSTRUCTION MATERIALS.
    - FUELS, OILS, OR OTHER POLLUTANTS USED IN VEHICLE AND EQUIPMENT OPERATION AND MAINTENANCE; AND
    - SOAPS OR SOLVENTS USED IN VEHICLE AND EQUIPMENT WASHING.
  - N. ALL CHEMICAL SPILLS, OIL SPILLS, OR FISH KILLS MUST BE REPORTED TO SCDEH LAND & WASTE MANAGEMENT EMERGENCY RESPONSE - CALL THE 24-HOUR EMERGENCY RESPONSE LINE AT 1-888-481-0125.
  - O. TEMPORARY TOILET FACILITIES SHALL BE PROVIDED FOR ALL CONSTRUCTION WORKERS AND SITE VISITORS IN ACCORDANCE WITH 2006 INTERNATIONAL PLUMBING CODE GENERAL REGULATIONS, SECTION 311. PORTABLE FACILITIES SHALL BE PLACED ON LEVEL GROUND AND AWAY FROM STORM DRAINAGE SYSTEMS (DITCHES, CATCH BASINS, ETC.). DISPOSAL AND HANDLING OF SANITARY WASTE MUST COMPLY WITH SCDEH REQUIREMENTS.
  - P. FINAL GRADES FOR GRASSED AND LANDSCAPED AREAS SHALL REQUIRE A MINIMUM OF 4-6" OF CLEAN TOP SOIL, FREE OF DEBRIS AND CONTAMINANTS, AND PREFERABLY OF NATIVE ORIGIN.

N/F  
BARNYARD OF COLUMBIA, LLC  
DB 17808 - PG 45  
TAX PARCEL # 005597-01-014

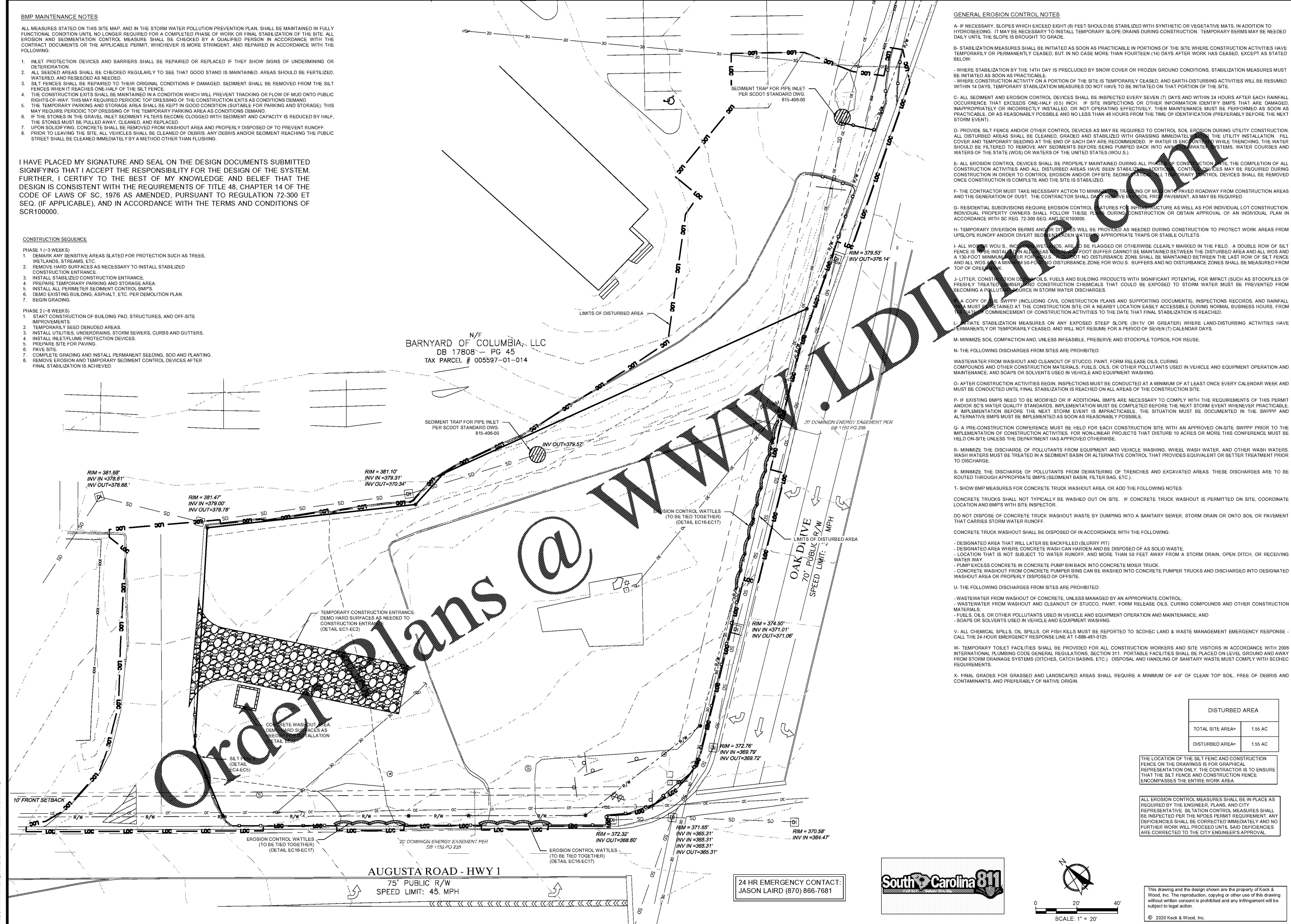

DISTURBED AREA	
TOTAL SITE AREA*	1.55 AC
DISTURBED AREA*	1.55 AC

THE LOCATION OF THE SILT FENCE AND CONSTRUCTION FENCE ON THE DRAWINGS IS FOR GRAPHICAL REPRESENTATION ONLY. THE CONTRACTOR IS TO ENSURE THAT THE SILT FENCE AND CONSTRUCTION FENCE ENCOMPASSES THE ENTIRE WORK AREA.

ALL EROSION CONTROL MEASURES SHALL BE IN PLACE AS REQUIRED BY THE ENGINEER, PLANS, AND CITY REPRESENTATIVE. SILTATION CONTROL MEASURES SHALL BE INSPECTED PER THE NPDES PERMIT REQUIREMENT. ANY DEFICIENCIES SHALL BE CORRECTED IMMEDIATELY AND NO FURTHER WORK WILL PROCEED UNTIL SAID DEFICIENCIES ARE CORRECTED TO THE CITY ENGINEER'S APPROVAL.

This drawing and the design shown are the property of Keck & Wood, Inc. The reproduction, copying or other use of this drawing without written consent is prohibited and any infringement will be subject to legal action.  
© 2020 Keck & Wood, Inc.

24 HR EMERGENCY CONTACT:  
JASON LAIRD (870) 866-7681

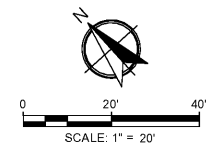

Sheet No. **C-4**

**MURPHY OIL USA, INC.**  
200 PEACH STREET  
EL DORADO, AR 71730

**MURPHY OIL USA**

**Keck & Wood**  
COLLABORATION BY DESIGN  
4825 Fisher Place Drive, Suite 210  
North Charleston, SC 29605  
(843) 278-6600  
keckandwood.com

**Erosion Control Plan - Phase I**  
Murphy Express  
4404 Augusta Road  
Keck & Wood Project No. 180167

CG	DRW
CG	DES
GS	PM
MM	PRN
08/02/20	DATE
REV-5	