

# SITE DEVELOPMENT PLANS FOR MURPHY EXPRESS COLUMBIA, SOUTH CAROLINA 4404 AUGUSTA ROAD

## GENERAL NOTES:

- CONTRACTOR SHALL BE RESPONSIBLE FOR RAISING AND REMOVAL OF THE EXISTING STRUCTURES, RELATED UTILITIES, PAVING, UNDERGROUND STORAGE TANKS AND ANY OTHER EXISTING IMPROVEMENTS AS NOTED.
- CONTRACTOR IS TO REMOVE AND DISPOSE OF ALL DEBRIS, RUBBISH AND OTHER MATERIALS RESULTING FROM PREVIOUS AND CURRENT DEMOLITION OPERATIONS. DISPOSAL WILL BE IN ACCORDANCE WITH ALL LOCAL, STATE AND/OR FEDERAL REGULATIONS GOVERNING SUCH OPERATIONS.
- THE GENERAL CONTRACTOR WILL BE HELD SOLELY RESPONSIBLE FOR AND SHALL TAKE ALL PRECAUTIONS NECESSARY TO AVOID PROPERTY DAMAGE TO ADJACENT PROPERTIES DURING THE CONSTRUCTION PHASES OF THIS PROJECT.
- WARRANTY/Disclaimer: THE DESIGNS REPRESENTED IN THESE PLANS ARE IN ACCORDANCE WITH ESTABLISHED PRACTICES OF CIVIL ENGINEERING FOR THE DESIGN FUNCTIONS AND USES INTENDED BY THE OWNER AT THIS TIME. HOWEVER, NEITHER THE ENGINEER NOR ITS PERSONNEL CAN OR DO WARRANT THESE DESIGNS OR PLANS AS CONSTRUCTED EXCEPT IN THE SPECIFIC CASES WHERE THE ENGINEER INSPECTS AND CONTROLS THE PHYSICAL CONSTRUCTION ON A CONTEMPORARY BASIS AT THE SITE.
- SAFETY NOTICE TO CONTRACTOR: IN ACCORDANCE WITH GENERALLY ACCEPTED CONSTRUCTION PRACTICES, THE CONTRACTOR SHALL BE SOLELY AND COMPLETELY RESPONSIBLE FOR CONDITIONS OF THE JOB SITE, INCLUDING SAFETY OF ALL PERSONS AND PROPERTY DURING PERFORMANCE OF THE WORK. THIS REQUIREMENT WILL APPLY CONTINUOUSLY AND NOT BE LIMITED TO NORMAL WORKING HOURS. ANY CONSTRUCTION OBSERVATION BY THE ENGINEER OF THE CONTRACTOR'S PERFORMANCE IS NOT INTENDED TO INCLUDE REVIEW OF THE ADEQUACY OF THE CONTRACTOR'S SAFETY MEASURES, IN, ON OR NEAR THE CONSTRUCTION SITE.
- ALL CONSTRUCTION WITHIN STATE HIGHWAY DEPARTMENT RIGHT-OF-WAY SHALL BE COORDINATED WITH THE HIGHWAY DEPARTMENT RESIDENT MAINTENANCE ENGINEER.
- ALL SITE WORK FOR THIS PROJECT SHALL MEET OR EXCEED THE SPECIFICATIONS OF THE RELEVANT UTILITY COMPANY OR REGULATORY AUTHORITY, AND THE SPECIFICATIONS FOR THE CONSTRUCTION OF THE EXISTING IMPROVEMENTS WHICH ARE BEING ALTERED OR REPLACED. CONTRACTOR SHALL CONTACT THE ENGINEER FOR SPECIFICATION SECTIONS FOR ITEMS SUCH AS LANDSCAPING AND IRRIGATION THAT ARE AFFECTED BY THE WORK BUT NOT COMPLETELY DETAILED OR SPECIFIED ON THESE PLANS.
- CONSTRUCTION AND INSTALLATION OF 2,824 SF BUILDING, ALL UTILITY ENTRANCES AND (2) 20,000 GALLON UNDERGROUND TANKS SHALL BE IN ACCORDANCE WITH ASSOCIATED PLANS.
- THE GENERAL CONTRACTOR TO FIELD COORDINATE THE CANOPY SIGN LOCATION WITH MURPHY'S CONSTRUCTION SUPERVISOR.
- STAGE II VAPOR RECOVERY SYSTEM IS NOT REQUIRED.

## NOTES TO CONTRACTOR

- THE CONTRACTOR SHALL PROVIDE THE ENGINEER OF RECORD WITH THE DATE WHEN CONSTRUCTION IS TO BEGIN.
- THE CONTRACTOR IS RESPONSIBLE FOR CONSTRUCTION STAKING AND LAYOUT.
- THE CONTRACTOR IS RESPONSIBLE FOR KEEPING THE ENGINEER OF RECORD OF ANY DEVIATIONS DURING CONSTRUCTION AND SHALL REPORT THEM IMMEDIATELY.
- CONTRACTOR IS REQUIRED TO KEEP REDLINE AS-BUILTS AND TO PROVIDE THOSE TO MURPHY UPON COMPLETION.
- CONTRACTOR IS RESPONSIBLE FOR UNDERSTANDING THE AS-BUILT AND CERTIFICATE OF OCCUPANCY (C.O.) REQUIREMENTS FOR THE ISSUING AUTHORITY.
- IF AN ELEVATION CERTIFICATE OR AS-BUILT SURVEY IS REQUIRED BY THE ISSUING AUTHORITY, THE CONTRACTOR SHALL BE RESPONSIBLE FOR COORDINATING THE SCHEDULING OF THE SURVEY WITH THE CIVIL CONSULTANT PRIOR TO DEADLINE FOR OBTAINING THE C.O. AND AFTER NECESSARY COMPLETED WORK TO BE SHOWN ON SURVEY.

## WETLANDS NOTE:

ANY DEVELOPMENT, EXCAVATION, CONSTRUCTION, OR FILLING IN A U.S. ARMY CORPS OF ENGINEERS DESIGNATED WETLAND IS SUBJECT TO LOCAL, STATE AND FEDERAL APPROVALS. THE CONTRACTOR SHALL COMPLY WITH ALL PERMIT REQUIREMENTS AND/OR RESTRICTIONS AND ANY VIOLATION WILL BE SUBJECT TO FEDERAL PENALTY. THE CONTRACTOR SHALL HOLD THE OWNER/DEVELOPER, THE ENGINEER AND THE LOCAL GOVERNING AGENCIES HARMLESS AGAINST SUCH VIOLATION.

## FLOOD CERTIFICATION:

THIS PROPERTY IS NOT LOCATED WITHIN ANY PRESENTLY ESTABLISHED 100-YEAR FLOOD PLAIN, AS SHOWN BY THE FEDERAL MANAGEMENT AGENCY, FLOOD INSURANCE RATE MAP 45083C0256J, DATED 07/05/2018.

## NOTICE TO BIDDERS:

ALL QUESTIONS REGARDING THE PREPARATION OF THE GENERAL CONTRACTOR'S BID SHALL BE DIRECTED THROUGH MURPHY'S CONSTRUCTION WEBSITE (HTTPS://MURPHYUSA.PROJECTMATES.COM) INCLUDING Q&A, RFIS, BID SUBMISSION, CHANGE ORDER REQUESTS, ETC. ONCE AWARDED THE CONTRACTOR SHALL COORDINATE WITH THE OWNER'S PROJECT MANAGER. SUBCONTRACTORS MUST DIRECT THEIR QUESTIONS THROUGH THE GENERAL CONTRACTOR, THE CONSULTING ARCHITECT AND/OR THE CONSULTING ENGINEER SHALL NOT BE CONTACTED DIRECTLY WITHOUT PRIOR AUTHORIZATION FROM THE OWNER/DEVELOPER.



NOTICE  
PRIOR TO BEGINNING EXCAVATION  
CALL  
1-888-721-7877  
PALMETTO UTILITY PROTECTION SERVICE  
OR VISIT  
<http://www.sc811.com>

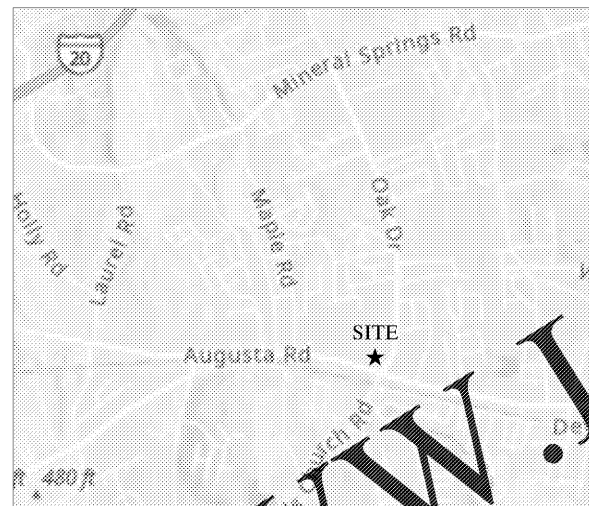

LOCATION MAP  
SCALE: 1" = 400'  
PLAN INDEX:

### ENGINEER (CIVIL)

- C-0 COVER SHEET
- C-0-1 LEGEND
- C-1 SITE PLAN
- C-1-1 OVERALL SITE PLAN
- C-2 ALTA
- C-3 GRADING PLAN
- C-3-1 STORM DRAINAGE PLAN
- C-3-2 SCDOT STORM DRAINAGE PLAN
- C-3-3 BUILDING ELEVATIONS
- C-4 EROSION CONTROL PH I
- C-4-1 EROSION CONTROL PH II
- C-5 DEMOLITION PLAN
- C-6 UTILITY PLAN
- C-6-1 SANITARY SEWER EXTENSION
- C-6-2 WIRING AND JOINT PLAN
- C-6-3 TRUCK ROAD PLAN
- C-9 EROSION CONTROL DETAILS
- C-10 EROSION CONTROL DETAILS
- C-11 EROSION CONTROL DETAILS
- C-12 SITE DETAILS
- C-13 SITE DETAILS
- C-14 SITE DETAILS
- C-15 SITE DETAILS
- C-16 DUMPSTER DETAILS
- C-16-1 CONCRETE SPECIFICATIONS
- C-17 STORM DETAILS
- C-17-1 STORM DETAILS
- C-18 WATER & SEWER DETAILS
- C-19 WATER & SEWER DETAILS
- C-20 SCDOT EXHIBITS - ACCESS PROFILE
- C-21 SCDOT EXHIBITS - SIGHT DISTANCE AND DRIVEWAY SPACING
- C-21-1 SCDOT EXHIBITS - SIGHT DISTANCE AND DRIVEWAY SPACING
- LP-1 LANDSCAPE PLAN
- LP-2 LANDSCAPE DETAILS
- IR-1 IRRIGATION PLAN
- L1.0 PHOTOMETRIC SITE PLAN

### GALLOWAY (TANK & PIPING)

- COVER COVER SHEET
- FS-1 SPECIFICATIONS
- FS-2 SPECIFICATIONS
- F-1 NOTES AND PART LIST
- F-1-1 PART LIST (ALTERNATE FUELS)
- F-2 TANK INSTALLATION AND ANCHORING DETAILS
- F-3 TANK SKID DETAILS
- F-4 TANK RISER, OBSERVATION WELL & VENTING DETAILS
- F-5 PRODUCT PIPING PLAN
- F-6 NOV FIBERGLASS PIPING SOLUTION
- F-7 DISPENSER ISLAND DETAILS
- F-8 PARTIAL PAVING PLAN
- FD-1 DISPENSER DETAILS
- FE-1 CONDUIT PLAN
- FE-2 PUMP AND DISPENSER CONTROL WIRING
- FE-3 CANOPY WIRING LAYOUT
- FE-4 VEEDER-ROOT DETAILS
- FE-5 VEEDER-ROOT SET-UP AND PROGRAMMING
- FE-6 TURBINE PUMP INSTALLATION REFERENCE
- FE-7 POWER INTEGRITY CORP. DDS WIRING
- FL-1 SIGNAGE PLACEMENT DETAILS
- FL-2 STANDARD LABELING DETAILS

### FREY MOSS (MODULAR BUILDING)

- CS1 COVER SHEET, SHEET INDEX & CODE DATA
- A1 ACCESSIBILITY STANDARDS NOTES & DETAILS
- A2 EGRESS/ACCESSIBILITY FLOOR PLAN
- S1 STRUCTURAL GENERAL NOTES
- E1 EXTERIOR ELEVATIONS
- E2 EXTERIOR ELEVATIONS
- E3 FLOOR PLAN
- E4 FLOOR FRAMING PLAN
- E5 ROOF FRAMING PLAN
- E5.1 OUTRIGGER FRAMING PLAN
- E6 SECTION
- E6a SECTION (ALTERNATE)
- E7 SECTION
- E7a SECTION (ALTERNATE)
- E8 SECTION
- E8a SECTION (ALTERNATE)
- E9 SECTION
- E9a SECTION (ALTERNATE)
- E10 SECTION
- E10a SECTION (ALTERNATE)
- E11 INTERIOR ELEVATIONS
- E12 INTERIOR ELEVATIONS
- E13 INTERIOR ELEVATIONS
- E14 FLOOR FINISH PLAN
- EL1 ELECTRICAL PLAN
- EL2 LIGHTING PLAN
- EL3 ELECTRICAL DETAILS
- EL4 ELECTRICAL PANEL SCHEDULE
- P1 PLUMBING PLAN
- P2 PLUMBING & WATER RISER
- M1 MECHANICAL PLAN
- M2 MECHANICAL ROOF PLAN
- F1 FOUNDATION PLAN
- F2 FOUNDATION DETAILS
- GC1 GENERAL CONTRACTOR SCOPE OF WORK

### FREY MOSS (CANOPY)

- CS1 COVER SHEET, SHEET INDEX & CODE DATA
- E1 FRAMING PLAN
- E2 ELEVATIONS
- E3 LIGHTING & SOFFIT PLAN
- E4 SECTION
- E5 SECTION
- E6 SECTION
- F1 FOUNDATION PLAN
- S1 STRUCTURAL GENERAL NOTES

### APPLICANT'S CERTIFICATION

I (WE) HEREBY CERTIFY THAT ALL CLEARING, GRADING, CONSTRUCTION, AND/OR DEVELOPMENT WILL BE DONE PURSUANT TO THIS PLAN AND I (WE) ARE RESPONSIBLE FOR THE LAND DISTURBANCE AND RELATED MAINTENANCE THEREOF. LEXINGTON COUNTY AUTHORITIES WILL BE ALLOWED TO ENTER THE PROJECT SITE FOR THE PURPOSED OF ON-SITE INSPECTIONS.

DATE \_\_\_\_\_ OWNER/PERSON FINANCIALLY RESPONSIBLE

### DESIGNER'S CERTIFICATION

I HEREBY CERTIFY THAT THIS PLAN IS DESIGNED TO CONTAIN SOIL ON THE PROPERTY CONCERNED TO THE MAXIMUM EXTENT, TO PROVIDE FOR THE PROTECTION OF THE PROPERTY AND THE PROPOSED IMPROVEMENTS THEREON FROM THE EFFECTS OF FLOODING, TO PROVIDE FOR THE CONTROL OF THE RUNOFF FROM THE PROPERTY, AND THAT ALL PROVISIONS FOR SEDIMENT CONTROL AND STORM DRAINAGE ARE IN ACCORDANCE WITH THE STORMWATER MANAGEMENT AND SEDIMENT CONTROL ORDINANCE FOR LEXINGTON COUNTY, SOUTH CAROLINA

DATE \_\_\_\_\_ DESIGNER'S SIGNATURE AND CERTIFICATION

## RESOURCE LIST:

### PLANNING AND ZONING

Lexington County  
Lexington County Community Development  
212 South Lake Drive  
Lexington, S.C. 29072  
(803) 785-8121  
Contact: Walt McPherson

### STORMWATER

Lexington County  
Lexington County Community Development  
212 South Lake Drive, Ste. 401  
Lexington, S.C. 29072  
(803) 785-8421  
Contact: Patrick Hinds

### WATER

City of West Columbia  
200 North 12th Street  
West Columbia, S.C. 29169  
(803) 609-2489  
Contact: Andy Zaengle

### TELEPHONE

Spectrum Business  
3179 Erie Boulevard East  
Syracuse, N.Y. 13214  
(315) 314-5178  
Contact: Omar Baez

### BUILDING

Lexington County  
Lexington County Community Development  
212 South Lake Drive  
Lexington, S.C. 29072  
(803) 785-8125  
Contact: Michael Moore

### FIRE PREVENTION

County of Lexington Fire Services  
436 Ball Park Road  
Lexington, S.C. 29072  
(803) 785-8145  
Contact: Robert Risinger

### ELECTRIC

Dominion Energy  
220 Operation Way  
Cayce, S.C. 29033  
(803) 217-4647  
Contact: Wendy Brawn

### MURPHY (OWNER)

Carlos Gutierrez (Project Manager)  
200 E. Peach Street  
El Dorado, A.R. 71730  
(870) 918-4329

### ENGINEER

Keck & Wood, Inc.  
4055 Faber Place Drive, Suite 210  
North Charleston, S.C. 29405  
(843) 279-9000  
Contact: Greg Sistrunk

### MANUFACTURER

Frey Moss Structures, Inc.  
1801 Rockdale Industrial Boulevard  
Conyers, G.A. 30012  
(770) 483-7543

### GEOTECH

United Consulting  
625 Holcomb Bridge Road  
Norcross, G.A. 30071  
(770) 209-0029

### SEWER

City of Cayce  
1800 12th Street  
Cayce, S.C. 29033  
(803) 550-9515  
Contact: Karalyn Miskie

Order Plans @ [www.lldline.com](http://www.lldline.com)



BASED ON SURVEY BY:  
KECK & WOOD, INC.  
300 TECHNOLOGY CENTER WAY, SUITE 400  
ROCK HILL, SC 29730  
EMAIL: CMORELLI@KECKWOOD.COM  
PHONE: 803-620-1300  
DATE: 02/13/2019

REVISION	DATE	DESCRIPTION
REV-0	04/24/20	INITIAL REVIEW SET
REV-1	04/28/20	UTILITY PLAN & LANDSCAPE PLAN UPDATES
REV-2	06/10/20	UTILITY PLAN UPDATES
REV-3	06/30/20	ADDRESS SCDOT COMMENTS
REV-4	07/10/20	ADDRESS SCDOT COMMENTS & LANDSCAPE PLAN UPDATES
REV-5	08/05/20	ADDRESS SCDOT COMMENTS
REV-6	08/14/20	OUT TO BID

DATE  
08/14/20  
SHEET NO.  
REV-6 C-0