

EXIT REQUIREMENTS: (NUMBER AND ARRANGEMENT OF EXITS)		
TRAVEL DISTANCE	COMMON PATH OF TRAVEL	
ALLOWABLE TRAVEL DISTANCE WITHOUT SPRINKLER: 200 FT. (TABLE 1017.2)	COMMON PATH OF TRAVEL DISTANCE WITHOUT SPRINKLER	ACTUAL COMMON PATH OF TRAVEL DISTANCE
ACTUAL TRAVEL DISTANCE: 72'-3"	75'-0"	48'-0"
MINIMUM NO. OF EXITS	ARRANGEMENT MEANS OF EGRESS	
REQUIRED: 1 PROVIDED: 2	REQUIRED DISTANCE BETWEEN EXIT DOORS DISTANCE BETWEEN EXITS SHALL BE EQUAL OR NOT LESS THAN 1/2 OF THE LENGTH OF THE MAXIMUM OVERALL DIAGONAL DIMENSION OF THE BUILDING OR AREA TO BE SERVED - MEASURED IN A STRAIGHT LINE BETWEEN EXIT DOORS OR EXIT ACCESS DOORWAYS (SECTION 1007.1.1)	ACTUAL STRAIGHT LINE DISTANCE BETWEEN EXITS EXIT #1 TO #2 = 52'-6" ACTUAL STRAIGHT LINE ACROSS PUBLIC AREA: DIAGONAL AT PUBLIC AREA = 77'-6" 1/2" DIAGONAL = 38'-9" CONCLUSION: 52'-6" (STRAIGHT DISTANCE) IS GREATER THAN 38'-9" (1/2 DIAGONAL DISTANCE) MEETS CODE

GENERAL NOTES	
1. MEANS OF EGRESS SHALL BE ILLUMINATED WITH AT LEAST ONE-FOOT CANDLE AT THE FLOOR LEVEL (WALKING SURFACE). REFER TO ELECTRICAL DRAWINGS FOR ADDITIONAL INFORMATION	
LEGEND:	
-----	= ROUTE FROM THE MOST REMOTE LOCATION IN ROOM OR SPACE TO NEAREST EXIT
-----	= DIAGONAL DISTANCE OF THE BUILDING AREA
-----	= STRAIGHT LINE DISTANCE BETWEEN EXITS
●	= MOST REMOTE POINT WITHIN THIS AREA
⊗	= ILLUMINATED EXIT SIGN AND EMERGENCY LIGHT COMBO
⊗	= EMERGENCY LIGHT W/BATTERY BACK-UP

ACCESSIBILITY SIGNS (FURNISHED AND INSTALLED BY FMS):	
(SIGN 1)	INTERNATIONAL SYMBOL OF ACCESSIBILITY
(SIGN 2)	'THIS DOOR TO REMAIN UNLOCKED WHEN BUILDING IS OCCUPIED' LETTER MIN. 1" HIGH SIGN MOUNTED ABOVE DOOR
(SIGN 3)	TACTILE EXIT SIGN - SHALL COMPLY WITH SECTION 703.3 ICC/ANSI 117.1
(SIGN 4)	RESTROOM SIGNAGE
(SIGN 5)	EMPLOYEES ONLY
NOTES: INSPECTOR MAY REQUIRE ADDITIONAL EXIT SIGNS AT THE TIME OF FINAL INSPECTION.	

ACCESSIBILITY NOTES:	
1. ACCESS TO THESE FACILITIES SHALL BE PROVIDED AT PRIMARY ENTRANCES.	
2. THE SLOPE OF PUBLIC WALKS SHALL NOT EXCEED MAX. - GROSS SLOPE OF 2%.	
3. WALKING SURFACE SLOPING GREATER THAN 2% SHALL BE SLIP RESISTANT.	
4. PROVIDE A 60"x60" MIN. LANDING ON STRIKE SIDE OF DOOR W/ 4" MIN. WIDTH IN DIRECTION OF TRAVEL.	
5. WALKS SHALL EXTEND 24" TO THE SIDE OF THE STRIKE EDGE OF A DOOR OR GATE THAT SWINGS TOWARD THE WALK.	
6. THE SLOPE OF RAMPS SHALL NOT EXCEED 1'-0" IN 12'-0" U.N.O.	
7. RAMPS SHALL HAVE A NON-SLIP SURFACE.	
8. RAMPS SHALL BE 48" WIDE MIN.	
9. EVERY REQUIRED EXIT DOORWAY SHALL BE SIZED FOR A DOOR NOT LESS THAN 3 FT. WIDE BY NOT LESS THAN 6'-8" HIGH CAPABLE OF OPENING 90° AND MOUNTED SO THAT THE CLEAR WIDTH OF THE EXIT WAY IS 32" MIN.	
10. THRESHOLD TO BE A MAX. 1/2" ABOVE ADJACENT FINISH FLOOR.	
11. MAXIMUM EFFORT TO OPERATE INTERIOR DOORS SHALL NOT EXCEED 5 LBS. FOR OTHER SWINGING DOORS, AS WELL AS SLIDING AND FOLDING DOORS, THE DOOR LATCH SHALL RELEASE WHEN SUBJECT TO A 15 POUND FORCE. THE DOOR SHALL BE SET IN MOTION WHEN SUBJECT TO 35 POUND FORCE. THE DOOR SHALL SWING TO FULL-OPEN POSITION WHEN SUBJECT TO A 15 POUND FORCE.	
12. THE BOTTOM 10" OF ALL DOORS EXCEPT AUTOMATIC AND SLIDING DOORS SHALL HAVE A SMOOTH UNINTERRUPTED SURFACE.	
13. PROVIDE LEVER TYPE HARDWARE, PANIC BARS, PUSH - PULL ACTIVATING BARS, OR OTHER HARDWARE DESIGNED TO PROVIDE PASSAGE WITHOUT REQUIRING THE ABILITY TO GRASP THE OPENING HARDWARE TO 44" A.F.F.)	
14. EVERY EXIT DOOR SHALL BE OPENABLE FROM THE INSIDE WITHOUT THE USE OF A KEY OR SPECIAL KNOWLEDGE OR EFFORT. FLUSH OR SURFACE BOLTS SHALL BE AUTOMATIC TYPE. LOCKABLE DOORS SHALL BE PROVIDED WITH A SIGN STATING "THESE DOORS TO REMAIN UNLOCKED WHEN BUILDING IS OCCUPIED" IN MIN. 1" HIGH LETTERS.	
15. EXIT SIGNS WHERE NOTED OR REQUIRED SHALL BE WORDED "EXIT" IN LETTERS HAVING THE PRINCIPAL STROKE OF NOT LESS THAN 3/4" WIDE AND 6" HIGH AND SHALL CONFORM TO THE APPLICABLE CODES.	
16. PROVIDE ILLUMINATED EXIT SIGNS AND EMERGENCY LIGHTING AT ALL EXIT CORRIDORS AS REQUIRED BY CODE. EMERGENCY LIGHTING SHALL PROVIDE ILLUMINATION OF ONE FOOT CANDLE AT FLOOR LEVEL.	
17. DOORS TO ACCESSIBLE SANITARY FACILITIES SHALL BE IDENTIFIED BY 1/4" THICK GEOMETRIC SYMBOLS OF CONTRASTING COLOR.	
18. POST INTERNATIONAL SYMBOL OF ACCESSIBILITY ON OR ADJACENT TO ALL ACCESSIBLE BUILDING ENTRANCES.	

GreenbergFarrow
21 South Evergreen Avenue
Suite 200
Arlington Heights, Illinois 60005
t: 847.788.9200

COPYRIGHT NOTICE
This drawing is the property of the above referenced Professional and is not to be used for any purpose other than the specific project and site named herein, and cannot be reproduced in any manner without the express written permission from the Professional.

ISSUE RECORD

DATE	REV.	DESCRIPTION
05/20/2020		PERMIT SUBMISSION SET
06/07/2020	1	OUT TO BID SET

Order Plans @ www.LDLine.com

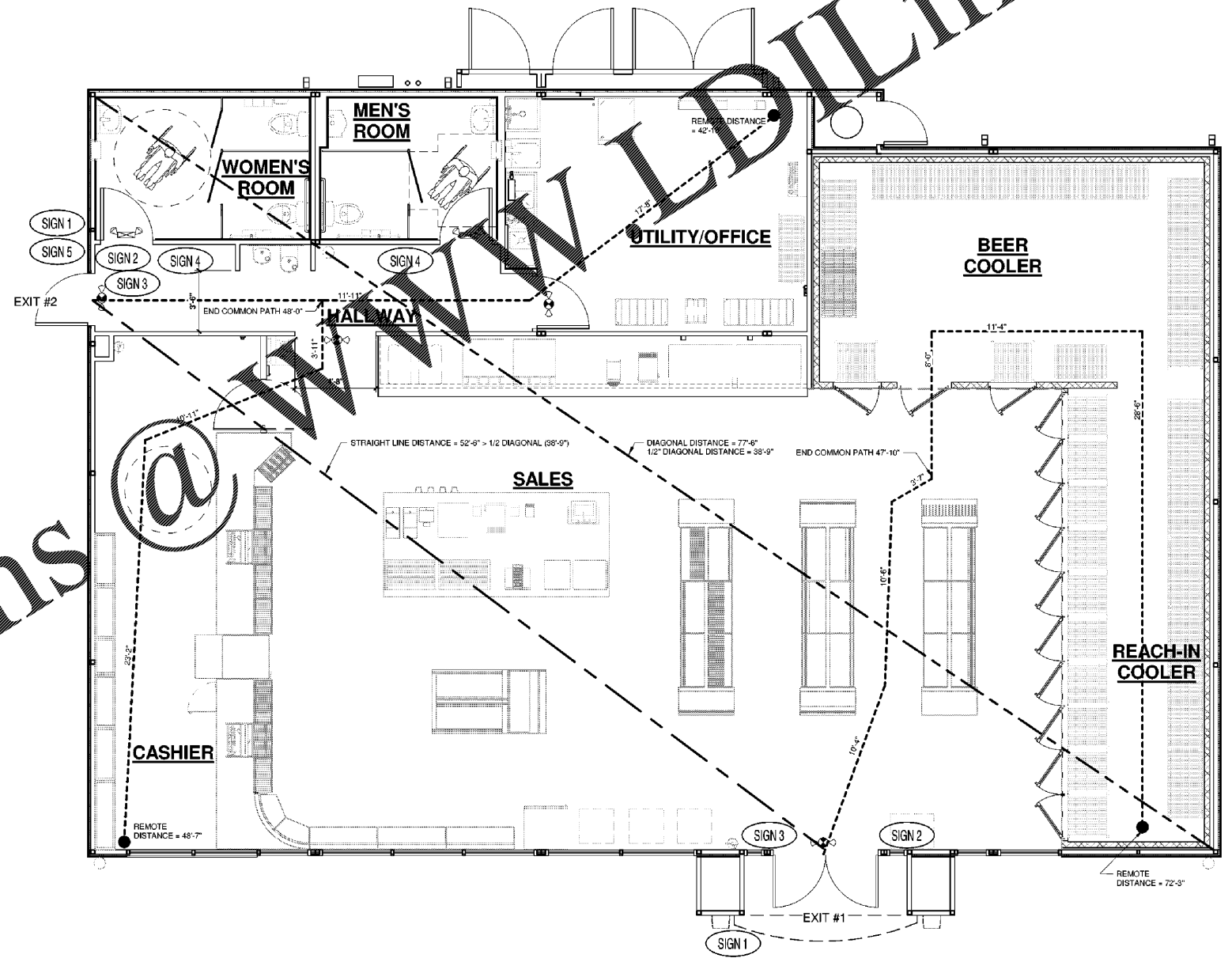

1 EGRESS/ACCESSIBILITY FLOOR PLAN
1/4" = 1'-0"

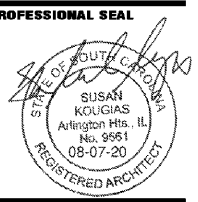
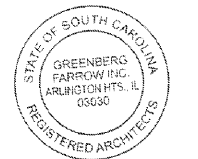

PROFESSIONAL IN CHARGE
SUSAN NELSON KOUGIAS

PROJECT MANAGER
JOHN NASHED

QUALITY CONTROL
CHRIS CERBO

DRAWN BY
SS

PROJECT NAME
MURPHY EXPRESS
MURPHY OIL CONVENIENCE STORE
4400 AUGUSTA RD & OAK DR,
LEXINGTON
SOUTH CAROLINA 29073

FREY MOSS STRUCTURE
1801 Rockdale Industrial Blvd.
Conyers, Georgia 30012
Voice: (800) 368-6385
Fax: (770) 408-6037
FMS JOB NUMBER: 020M100001
FMS MODEL NUMBER: XXXXXX

PROJECT NUMBER
20181975.5

SHEET TITLE

EGRESS/ACCESSIBILITY FLOOR PLAN

SHEET NUMBER

A2