

PARTITION TYPE SCHEDULE			
TYPE	SYMBOL	ASSEMBLY	NOTES
4M		ONE LAYER 5/8" CWB ON EACH SIDE OF 3 5/8" COLD FORMED METAL FRAMING (20 GA. MIN.) AT 16" O.C. EXTEND FRAMING AND CWB TO 14'-10" AFF	
4M-SP		SMOKE PARTITION: ONE LAYER 5/8" CWB APPLIED TO EACH SIDE OF 3 5/8" COLD FORMED METAL FRAMING (20 GA. MIN.) AT 16" O.C. WITH SOUND BATTS, EXTEND FRAMING AND CWB TO 14'-10" AFF	THE SUSPENDED CEILING SYSTEM IS USED AS A COMPONENT OF THE SMOKE RESISTING SYSTEM PER NFPA 8.4.2 (2).
4Ma		ONE LAYER 5/8" CWB ON EACH SIDE OF 3 5/8" COLD FORMED METAL FRAMING (20 GA. MIN.) AT 16" O.C. WITH SOUND BATTS, EXTEND FRAMING AND CWB TO 14'-10" AFF	

PLAN LEGEND	
	COLUMN GRID AND/OR WALL CENTER LINES
	MARKER BOARD OR TACKBOARD
	FIRE EXTINGUISHER CABINET & FIRE EXTINGUISHER
	SURFACE MOUNTED FIRE EXTINGUISHER
	DOOR NUMBER
	WINDOW NUMBER
	MILLWORK TYPE/BUILDING ELEVATION MARKER

- GENERAL NOTES**
- ALL INTERIOR WALLS ARE PARTITION TYPE "4M" UNLESS INDICATED OTHERWISE.
 - CONTRACTOR SHALL COORDINATE EQUIPMENT LAYOUT OF MECHANICAL/ELECTRICAL ROOMS INCLUDING, BUT NOT LIMITED TO, THE FOLLOWING: MECHANICAL FLOOR PENETRATIONS, FLOOR DRAINS, EQUIPMENT PAD SIZES & LOCATIONS, ALL ROOF PENETRATIONS, ELECTRICAL SERVICE LINE, ELECTRICAL PANELS, SWITCHGEAR SIZES & LOCATION, CIRCULATING WATER LINES.
 - WHERE PARTITIONS APPEAR TO BE CENTERED ON COLUMN LINES, THEY ARE, UNLESS DIMENSIONED OTHERWISE.
 - COORDINATE FLOOR DRAIN LOCATIONS WITH PLUMBING DRAWINGS.
 - VERTICAL PIPES, DUCTS, ROOF LEADERS & VENTS EXPOSED IN FINISHED SPACES SHALL BE ENCLOSED IN CHASE SPACES CONSTRUCTED OF SAME MATERIALS AS THE WALLS ADJACENT TO CHASE.
 - FOR SMOKE PARTITION WALLS AND SMOKE BARRIER WALLS SEAL ALL PENETRATIONS, TERMINATIONS AND VOIDS TO PREVENT THE PASSAGE OF SMOKE. REFER TO SPECIFICATIONS FOR REQUIRED SMOKE STOPPING.
 - ALL C.M.U. WALLS ARE TO BE RUNNING BOND UNLESS INDICATED OTHERWISE.
 - ALL EXPOSED VERTICAL CORNERS OF CMU PARTITIONS AND CHASES SHALL BE CONSTRUCTED OF BULLNOSE CMU EXTEND BULLNOSE CMU TO 8" ABOVE CEILING.
 - SEE UL FIRE RESISTANCE DIRECTORY, VOLUME 1, LATEST EDITION, FOR FURTHER INFORMATION REGARDING REFERENCED UL DESIGNS.
 - WHERE A SECTION OR DETAIL IS SHOWN ON DRAWINGS IT IS ASSUMED TO BE REPRESENTATIVE OF ALL LIKE OR SIMILAR CONDITIONS.
 - SEE STRUCTURAL DRAWINGS FOR SHEARWALL AND BEARING WALL LOCATIONS.
 - EXTERIOR WALLS ARE DIMENSIONED TO FACE OF BRICK, FACE OF CURTAINWALL OR FACE OF CMU.

- PLAN KEY NOTES**
- ROD SUPPORTED CANOPY
 - 12'-0" HIGH VINYL COATED (BLACK) CHAIN LINK FENCE AND GATES. PROVIDE LATCH AND LOCK HARDWARE FOR GATE.
 - INTERMEDIATE COLUMNS TO HAVE 4" CONCRETE COLUMN WRAP TO 12' AFF. COORDINATE CUT OUTS OF ELEC. CONVENIENCE OUTLETS.
 - PROVIDE TOILET ACCESSORY ITEMS 2 & 3 IN THIS LOCATION. REFER TO A1.31 FOR LEGEND.
 - EYE WASH / SHOWER LOCATION. SEE PLUMBING.
 - FORKLIFT CHARGING STATION (NIC).
 - WRAPPING STATION (NIC).
 - COPIER LOCATION (NIC).
 - REFRIGERATION LOCATION (NIC).
 - WASHER AND DRYER LOCATION (NIC). TO BE PROVIDED BY OWNER AND INSTALLED BY CONTRACTOR.
 - VENDING MACHINES LOCATION (NIC).
 - STORAGE SHELVING LOCATION (NIC).
 - CARD READER LOCATION. PROVIDE RECESSED UNIT AND MOUNT 4'-6" TO CENTER.
 - CARD READER, CAMERA & REMOTE DOOR UNLOCK AT LOCATION. FOR CARD READER PROVIDE RECESSED UNIT & MOUNT 4'-6" TO CENTER.
 - PROVIDE RECESSED "KNOX BOX" KEY VAULT. MOUNT 4'-6" TO CENTER. ALIGN WITH ADJACENT CARD READER.
 - PIPE BOLLARDS LOCATED ACROSS CHECK-IN AREA AND WORK AREA. TYPICAL.
 - 84" WIDE MECHANICAL EDGE OF DOCK LEVELER WITH 30,000 LB. CAPACITY BY COPPERLOY OR EQUAL.
 - PIT-MOUNTED PULL CHAIN MECHANICAL DOCK LEVELER. 20,000 LB. UNIFORM CAPACITY. 6'X8" MODEL RR-68-20 WITH SERVICE RANGE 12" ABOVE AND BELOW BY VESTIB OR EQUAL.
 - PROVIDE "KNOX GATE PAD LOCK" AT CHAIN LINK GATE.
 - PROVIDE "KNOX GATE KEY SWITCH" AT ELECTRIC GATE PEDESTAL.
 - AIR COMPRESSOR LOCATION (NIC).

REVISIONS/ISSUANCES		
NO.	DATE	DESCRIPTION

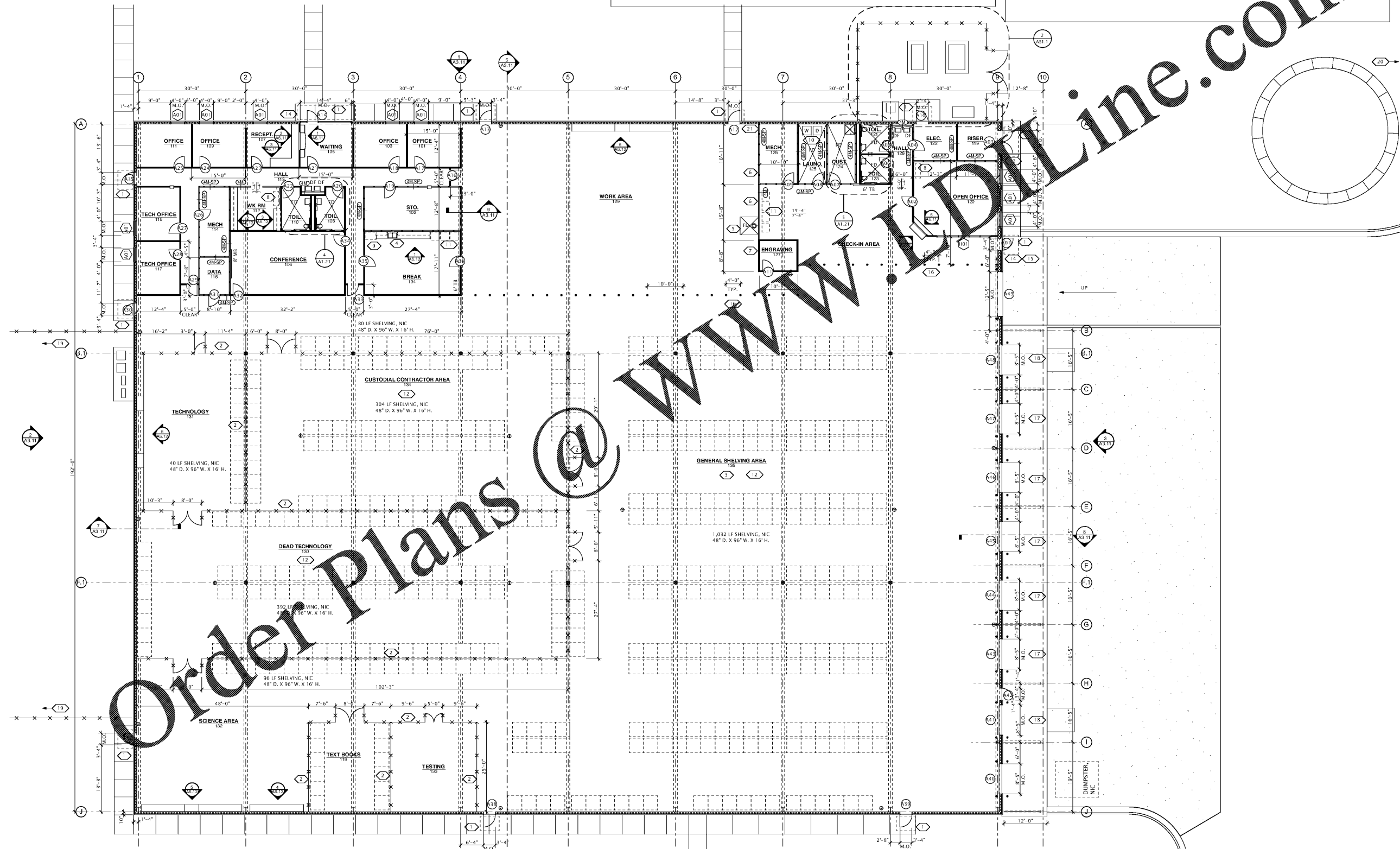

FLOOR PLAN
SCALE: 3/32" = 1'-0"



Manley Spangler Smith Architects
A Professional Corporation

525 East Taylor St.
P.O. Box 880
Goff, Georgia 30224
Office 770.227.5473
Fax 770.228.3442

PROJECT:
HENRY COUNTY SCHOOLS - DISTRIBUTION CENTER

CLIENT:
HENRY COUNTY BOARD OF EDUCATION

SHEET TITLE:
FLOOR PLAN

© 2020 Manley Spangler Smith Architects, PC
PROJECT NUMBER: 201627
DATE: 08.13.20
SCALE: AS NOTED
DRAWN BY: JS, LT
CHECKED BY: RV

SHEET NO.: **A1.11**