

EQUIPMENT PLAN- RESPONSIBILITY SCHEDULE

(Rev. 03/19)

COPIERS, FAX MACHINES, PRINTERS	BY	REMOVED	RELOCATED	RECEIVED	COMMENTS:
COMPUTER EQUIPMENT: LAPTOP, PRINTING STATIONS, CRTS, CRD, DPW, FPOS, CMW, BOC, REG, EPREG, SCANNER, CENTER SERVER, EXPRESS PAY, KIOSKS	FXO	FXO	FXO	FXO	ELECTRICAL BGC
ANCILLARY EQUIPMENT: BINDING-BINDERS, BINDER-PUNCHES, BOOKLETMAKERS, BUSINESS CARD SYSTEMS, COLLATORS, CUTTERS, DRILLS, FAST FRAME SYSTEMS, FOLDERS, GROMMET MACHINES, JOGGERS, LAMINATING MACHINES, MONEY COUNTERS, PADDERS, PERFORATE/SCORE NUMBER, ROTARY TRIMMERS, SHREDDERS, SHRINKWRAPPERS, STITCHERS, STAPLERS, TABBING EQUIPMENT	FXO/GC	FXO	GC		ELECTRICAL BGC ANCILLARY EQUIPMENT INSTALLED BY FXO FOR RELOCATION PROJECTS.
PASSPORT CAMERA	FXO	FXO	FXO	FXO	ELECTRICAL BGC
PHOTO FINISHING SYSTEMS, SONY PICTURE STATION	FXO	FXO	FXO	FXO	ELECTRICAL BGC
POSTAGE METERS, FEDEX SCALE	FXO	FXO	FXO	FXO	ELECTRICAL BGC
SAFE	FXO	GC	FXO	GC	SECURE TO FLOOR PER MFR RECOMMENDATIONS
BREAKROOM EQUIPMENT: REFRIGERATOR, MICROWAVE	GC	FXO	GC	GC	ELECTRICAL BGC
MUSIC DVR & SHELF / PLAYNETWORK EQUIPMENT	FXO	FXO	FXO	FXO	ELECTRICAL BGC

NOTES:  
1. WORK SHOWN AS FEDEX OFFICE FURNISHED/INSTALLED SHALL BE WORK FURNISHED/INSTALLED BY THE FEDEX OFFICE GENERAL CONTRACTOR SHALL COORDINATE WITH THE FXO VENDOR IF NECESSARY.  
2. GC SHALL COORDINATE ALL VENDOR SUPPLIED ITEMS, PER SCHEDULE PROVIDED BY FXO CONSTRUCTION PROJECT

EQUIPMENT/FIXTURE LEGEND

(Revised 03/19)

SYMBOL	DESCRIPTION
[Symbol]	EQUIPMENT/FIXTURE TO BE REMOVED FROM CENTER AND DESTROYED OR RELOCATED TO ANOTHER CENTER. CHOOSE FROM LIKE EXISTING EQUIPMENT/FIXTURE IN CENTER.
[Symbol]	EXISTING FIXTURE/EQUIPMENT TO BE RELOCATED FROM WITHIN EXISTING CENTER. CHOOSE FROM LIKE EXISTING EQUIPMENT/FIXTURE IN CENTER.
[Symbol]	EXISTING FIXTURE/EQUIPMENT TO BE REMOVED FROM CENTER AND RELOCATED TO ANOTHER CENTER. CHOOSE FROM LIKE EXISTING EQUIPMENT/FIXTURE IN CENTER.
[Symbol]	EXISTING EQUIPMENT/FIXTURE TO REMAIN IN EXISTING LOCATION.
[Symbol]	NEW EQUIPMENT/FIXTURE.
[Symbol]	FUTURE EQUIPMENT/FIXTURE.

EQUIPMENT AND FIXTURE PLACEMENT NOTES:

- FOR REMODEL PROJECTS, ALL EQUIPMENT TO REMAIN ON PREMISES AND FURNITURE/FIXTURES TO REMAIN ON PREMISES (SEE SHEET X-1.0 FOR REMOVAL). FOR REMODEL & RELO PROJECTS, COORDINATE EQUIPMENT REMOVAL AND UNPLUGGING OF ALL MACHINES WITH STREAM NUMBER OF BEST DISPLACEMENT. GO TO REPOSITION FOR ALL FIXTURES PLACEMENTS - A-A-3.0 AND A-3.0 FOR REVISED LOCATION.
- PROVIDE A MINIMUM CLEARANCE PATH BETWEEN ALL FURNITURE, FIXTURES AND EQUIPMENT UNLESS NOTED OTHERWISE.
- SHEET X-1.0: ALL EQUIPMENT IS TO BE RELOCATED TO PERMITS. ALL FIXTURES NOT MARKED WITH 'D' ARE TO BE REMOVED.
- SHEET A-3.0: ALL EQUIPMENT NOT MARKED WITH 'D' OR 'R' IS TO REMAIN IN PLACE. ALL FIXTURES NOT MARKED WITH 'D' ARE TO REMAIN IN PLACE.

PROJECT COORDINATOR  
**idGROUP**  
2841 IRVING BLVD.  
DALLAS, TEXAS 75207  
TEL: 214-698-6800

SEAL

DRAWING IS INCOMPLETE AND MAY NOT BE USED FOR REGULATORY APPROVAL PERMIT, OR CONSTRUCTION.

CONSULTING ENGINEER

IDS PROJECT NO.: 80-792  
MEP PROJECT NO.:  
STRUCTURAL PROJECT NO.:  
SWE PROJECT NO.:

**FedEx Office**  
SM  
JOHNSON CITY, TN  
N ROAN RD  
2116 N ROAN ST, SUITE 1A  
JOHNSON CITY, TN 37601

CENTER NO.: 0531  
SITE ID NO.: LX779947  
PROGRAM: RTSZ

**STIPULATION FOR REUSE**  
THIS DRAWING WAS PREPARED FOR USE ON A SPECIFIC SITE JOHNSON CITY, TX 37601  
03/07/2020  
AND IT IS NOT SUITABLE FOR USE ON A DIFFERENT PROJECT. A LATER TIME USE OF THIS DRAWING FOR REFERENCE OR ON ANOTHER PROJECT ASSURES THE SERVICES OF PROFESSIONAL ARCHITECTS AND ENGINEERS. REPRODUCTION OF THE DRAWING FOR REUSE ON ANOTHER PROJECT IS NOT ALLOWED UNLESS THE PROJECT OF FEDEX OFFICE. WRITERS AND SHALL NOT BE IN ANY MANNER OR USED ON ANY OTHER WORK EXCEPT BY THE AGREEMENT WITH FEDEX OFFICE. WRITERS AND SHALL NOT BE IN PREFERENCE OVER SCALED DIMENSIONS AND SHALL BE VIEWED AS THE JOB SET. BACK OFFICE IS TO BE NOTED IN WRITING (DISCREPANCIES IN DIMENSIONS PRIOR TO THE COMMENCEMENT OF ANY WORK. THESE DRAWINGS ARE INTENDED FOR DESIGN ONLY AND NOT FOR USE IN CONSTRUCTION UNLESS APPROVED SUCH BY GOVERNING AUTHORITIES.

PERMIT / BID SET

? NO. FedEx Office

NO.	REVISIONS	DATE:

PERMIT SET ISSUE DATE: 08/07/20  
BID SET ISSUE DATE: 08/07/20  
CONSTRUCTION SET ISSUE DATE: --

DRAWING TITLE:  
EQUIPMENT PLAN

DRAWING NUMBER:  
**A-3.0**

TEMPLATE (30 x 42) ISSUE: 10/29/19

EQUIPMENT ITEMS NOT SHOWN ON PLAN

- VACUUM CLEANER
  - Express Pay Cards
  - Scan Gun - Wireless
  - Dymo Label Printer
  - RACK SERVER WITH IMAGE MSC-PKG2
  - VIDEO-PKG3
- REFER TO EQUIPMENT SCHEDULE FOR STATUS OF THESE ITEMS.

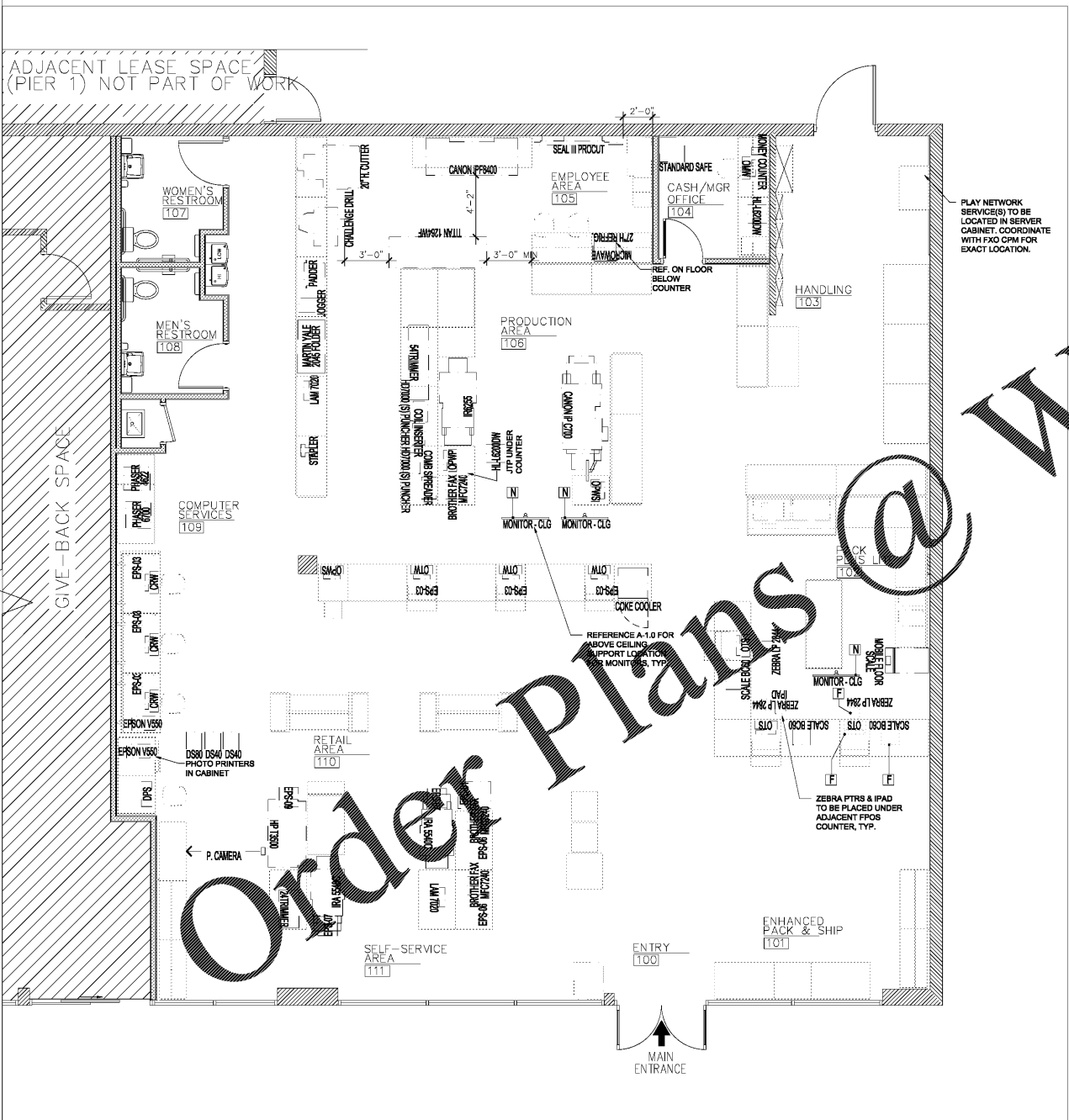

Equipment Schedule

Item ID	Description	Status	Future New	Manufacturer/Vendor	Received By Center
PPLSFT					
201844-AM	Printer, Canon IP C700 including delivery and installation	1	✓	Canon	
NCBTRFAX	Multi-Function Copier Brother Fax 7240 FX	3	✓	Brother/ Zones	
208250	Jet Ticket Printer - Printer, Brother HLL6200DW Mono Laser	2	✓	Brother/ Zones	
N/A	Coke Cooler	1	✓	Unknown	
TBD	Phaser 4622 Laser Printer - B&W	1	✓	Xerox	
601325 + 601353-AM	Printer, HP DesignJet T3500 Bundle (Self Serve oversized printer)	1	✓	HP	
601351	Zones handling fee for Xerox 6700 (Printer, Xerox Phaser 6700dn)	1	✓	Xerox	
208298-AM + 208299-AM + 208297-AM	Copier, Canon 5540, included delivery and installation	2	✓	Canon	
201967-AM + 601353-AM	Copier, IRA 6255 includes delivery & install (Low-Mid Vol Prod Copier-B&W)	1	✓	Canon	
601349-AM + 601171-AM	Printer, Canon IPF8400 install, shipping, training	1	✓	Canon	
650877	Microwave, 1100 watts, 1.1 cu ft, white, Frigidaire	1	✓	Frigidaire/ Tri County	
412500	SC888K Vacuum Cleaner	1	✓	Eureka	
RACKSERVIMAGE	Rack Server with Image	1	✓	Dell/ Zones	
424350	24" Rotatrim Rotary Trimmer	1	✓	South Coast Designs	
510111	Card Convenience FedEx (50)	1	✓	EFI	
510110	Card Team Member FedEx (50)	1	✓	EFI	
209268 + 601354	Passport Complete System, IDW510 w/ Camera, Printer, Console Tabletop Passport Photo Cutter 2 in x2 in	1	✓	DNP Imaging	
408059	Money Counter, Tellemate TY 100KB	1	✓	Tellemate, Inc.	
N/A	Safe, Depository, Large Model 3020 FL	1	✓	Defiant Safe Company	
424112	Padding Press, Challenge HandyPadder	1	✓	CFS	
650878	Refrigerator, Compact, 2.6 Cubic Feet, White, Danby	1	✓	Danby/ Tri County	
600986	Wide Format Laminator-63" max film width	1	✓	GBC	
600056	Paper Drill, Challenge EH-3C (possible refurb-601636)	1	✓	CFS	
416003	R-106 - Stapler	1	✓	Salco/Gen. Graphics Co.	
600004	Punch, PDI Rhin-O-Tuff HD7000 Coil/Comb Die (possible refurb-202020)	2	✓	CFS	
651013 + 300217	Scan Gun, MC55 Scan Gun (wireless) + Warranty, Scan Gun, MC55, one year initial warranty	1	✓	Motorola/ Symbol	
424349	Rotary Trimmer, Rotatrim, 54 inch	1	✓	South Coast Designs	
408004	Comb Spreader, 16DB	1	✓	GBC	
600530	Coil Inserter, PDI HD4170	1	✓	CFS	
408410	Laminator, Pouch, Model 7020	2	✓	CFS	
600061	Cutter, Challenge Titan 200 Includes installation (possible refurb-201533)	1	✓	CFS	
601108	Folder, Martin Yale 2045	1	✓	CFS	
600619	Jogger, Challenge Handy Jog	1	✓	CFS	
N/A	Seal III - Wall Cutter - Asbuilt Only	1	✓	--	
OTSNN	OTS Office Transaction Shipping NN	1	✓	Dell/ Zones	
550801	Video Equipment & Installation, 3 TV System	1	✓	Playnetwork Inc	
801774	Music Equipment and Installation, 2 Speaker System	1	✓	Playnetwork Inc	
301372	Samsung PM43H 43in Commercial LED LCD Display, Tizen Based P	3	✓	Samsung/Zones	
651736	G5 Hybrid USB Card Reader	6	✓	EFI	
OTWNN	OTW Office Trans Wkst Net New	3	✓	Dell/ Zones	
EPGEN3KSK	EPS-01 - Express Pay Station	1	✓	Entrac Technologies, Inc	
OPWPN	OPWP Ofc Prod Wkst Primary NN	1	✓	Dell/ Zones	
201792	Fax C500, MiniNet, Fax Station Kit	2	✓	EFI	
300172	Scale, Mobile, Heavy Duty 800lb	1	✓	Mettler/ Zones	
208463	Kit, AEC MiniNet Kit, incl M500, stand, power adapter, RJ cable	1	✓	EFI	
OPWSNN	OPWS Ofc Prod Wkst Secondary NN	2	✓	Dell/ Zones	
CRWNN	CRW Net New (Computer Rental Workstation)	3	✓	Dell/ Zones	
FPOSIPADNN	Shipping IPAD Equipment	1	✓	Zones	
OTSNN	OTS Office Transaction Shipping NN	2	✓	Dell/ Zones	
OMWNN	OMW Office Mgmt Wkst NN	1	✓	Dell/ Zones	
651164	Scanner, Epson Perfection V550, For CRW area	2	✓	Epson/ Zones	
(3) 208525 + (1) 550805 + (1) 677530 + (1) 810255 + (1) 677534 + (2) 408427	Digital Photo Station (DPS): Photo Design Station, USB 10ft Printer Cable, USB 2.0 A Male/B Male Photo Design Station, Monthly Mnt at 65 dollars for 36 months Photo Terminal, Venus 21.5 with G5 cable, media bay drives and port cover plate, cell phone cable, no windows Photo Terminal, G5 Card Reader with Bracket for Venus Photo Design Station, Printer, DS80 8x12 Photo Design Station, Printer DNP DS40 4x8 or 5x7 including installation	1	✓	DNP	
650990	Dymo Label Printer	1	✓	Dymo	
511114	Kit, M500 Copy/Print Station w/ Stand	2	✓	EFI	

1 EQUIPMENT PLAN  
1/4 = 1'-0"

NORTH