

SEAL

DRAWING IS INCOMPLETE AND MAY NOT BE USED FOR REGULATORY APPROVAL PERMIT, OR CONSTRUCTION.

CONSULTING ENGINEER

DS PROJECT NO.: 80-752  
 MEP PROJECT NO.: ---  
 STRUCTURAL PROJECT NO.: ---  
 SWI PROJECT NO.: ---

**FedEx Office<sup>SM</sup>**  
 JOHNSON CITY, TN  
 N ROAN RD  
 2116 N ROAN ST., SUITE 1A  
 JOHNSON CITY, TN 37601

CENTER NO.: 0531 SITE ID NO.: LX779947 PROGRAM: RTSZ

STIPULATION FOR REUSE  
 THIS DRAWING WAS PREPARED FOR USE ON A SPECIFIC SITE JOHNSON CITY, TX 37601  
 CONTEMPORANEOUSLY WITH ITS ISSUE DATE  
 03/07/2020

IT IS NOT SUITABLE FOR USE ON A DIFFERENT PROJECT A LATER TIME. USE OF THIS DRAWING FOR REFERENCE ON OR ON ANOTHER PROJECT ASSURES THE SERVICES OF PROPER LICENSED ARCHITECTS AND ENGINEERS. REPRODUCTION OF THIS DRAWING FOR REUSE ON ANOTHER PROJECT IS NOT ALLOWED IN ANY MANNER OR USED ON ANY OTHER WORK EXCEPT BY THE AGREEMENT WITH FEDEX OFFICE. WRITERS' DIMENSIONS TAKE PRECEDENCE OVER SCALED DIMENSIONS AND SHALL BE VERIFIED THE JOB SITE. CHECK OFFICE TO BE ADVISED BY WRITERS' DIMENSIONS IN DIMENSIONS PRIOR TO THE COMMENTARY. ANY WORK THESE DRAWINGS ARE INTENDED FOR DESIGN ONLY AND NOT FOR USE BY CONSTRUCTION UNLESS APPROVED BY GOVERNING AUTHORITIES.

PERMIT/ BID SET

? 2020 FedEx Office

NO.	REVISIONS	DATE:

PERMIT SET ISSUE DATE: 08/07/20  
 BID SET ISSUE DATE: 08/07/20  
 CONSTRUCTION SET ISSUE DATE: ---

DRAWING TITLE:

**FINISH FLOOR PLAN**  
 DRAWING NUMBER:  
**A-1.1**

TEMPLATE (30 x 42) ISSUE: 10/29/19r2

**FINISH SCHEDULE** (Revised 07.25.19)

SYMBOL	MARK	MATERIAL	MANUFACTURER	MODEL # DESIGN #	STYLE	COLOR	DESCRIPTION	PRICE	QTY	STATUS	FURNISHED	BY:	REMARKS
BASE	B-13	Thermoplastic Vinyl	Mannington	Mannington Edge	4"	Night Black	4"H With Cove/ Tse, 1/8" Thk. Ref. Note #1	---	---	---	FXO	GC	GC
	B-14	Colorbody Porcelain Tile	Dal-Tile	CD42	Porcelite - Granite Series	Grigio Scuro	6" x 12" Unpolished. Coordinating floor tile FL-20. Recommended Grout G-2.	---	---	---	FXO	GC	GC
CARPET	CP-19	Entry Carpet	Mannington	NA	Ruffan	Granite	Carpet Tile - Monolithic Installation. Ref. Note #3, #5, #13	---	---	---	FXO	GC	GC
	CP-27	Carpet	Mannington	M38068-002A- Infinity Modular	FEX4T	LW08	Carpet Tile, 24" sq. (Design 4.0) - Vertical Ashlar Orientation. Ref. Note #3, #5, #13	---	---	---	FXO	GC	GC
CEILING	CT-1	Acoustical Ceiling Tile	Armstrong	#704	Cortega Tegular	White	2'X2' Ceiling Tile. Ref. Note #5	---	---	---	GC	GC	GC
	CT-4	5/8" Gyp. Board Ceiling	See Specifications	NA	NA	P1-43		---	---	---	GC	GC	GC
	CT-5	Acoustical Ceiling Tile	Armstrong	#703	Cortega Tegular	White	2'X4' Ceiling Tile. Ref. Note #5	---	---	---	GC	GC	GC
CORNER GUARDS	CG-6	Vinyl Corner Guard	C/S Group	LG-150	Clear	Clear	1-1/2" Low Profile. Mount Top @ 45° AFF Typ. Ref. Note #4	---	---	---	GC	GC	GC
GROUT	G-2	Grout	Custom Building Products	---	Polyblend Sanded	#165 Deterioran Gray	Recommended for use at FL-20/B-14.	---	---	---	GC	GC	GC
HARD FLOORING	FL-7	Exposed Concrete	By subcontractor	NA	NA	Natural	Apply Recommended Sealer	---	---	---	GC	GC	GC
	FL-20	Colorbody Porcelain Tile	Dal-Tile	CD42	Porcelite - Granite Series	Grigio Scuro	12" x 12" Unpolished. Coordinating wall base B-14. Recommended Grout G-2.	---	---	---	GC	GC	GC
	FL-25	VCT	Armstrong	51915	Std. Excelon Imperial	Texture Charcoal	12" x 12" - 1/8" (Back Rooms) Ref. Note #3 & #11	---	---	---	GC	GC	GC
	FL-26	Luxury Vinyl Tile	Mannington	12309	Nature's Paths Rainfall	Storm	18" x 36" Tile (Design 4.0). Ref. Note #3 & #18	---	---	---	GC	GC	GC
	FL-29	Sheet Vinyl	Mannington	---	Biospec FB Tealaid Sheet	Stone Gray 10328	Sheet Vinyl (Back Rooms). Ref. Note #7.	---	---	---	GC	GC	GC
	TS-1	Transition Strip	Mannington	152	---	Black	Transition From Carpet To Resilient	---	---	---	FXO	GC	GC
	TS-2	Transition Strip	Mannington	800	---	Black	Transition From Carpet To Concrete	---	---	---	FXO	GC	GC
	TS-3	Transition Strip	Mannington	735	---	Black	Transition From Resilient To Concrete	---	---	---	FXO	GC	GC
PAINT	PT-43	Paint	Sherwin Williams	SW 7005	Pro Mar 200 Zero VOC	Pure White (Walls & Trim)	Gloss/Latex Paint. Ref. Notes #1, #4, #6	---	---	---	GC	GC	GC
	PT-58	Paint	Sherwin Williams	SW 6901	ProMar 200 Zero VOC	Dafoadi (Yellow)	Gloss/Latex Paint. Use as required per OSHA Ref. Note #4	---	---	---	GC	GC	GC
	PT-59	Paint	Sherwin Williams	SW 7005	ProMar 200 Zero VOC	Pure White (Doors & Trim)	Gloss/Latex Paint. Ref. Notes #4, #6	---	---	---	GC	GC	GC
STAIR FINISH	FL-19	Rubber (TP)	Mannington	Linear Stair Tread	Visually Impaired Safety Tread	901 Night Black	Stair Tread "Square nosed" Abrasive Surface. Riser: 0.085" thick nosed, 7" High Cove. Stringer: 0.085" thick nosed, 30" coils, 10" Cove.	---	---	---	GC	GC	GC
WALL	WC-7	Fiber Reinfr. Panel	Marlite	P-100	Textured	White	Wainscot w/ Glass Firm To Match CRP	---	---	---	GC	GC	GC
WINDOW TREATMENTS	WT-15	Window Tint	CP Films - Llumiar	NRM/PS2	Frosted Crystal	Transparent Frosted	Vinyl Window Treatments For Application. Ref. Note #9	---	---	---	GC	GC	GC
	WT-16	Window Tint	CP Films - Llumiar	NRM/PS3	Black Opaque	Black	Vinyl Window Treatments For Application. Ref. Note #9	---	---	---	GC	GC	GC
	WT-17	Window Tint	CP Films - Llumiar	NRM/PS3	White Opaque	White	Vinyl Window Treatments For Application. Ref. Note #9	---	---	---	GC	GC	GC
	WT-19	Window Tint	3M	Window Film	Night Vision 15	White	Window Film For Back and Ship Interior Window. Ref. Note #9 & #14	---	---	---	GC	GC	GC
	WT-21	Window Tint	Huper Optik	Window Film	Huper Select Sech	---	Window Film Storefront As Needed Per Site Conditions. Ref. Note #9	---	---	---	GC	GC	GC
	WT-22	Window Tint	Huper Optik	Window Film	Huper Ceramic	---	Window Film Storefront As Needed Per Site Conditions. Ref. Note #9	---	---	---	GC	GC	GC
	WT-23	Window Tint	Huper Optik	Window Film	Energy Efficient	---	Window Film Storefront As Needed Per Site Conditions. Ref. Note #9	---	---	---	GC	GC	GC
	WT-24	Mini Blinds	Budget Blinds	Signature Series	Premium Aluminum	Goose 455 S/W	1" Mini Blind (Interior Office Windows)	---	---	---	FXO	GC	GC
	WT-25	Roller Shade Blackout	Budget Blinds	Signature Series	Roller Shade	Furni-Central Taupe 8000	Video Conference Room (Exterior Windows)	---	---	---	FXO	GC	GC
	WT-26	Solar Shades	Budget Blinds	Signature Series	Roller Shade	Sparda 5 Graphite 9046	Vinyl Roller Shade (Storefront Extreme Sun)	---	---	---	FXO	GC	GC

NOTES:  
 1. TYPICAL WALL AND BASE FINISH. ALL WALLS, U.O.N. THIS IS NOT APPLICABLE ON ALL PROJECTS; REFERENCE PLAN FOR LOCATIONS.  
 2. REFERENCE REFLECTED CEILING PLAN FOR CEILING TYPES AND FINISHES. ANY PAINT FINISH IS TO BE UPDATED PER THE SCHEDULE ABOVE. COORDINATE EXTENTS WITH FXO PROJECT MANAGER.  
 3. MOVE AND REINSTALL EXISTING EQUIPMENT AND FIXTURES FOR FLOORING INSTALLATION. EQUIPMENT AND FIXTURES TO REMAIN ON PREMISES. EQUIPMENT TO BE SHUT DOWN AND UNPLUGGED BY FXO TEAM MEMBERS.  
 4. FXO PAINT COLORS ARE LISTED UNDER THE SHERWIN WILLIAMS NATIONAL ACCOUNT DATA BASE.  
 5. AT CARPET TILE, USE MANNINGTON M1-711 PVS-3.  
 6. GC TO CONTACT FEDEX OFFICE'S ACCOUNT REPRESENTATIVE AT 1-800-424-6287 TO OBTAIN FXO NATIONAL ACCOUNT PRICING. WHEN CORNER GUARD IS INSTALLED ON PAINTED WALL, GENERAL CONTRACTOR TO REMOVE CORNER GUARD PRIOR TO INSTALLATION.  
 7. WALL PAINT COLOR PRIOR TO INSTALLATION: GC CONTACT WITH SENEARTH WITH ARMSTRONG AT 1-800-442-4212 OPTION #1 TO OBTAIN FXO NATIONAL ACCOUNT PRICING THROUGH LOCAL DISTRIBUTOR.  
 8. USE PRELUDE WHITE GRID/COLOR CONTACT WITH WINDOW DEPOT, STEPHEN WALLORY, AT 770-973-4287 OR 1-855-933-3456 TO OBTAIN NATIONAL ACCOUNT PRICING.  
 9. GC TO CONTACT FEDEX OFFICE'S ACCOUNT REPRESENTATIVE AT 1-800-424-6287 TO OBTAIN FXO NATIONAL ACCOUNT PRICING.  
 10. WALLCOVERING TO BE INSTALLED AND CLEAN UP PER MANUFACTURER'S INSTRUCTIONS.  
 11. INSTALL VCT USING 3M TACKING STRIPS TO CLEAN AND SEAL VCT PER MANUFACTURER'S RECOMMENDATION.  
 12. WALLCOVERING TO BE INSTALLED ON HARD SURFACES. USE FORMULATED SOLUTIONS XT2000H ADHESIVE OR 3M FAST BOND #30 NF CONTACT ADHESIVE.  
 13. FOR SOME WINDOW REMOVALS, CARPET TO BE FURNISHED BY GC. CONTACT FXO CONSTRUCTION MANAGER FOR CLARIFICATION.  
 14. INSTALL PER MANUFACTURER'S INSTRUCTIONS. APPLY FILM TO BACK OFFICE/PRODUCTION SIDE OF GLASS --- CONTACT FXO CONSTRUCTION PROJECT MANAGER FOR CONFIRMATION.  
 15. GC TO TRIM, FINISH AND INSTALL CORNER GUARD TO FIT FULL HEIGHT OF VERTICAL CORNER OF FIXTURE. DO NOT INCLUDE AT HORIZONTAL COUNTERTOP.  
 16. REFERENCE FINISH SCHEDULE FOR DOOR/FRAME FINISHES.  
 17. INSURE WITH INSTRUCTION'S INSTRUCTIONS FOR INSTALLATION, WALL PREPARATION, AND CLEANING. DO NOT WRAP CORNERS OR CREASE. MUST USE COORDINATING CORNER GUARD (AS SCHEDULED) AT ALL EXPOSED EDGES.  
 18. USE WITH INSTRUCTION'S INSTRUCTIONS FOR INSTALLATION, WALL PREPARATION, AND CLEANING. DO NOT WRAP CORNERS OR CREASE. MUST USE COORDINATING CORNER GUARD (AS SCHEDULED) AT ALL EXPOSED EDGES.  
 19. USE WITH INSTRUCTION'S INSTRUCTIONS FOR INSTALLATION, WALL PREPARATION, AND CLEANING. DO NOT WRAP CORNERS OR CREASE. MUST USE COORDINATING CORNER GUARD (AS SCHEDULED) AT ALL EXPOSED EDGES.  
 20. USE WITH INSTRUCTION'S INSTRUCTIONS FOR INSTALLATION, WALL PREPARATION, AND CLEANING. DO NOT WRAP CORNERS OR CREASE. MUST USE COORDINATING CORNER GUARD (AS SCHEDULED) AT ALL EXPOSED EDGES.

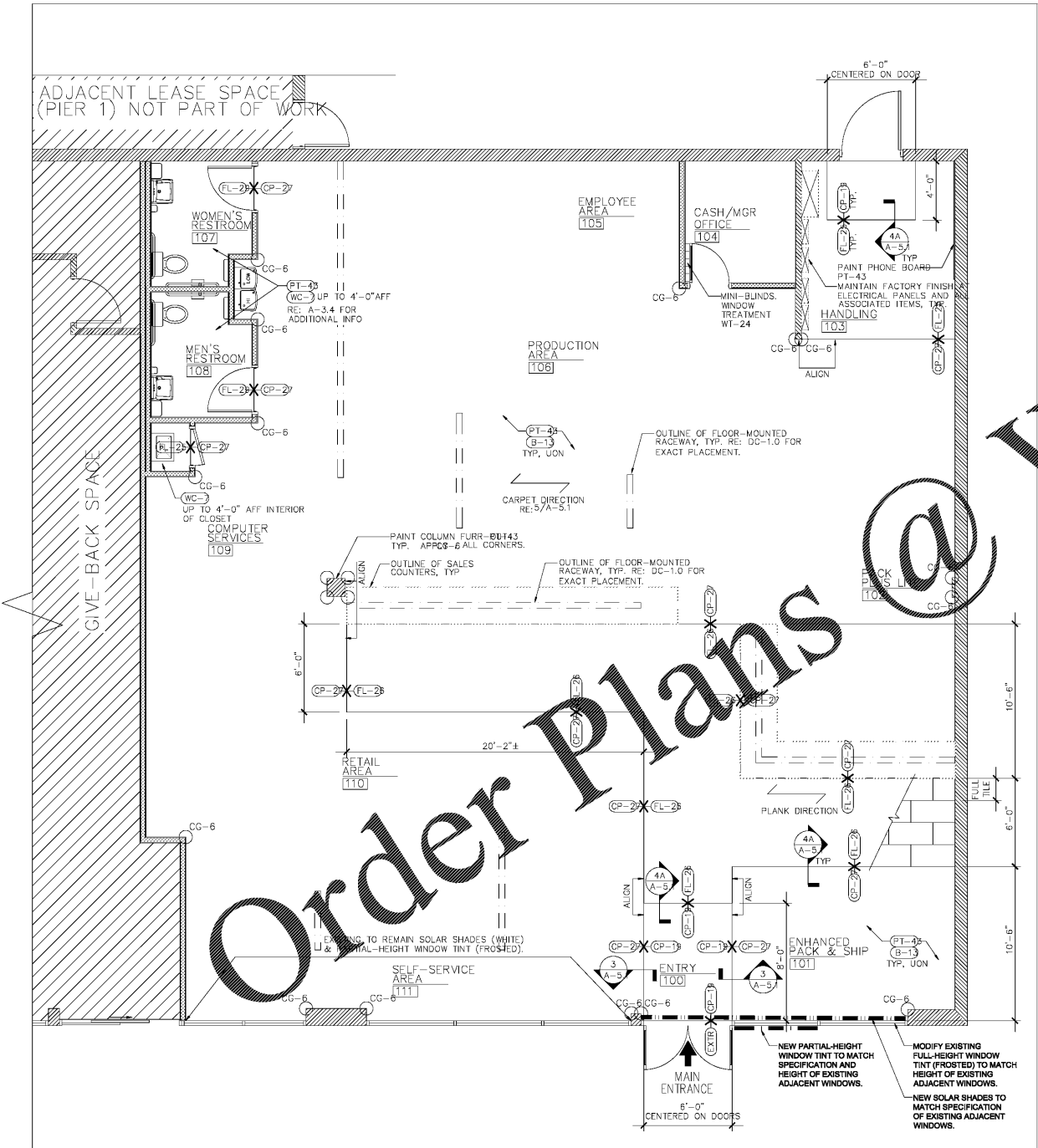

1 FINISH FLOOR PLAN  
 1/4" = 1'-0"  
 NORTH