

USER: BSPETERSON  
 FILE: \\SRV1\BIS\BIS\18106\18106\_CAD\CIVIL\PLANS\18106\_C021.dwg  
 PLOT DATE: 07/14/2020  
 PLOTTED: 17:46:50

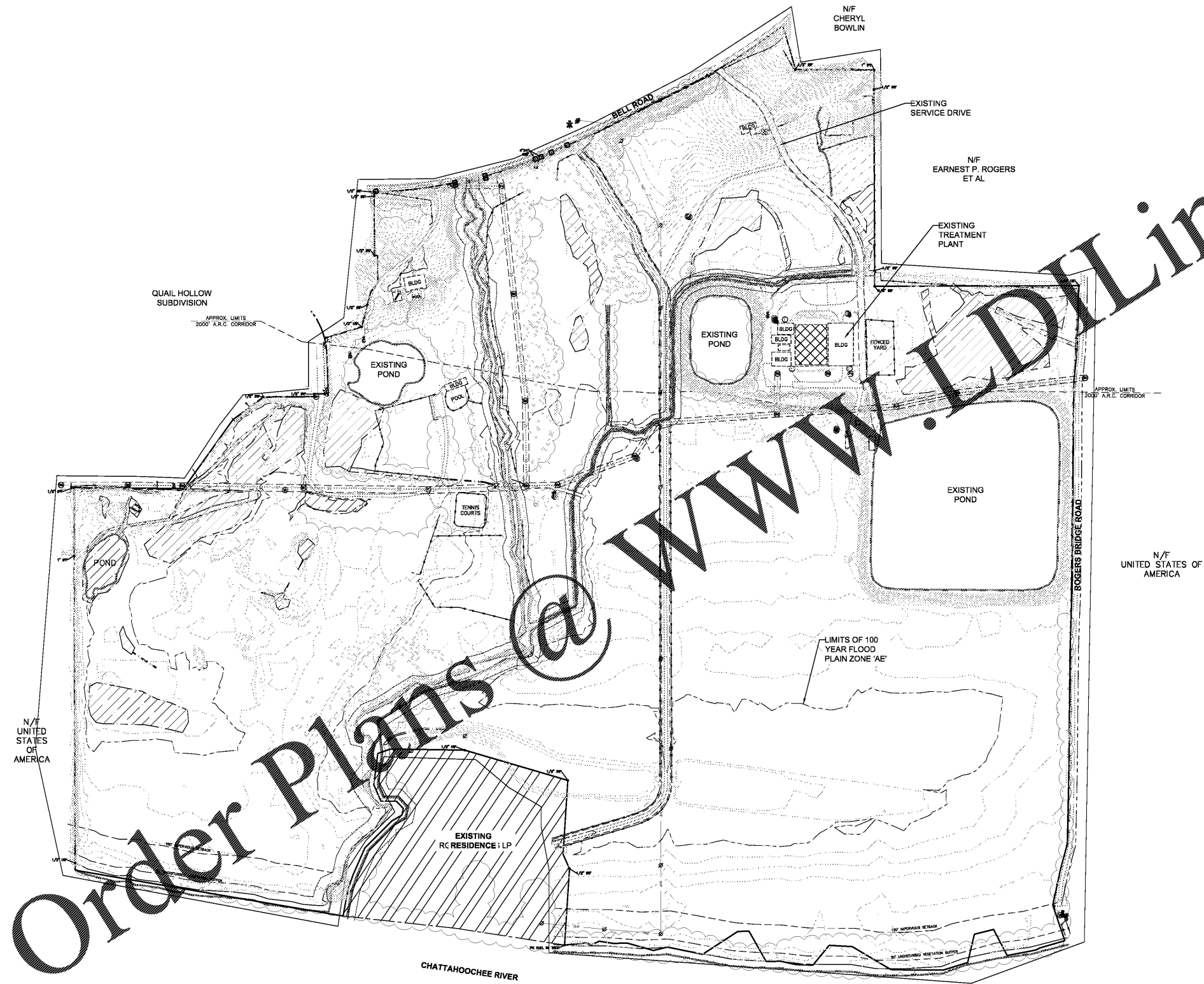

**LEGEND**

- (00) PARCEL NO.
- LOT NO.
- IRON ROD (OLD)
- IRON ROD (SET)
- PROPERTY LINE
- 520 CONTOUR LINE (MAJOR)
- 519 CONTOUR LINE (MINOR)
- UNDERGROUND ELECTRIC LINE
- 0H OVERHEAD POWER LINE
- 12 SA SANITARY SEWER LINE
- 15" ST STORM SEWER LINE
- 8" W WATER LINE
- ER ELECTRIC RISER
- ERXV ELECTRIC METER / VAULT
- TRAFFIC SIGNAL POST
- UTILITY POLE
- ↑ GUY WIRE
- TRBX TRAFFIC SIGNAL BOX
- SANITARY SEWER MANHOLE
- STORM SEWER MANHOLE
- ▒ CURB INLET
- ▒ CATCH BASIN
- CLEANOUT
- FIRE HYDRANT
- WATER METER
- WATER VALVE
- SIGN POST
- BOLLARD

Order Plans @

www.dline.com

**BARGE**  
DESIGN SOLUTIONS

**Johns Creek**  
*be the exception*



EXISTING CONDITIONS

MULTIUSE TRAIL PHASE 1 SEGMENT  
 CAULEY CREEK PARK  
 JOHNS CREEK, GA

**811** Know what's below  
 Call before you dig.  
 811  
 www.call811.com

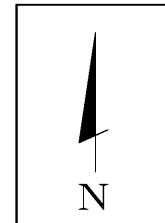

PERMIT NUMBERS:	
PARCEL ID:	FEMA PANEL: PANEL NO. 13121 C0092G EFFECTIVE DATE: 09/18/2013
DATUM:	BENCHMARK:
SCALE: 1 INCH = 200 FEET	

REV.	CHK.	DATE	DESCRIPTION
A	AKC	05/07/2020	100% OWNER REVIEW
B	AKC	06/15/2020	DRAFT BID PACKAGE
C	AKC	07/14/2020	BID PACKAGE

**C0.21**  
 FILE NO. 38106-03