

**GENERAL NOTES (THIS SHEET ONLY)**  
 1. EACH VAV BOX TO BE PROVIDED WITH A FUSIBLE DISCONNECT SWITCH. THE CIRCUIT LOADING WILL BE APPROXIMATELY 3 VAV-BOXES PER 1 CIRCUIT.

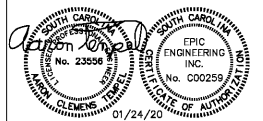

**EPIC ENGINEERING INC.**  
 P.O. BOX 2132 • MT. PLEASANT, SC 29485  
 (843) 949-6876 EPIC JOB NO. 19086



**DISCONNECT SWITCH SCHEDULE (THIS SHEET ONLY)**

SYMBOL	DESCRIPTION
◇	30A/2P/3P/NF
◇	60A/2P/3P/NF
◇	60A/1P/3P/NF

**WIRE & CONDUIT SCHEDULE (THIS SHEET ONLY)**

SYMBOL	DESCRIPTION
Ⓐ	2#10, 1#10N, 1#10G, 3/4" C
Ⓑ	2#8, 1#8N, 1#10G, 3/4" C
Ⓒ	3#6, 1#6N, 1#10G, 1" C
Ⓓ	3#8, 1#8N, 1#10G, 3/4" C
Ⓔ	2#10 1#10G, 3/4" C
Ⓕ	2#6, 1#10G, 1" C

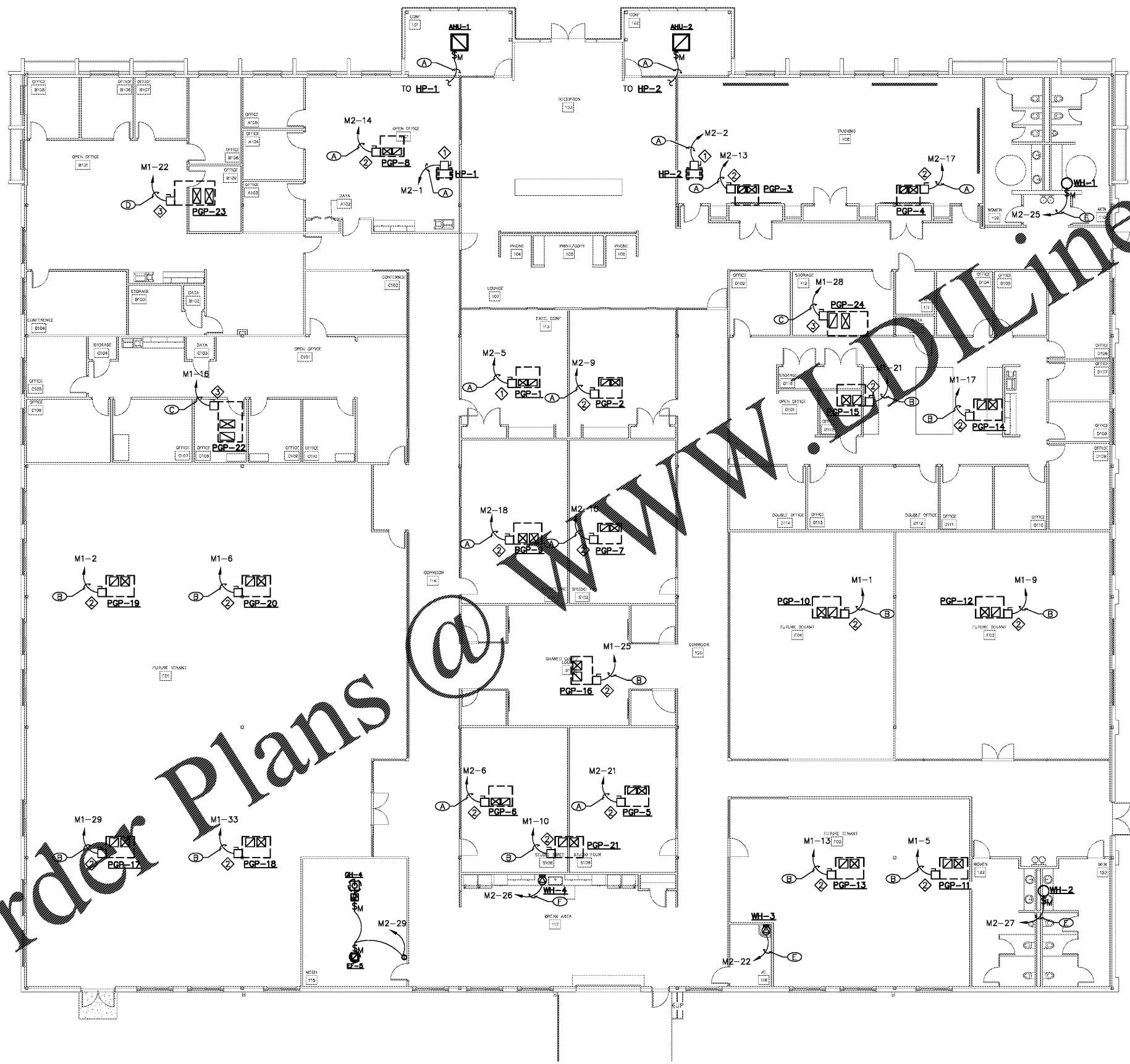

**POWER — EQUIPMENT PLAN**  
 SCALE: 1/8" = 1'-0"

Order Plans @ [www.dliline.com](http://www.dliline.com)

THE OPPORTUNITY CENTER  
 8570 RIVERS AVE N CHARLESTON, SC

SHEET ISSUE:  
 01/14/2009 Redline Set  
 01/24/2009 Final/Etd Set

PRINCIPAL IN CHARGE: ACT  
 PROJECT ENGINEER: ACT  
 DRAWN BY: RAD

SHEET TITLE:  
**POWER EQUIPMENT PLAN**

PROJ. NO. MFS 017348.00

SHEET NO.  
**E103**