



SHEET ISSUE

Revision Number	Revision Date	Revision Description
01/23/2020	Permit Set	

PRINCIPAL IN CHARGE:  
PROJECT ARCHITECT:  
DRAWN BY:

Approver  
Checker  
Author

SHEET TITLE:  
**REFLECTED  
CEILING PLAN**

PROJ. NO. 017340.00

SHEET NO.

**A200**

**CEILING LEGEND**

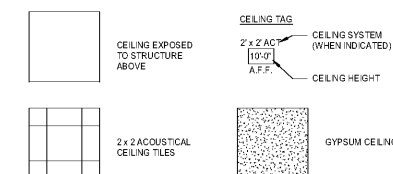

**LIGHTING GENERAL NOTES**

- ALL ANCHOR TENANT SPACES AND INCLUDE TO RECEIVE STANDARD 2X4 FLUORESCENT TROFFER FIXTURES. LINEAR DOWNLIGHTS TO RECEIVE HIGH BAY LED FIXTURES
- ALL CORRIDORS AND OPEN COMMON AREAS TO RECEIVE HIGH BAY LED FIXTURES
- UNSHARED CONFERENCE AND MEETING SPACES TO RECEIVE LED LINEAR DOWNLIGHTS AND CAN LIGHTS
- ALL SERVICE AREAS, JANITOR CLOSETS, DATA CLOSETS AND STORAGE AREAS TO RECEIVE LINEAR FLUORESCENT FIXTURES
- RESTROOMS TO RECEIVE CAN LIGHTING IN CEILING AND VANITY SCONCES AT SINKS
- ALL OFFICES AND PHONE BOOTHS TO RECEIVE LED CAN LIGHTING
- ALL SERVICE AREAS TO RECEIVE STIMBLE LIGHTING ONLY
- STIMBLE FEATURE LIGHTING TO BE SPECIFIED BY DESIGNER FOR LOBBY AREA, SHARED STUDIO ATRIUM, AND BREAK ROOM. CONTRACTOR TO CARRY ALLOWANCE IN BUDGET PRICING
- CONTRACTOR TO VERIFY ALL EXISTING AND EXTERIOR DOORS ARE EQUIPPED WITH EMERGENCY OUTDOOR LIGHTING PER CODE REQUIREMENTS
- EXIT SIGNS TO BE PROVIDED IN ALL REQUIRED LOCATIONS PER CODE
- CONTRACTOR TO COORDINATE WITH DESIGNER/ARCHITECT AND ENGINEER FOR ALL FINAL LIGHTING SELECTIONS

**LIGHTING LEGEND**

- A1 2X4 TROFFER
- A2 2X4 TROFFER - EMERGENCY
- B 4" STRIP LIGHT (STORAGE ROOMS / MECH)
- C LED SQUARE RECESSED DOWNLIGHT
- D LED RECESSED CAN - DAMP LOCATIONS
- E DIRECT/INDIRECT SUSPENDED - 8'-0"
- F EUREKA SWITCH 7470X-3-7-012012
- G ATLANTIC LIGHTING LOW BAY LED 12"
- J IMPACT LIGHTING 8" BULB IT
- K PABLO CEILO
- L ALCOON LIGHTING - 24000 ELITE LED RECESSED 2X2
- M 8'-0" STPLIGHT CHAIN HUNG

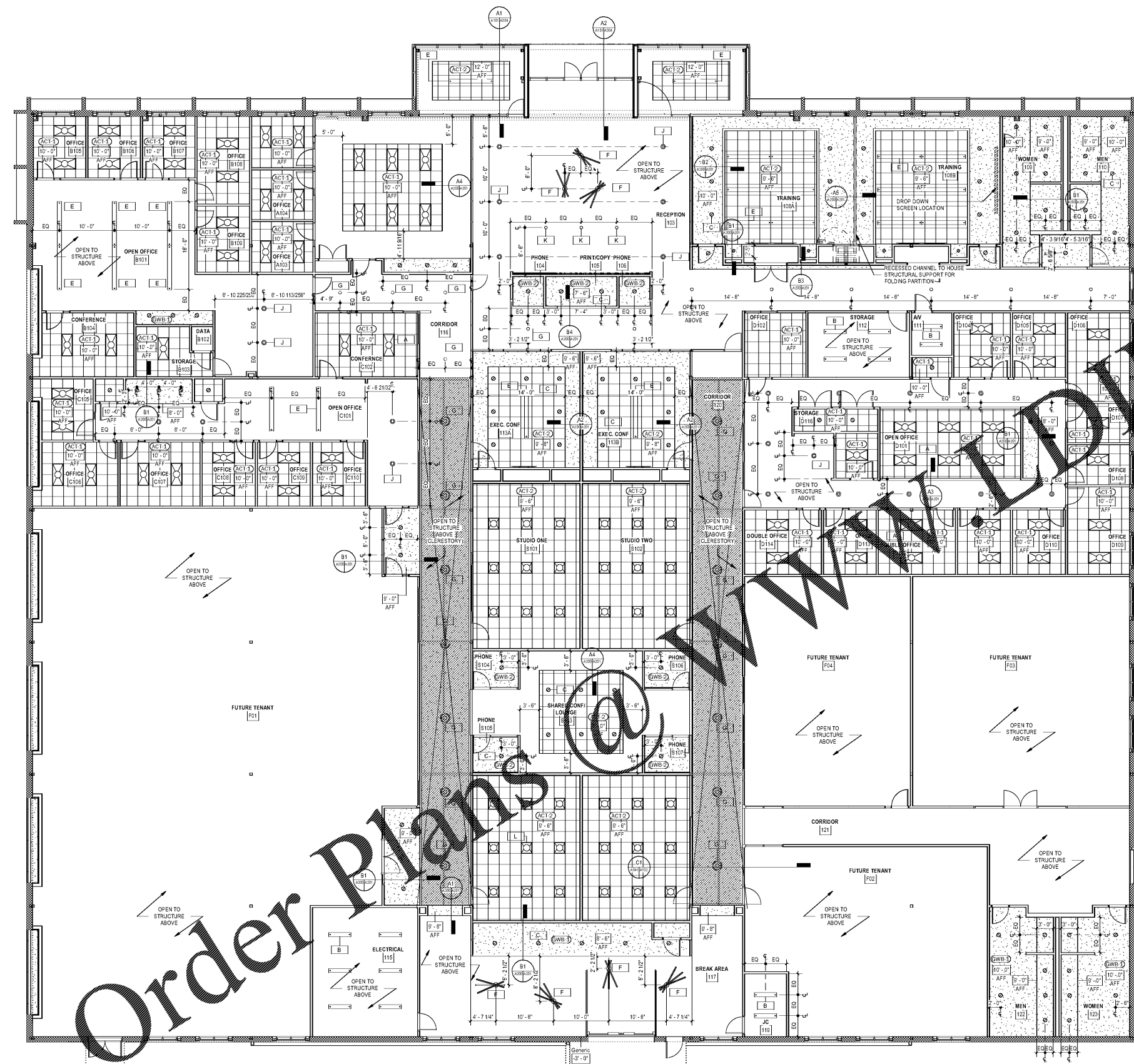

**REFLECTED CEILING PLAN**

1/8" = 1'-0"

Order Plans @ [www.drawingline.com](http://www.drawingline.com)