

GAS PIPING HANGER SPACING SCHEDULE			
STEEL PIPE, NOMINAL SIZE OF PIPE (INCHES)	SPACING OF SUPPORT (FEET)	NOMINAL SIZE OF TUBING, SMOOTH-WALL, (INCHES O.D.)	SPACING OF SUPPORT (FEET)
1/2	6	1/2	4
3/4 TO 1	8	5/8 OR 3/4	5
1-1/4 OR LARGER (HORIZONTAL)	10	7/8 OR 1 (HORIZONTAL)	8
1-1/4 OR LARGER (VERTICAL)	EVERY FLOOR LEVEL	1 OR LARGER (VERTICAL)	EVERY FLOOR LEVEL

HANGER SPACING SCHEDULE		
PIPING MATERIAL	MAXIMUM HORIZONTAL SPACING (FEET)	MAXIMUM VERTICAL SPACING (FEET)
ABS PIPE	4	10
CAST-IRON PIPE	5	15
COPPER OR COPPER ALLOY PIPE	12	10
COPPER OR COPPER ALLOY TUBING 1-1/4 INCH DIAMETER AND SMALLER	6	10
COPPER OR COPPER ALLOY TUBING 1-1/2 INCH DIAMETER AND LARGER	10	10
CROSSED-LINKED POLYETHYLENE (PEX) PIPE	2.67 (32 INCHES)	10
CROSSED-LINKED POLYETHYLENE/FLUORINOPOLYMER (PEX-AL) PIPE	2.67 (32 INCHES)	4
CPVC PIPE OR TUBING, 1 INCHES AND SMALLER	3	10
CPVC PIPE OR TUBING, 1 1/4 INCHES AND LARGER	4	10
PVC PIPE	4	10

PLUMBING LEGEND	
SYMBOL	DESCRIPTION
---	COLD WATER PIPING (CW)
---	HOT WATER PIPING (HW)
---	SANITARY SEWER (BELOW GRADE)
---	CLEAROUT
---	SANITARY VENT PIPING
---	GAS PIPING
---	SHUT-OFF VALVE RISER
---	SHUT-OFF VALVE
---	RISER DOWN (ELBOW)
---	RISER UP (ELBOW)
---	BRANCH-TOP CONNECTION
---	BRANCH-BOTTOM CONNECTION
---	TEE
---	ELBOW
WC	WATER CISTERN
LAV	LAVATORY
SRK	SINK
FOUR	FOUR
MOP SRK	MOP SINK
PC	PLUMBING CONTRACTOR
GC	GENERAL CONTRACTOR
EC	ELECTRICAL CONTRACTOR
MC	MECHANICAL CONTRACTOR

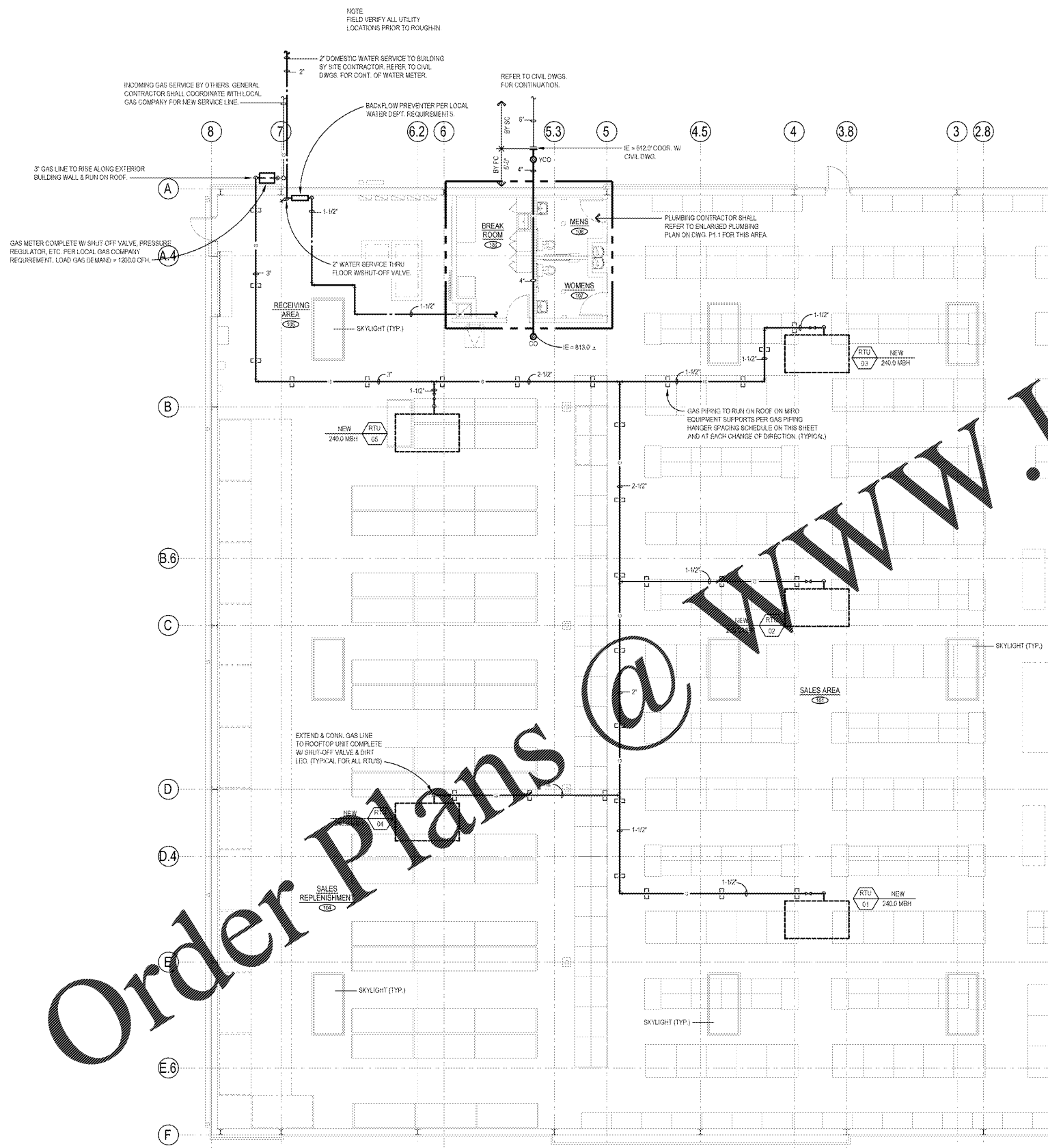

HARBOR FREIGHT TOOLS GAS DEMAND	
ROOFTOP UNIT (RTU 01, NEW)	240.0 CFH (240,000 BTU/HR)
ROOFTOP UNIT (RTU 02, NEW)	240.0 CFH (240,000 BTU/HR)
ROOFTOP UNIT (RTU 03, NEW)	240.0 CFH (240,000 BTU/HR)
ROOFTOP UNIT (RTU 04, NEW)	240.0 CFH (240,000 BTU/HR)
ROOFTOP UNIT (RTU 05, NEW)	240.0 CFH (240,000 BTU/HR)
ROOFTOP UNIT (RTU 06, NEW)	240.0 CFH (240,000 BTU/HR)
<b>TOTAL GAS DEMAND</b>	<b>1200.0 CFH (1,200,000 BTU/HR)</b>

- NOTES:**
- GAS PRESSURE APPEARS TO BE 7" WC. CONFIRM GAS DELIVERY PRESSURE PRIOR TO STARTING WORK.
  - GAS PIPE SIZES ARE BASED ON THE 2018 INTERNATIONAL FUEL GAS CODE TABLE 402.4(2) SCHEDULE 40 METALLIC PIPE, INLET PRESSURE OF LESS THAN 2 PSI; PRESSURE DROP OF 0.5 IN W.C. AND 300 FEET (TOTAL LENGTH OF PIPE).

- GAS PIPING NOTES:**
- PLUMBING CONTRACTOR TO NOTIFY THE AUTHORITY HAVING JURISDICTION WHEN THE INSTALLATION IS READY FOR INSPECTION (AT ROUGH-IN PRIOR TO COVERING AND FINAL).
  - PLUMBING CONTRACTOR SHALL FURNISH AND INSTALL GAS PRESSURE REGULATOR, MANUAL SHUT-OFF VALVE, DRIPS AND/OR SEDIMENT TRAPS AT EACH PIECE OF EQUIPMENT AND AT THE OUTLET OF THE METER. VALVES AND DRIPS SHALL BE READILY ACCESSIBLE TO PERMIT CLEANING, EMPTYING OR SERVICING.
  - GAS PIPING IS SIZED WITH LONGEST LENGTH METHOD AND BASED ON THE INTERNATIONAL FUEL GAS CODE, SCHEDULE 40 METALLIC PIPE TABLE 402.4(2).
  - PLUMBING CONTRACTOR SHALL BE RESPONSIBLE FOR PRESSURE TESTING AND INSPECTION PRIOR TO ACCEPTANCE, PER NFPA 54. TEST PRESSURE SHALL BE NO LESS THAN 1-1/2 TIMES THE MAXIMUM WORKING PRESSURE, BUT NOT LESS THAN 3 PSI. TEST SHALL BE NOT LESS THAN 1/2 HOUR PER 500 CF OF PIPE VOLUME.
  - GAS PIPING ABOVE GROUND SHALL BE SCHEDULE 40 BLACK STEEL WITH 125 POUND BLACK MALLEABLE IRON SCREWED FITTINGS FOR 2" AND SMALLER AND WELDED FOR 2-1/2" AND ABOVE. GAS PIPING COMPOUND AT JOINTS SHALL BE PER NFPA BULLETIN #54 AND LOCAL CODES. GAS VALVES SHALL BE UL LISTED FOR GAS SERVICE SUCH AS DEZURICK MODEL S-425 FOR 2" AND LESS AND MODEL F-425 FOR 2-1/2" AND LARGER. NOTE: WELDED PIPE TO BE WITH APPROVED WELD-O-LET FITTINGS.
  - GAS PIPING SERVING HARBOR FREIGHT TOOLS' LEASE SPACE IS TO BE PRIMED AND PAINTED WITH TWO (2) COATS OF RUST RESISTANT PAINT, PAINT EXTERIOR TO MATCH EXTERIOR BUILDING COLOR AND GAS PIPING ON ROOF SHALL BE PAINTED SAFETY YELLOW AS REQUIRED BY SECTION 404 OF THE INTERNATIONAL FUEL GAS CODE.

**PLUMBING PLAN**  
 SCALE: 1/8" = 1'-0"  
 FINISH FLOOR ELEVATION = 816.50'

NOTE: PIPING TO BE SUPPORTED PER SMACNA SEISMIC RESTRAINT MANUAL AND ALSO THE FEDERAL EMERGENCY MANAGEMENT AGENCY "INSTALLING SEISMIC RESTRAINTS FOR DUCT AND PIPE" AND PER TENNESSEE BUILDING CODE.

NOTE: PLUMBING CONTRACTOR SHALL REFER TO DWG. M1.3 FOR PLUMBING SPECIFICATIONS



**ARCHITECTS, INC.**  
 17710 Detroit Avenue  
 Lakewood, Ohio 44107  
 Phone (216) 521-5134  
 Fax (216) 521-4824  
 www.a2darchitects.com

**HARBOR FREIGHT TOOLS**  
 705 WYATT ROAD NORTHWEST  
 CLEVELAND, TN 37312

REVISIONS	
#	DATE
1	
2	
3	
4	
5	
6	
7	
8	
9	
10	

**PLUMBING PLAN**  
 DATE: 06/02/20  
 JOB NO.: 19155  
**P1.0**  
 SHEET NO.

Order Plans @

WWW.LDILine.com