

**ARCHITECT**  
HKS ARCHITECTS, INC.  
444-1030119  
301 ALHAMBRA CIRCLE, SUITE 800  
CORAL GABLES, FL 33134

**CIVIL ENGINEER**  
KIMLEY-HORN  
12740 GRAN BAY PARKWAY WEST  
SUITE 2350  
JACKSONVILLE, FL 32258

**STRUCTURAL CONSULTANT**  
THORNTON TOMASETTI  
101 NE 11TH AVE., SUITE 1170  
FORT LAUDERDALE, FL 33301-1139

**MEP CONSULTANT**  
THOMPSON FILE  
53 TECHNOLOGY PARKWAY 8, PEACHTREE CORNERS,  
GA 30092

**KITCHEN CONSULTANT**  
INNOVATIVE FOOD SERVICE  
11501 NORTH 45TH STREET, TAMPA, FL 33617

**WATERPROOFING CONSULTANT**  
OCC USA  
6070 Park Ln., Suite 400 Dallas, TX 75221

**CODE & LIFE SAFETY CONSULTANT**  
HOWE ENGINEERS  
101 LONGWATER CIR. NORWELL, MA 02061

**MARRIOTT SAWGRASS CABANA CLUB**

**OWNER**  
WATERMARK CAPITAL PARTNERS, LLC  
150 NORTH RIVERSIDE PLAZA SUITE 400  
CHICAGO, IL 60606

**OWNER'S CONSULTANT**  
THE JOHN HARRY GROUP INC.  
6085 SANFIELD RD. SUITE 200  
ATLANTA, GA 30328

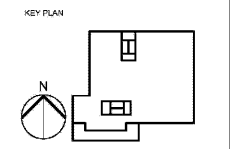

REVISION

NO.	DESCRIPTION	DATE

HKS PROJECT NUMBER  
**22808.001**

DATE  
**05/22/2020**

ISSUE  
**PERMIT SET**

SHEET TITLE  
**DETAILS - TECH SYSTEMS**

SHEET NO.  
**T3.01**

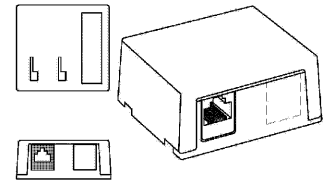
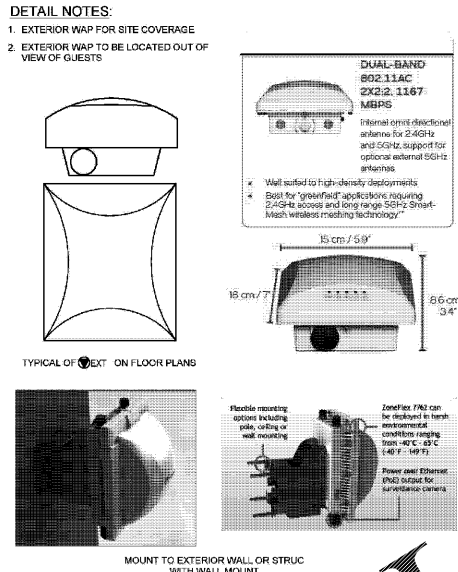
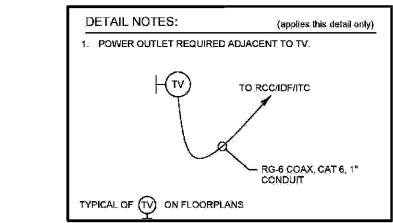
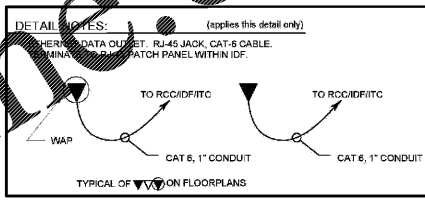
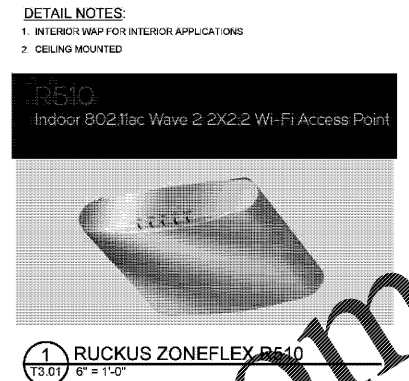

**DETAIL NOTES:**

- 4 PAIR, CAT-6 CABLE, HOMERUN TO THE NEAREST IDF. TERMINATE ONTO PATCH PANEL. GROUP ALL WIRELESS TERMINATIONS TOGETHER ON PATCH PANEL.

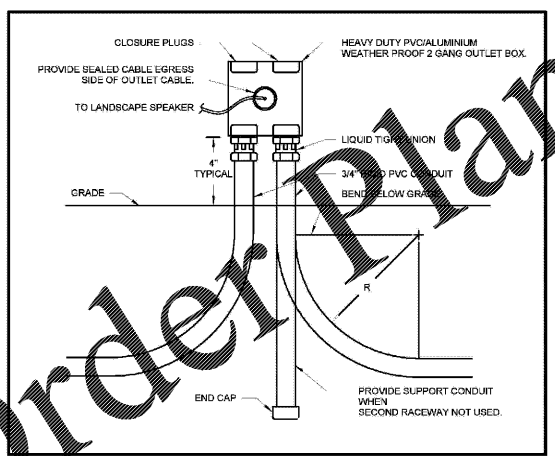
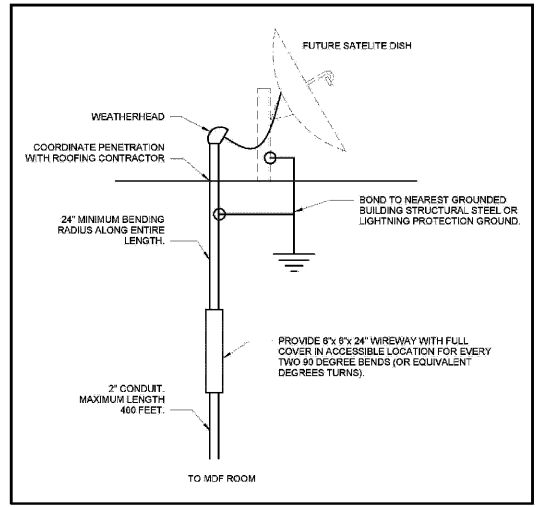
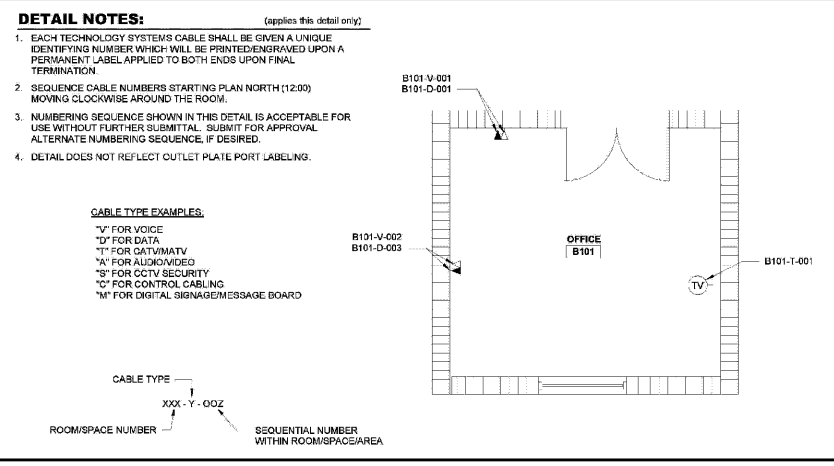
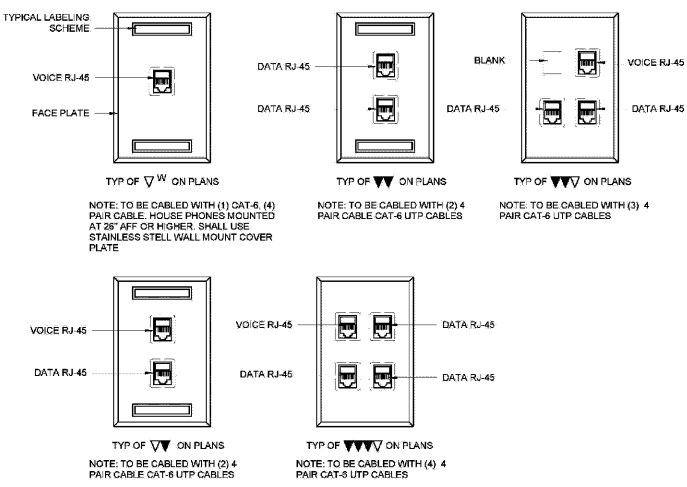
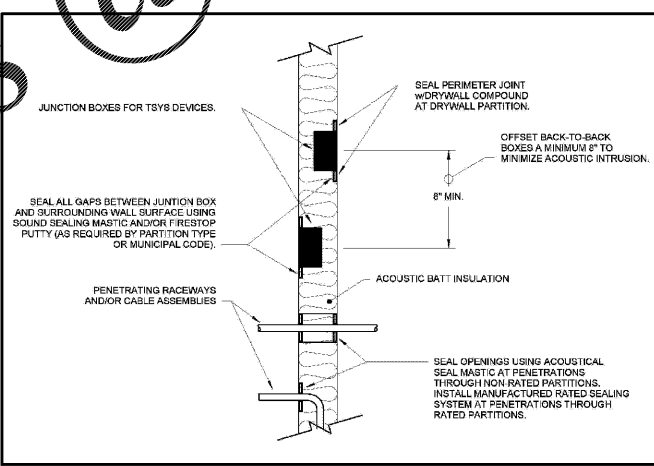
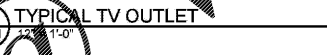
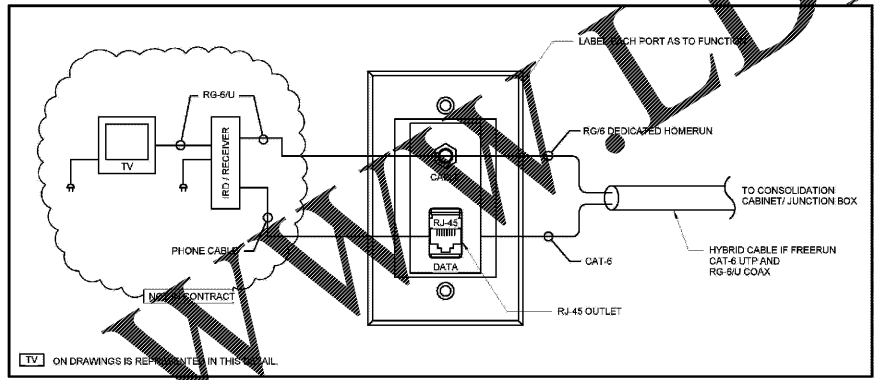
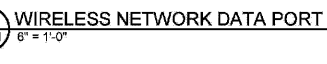

Order Plans @ [www.edilines.com](mailto:www.edilines.com)