

ARCHITECT
HKS ARCHITECTS, INC.
444 100th St
201 ALHAMBRA CIRCLE, SUITE 800
CORAL GABLES, FL 33134

CIVIL ENGINEER
KIMLEY-HORN
12740 GRAN BAY PARKWAY WEST
SUITE 2380
JACKSONVILLE, FL 32258

STRUCTURAL CONSULTANT
THORNTON TOMASETTI
101 NE 11th AVE, SUITE 1170
FORT LAUDERDALE, FL 33301-1130

MEP CONSULTANT
THOMPSON FILE
53 TECHNOLOGY PARK & PEACHTREE CORNERS
GA 30020

KITCHEN CONSULTANT
INNOVATIVE FOOD SERVICE
11501 NORTH 45th STREET, TAMPA, FL 33617

WATERPROOFING CONSULTANT
OCC USA
6070 Park Ln., Suite 400 Dallas, TX 75221

CODE & LIFE SAFETY CONSULTANT
HOWE ENGINEERS
101 LONGWATER CIR. NORWELL, MA 02061

- SHEET NOTES:**
1. PROVIDE ALL POWER AND FIRE ALARM INSTALLATIONS IN ACCORDANCE WITH ELECTRICAL SYSTEM REQUIREMENTS AND SPECIFICATIONS. ALL ELECTRICAL INSTALLATIONS SHALL COMPLY WITH THE 2017 FLORIDA BUILDING AND ENERGY CODES.
 2. COORDINATE WITH MECHANICAL AND PLUMBING DRAWINGS AND SPECIFICATIONS FOR ALL FINAL EQUIPMENT REQUIREMENTS. REFER TO ELECTRICAL EQUIPMENT SCHEDULES FOR ELECTRICAL CONNECTION REQUIREMENTS. COORDINATE ALL FINAL ELECTRICAL REQUIREMENTS WITH SUBMITTED AND APPROVED EQUIPMENT SHOP DRAWINGS.
 3. ALL 125V, SINGLE PHASE, 15A AND 20A RECEPTACLES INSTALLED IN KITCHEN AND BAR AREAS SHALL HAVE READILY ACCESSIBLE GROUND-FAULT CIRCUIT INTERRUPTER PROTECTION FOR PERSONNEL. ACCESSIBLE RECEPTACLES WITHIN THE KITCHEN AND BAR AREAS HAVE BEEN SHOWN AS GFCI TYPE DEVICES WITHIN PLANS. RECEPTACLES BEHIND FIXED EQUIPMENT HAVE BEEN PROVIDED WITH GFCI TYPE BREAKERS. REFER TO ENLARGED PLANS AND PANEL SCHEDULES FOR REQUIREMENTS.
 4. CONTRACTOR SHALL PROVIDE DISCONNECTS OR LOCKABLE BREAKERS FOR HARDWIRED KITCHEN EQUIPMENT NOT WITHIN LINE OF SIGHT FROM THE PANEL PER NEC REQUIREMENTS. COORDINATE FINAL ELECTRICAL REQUIREMENTS WITH SUBMITTED AND APPROVED FOOD SERVICE EQUIPMENT.
 5. COORDINATE EXACT LOCATIONS AND MOUNTING HEIGHTS FOR ALL ELECTRICAL DEVICES WITH ARCHITECT, INTERIORS AND FOOD SERVICE PLANS AND ELEVATIONS PRIOR TO ROUGH-IN.

KITCHEN EQUIPMENT SCHEDULE - LEVEL 02 - ELECTRICAL										
TAG	DESCRIPTION	FLA	TOTAL VA	VOLTAGE	POLES	DEVICE	PANEL	CIRCUIT NUMBER	CIRCUIT DESCRIPTION	NOTES
E202	WALK-IN COOLER	15 A	1820 VA	120 V	1	DIRECT	K2	14	2#12, 1#12G, 3#4C	
E203	MEDIUM TEMPERATURE BLOWER COIL	10 A	1200 VA	120 V	1	DIRECT	K2	16	2#12, 1#12G, 3#4C	
E213	WORK TABLE WITH PREP SINK	15 A	1820 VA	120 V	1	5-20R	K2	10	2#12, 1#12G, 3#4C	
E214	WORK TABLE WITH PREP SINK	15 A	1820 VA	120 V	1	5-20R	K2	12	2#12, 1#12G, 3#4C	
E217	UNDERCOUNTER REFRIGERATOR	3 A	360 VA	120 V	1	5-15R	K2	11	2#12, 1#12G, 3#4C	
E222	WORK TABLE CONVENIENCE OUTLET	15 A	1820 VA	120 V	1	5-20R	K2	7	2#12, 1#12G, 3#4C	
E222	WORK TABLE CONVENIENCE OUTLET	15 A	1820 VA	120 V	1	5-20R	K2	9	2#12, 1#12G, 3#4C	
E225	COFFEE BREWER / DISPENSER	30 A	6240 VA	208 V	2	5-30R	K2	6,8	2#6, 1#12G, 3#4C	
E228	ICE MACHINE	20 A	4180 VA	208 V	2	DIRECT	K2	2,4	2#10, 1#12G, 3#4C	
E233	SCRAP COLLECTOR	4 A	1440 VA	208 V	3	DIRECT	K2	1,3,5	3#12, 1#12G, 3#4C	
E237	DISH MACHINE, HIGH TEMPERATURE	50 A	21600 VA	208 V	3	DIRECT	MCP	2	3#2, 1#6G, 1,1#12C	
E201	REFRIGERATED PREP TABLE	5 A	600 VA	120 V	1	5-15R	K2	34	2#12, 1#12G, 3#4C	
E262	STONE HEARTH OVEN	10 A	1200 VA	120 V	1	DIRECT	K2	13	2#12, 1#12G, 3#4C	INTERLOCKED WITH UNIT EXHAUST FAN.
E273	LANDING COUNTER CONVENIENCE	15 A	1820 VA	120 V	1	5-20R	K2	35	2#12, 1#12G, 3#4C	
E273	LANDING COUNTER CONVENIENCE	15 A	1820 VA	120 V	1	5-20R	K2	32	2#12, 1#12G, 3#4C	
E273	LANDING COUNTER CONVENIENCE	15 A	1820 VA	120 V	1	5-20R	K2	17	2#12, 1#12G, 3#4C	
E276	UNDERCOUNTER REFRIGERATOR	3 A	360 VA	120 V	1	5-15R	K2	33	2#12, 1#12G, 3#4C	
E281	WORK COUNTER WITH SINKS	15 A	1820 VA	120 V	1	5-20R	K2	18	2#12, 1#12G, 3#4C	
E281	WORK COUNTER WITH SINKS	15 A	1820 VA	120 V	1	5-20R	K2	20	2#12, 1#12G, 3#4C	
E289	UNDERCOUNTER REFRIGERATOR	3 A	360 VA	120 V	1	5-15R	K2	19	2#12, 1#12G, 3#4C	
E297	GLASS WASHER, HIGH TEMPERATURE	40 A	8320 VA	208 V	2	DIRECT	K2	21,23	2#6, 1#12G, 1#12C	
E299	CORNER DRINKBOARD CONVENIENCE	15 A	1820 VA	120 V	1	5-20R	K2	22	2#12, 1#12G, 3#4C	
E301	BLENDER STATION	15 A	1820 VA	120 V	1	DIRECT	K2	24	2#12, 1#12G, 3#4C	CONTRACTOR TO EXTEND CIRCUIT TO BLENDER STATION RECEPTACLE.
E308	SODA GUN	10 A	1200 VA	120 V	1	5-15R	K2	25	2#12, 1#12G, 3#4C	
E309	DRINKBOARD WITH GLASS RACK CONVENIENCE	15 A	1820 VA	120 V	1	5-20R	K2	26	2#12, 1#12G, 3#4C	
E318	PASS THRU BACK BAR COOLER, BOTTLES	6 A	720 VA	120 V	1	5-15R	K2	29	2#12, 1#12G, 3#4C	
E321	POS SYSTEM WITH PRINTER	10 A	1200 VA	120 V	1	5-15R	K2	28	2#12, 1#12G, 3#4C	
E321	POS SYSTEM WITH PRINTER	10 A	1200 VA	120 V	1	5-15R	K2	27	2#12, 1#12G, 3#4C	
E327	DRINKBOARD WITH GLASS RACK CONVENIENCE	15 A	1820 VA	120 V	1	5-20R	K2	31	2#12, 1#12G, 3#4C	
E332	SODA GUN	10 A	1200 VA	120 V	1	5-15R	K2	30	2#12, 1#12G, 3#4C	
E337	POS SYSTEM WITH PRINTER	15 A	1820 VA	120 V	1	5-20R	L2	15	2#12, 1#12G, 3#4C	

- NOTES:**
1. COORDINATE ALL ELECTRICAL DEVICE LOCATIONS AND ELEVATIONS WITH FOOD SERVICE AND ARCHITECTURAL DRAWINGS PRIOR TO ROUGH-IN.
 2. REFER TO FOOD SERVICE DRAWINGS FOR ALL BEVERAGE CONDUIT REQUIREMENTS AND COORDINATE INSTALLATION WITH ALL OTHER TRADES.

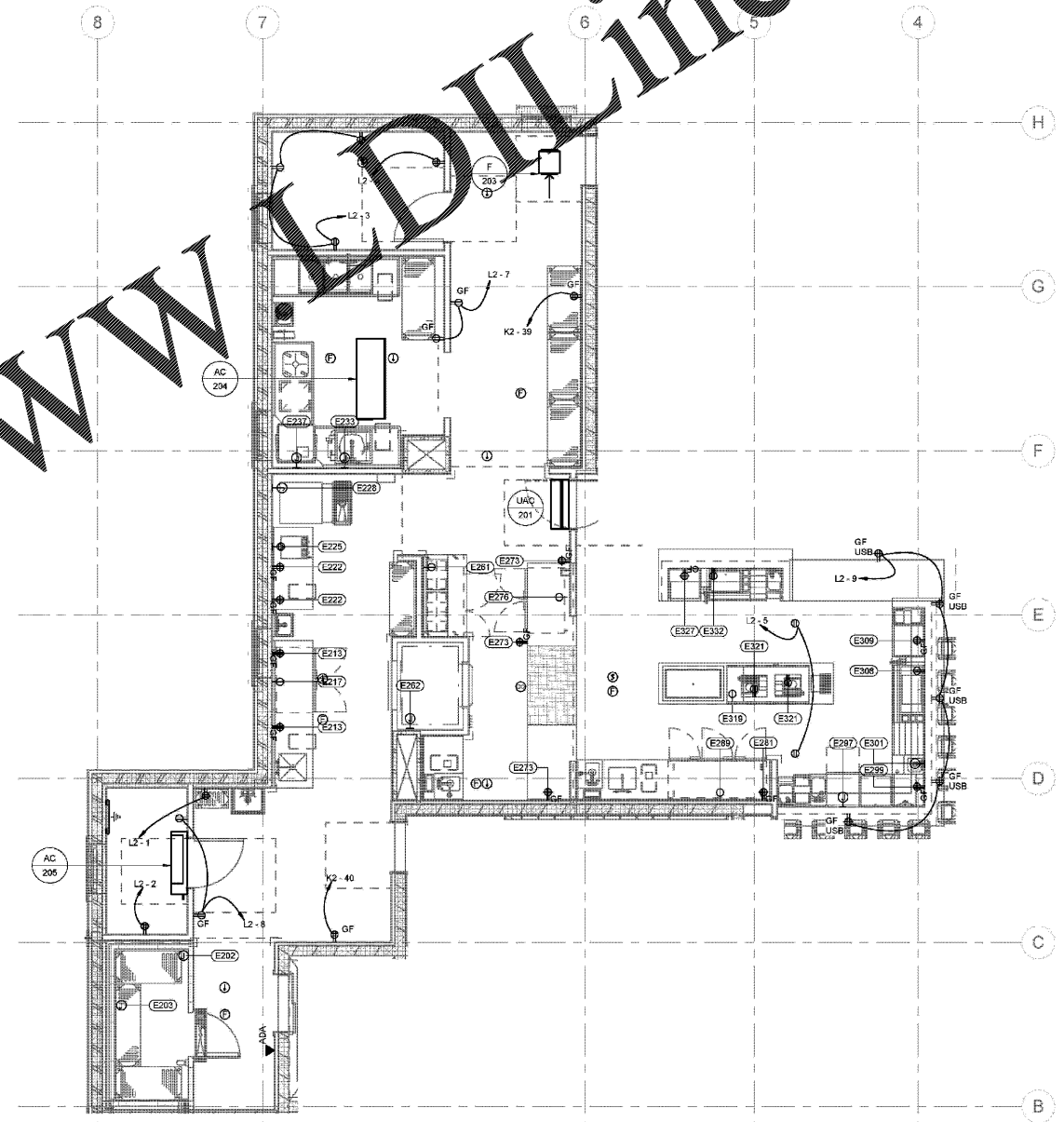

1 ENLARGED PLAN - LEVEL 02 KITCHEN - POWER
E2.11 1/4" = 1'-0"

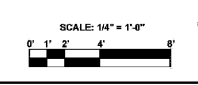

Thompson File Company
www.thompsonfile.com
Tel: 713.518.1428
TEC Project #219618
© 2018 HKS ARCHITECTS, INC.

REVISION NO.	DESCRIPTION	DATE

HKS PROJECT NUMBER
22808.001

DATE
05/22/2020

ISSUE
PERMIT SET

SHEET TITLE
ENLARGED PLAN - ELECTRICAL

SHEET NO.
E2.11

Order Plans @ www.LDLine.com

MARRIOTT SAWGRASS CABANA CLUB

OWNER
WATERMARK CAPITAL PARTNERS, LLC
150 NORTH RIVERSIDE PLAZA, SUITE 400
CHICAGO, IL 60606

OWNER'S CONSULTANT
THE JOHN HARRY GROUP INC.
6085 DANFELD RD., SUITE 200
ATLANTA, GA 30328

Designer: Kowalski, State of Florida, Professional Engineer, License No. 7781
This sheet has been electronically signed and sealed by Designer Kowalski, on the Date and/or Time Stamp with a digital signature.
Physical copies of this document are not considered signed and sealed, and the signature must be verified on any electronic copy.

