

## MARRIOTT SAWGRASS CABANA CLUB

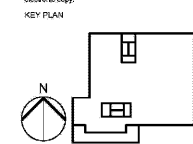

REVISION NO.	DESCRIPTION	DATE

HKS PROJECT NUMBER  
**22808.001**  
DATE  
**05/22/2020**  
ISSUE  
**PERMIT SET**

SHEET TITLE  
**FLOOR PLAN - LEVEL 01 & 02 - POWER**

SHEET NO.  
**E2.01**

Thompson File Company  
www.thompsonfile.com  
Tel: 718.518.1428  
TEC Project #219918

- SHEET NOTES:**
- 1 PROVIDE ALL POWER AND FIRE ALARM INSTALLATIONS IN ACCORDANCE WITH ELECTRICAL SYSTEM REQUIREMENTS AND SPECIFICATIONS. ALL ELECTRICAL INSTALLATIONS SHALL COMPLY WITH THE 2017 FLORIDA BUILDING AND ENERGY CODES.
  - 2 COORDINATE WITH MECHANICAL AND PLUMBING DRAWINGS AND SPECIFICATIONS FOR ALL FINAL EQUIPMENT REQUIREMENTS. REFER TO ELECTRICAL EQUIPMENT SCHEDULES FOR ELECTRICAL CONNECTION REQUIREMENTS. COORDINATE ALL FINAL ELECTRICAL REQUIREMENTS WITH SUBMITTED AND APPROVED EQUIPMENT SHOP DRAWINGS.
  - 3 ALL 125V, SINGLE PHASE, 15A AND 20A RECEPTACLES INSTALLED IN KITCHEN AND BAR AREAS SHALL HAVE READILY ACCESSIBLE GROUND-FAULT CIRCUIT INTERRUPTER PROTECTION FOR PERSONNEL. ACCESSIBLE RECEPTACLES WITHIN THE KITCHEN AND BAR AREAS HAVE BEEN SHOWN AS GFCI TYPE DEVICES WITHIN PLANS. RECEPTACLES BEHIND FIXED EQUIPMENT HAVE BEEN PROVIDED WITH GFCI TYPE BREAKERS. REFER TO ENLARGED PLANS AND PANEL SCHEDULES FOR REQUIREMENTS.
  - 4 CONTRACTOR SHALL PROVIDE DISCONNECTS OR LOCKABLE BREAKERS FOR HARDWARED KITCHEN EQUIPMENT, NOT WITH LINE OF SIGHT FROM THE PANEL PER NEC REQUIREMENTS. COORDINATE FINAL ELECTRICAL REQUIREMENTS WITH SUBMITTED AND APPROVED FOOD SERVICE EQUIPMENT.
  - 5 COORDINATE EXACT LOCATIONS AND MOUNTING HEIGHTS FOR ALL ELECTRICAL DEVICES WITH ARCHITECT, INTERIORS AND FOOD SERVICE PLANS AND ELEVATIONS PRIOR TO ROUGH-IN.

- KEY NOTES:**
- 1 PROVIDE 20A, 120V CONNECTION TO FIRE SMOKE DAMPER, CIRCUITED VERTICALLY FROM ABOVE. REFER TO 2/E2.01 FOR CONTINUATION AND CIRCUIT NUMBER.
  - 2 PROVIDE LEGRAND WIRE MOLD RFB2 SERIES FLOOR BOX FOR DUPLEX RECEPTACLE AND LOW VOLTAGE CONNECTIONS AT HOSTESS STATION. COORDINATE EXACT LOCATION AND REQUIREMENTS WITH ARCHITECT AND STRUCTURAL PRIOR TO ROUGH-IN.
  - 3 ELEVATOR PIT DEVICES. COORDINATE ALL FINAL ELEVATOR ELECTRICAL CONNECTION AND HOISTWAY REQUIREMENTS WITH SUBMITTED AND APPROVED ELEVATOR SHOP DRAWINGS.
  - 4 CEILING MOUNTED GFCI RECEPTACLE WITH IN-RUSE WEATHER PROOF ENCLOSURE FOR CONNECTION TO TELEVISION. REFER TO LOW VOLTAGE DRAWINGS FOR ADDITIONAL ROUGH-IN REQUIREMENTS.
  - 5 FIRE ALARM ANNUNCIATOR PANEL. PROVIDE LOW VOLTAGE CONNECTION FROM MAIN FIRE ALARM PANEL AS REQUIRED. COORDINATE ALL FINAL FIRE ALARM REQUIREMENTS WITH SUBMITTED AND APPROVED SHOP DRAWINGS.
  - 6 PROVIDE 20A, 120V CONNECTION TO IRRIGATION CONTROLLER. COORDINATE FINAL LOCATION WITH CIVIL AND LANDSCAPE PRIOR TO ROUGH-IN.
  - 7 PROVIDE 20A, 120V CONNECTION TO ADA DOOR OPERATORS. PROVIDE ALL CONNECTIONS TO PUSH BUTTON OPERATORS AS REQUIRED. COORDINATE ALL FINAL ELECTRICAL REQUIREMENTS WITH DOOR HARDWARE SUBMITTAL PRIOR TO ROUGH-IN.
  - 8 1200A, NEMA-4X DISCONNECT D6C-M5B. REFER TO RISER E9.01 FOR DETAILS. PROVIDE LEGRAND WIRE MOLD RFB2 SERIES FLOOR BOX FOR DUPLEX RECEPTACLE CONVENIENCE POWER. COORDINATE EXACT LOCATION AND REQUIREMENTS WITH ARCHITECT AND STRUCTURAL PRIOR TO ROUGH-IN.
  - 9 PROVIDE 20A, 120V CIRCUIT FOR HVAC MOTORIZED DAMPERS ON LEVEL 02. CIRCUIT TO M2-34 USING 2#12, 1#12S, 3#14C. COORDINATE ALL FINAL REQUIREMENTS WITH MECHANICAL CONTRACTOR AND APPROVED EQUIPMENT SHOP DRAWINGS.
  - 10 PROVIDE 20A, 120V CIRCUIT FOR HVAC MOTORIZED DAMPERS ON LEVEL 01. CIRCUIT TO M1-55 USING 2#12, 1#12S, 3#14C. COORDINATE ALL FINAL REQUIREMENTS WITH MECHANICAL CONTRACTOR AND APPROVED EQUIPMENT SHOP DRAWINGS.
  - 11 EXISTING UTILITY TRANSFORMER TO REMAIN. CONTRACTOR TO PROVIDE NEW C.T. CABINET AND METER. REFER TO RISER DIAGRAM E9.01 FOR REQUIRED WORK IN THIS AREA.

TAG	DESCRIPTION	FLA	TOTAL VA	VOLTAGE	POLES	DEVICE	PANEL	CIRCUIT NUMBER	CIRCUIT DESCRIPTION	NOTES
E307	MEDIUM TEMP REMOTE CONDENSER	5 A	1332 VA	208 V	2	30A223R	M1	7.9	2#12, 1#12S, 3#14C	
E014	MEDIUM TEMP REMOTE CONDENSER	12 A	2659 VA	208 V	2	30A223R	M1	17.19	2#10, 1#10C, 3#14C	
E019	LOW TEMPERATURE REMOTE CONDENSER	28 A	6408 VA	208 V	2	30A223R	M1	32.34	2#8, 1#10C, 3#14C	

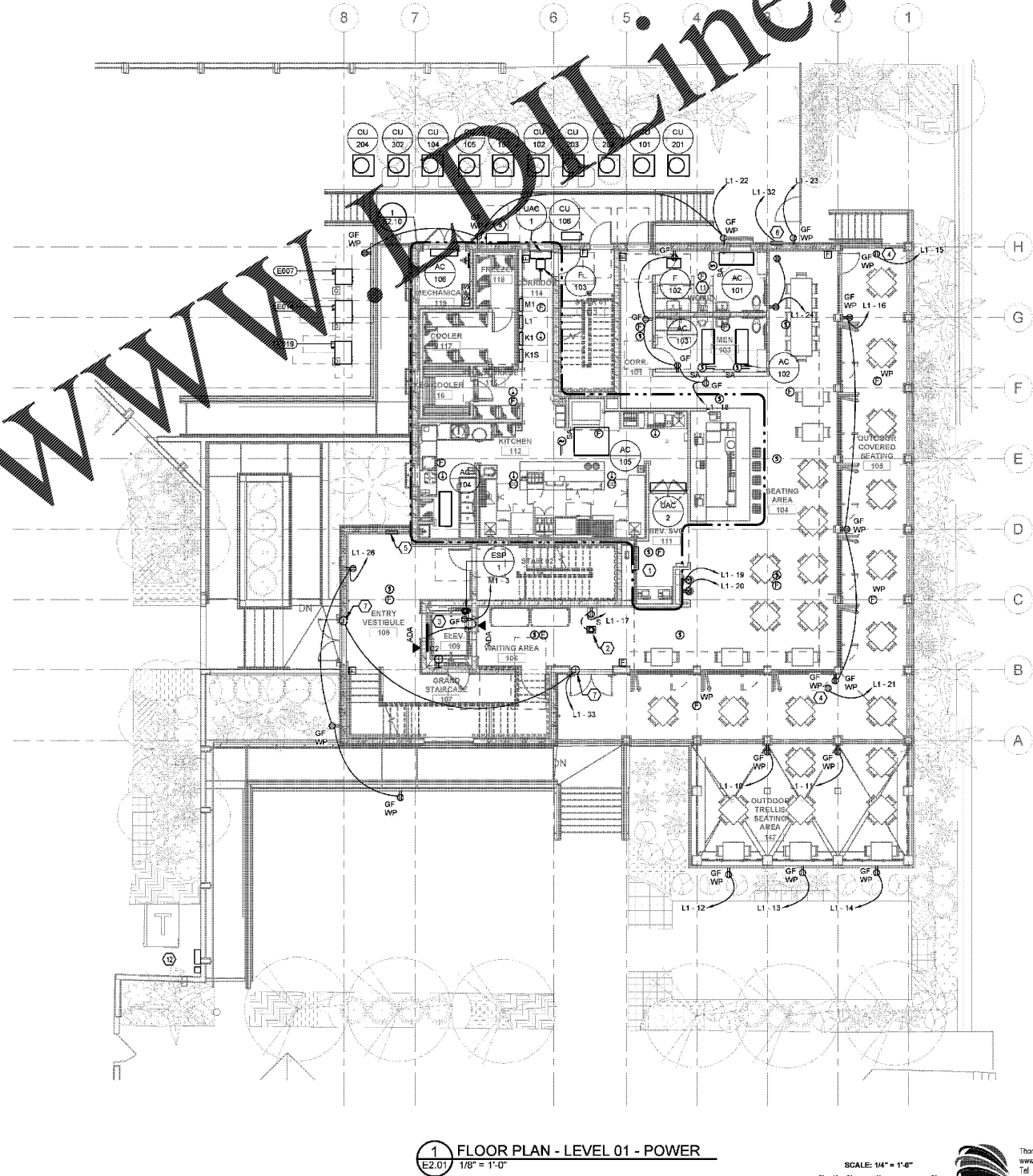
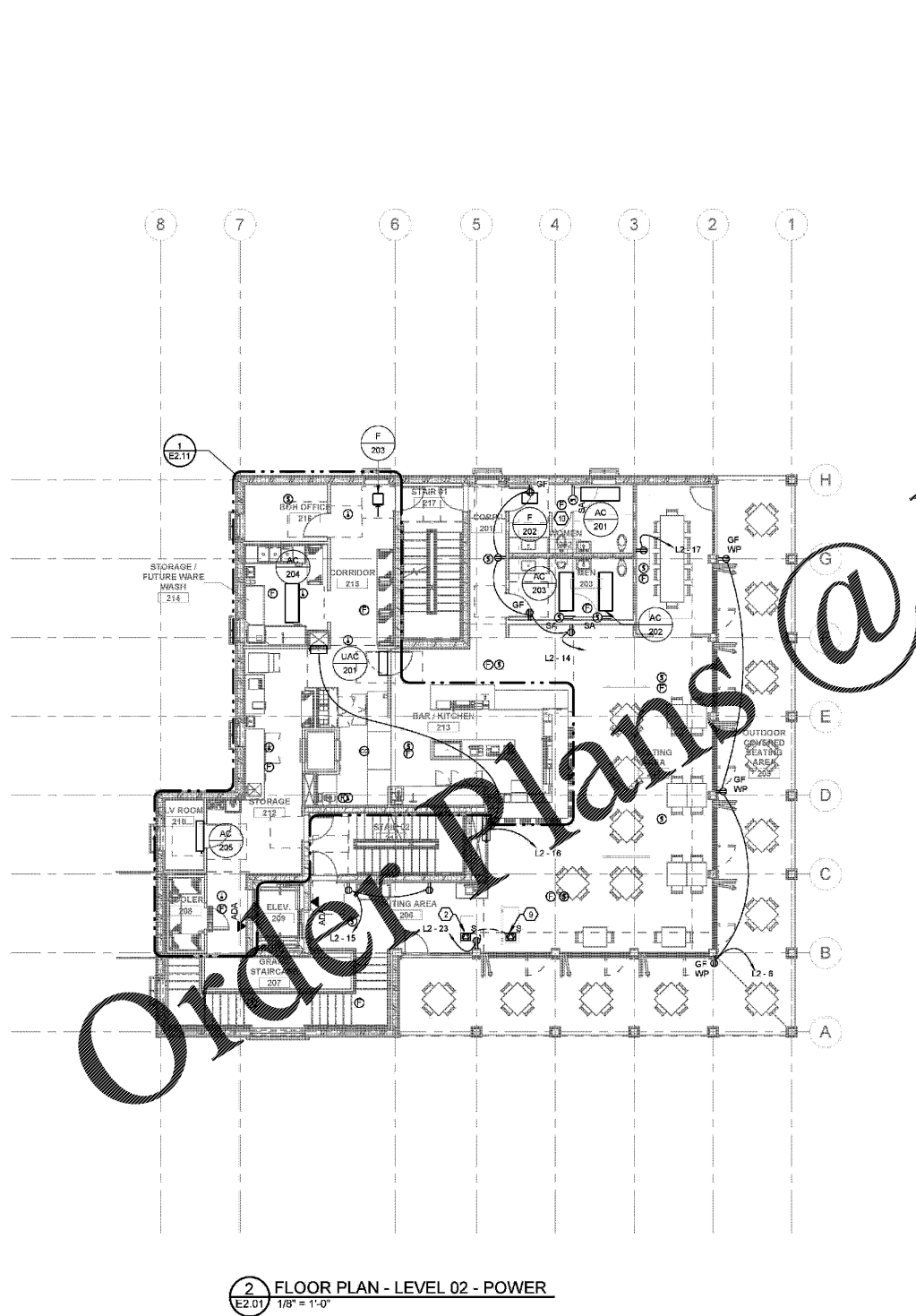

**2 FLOOR PLAN - LEVEL 02 - POWER**  
E2.01 1/8" = 1'-0"

**1 FLOOR PLAN - LEVEL 01 - POWER**  
E2.01 1/8" = 1'-0"

