

ARCHITECT
HKS ARCHITECTS, INC.
#AA F000119
2000 SALZEDO ST, 4TH FLOOR
CORAL GABLES, FL 33134

STRUCTURAL CONSULTANT
THORNTON TOMASETTI
101 NE THIRD AVE., SUITE 1170
FORT LAUDERDALE, FL 33301-1129

MEP CONSULTANT
THOMPSON BILLS
50 TECHNOLOGY PARKWAY S. PEACHTREE CORNERS,
GA 30062

KITCHEN CONSULTANT
INNOVATIVE FOOD SERVICE
11101 NORTH 45TH STREET, TAMPA, FL 33617

WATERPROOFING CONSULTANT
CDC USA
6070 Park Ln., Suite 400 Dallas, TX 75231

CODE & LIFE SAFETY CONSULTANT
HOME ENGINEERS
101 LONGWATER CIR, NORWELL, MA 02061

MARRIOTT SAWGRASS CABANA CLUB

618 PONTE VEDRA BLVD
PONTE VEDRA BEACH, FL 32082

OWNER
WATERMARK CAPITAL PARTNERS, LLC
100 NORTH RIVERVIEW PLAZA SUITE 400
CHICAGO, IL 60659

OWNER'S CONSULTANT
THE JOHN HARMON GROUP INC
6065 DANFELD RD., SUITE 200
ATLANTA, GA 30328

CIVIL ENGINEER AND LANDSCAPE CONSULTANT
WALKER+HORN
12740 GRAND BAY PARKWAY WEST
SUITE 200
JACKSONVILLE, FL 32256

INTERIOR DESIGN CONSULTANT
HBA DESIGN
3216 MERRICK AVENUE, SANTA MONICA,
CALIFORNIA 90404 U. S. A.

This drawing is for information only to be used by the contractor as a general understanding of interior conditions. It has been made from available information, however measurements are to be verified on project site. This drawing may be revised and approved prior to final ordering and fabrication.

This drawing is the property of HERRICK BENDER AND ASSOCIATES and is not to be reproduced or copied in whole or in part. It is not to be used for the project and site specifically identified herein and is not to be used on any other project. It is to be returned upon request.

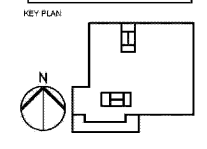

REVISION NO.	DESCRIPTION	DATE

HKS PROJECT NUMBER
22808.001

DATE
05/22/2020

ISSUE
PERMIT SET

SHEET TITLE
PUBLIC AREA - L2 BAR DETAILS

SHEET NO.

ID-715

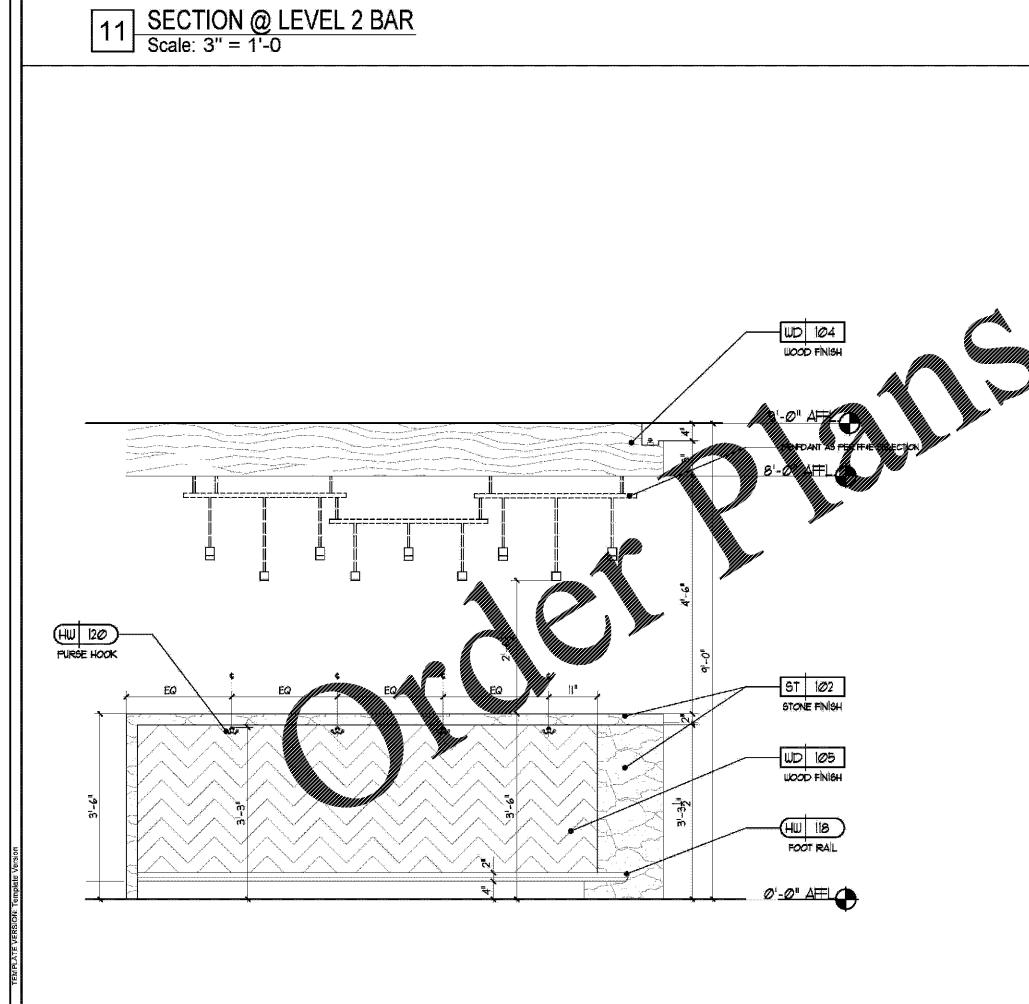
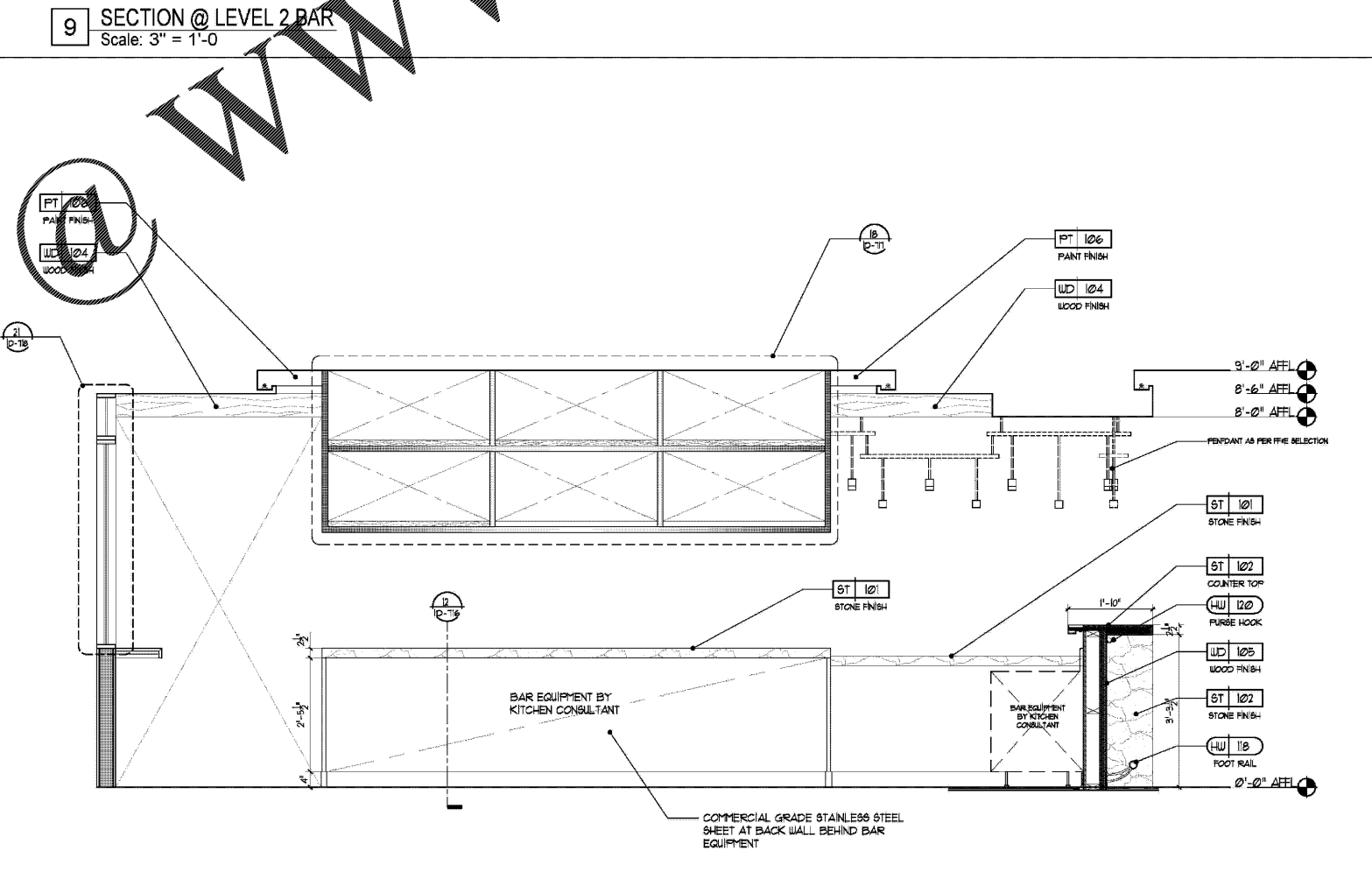
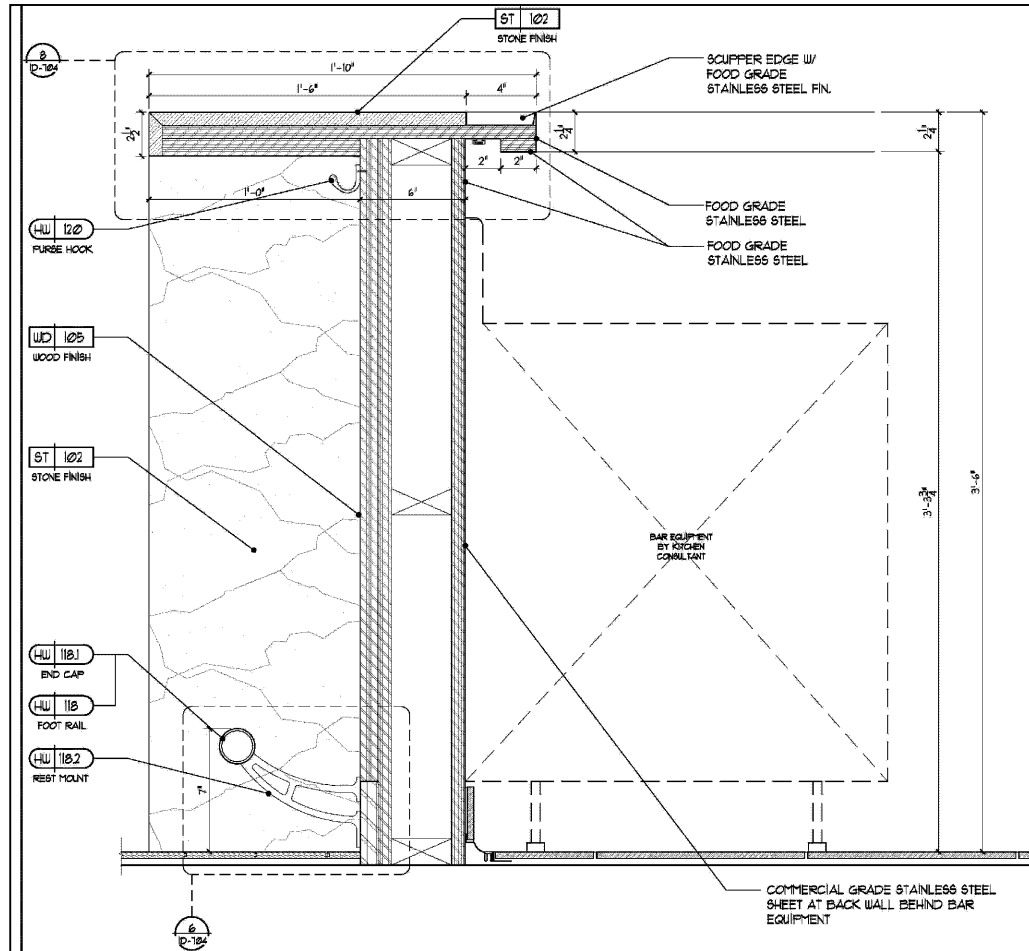
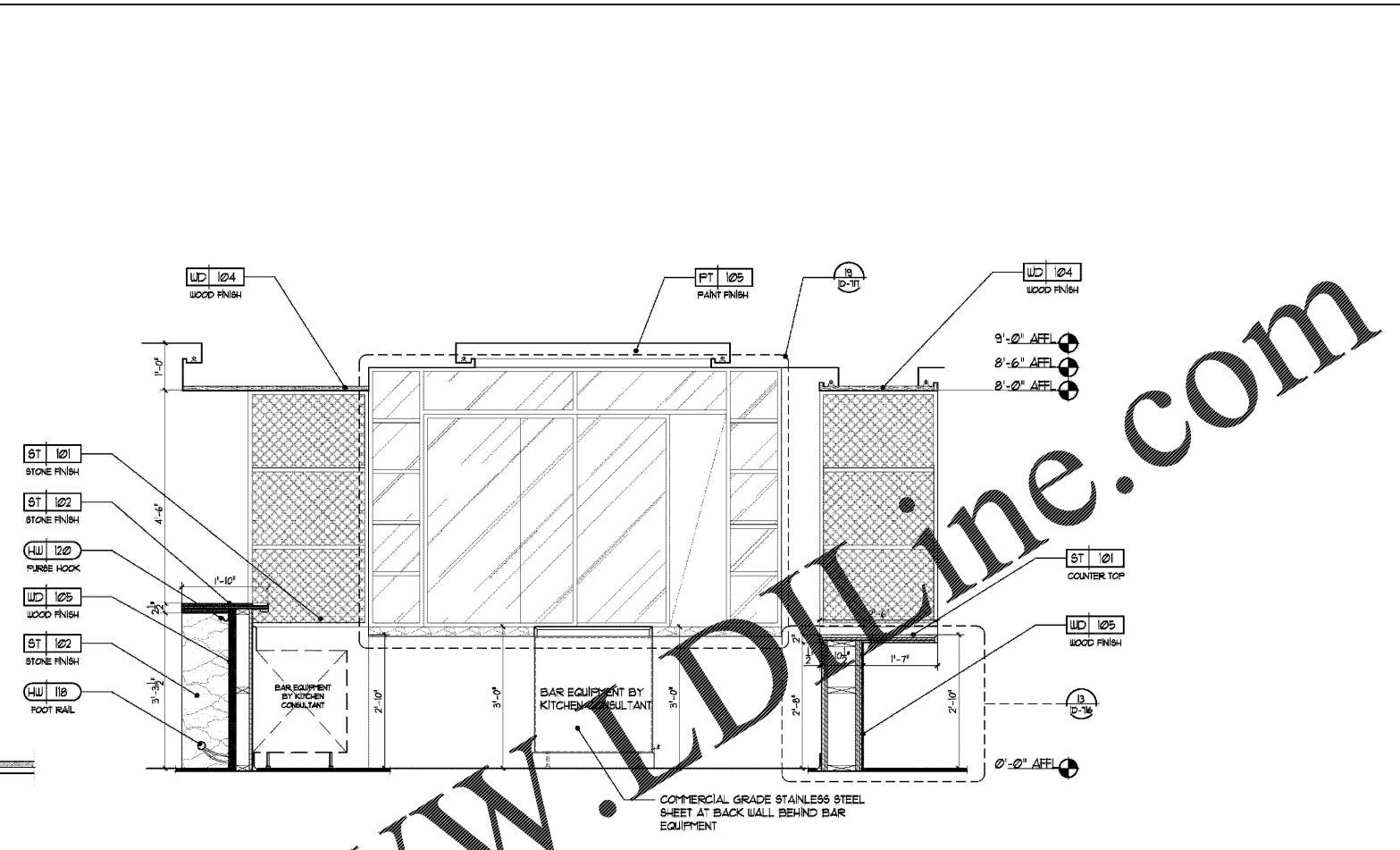

PLOT DATE: 07/28/2020 12:58:05 PM
 TEMPLATE VERSION: INTERIOR_V2020