

PONTJE VEDRA BOULEVARD (C.R. 203)
(or North of Hwy)

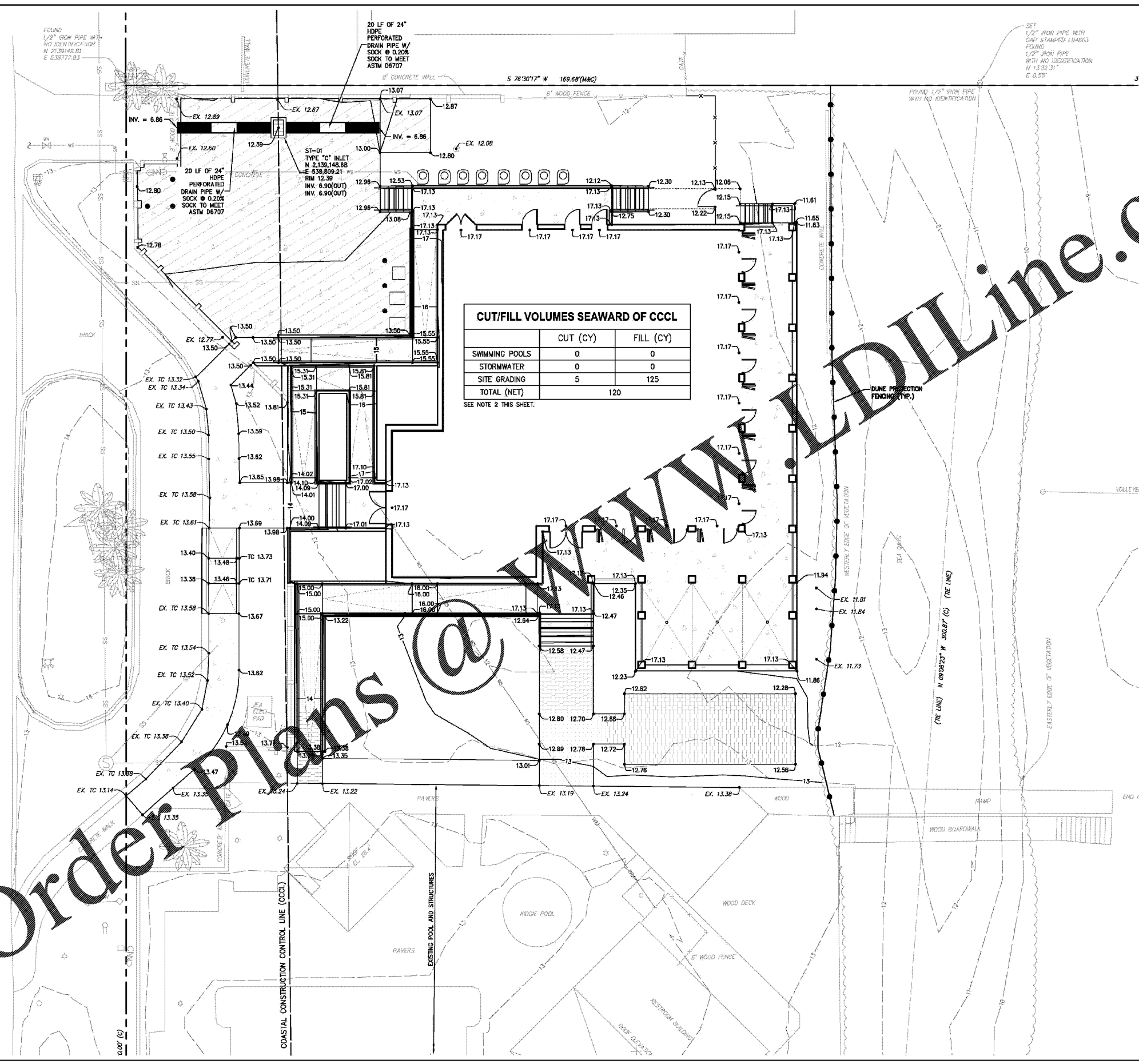

	CUT (CY)	FILL (CY)
SWIMMING POOLS	0	0
STORMWATER	0	0
SITE GRADING	5	125
TOTAL (NET)		120

SEE NOTE 2 THIS SHEET.

NOTES:

- FOR PROJECT BENCHMARK, REFER TO SHEET C-06
- (7) ON EACH COMPACTED FILL SHALL BE PLACED ON THE BEACH OR IN AN ASSOCIATED DUNE SYSTEM. ALL FILL MATERIAL PLACED SEAWARD OF THE CCCL SHALL BE AND WHICH IS SIMILAR TO THAT ALREADY EXISTING IN THE SAME COASTAL CELL IN COLORATION, GRAIN SIZE, AND POSITION. BEACH COMPATIBLE FILL IS MATERIAL THAT MAINTAINS THE GENERAL CHARACTER AND FUNCTIONALITY OF THE MATERIAL OCCURRING ON THE BEACH AND IN THE ADJACENT DUNE AND COASTAL SYSTEM. SUCH MATERIAL SHALL BE PREDOMINATELY CARBONATE, QUARTZ OR SIMILAR MATERIAL WITH A PARTICLE SIZE DISTRIBUTION RANGING BETWEEN 0.062MM (4.0) AND 4.75MM (-2.25) (CLASSIFIED AS SAND BY EITHER THE UNIFIED SOILS OR THE WENTWORTH CLASSIFICATION), SHALL BE SIMILAR IN COLOR AND GRAIN SIZE DISTRIBUTION (SAND GRAIN FREQUENCY, MEAN AND MEDIAN GRAIN SIZE AND SORTING COEFFICIENT) TO THE MATERIAL IN THE EXISTING COASTAL SYSTEM AT THE PLACEMENT AREA AND SHALL NOT CONTAIN:
 - (A) GREATER THAN 5 PERCENT, BY WEIGHT, SILT, CLAY OR COLLOIDS PASSING THE #20 SIEVE (4.0);
 - (B) GREATER THAN 5 PERCENT, BY WEIGHT, FINE GRAVEL RETAINED ON THE #4 SIEVE (-2.25);
 - (C) COARSE GRAVEL, COBBLES OR MATERIAL RETAINED ON THE 3/4 INCH SIEVE IN A PERCENTAGE OR SIZE GREATER THAN FOUND AT THE PLACEMENT AREA;
 - (D) CONSTRUCTION DEBRIS, CLAY BALLS OR FOREIGN MATERIAL; OR
 - (E) MATERIAL THAT RESULTS IN OCEANIZATION OF THE BEACH.
 THE DEPARTMENT RESERVES THE RIGHT TO APPROVE DEVIATIONS FROM THE ABOVE CRITERIA. IF THOSE DEVIATIONS WOULD NOT INCREASE THE POTENTIAL FOR ADVERSE IMPACTS TO THE COASTAL SYSTEM, WHEN REQUESTING SUCH DEVIATIONS, THE APPLICANT SHALL PROVIDE FULLY DOCUMENTED EVIDENCE THAT WOULD JUSTIFY THE DEVIATIONS.

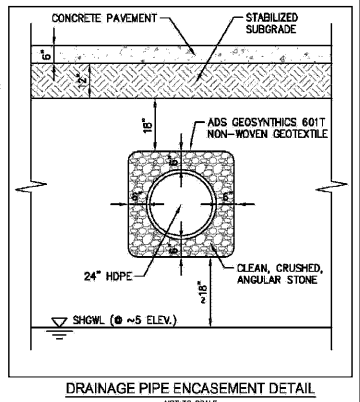

LEGEND:

- - - EXISTING CONTOUR
- PROPOSED CONTOUR
- 2.75 PROPOSED GRADE
- STORM DRAIN PIPE

THE PRESENCE OF GROUNDWATER SHOULD BE ANTICIPATED ON THIS PROJECT. CONTRACTOR'S BID SHALL INCLUDE CONSIDERATION FOR ADDRESSING THIS ISSUE.

THE SITE CONSTRUCTION STAKEOUT SHALL BE PERFORMED UNDER THE DIRECTION OF A FLORIDA REGISTERED SURVEYOR. AUTOCAD FILES WILL BE FURNISHED TO AID IN THE SITE CONSTRUCTION STAKEOUT. ANY DISCREPANCIES FOUND BETWEEN AUTOCAD FILES AND SITE CONSTRUCTION PLANS SHALL BE BROUGHT TO THE ENGINEER'S ATTENTION FOR CLARIFICATION PRIOR TO THAT STAKEOUT.

PROJECT DATUM: NAVD'88

Always call 811 two full business days before you dig to have underground utilities located and marked.



NO.	REVISIONS	DATE	BY

Kimley»Horn
© 2020 KIMLEY-HORN AND ASSOCIATES, INC.
12740 BEAN BAY PARKWAY WEST, SUITE 2350
JACKSONVILLE, FLORIDA 32258
PHONE: 904-828-3900
WWW.KIMLEY-HORN.COM REGISTRY 696

JOSEPH P. MECCA, P.E.
No. 53192
STATE OF FLORIDA
PROFESSIONAL ENGINEER

LICENSED PROFESSIONAL
JOSEPH P. MECCA, P.E.
FLORIDA LICENSE NUMBER
DATE
MAY 2020
53192
THIS ITEM HAS BEEN ELECTRONICALLY SIGNED AND SEALED BY:
JOSEPH P. MECCA, P.E.
PRINTED COPIES OF THIS DOCUMENT ARE NOT CONSIDERED SIGNED AND SEALED.
DESIGNED BY: WJC
DRAWN BY: CDC
CHECKED BY: JPM

GRADING AND DRAINAGE PLAN
MARRIOTT SAWGRASS CABANA BEACH CLUB
PREPARED FOR
CWI SAWGRASS HOTEL, LLC
FLORIDA
ST. JOHNS COUNTY

SHEET NUMBER
C-09