

COMMUNICATION NOTES

(THIS SHEET ONLY)
 ACCESS POINTS SHALL BE CALLED TO PENDANTS BY THE LOW VOLTAGE VENDOR

GENERAL NOTES

1. THIS DRAWING IN CONJUNCTION WITH DCA, E6b, AND E6c IS INTENDED FOR COMMUNICATION INSTALLATION ONLY. ALL JUNCTIONS AND CONDUIT AND/OR RISERS IF REQUIRED SHALL BE INSTALLED BY THE ELECTRICAL CONTRACTOR UNLESS NOTED OTHERWISE.
2. EXPOSED CABLES SHALL BE INSTALLED PARALLEL AND PERPENDICULAR TO SURFACES OR EXPOSED MEMBERS AND FOLLOW SURFACE CONTOUR WHERE POSSIBLE. ANY CABLE NOT INSTALLED ALONG THE CONTOURS OF THE STRUCTURE SHALL BE ENCASED IN CONDUIT WITH BUSHINGS AND PROPERLY SUPPORTED PER CODE.
3. CABLES SHALL BE SECURED AND SUPPORTED AT INTERVALS NOT EXCEEDING 36" AND NOT MORE THAN 6" FROM CABINETS, BOXES, FITTINGS AND TERMINATIONS.
4. CONTRACTOR SHALL FREQUENTLY LOW VOLTAGE CABLES ONLY UPON COMPLETION OF PAINTING IN THE INSTALLATION AREA.

TELECOM LEGEND

- ▽ TELEPHONE ONLY
- ▽ TELEPHONE ONLY
- ▽ TELEPHONE ONLY
- ▽ TELEPHONE ONLY
- ▽ TELEPHONE W/STAINLESS STEEL COVER PLATE
- ▽ 1 PORT DATA OUTLET
- ▽ 2 PORT DATA OUTLET
- ▽ 3 PORT DATA OUTLET
- ▽ 4 PORT DATA OUTLET
- ▽ 6 PORT DATA OUTLET
- ▽ 1 PORT VOICE AND DATA COMBINATION OUTLET
- ▽ 2 PORT VOICE AND DATA COMBINATION OUTLET
- ▽ 3 PORT VOICE AND DATA COMBINATION OUTLET
- ▽ 4 PORT VOICE AND DATA COMBINATION OUTLET
- ▽ 6 PORT VOICE AND DATA COMBINATION OUTLET

THE DRAWING AND ALL INFORMATION CONTAINED HEREIN IS THE PROPERTY OF APOLLO ENGINEERING, LLC. IT IS TO BE USED ONLY FOR THE PROJECT AND SITE SPECIFICALLY IDENTIFIED HEREIN. ANY REUSE, REPRODUCTION, OR DISTRIBUTION OF THIS DRAWING WITHOUT THE WRITTEN PERMISSION OF APOLLO ENGINEERING, LLC IS STRICTLY PROHIBITED. THIS DRAWING IS NOT TO BE USED FOR ANY OTHER PROJECT OR SITE WITHOUT THE WRITTEN PERMISSION OF APOLLO ENGINEERING, LLC.

PUBLICLY PROTOTYPE BASIS OF DESIGN
20M
 EXPANDED RECEIVED: 08.14.18

CORPORATE OFFICES, FACILITIES DESIGN
 BOX 407, LAKELAND, FL 33807
 (888) 680-3995
 PHYSICAL ADDRESS
 1300 AIRPORT RD., LAKELAND, FL 33811

Publix
 SUPER MARKETS

FISHER AND ASSOCIATES, LLC.
 ARCHITECTS
 PLANNERS
 INTERIOR DESIGNERS
 605 BELLEAIR RD. CLEARWATER, FL 34616 727-466-4400

COMMUNICATION DEVICE LOCATIONS
EAST COBB PUBLIX - #1745
 EAST COBB CROSSING SHOPPING CENTER
 ROSEWELL ROAD
 MARIETTA, GA 30062

RELEASED FOR:
 BID
 PERMIT 07/16/20
 CONSTR.

REVISIONS:

| | | |
|--|--|--|
| | | |
| | | |
| | | |

HAROLD A. SCOTT
 GEORGIA P.E. #527908

E-6a

Issue Date: 04-01-20
 Project No.: 220036

SCALE = 1/8" = 1'-0"
APOLLO ENGINEERING, LLC
 CONSULTING ENGINEERS
 PEP060833
 6544 U.S. Hwy 41 North, Suite 900, Apollo Beach, FL 33572
 Phone: 813.928.8400 / Fax: 813.928.8400
 A/E # 10133
 Copyright 2020 - All rights reserved.

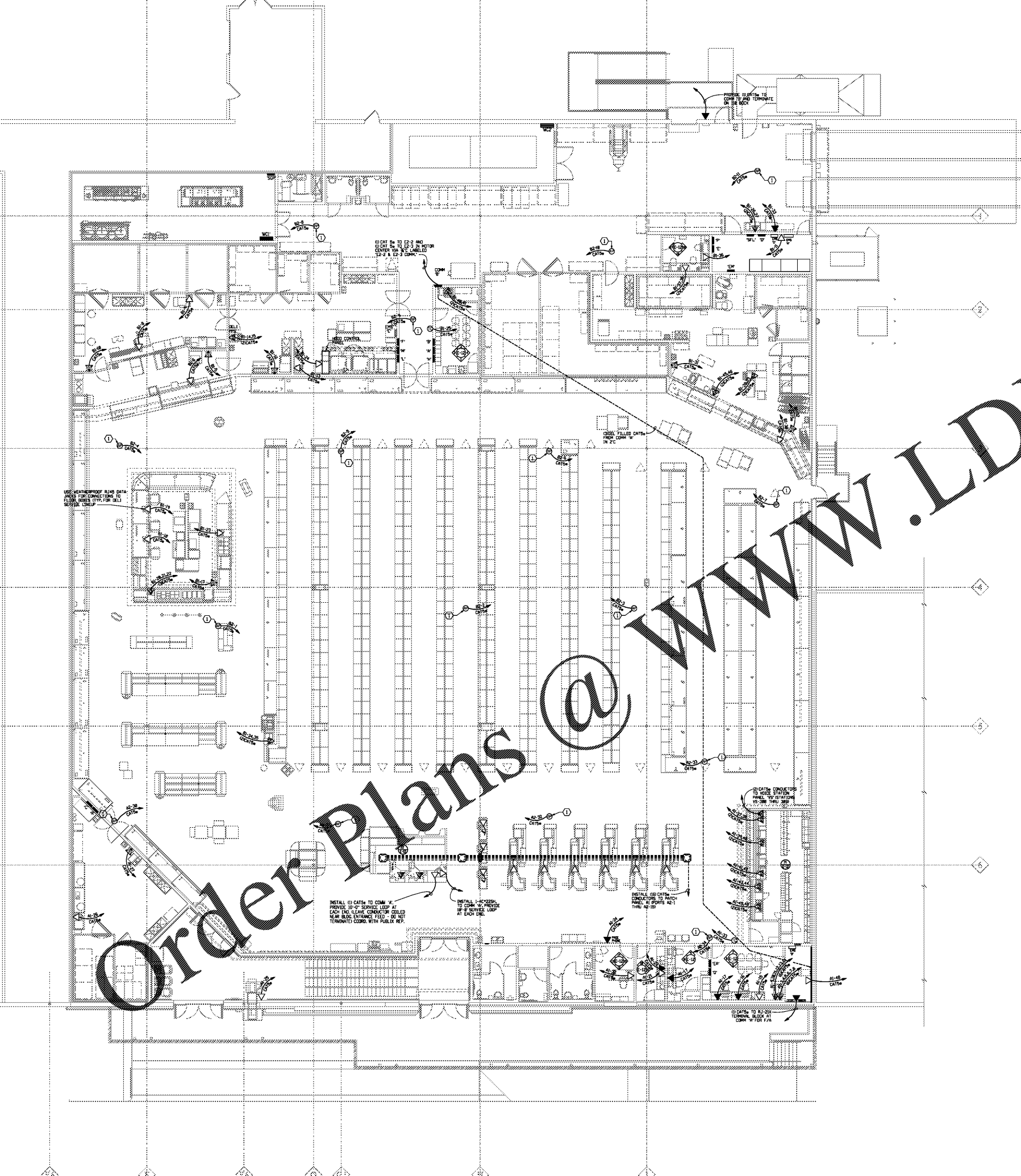

Order Plans @ www.LDILine.com

ALL RIGHTS RESERVED TO THE ARCHITECT. NO PART OF THIS DRAWING IS TO BE REPRODUCED OR TRANSMITTED IN ANY FORM OR BY ANY MEANS, ELECTRONIC OR MECHANICAL, WITHOUT THE WRITTEN PERMISSION OF APOLLO ENGINEERING, LLC.