

Order Plans @ WWW.IDIline.com

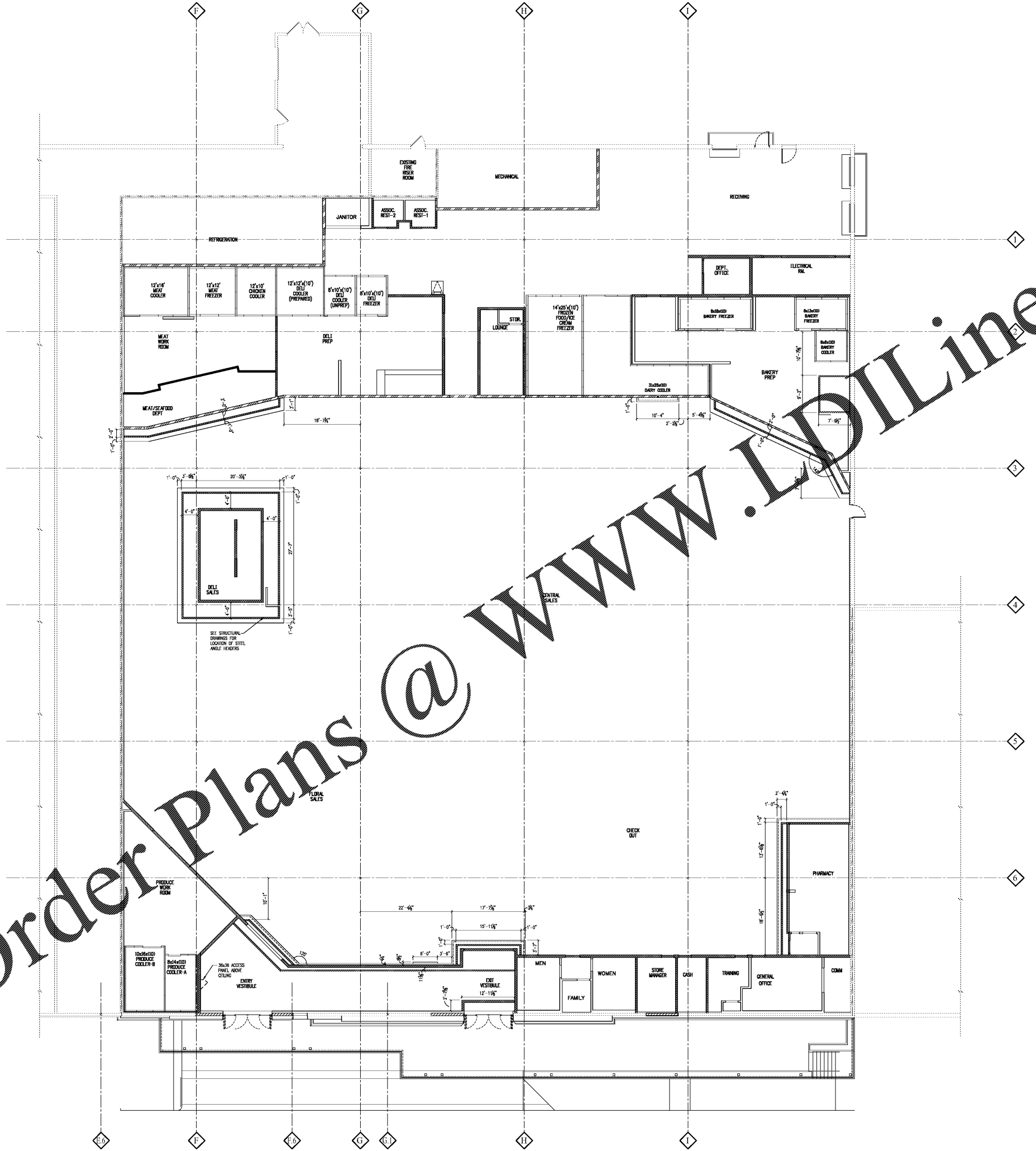

INTERIOR WALL/SOFFT LEGEND

- WALLS/SOFT TO THE DECK
- WALLS/SOFT TO THE UNDERSIDE OF STRUCTURE
- WALLS TO UNDERSIDE OF COOLER CEILING
- WALLS 6" ABOVE CEILING OR AS NOTED
- COOLER WALL

NOTE: ALL GYP. BOARD TO RUN 6" ABOVE ADJACENT CEILING

SOFFT PLAN
 EAST COBB PUBLIX - #1745
 EAST COBB CROSSING SHOPPING CENTER
 ROSEWELL ROAD
 MARIETTA, GA 30062

RELEASED FOR:
 BID: _____
 PERMIT: 07/16/20
 CONSTR: _____

REVISIONS:

NO.	DATE	DESCRIPTION

STATE OF GEORGIA
 WILLIAM JOE FISHER ARCHITECT
 LICENSED ARCHITECT

A2.4

Issue Date: 04-01-20
 Project No.: 220006

THE OWNER HAS BEEN MECHANICALLY SIGNED AND SEALED BY WILLIAM JOE FISHER, ARCHITECT, LICENSE NO. 19686. THE SIGNATURE AND SEAL OF THE ARCHITECT ARE NECESSARY TO VALIDATE THESE DOCUMENTS. THE ARCHITECT'S LIABILITY IS LIMITED TO THE PROFESSIONAL SERVICES PROVIDED AND DOES NOT EXTEND TO THE DESIGN OR CONSTRUCTION OF THE PROJECT. THE ARCHITECT IS NOT RESPONSIBLE FOR THE ACCURACY OF THE INFORMATION PROVIDED BY THE OWNER OR FOR THE ACTIONS OF ANY OTHER PROFESSIONAL OR NON-PROFESSIONAL PERSONS. THE ARCHITECT HAS NOT CONDUCTED A VISUAL INSPECTION OF THE PROJECT AND HAS NOT BEEN ADVISED OF ANY CONSTRUCTION DEFECTS. THE ARCHITECT'S LIABILITY IS LIMITED TO THE PROFESSIONAL SERVICES PROVIDED AND DOES NOT EXTEND TO THE DESIGN OR CONSTRUCTION OF THE PROJECT. THE ARCHITECT IS NOT RESPONSIBLE FOR THE ACCURACY OF THE INFORMATION PROVIDED BY THE OWNER OR FOR THE ACTIONS OF ANY OTHER PROFESSIONAL OR NON-PROFESSIONAL PERSONS.

PUBLIX PROTOTYPE
 BASIS OF DESIGN
20M
 EXPANDED
 RECEIVED: 09.14.18

FISHER AND ASSOCIATES, L.L.C.
 ARCHITECTS
 PLANNERS
 INTERIOR DESIGNERS
 282 BELLAR RD., CLEARWATER, FL 34774 727/4844408

CORPORATE OFFICES, FACILITIES DESIGN
 BOX 407, LAKELAND, FL 33822
 (863) 660-3226
 PHYSICAL ADDRESS:
 3300 AIRPORT RD., LAKELAND, FL 33811

PUBLIX
 SUPER MARKETS

SOFFT PLAN
 EAST COBB PUBLIX - #1745
 EAST COBB CROSSING SHOPPING CENTER
 ROSEWELL ROAD
 MARIETTA, GA 30062

RELEASED FOR:
 BID: _____
 PERMIT: 07/16/20
 CONSTR: _____

REVISIONS:

NO.	DATE	DESCRIPTION

STATE OF GEORGIA
 WILLIAM JOE FISHER ARCHITECT
 LICENSED ARCHITECT

A2.4

Issue Date: 04-01-20
 Project No.: 220006

THIS PLAN HAS BEEN MECHANICALLY SIGNED AND SEALED BY WILLIAM JOE FISHER, ARCHITECT, LICENSE NO. 19686. THE SIGNATURE AND SEAL OF THE ARCHITECT ARE NECESSARY TO VALIDATE THESE DOCUMENTS. THE ARCHITECT'S LIABILITY IS LIMITED TO THE PROFESSIONAL SERVICES PROVIDED AND DOES NOT EXTEND TO THE DESIGN OR CONSTRUCTION OF THE PROJECT. THE ARCHITECT IS NOT RESPONSIBLE FOR THE ACCURACY OF THE INFORMATION PROVIDED BY THE OWNER OR FOR THE ACTIONS OF ANY OTHER PROFESSIONAL OR NON-PROFESSIONAL PERSONS. THE ARCHITECT HAS NOT CONDUCTED A VISUAL INSPECTION OF THE PROJECT AND HAS NOT BEEN ADVISED OF ANY CONSTRUCTION DEFECTS. THE ARCHITECT'S LIABILITY IS LIMITED TO THE PROFESSIONAL SERVICES PROVIDED AND DOES NOT EXTEND TO THE DESIGN OR CONSTRUCTION OF THE PROJECT. THE ARCHITECT IS NOT RESPONSIBLE FOR THE ACCURACY OF THE INFORMATION PROVIDED BY THE OWNER OR FOR THE ACTIONS OF ANY OTHER PROFESSIONAL OR NON-PROFESSIONAL PERSONS.