

STIPULATION FOR REUSE
THIS DOCUMENT IS THE PROPERTY OF HARRISON FRENCH & ASSOCIATES, L.P. AND IS TO BE USED ONLY FOR THE PROJECT AND SITE SPECIFICALLY IDENTIFIED HEREIN. IT IS NOT TO BE REPRODUCED, COPIED, OR TRANSMITTED IN ANY FORM OR BY ANY MEANS, ELECTRONIC OR MECHANICAL, INCLUDING PHOTOCOPYING, RECORDING, OR BY ANY INFORMATION STORAGE AND RETRIEVAL SYSTEM, WITHOUT THE WRITTEN PERMISSION OF HARRISON FRENCH & ASSOCIATES, L.P.

200 S KING'S HWY
FORT PIERCE, FL 34945
SPEEDCO REMODEL
PROJECT NUMBER: 03-19-00467

Loves
Travel Stop &
Country Stores

Professional Engineer
No. 79462
STATE OF FLORIDA
Professional Engineer
Ryan G. Galloway
1/20/2018
Daniel Ryan G. Galloway
License #79462
Harrison French & Associates, L.P.
03/19/2020

ISSUE BLOCK		
OTD	OTD	08-13-2019
3	ADD-3	11-22-2019
4	ADD-4	4-22-2020

STORE NO. 467
DOCUMENT DATE: 8/13/19
CHECKED BY: WFM
DRAWN BY: ENH
PROTO CYCLE:

DETAIL SHEET

SHEET: YCV3

PROPOSED

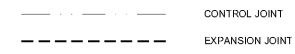

NOTE: CONTRACTOR TO FIELD ADJUST JOINTS BASED UPON SITE CONDITIONS

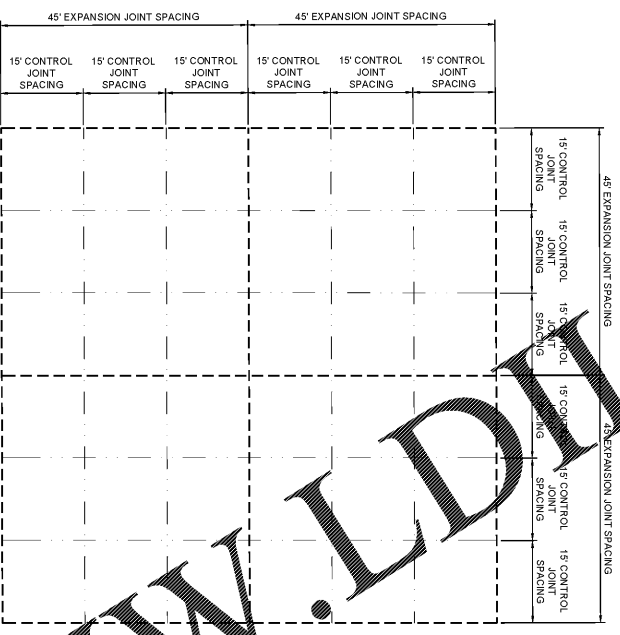

TYPICAL JOINT LAYOUT

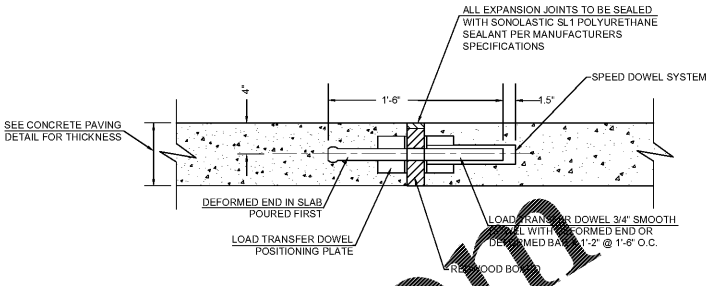

PAVEMENT EXPANSION JOINT

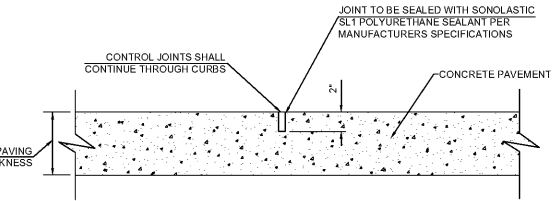

PAVEMENT CONTROL JOINT

NOTE: CONTROL JOINTS SHALL BE SAW CUT WITHIN 24 HOURS OF CONCRETE PLACEMENT - REINFORCEMENT LAPS SHALL NOT BE LOCATED WITHIN 3 FEET OF CONTROL JOINTS

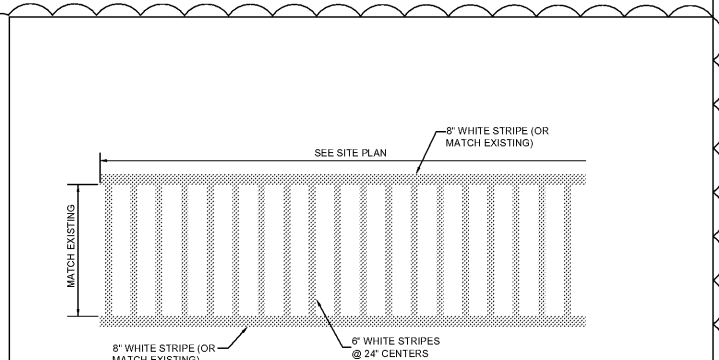

8 CROSSWALK MARKING

- NOTE:
- MARKINGS FOR STREET SHALL BE ACCORDING TO LOCAL CODE REQUIREMENTS AND AS OUTLINED IN SECTION 99 OF THE MANUAL ON UNIFORM TRAFFIC CONTROL DEVICES FOR STREETS AND HIGHWAYS.
 - MARKINGS WITHIN PRIVATE PARKING LOT SHALL BE PER THIS DETAIL.
 - THESE MARKINGS ARE TO BE PAINTED REFLECTIVE WHITE (OR SHOULD MATCH EXISTING CROSSWALK).

7 TYPICAL PAVING JOINT DETAIL

N.T.S.

NOTES:

- SEE SITE PLAN FOR COMPLETE STRIPING LAYOUT.
- THIS IS FOR REFERENCE AND DIMENSION CONTROL ONLY.
- ALL DIMENSIONS ARE TO CENTERLINE OF STRIPE UNLESS OTHERWISE NOTED.
- ALL COLORS AS SHOWN OR BY LOCAL CODES.
- STRIPING IS THE RESPONSIBILITY OF THE GENERAL CONTRACTOR.

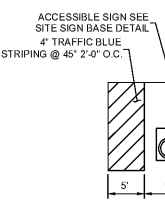

6 PARKING LOT STRIPING

N.T.S.

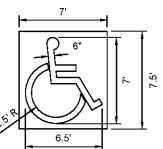

ACCESSIBLE PARKING SYMBOL

LOCATED AT EDGE OF PARKING SPACE UNLESS ACCOMPANIED BY VAN LETTERING

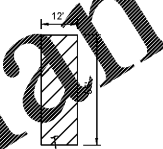

LOADING SPACE

4" TRAFFIC WHITE STRIPING @ 45" 2'-0" O.C.

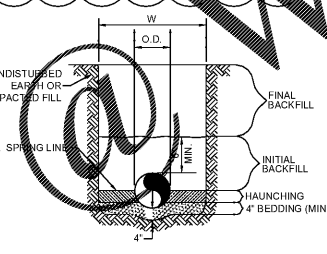

WATER LINE

N.T.S.

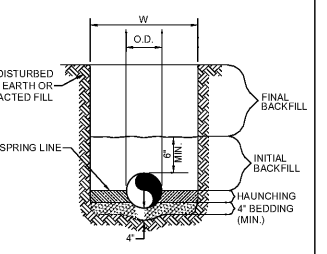

SANITARY SEWER

N.T.S.

GENERAL NOTES

- BEDDING SHALL BE CLASS I-A WORKED BY HAND. IF GROUNDWATER IS ANTICIPATED, THEN BEDDING SHALL BE CLASS I-B COMPACTED TO 85% STANDARD PROCTOR.
- HAUNCHING SHALL BE WORKED AROUND THE PIPE BY HAND TO ELIMINATE VOIDS AND SHALL BE CLASS I-A OR CLASS I-B OR CLASS II COMPACTED TO 85% PROCTOR.
- INITIAL BACKFILL SHALL BE CLASS I-A WORKED BY HAND, OR CLASS I-B OR CLASS II COMPACTED TO 85% STANDARD PROCTOR.
- INITIAL BACKFILL NOT UNDER PAVED AREAS CAN BE CLASS III COMPACTED TO 90% STANDARD PROCTOR.
- FINAL BACKFILL SHALL BE CLASS I, II, OR III COMPACTED AS NOTED IN NOTES 3, AND 4.
- FINAL BACKFILL NOT UNDER PAVED AREAS CAN BE CLASS IV-A COMPACTED TO 95% STANDARD PROCTOR.
- ALL MATERIALS ARE CLASSIFIED IN ACCORDANCE WITH ASTM D 2321-89.
- ALL MATERIALS SHALL BE INSTALLED IN MAXIMUM 8" LOOSE LIFTS IN ACCORDANCE WITH ASTM D 856. CLASS III AND IV-A MATERIALS SHALL BE COMPACTED NEAR OPTIMUM MOISTURE CONTENT.
- FILL SALVAGED FROM EXCAVATION SHALL BE FREE OF DEBRIS, ORGANICS AND ROCKS LARGER THAN 3".
- ALL TRENCH EXCAVATIONS SHALL BE SLOPED, SHORED, SHEETED, BRACED, OR OTHERWISE SUPPORTED IN COMPLIANCE WITH OSHA REGULATIONS AND LOCAL ORDINANCES. (SEE SPECIFICATIONS)

3 UTILITY TRENCH AND BEDDING

N.T.S.

NOTES:

- IF NEEDED, DOWEL IN TO ADJACENT CONCRETE SLAB PER THE PAVEMENT EXPANSION JOINT DETAIL.
- GUTTER SLOPE TO MATCH ADJACENT PAVEMENT, TRAVERSE AND LONGITUDINAL.
- CURB SHALL MEET STANDARDS & SPECIFICATIONS OF THE FLORIDA DEPARTMENT OF TRANSPORTATION.

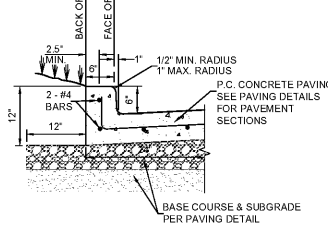

2 TYPE "B" CONCRETE CURB & GUTTER

N.T.S.

NOTE: SEE UTILITY TRENCH AND BEDDING DETAIL FOR BACKFILL AND BEDDING INSTRUCTIONS.

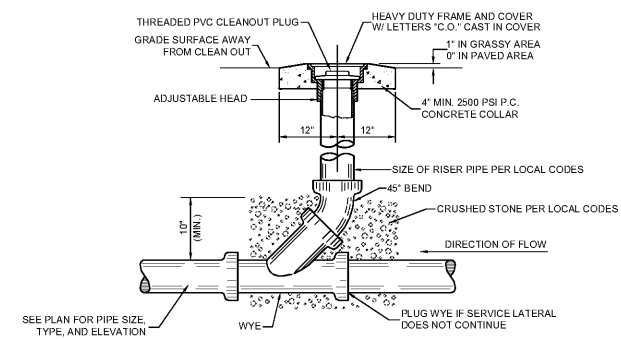

5 SANITARY SEWER CLEAN-OUT

N.T.S.

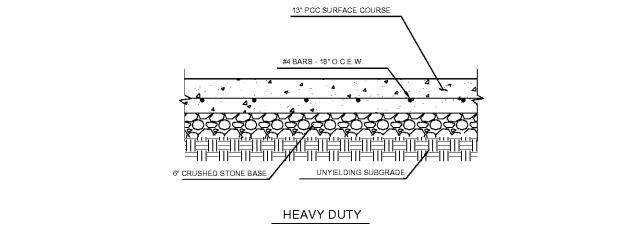

1 CONCRETE PAVING DETAIL

N.T.S.

- NOTES:
- DESIGN PER GEOTECH BY TERRACON DATED DECEMBER 10, 2009
 - PAVEMENTS AND SUBGRADES INCLUDING MATERIALS & COMPACTION SHALL MEET STANDARDS & SPECIFICATIONS OF THE FLORIDA DEPARTMENT OF TRANSPORTATION
 - CONCRETE IS TO BE 4000 PSI.