

GENERAL NOTES

1. NOTIFY THE OWNER, IN WRITING, AT LEAST SEVEN (7) DAYS IN ADVANCE OF ALL REQUIRED SHUTDOWNS OF WATER, FIRE, SEWER, GAS, ELECTRICAL SERVICE, OR OTHER UTILITIES. UPON WRITTEN RECEIPT OF APPROVAL FROM OWNER, SHUTDOWN SHALL BE PERFORMED BETWEEN THE HOURS OF SIX (6) P.M. AND SIX (6) A.M. OR AS DIRECTED OTHERWISE BY THE OWNER AND SHALL BE ACCOMPLISHED AT NO ADDITIONAL CONTRACT COST. AT THE END OF EACH SHUTDOWN ALL SERVICES SHALL BE RESTORED SO THAT NORMAL USE OF THE UTILITIES CAN CONTINUE.
2. WHEN WORKING IN AND AROUND THE EXISTING BUILDING, EXTREME CARE SHALL BE EXERCISED WITH REGARD TO PROTECTION OF THE EXISTING STRUCTURE AND MECHANICAL AND ELECTRICAL SERVICES WHICH WILL REMAIN, REPAIR, REPLACE, OR RESTORE TO THE SATISFACTION OF THE ARCHITECT ALL EXISTING WORK DAMAGED IN THE PERFORMANCE OF DEMOLITION AND/OR NEW WORK.
3. EXISTING CONDITIONS, I.E., PRESENCE AND LOCATION OF DUCTWORK, PIPING, EQUIPMENT AND MATERIALS, INDICATED ARE BASED ON INFORMATION OBTAINED FROM AVAILABLE RECORD DRAWINGS AND FIELD SURVEYS AND ARE NOT WARRANTED TO BE COMPLETE OR CORRECT. CONTRACTOR SHALL FIELD VERIFY EXACT LOCATION OF ALL DUCTWORK, PIPING, EQUIPMENT AND MATERIALS IN THE FIELD PRIOR TO STARTING ALL WORK.
4. EXISTING MECHANICAL AND ELECTRICAL EQUIPMENT, PIPING, DUCTWORK, AND MATERIALS AFFECTED BY DEMOLITION OR NEW WORK INSTALLATION AND REQUIRED TO REMAIN IN SERVICE SHALL BE RE-INSTALLED OR SUPPORTED AS REQUIRED IN ACCORDANCE WITH NEW WORK SPECIFICATION. ALL WORK SHALL BE COMPLETED TO THE SATISFACTION OF THE ARCHITECT AND AT NO ADDITIONAL CONTRACT COST.
5. PATCH ALL DISTURBED SURFACES, INCLUDING WALLS, CEILINGS, ROOF, AND FLOORS. PATCHING SHALL MATCH EXISTING ADJACENT SURFACES AS TO THICKNESS, TEXTURE, WATERPROOFING AND COLOR. ALL PATCHING SHALL BE PERFORMED TO THE SATISFACTION OF THE OWNER AND AT NO ADDITIONAL CONTRACT COST.
6. IN GENERAL, ALL PIPING, EQUIPMENT, DUCTWORK, AND MATERIALS SHOWN "EXIST" IS EXISTING TO REMAIN. ALL PIPING, CONDUITS, EQUIPMENT, DUCTWORK, AND MATERIALS SHOWN "DEM" AND "DASHED" IS EXISTING AND SHALL BE DEMOLISHED.
7. ALL WORK SHALL BE PERFORMED IN A SEQUENCE AND DURING HOURS TO MINIMIZE DISRUPTION TO THE BUILDING WHICH WILL REMAIN OCCUPIED DURING CONSTRUCTION.
8. ALL WORK SHALL BE PERFORMED IN ACCORDANCE WITH THE JURISDICTION'S APPLICABLE CODES AND THE LOCAL FIRE MARSHALL'S OFFICE.
9. THIS CONTRACTOR SHALL BE RESPONSIBLE FOR COORDINATING WITH ALL OTHER TRADES, SUBCONTRACTORS INCLUDING BUT NOT LIMITED TO MECHANICAL, PLUMBING, ELECTRICAL, AND GENERAL TRADES.
10. CONTRACTOR SHALL MAINTAIN ACCESS TO ALL STAIRWELLS AND EGRESS CORRIDORS DURING CONSTRUCTION.
11. ALL PENETRATIONS THROUGH FIRE WALLS MUST BE SEALED WITH AN APPROVED UL LISTED FIRE STOP MATERIAL AFTER SERVICES ARE RUN THROUGH. ALL PENETRATIONS THROUGH EXTERIOR WALLS ABOVE AND BELOW GRADE OR SLAB ON GRADE MUST BE WATERPROOFED.

DRAWING NOTES

1. DISCONNECT CIRCUIT FOR EXISTING NATURAL GAS UNIT HEATER AND REMOVE ALL CONDUIT AND CONDUCTORS BACK TO P.N.L. CIRCUIT BREAKERS ARE ETR; RELABEL AS SPARE.
2. DISCONNECT CIRCUIT FOR EXISTING EXHAUST FAN AND REMOVE ALL CONDUIT AND CONDUCTORS BACK TO P.N.L. CIRCUIT BREAKERS ARE ETR; RELABEL AS SPARE.
3. DISCONNECT CIRCUIT FOR EXISTING LOUVER AND REMOVE ALL CONDUIT AND CONDUCTORS BACK TO P.N.L. CIRCUIT BREAKERS ARE ETR; RELABEL AS SPARE.

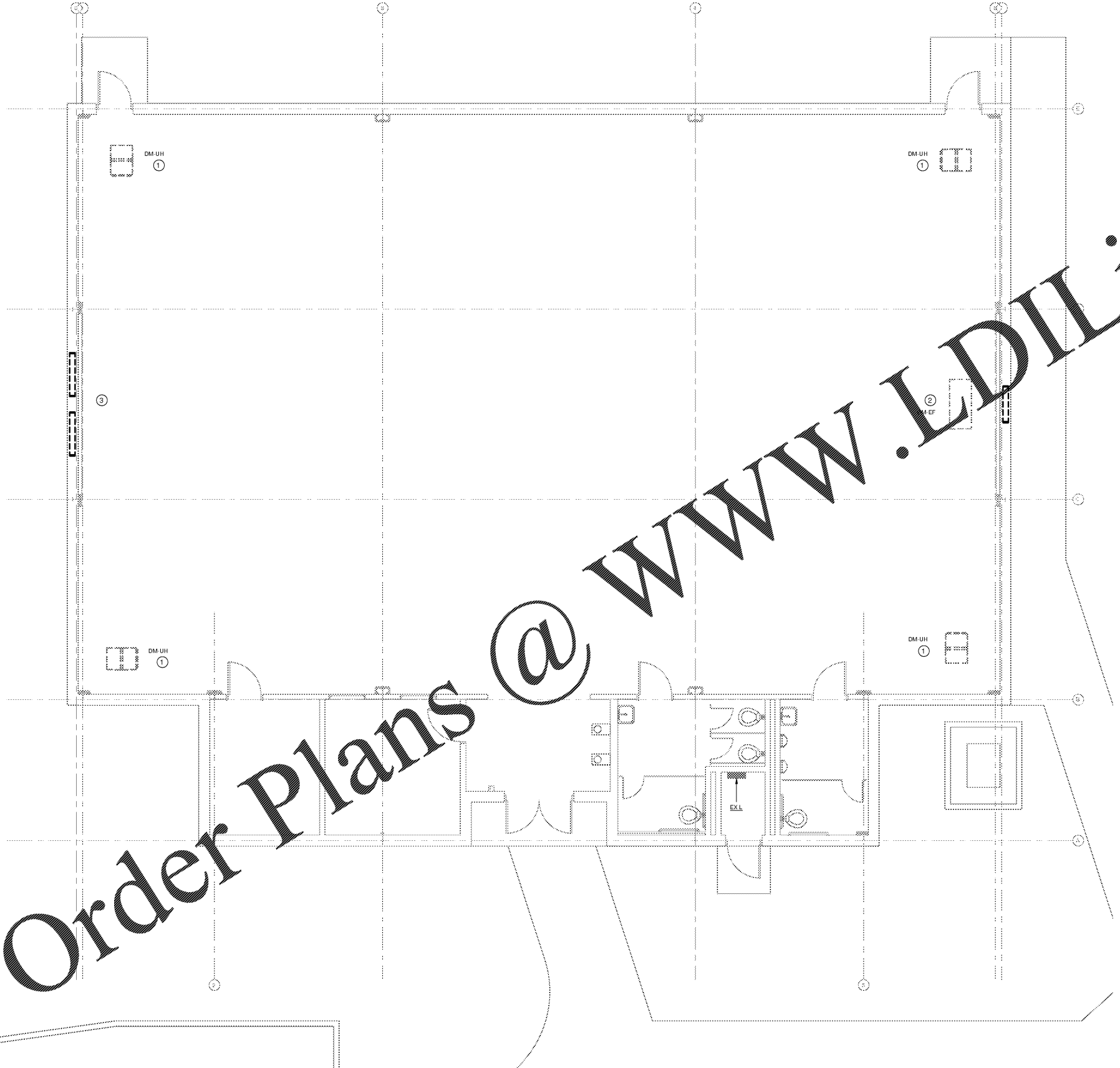

LEVEL 1 POWER DEMOLITION PLAN
 SCALE: 1/4" = 1'-0"

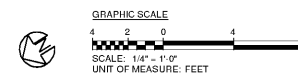

DATE	01/06/2020
PROJECT NO.	6919.9
DRAWING NO.	ED-101

BROCKETT ELEMENTARY SCHOOL
GYM HVAC DESIGN
 1855 Brockett Road
 Tucker, Georgia 30084

STANLEY LOVE STANLEY P A C
 ARCHITECTURE
 INTERIORS PLANNING
 PROGRAM MANAGEMENT
 1106 SPRING STREET, N.W.
 ATLANTA, GEORGIA 30309-3918
 404-576-2526
 404-576-2617 fax
 www.stanleylove.com

DRAWING TITLE
**ELECTRICAL LEVEL 1
 POWER DEMOLITION
 PLAN**

PROFESSIONAL SEAL

 CONSULTANT

SCALES AS STATED HEREON ARE VALID ON THE ORIGINAL DRAWING. THE DIMENSIONS OF WHICH ARE SHOWN HEREON. THE SCALES NOTED HEREON ARE SUBJECT TO CHANGE BY THE RATIO OF THE OVERALL SHEET DIMENSIONS OF THE PRINT TO CORRESPONDING DIMENSIONS OF THE ORIGINAL DRAWING.

THIS DRAWING IS THE PROPERTY OF STANLEY LOVE STANLEY, P.C. AND IS NOT TO BE REPRODUCED OR COPIED IN WHOLE OR IN PART. IT IS ONLY TO BE USED FOR THE PROJECT AND FOR THE SPECIFIC AREA SHOWN HEREON AND IS NOT TO BE USED ON ANY OTHER PROJECT. IT IS TO BE RETURNED UPON REQUEST.

COPYRIGHT © 2016. ALL RIGHTS RESERVED BY STANLEY LOVE STANLEY, P.C.

DATE	01/06/2020
PROJECT NO.	6919.9
DRAWING NO.	ED-101

ED-101

RELEASED FOR CONSTRUCTION 01/06/2020