

**DRAWING NOTES**

- ① DEMOLISH EXISTING NATURAL GAS UNIT HEATER AND ALL ASSOCIATED DUCTWORK, PIPING, CONTROLS, AND WIRING. SEE FD-101 FOR EXTENT OF DEMOLITION.
- ② DEMOLISH EXISTING EXHAUST FAN AND ALL ASSOCIATED DUCTWORK, CONTROLS, AND WIRING.
- ③ DEMOLISH EXISTING OUTSIDE AIR LOUVER.

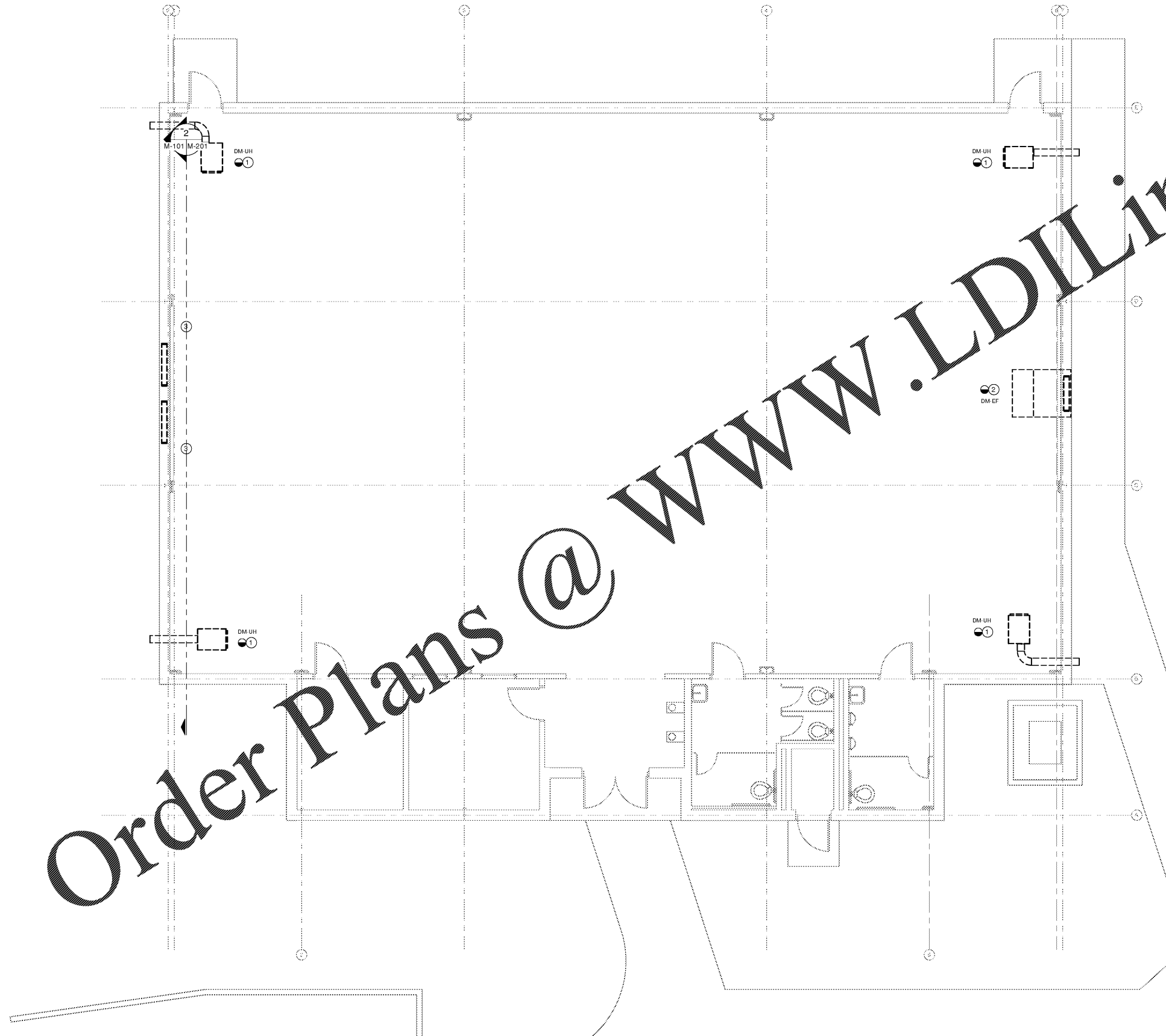

**LEVEL 1 HVAC DEMOLITION PLAN**  
SCALE: 1/4" = 1'-0"

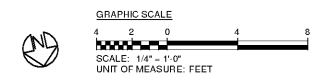

**BROCKETT ELEMENTARY SCHOOL**  
**GYM HVAC DESIGN**  
1855 Brockett Road  
Tucker, Georgia 30084

**STANLEY  
LOVE  
STANLEY  
P A C**

ARCHITECTURE  
INTERIORS PLANNING  
PROGRAM MANAGEMENT

1186 SPRING STREET, N.W.  
ATLANTA, GEORGIA 30309-3919  
404.876.0596  
404.876.0877 fax  
www.stanleylove-stanleypac.com

DRAWING TITLE  
**MECHANICAL LEVEL 1  
DEMOLITION PLAN**

PROFESSIONAL SEAL

REGISTERED PROFESSIONAL ENGINEER  
DANIEL NOTZ

CONSULTANT

SCALES AS STATED HEREON ARE VALID ON THE ORIGINAL DRAWING. THE DIMENSIONS OF WORK ARE SHOWN HEREON. THE SCALE IS NOT TO BE USED AS A CHECK OF THE RATIO OF THE OVERALL SHEET DIMENSIONS OF THE PRINT TO CORRESPONDING DIMENSIONS OF THE ORIGINAL DRAWING.

THIS DRAWING IS THE PROPERTY OF STANLEY LOVE STANLEY P A C AND IS NOT TO BE REPRODUCED, COPIED, OR IN ANY MANNER USED FOR THE PROJECT AND IS NOT TO BE USED ON ANY OTHER PROJECT. IT IS TO BE RETURNED UPON REQUEST.

COPYRIGHT © 2016. ALL RIGHTS RESERVED BY STANLEY LOVE STANLEY P A C.

DRAWING NO.  
DATE  
01/06/2020  
PROJECT NO.  
6919.9  
DRAWING NO.

**MD-101**