

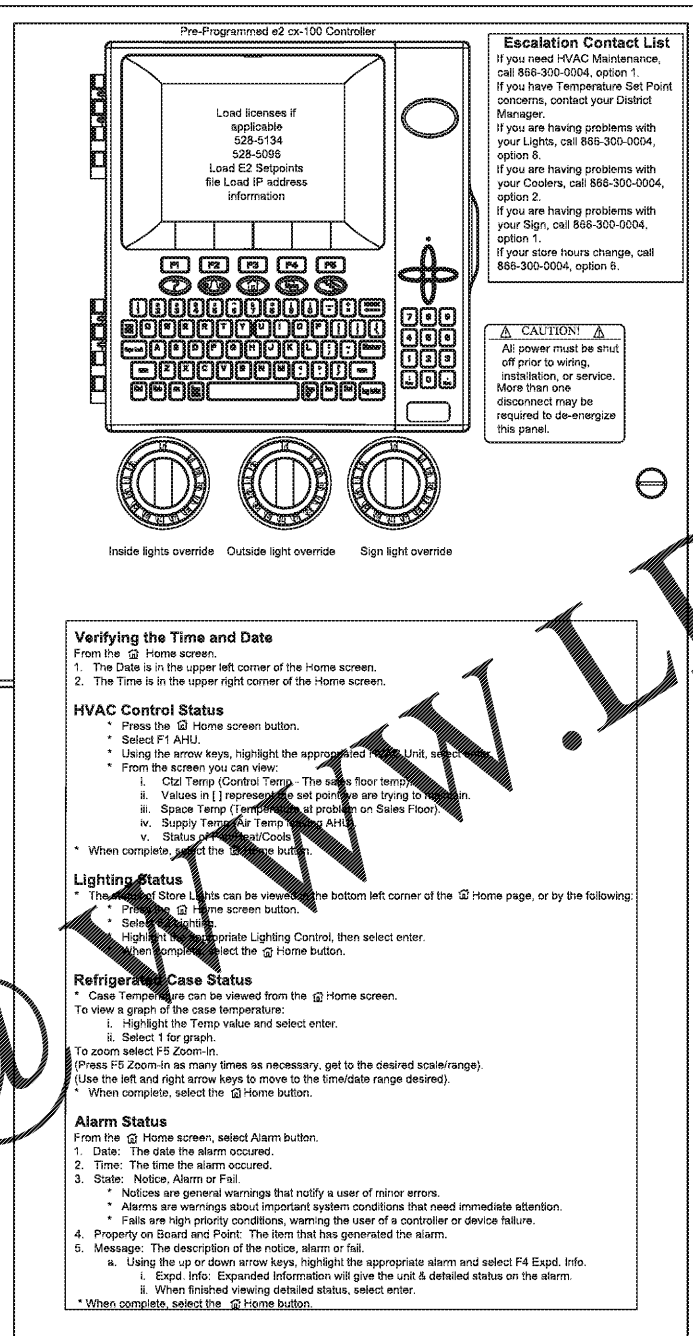

GENERAL CONTRACTOR TO ENSURE THAT THE BATTERY ENABLE IS SWITCHED TO THE "ON" POSITION

Order Plans

1 CPU TERMINAL DIAGRAM
SCALE: NTS



CONTROL PANEL NOTES

- EMS SYSTEM SHOULD BE TESTED FOR HVAC OPERATION, INTERIOR LIGHTING, EXTERIOR LIGHTING AND SIGN LIGHTING PRIOR TO CONTRACTOR'S ELECTRICAL POSSESSION DATE. USE OUTSIDE LIGHT AND SIGN LIGHT OVERRIDE FOR EXTERIOR TESTING.

2 PROGRAMMER CONTROLLER
SCALE: NTS

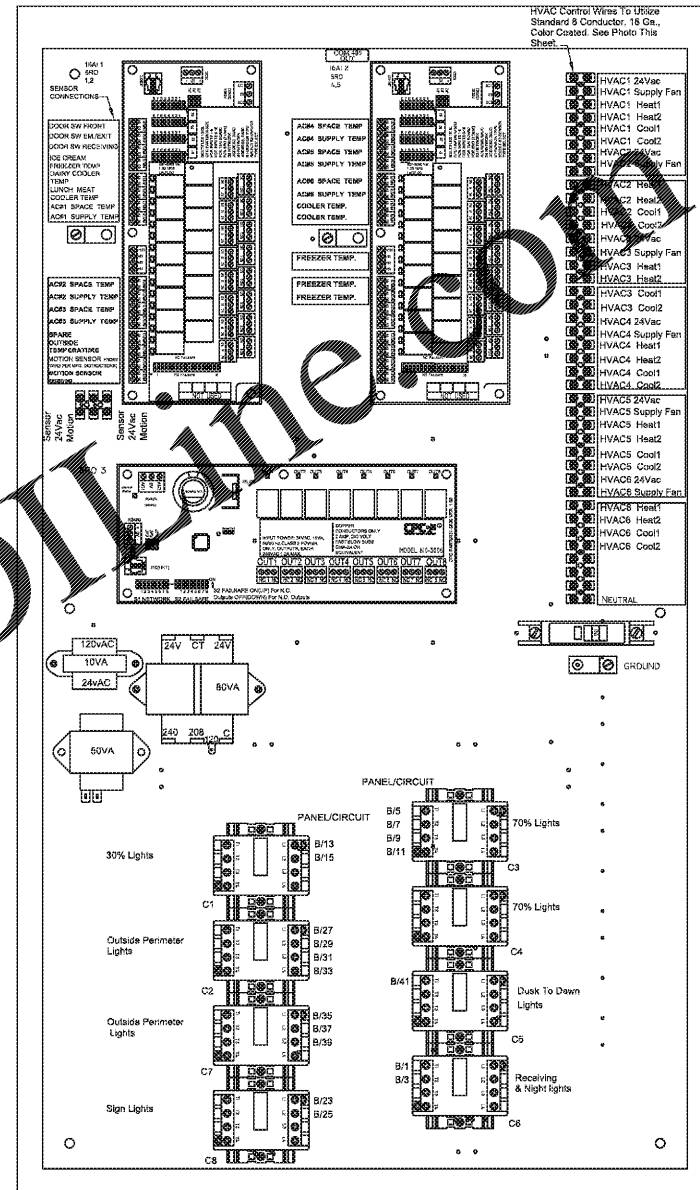

TESTING NOTES

TESTING OF HVAC UNITS THRU EMS PANEL IS ACCOMPLISHED BY SIMPLY WARMING UP OR COOLING DOWN A SPACE TEMPERATURE SENSOR (USING A BLOW DRYER OR ELECTRONIC EQUIPMENT DUSTER AEROSOL) AND WATCH THE FAN, HEAT AND COOL STAGES CYCLE ON AND OFF. THIS REQUIRES TWO PEOPLE AT ALL TIMES...ONE TO WATCH THE SCREEN AND THE OTHER TO WATCH OPERATION OF THE AHU. WHEN COMPLETE, PRESS THE HOME BUTTON TO RETURN TO THE MAIN SCREEN.

EMS GENERAL NOTES

- EMS SUPPLIER NOTE: CUSTOMIZED DOLLAR GENERAL EMS PANEL REQUIRES STORE #, CITY, STATE, ZIP CODE & QTY. OF HVAC UNITS OF THE INSTALL SITE WHEN ORDERING. EMS SYSTEMS INSTALLATION GUIDE WITH PHOTOS IS AVAILABLE ON NATIONAL ACCOUNT WEBSITE. ALL QUESTIONS PERTAINING TO THE EMS PANEL, SYSTEM INSTALLATION & SETUP SHOULD BE DIRECTED TO EMERSON'S DOLLAR GENERAL SUPPORT TEAM AT 770-425-2724.
- ALL SIGN & LIGHTING CIRCUITS MUST BE FED THROUGH THE DESIGNATED CONTACTORS AS NOTED ON THIS PAGE.
- ALL LOW VOLTAGE HVAC & DOOR SENSORS MUST BE CONNECTED TO THE PROPER TERMINAL. 24 GA. SHIELDED (SHIELD MUST BE GROUND) CABLE, BELDEN 99S41, 2 CONDUCTOR WIRE OR IT'S EQUIVALENT IS REQUIRED.
- COOLER & FREEZER HOME RUNS WILL BE TERMINATED AT ALL POINTS BY DOLLAR GENERAL REFRIGERATION DEPARTMENT.

3 CONTROL WIRING DIAGRAM
SCALE: NTS

DISCLAIMER NOTICE:
THE DESIGN BASIS FOR THESE DOCUMENTS WERE BASED ON THE STANDARD PROTOTYPE DRAWINGS PROVIDED TO US BY DOLLAR GENERAL THROUGH THEIR OWNERS REPRESENTATIVE. THE GENERAL CONTRACTOR SHALL BE RESPONSIBLE FOR FIELD VERIFYING ALL EXISTING CONDITIONS PRIOR TO COMMENCING WITH PART OF THE WORK. MATERIALS, FOUNDATIONS, BUILDING INFORMATION, ETC. ANY DISCREPANCIES BETWEEN THESE DOCUMENTS AND ACTUAL FIELD CONDITIONS SHALL BE BROUGHT TO THE ATTENTION OF THE ARCHITECT PRIOR TO ANY WORK BEING DONE. ANY REQUIRED ENGINEERING CHANGES TO MATCH THE EXISTING SITE CONDITIONS SHALL BE TREATED AS ADDITIONAL SERVICES.

Robert E. Walker, IV
Architect
2229 FIRST AVE. SOUTH
SUITE 110
BIRMINGHAM, Alabama
35233
T-205.254.3212
F-205.254.3269

ROBERT M. BEATTIE, PE
2875 SHILOH ROAD, SUITE 100, GAINESVILLE, FL 32608
PHONE: 352.381.1111 FAX: 352.381.1112
WWW.RMBSYSTEMS.COM EMAIL: RMBSYSTEMS@GMAIL.COM
REGISTERED PROFESSIONAL ELECTRICAL ENGINEER, LICENSE NO. 12000, STATE OF FLORIDA
REGISTERED PROFESSIONAL MECHANICAL ENGINEER, LICENSE NO. 12000, STATE OF FLORIDA



DG
DOLLAR GENERAL BUILDING
Prototype 9100 SF E
Store # 22323
DG Villa Rica
101 Prospector Drive
Villa Rica, GA

CONSTRUCTION DOCUMENTS

PROJECT NO.: 8095.89
ISSUED: 07/21/2020

EMS CONTROL DIAGRAMS AND DETAILS

E4.2