

- LEGEND**
- AIF - ANGLE IRON FOUND
 - AKA - ALSO KNOWN AS
 - ACSP - ALUMINUM CORRUGATED STEEL PIPE
 - BC - BACK OF CURB
 - BL - BUILDING SETBACK LINE
 - BWF - BARD WIRE FENCE
 - C&G - CURB & GUTTER
 - C/T - CRIMP TOP PIPE
 - CI - CURB INLET
 - CL - CENTER LINE
 - CLF - CHAIN LINK FENCE
 - CMF - CONCRETE MONUMENT FOUND
 - CMR - CORRUGATED METAL PIPE
 - CO - CLEAN OUT
 - CONC - CONCRETE
 - CORPS - ARMY CORPS OF ENGINEERS
 - DB, PG - DEED BOOK, PAGE
 - DI - DROP INLET
 - DIP - DUCTILE IRON PIPE
 - DS - DOWN SPOUT
 - DWCB - DOUBLE WING CATCH BASIN
 - EP - EDGE OF PAVEMENT
 - FIE - FINISH FLOOR ELEVATION
 - FH - FIRE HYDRANT
 - G - GAS LINE
 - GM - GAS METER
 - GP - GUY POLE
 - GV - GAS VALVE
 - GW - GUY WIRE
 - HC - HANDICAP
 - HW - HEADWALL
 - HWF - HOG WIRE FENCE
 - IE - INVERT ELEVATION
 - IPF - IRON PIN FOUND
 - IPS - IRON PIN SET
 - JB - JUNCTION BOX
 - LL - LAND LOT
 - LLL - LAND LOT LINE
 - LP - LIGHT POLE
 - MH - MANHOLE
 - MON - MONUMENT
 - N/F - NOW OR FORMERLY
 - OT - OPEN TOP PIPE
 - PBX - POWER BOX / TRANSFORMER
 - P - OVERHEAD POWER LINE
 - P-T - OH POWER & TELE LINE
 - PL - PROPERTY LINE
 - PM - POWER METER
 - POB - POINT OF BEGINNING
 - PP - POWER POLE
 - PTP - POWER & TELEPHONE POLE
 - PVC - POLYVINYLCHLORIDE PIPE
 - RB - REINFORCING IRON BAR
 - RCP - REINFORCED CONCRETE PIPE
 - R/W - RIGHT OF WAY
 - SS - SANITARY SEWER LINE
 - SSE - SANITARY SEWER EASEMENT
 - SW - SIDEWALK
 - SWCB - SINGLE WING CATCH BASIN
 - TBM - TEMPORARY BENCHMARK
 - TBX - TELEPHONE BOX
 - TF - TRANSFORMER
 - TMH - TELEPHONE MANHOLE
 - TP - TELEPHONE POLE
 - TPOB - TRUE POINT OF BEGINNING
 - T - OVERHEAD TELEPHONE LINE
 - UP - UNDERGROUND POWER
 - UT - UNDERGROUND TELEPHONE
 - WI - WEIR INLET
 - WL - WATER LINE
 - WM - WATER METER
 - WMH - WATER MANHOLE
 - WV - WATER VALVE

NRCS SOILS TABLE		
Soil Name	Slopes	Hydrologic Group
Chewacla	0 to 2 percent slopes	B/D
Hullett	2 to 6 percent slopes	C
Gullied Land	--	--

SEDIMENT STORAGE CALCULATIONS:
 DISTURBED AREA: 3.06 ACRES
 STORAGE REQUIRED: 3.06 ACRES x 67 CY/ACRE = 205 CY

SD4 CALCULATIONS:
 SD4 - C:
 STORAGE PROVIDED: 0.4 x AREA x DEPTH
 0.4 x (5329.44) x 3 = 6395.33 CF
 6395.33 CF x 27 CF/CY = 237 CY
 STORAGE PROVIDED: 237 CY > STORAGE REQUIRED: 205 CY

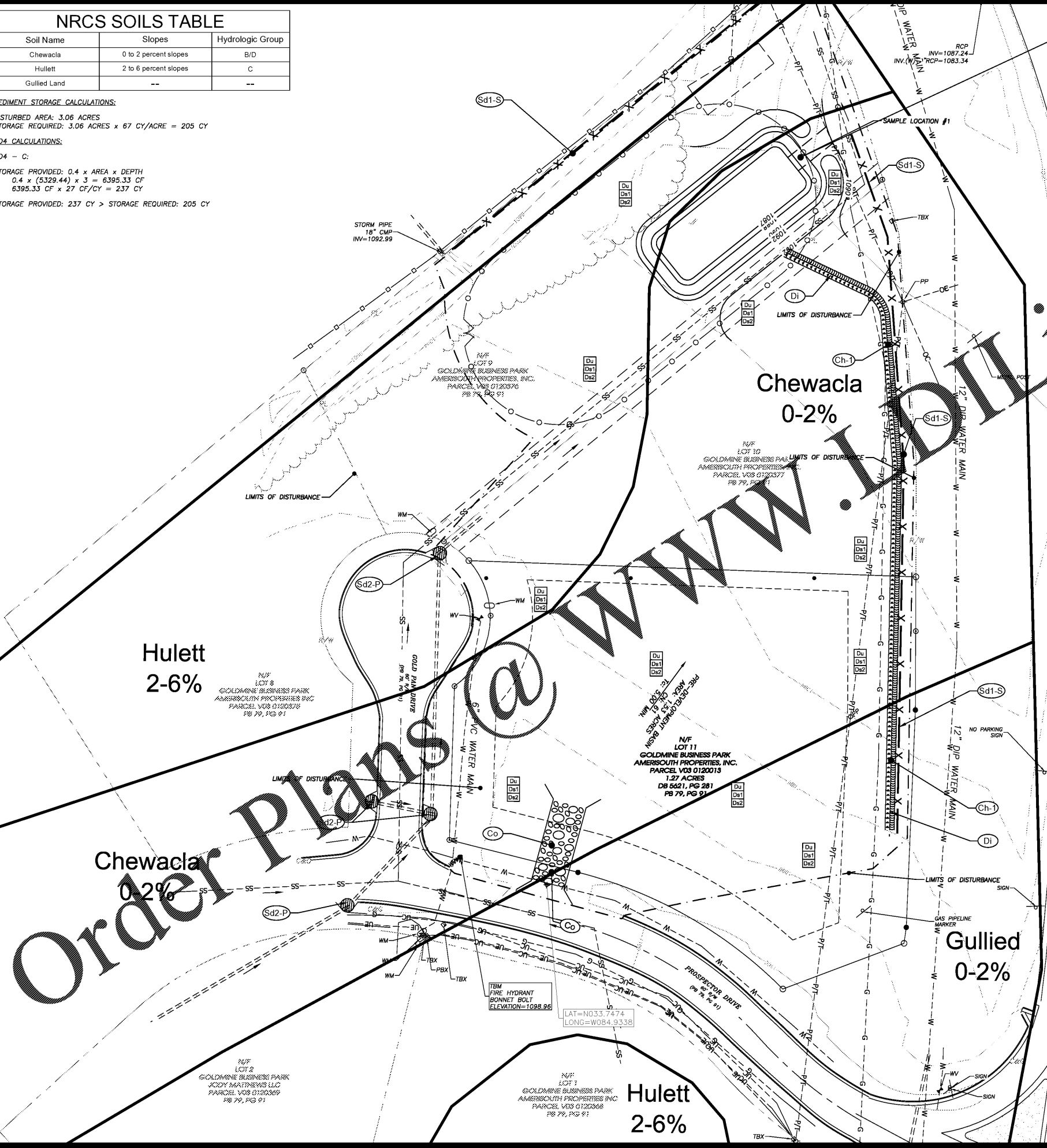

PRIMARY PERMITTEE & DEVELOPER:
SW VILLA RICA, LLC
 4151 ASHFORD DUNWOODY RD
 ATLANTA, GA 30319

24 HOUR EMERGENCY CONTACT
 BRIAN SULLIVAN
 (770) 883-1702

ENGINEERING CONTACT
 ERIC HUFFINE, PE
 (770) 718-0600

SURVEYING CONTACT
 BRANDY REGISTER, RLS
 (770) 718-0600

EROSION CONTROL CERTIFICATION:
 I CERTIFY THAT THIS PERMITTEE'S EROSION, SEDIMENTATION AND POLLUTION CONTROL PLAN PROVIDES FOR AN APPROPRIATE AND COMPREHENSIVE SYSTEM OF BEST MANAGEMENT PRACTICES REQUIRED BY THE GEORGIA WATER POLLUTION CONTROL ACT AND THE DOCUMENT "MANUAL FOR EROSION AND SEDIMENT CONTROL IN GEORGIA" PUBLISHED BY THE GEORGIA SOIL AND WATER CONSERVATION COMMISSION AS OF JANUARY 1, 2010. THE YEAR IN WHICH THE LAND-DISTURBING ACTIVITY WAS PERMITTED, PROVIDES FOR THE SAMPLING OF THE RECEIVING WATER(S) OR THE SAMPLING OF THE STORM WATER OUTFALLS AND THAT THE DESIGNED SYSTEM OF BEST MANAGEMENT PRACTICES AND SAMPLING METHODS IS EXPECTED TO MEET THE REQUIREMENTS CONTAINED IN THE GENERAL EROSION PERMIT NO. GAR 100001.

(2) I CERTIFY UNDER PENALTY OF LAW THAT THIS PLAN WAS PREPARED AFTER A SITE VISIT TO THE LOCATIONS DESCRIBED HEREIN BY MYSELF OR MY AUTHORIZED AGENT, UNDER MY DIRECT SUPERVISION.

Eric M. Huffine, P.E. EXPIRATION DATE: SEPT. 25, 2022
 ERIC M. HUFFINE, P.E. CERTIFICATION #15201

CODE	PRACTICE	DETAIL	MAP SYMBOL	DESCRIPTION
Co	CONSTRUCTION EXIT			A crushed stone pad located at the construction site exit to provide a place for removing mud from tires thereby protecting public streets.
Ch	CHANNEL STABILIZATION			Improving, constructing or stabilizing an open channel existing stream, or ditch.
Di	DIVERSION			An earth channel or dike located above, below, or across a slope to divert runoff. This may be a temporary or permanent structure.
Ds1	DISBURBED AREA STABILIZATION (WITH MULCHING ONLY)			Establishing temporary protection for disturbed areas where seedlings may not have a suitable growing season to produce an erosion retarding cover.
Ds2	DISBURBED AREA STABILIZATION (WITH TEMP SEEDING)			Establishing a temporary vegetative cover with fast growing seedlings on disturbed areas.
Du	DUST CONTROL ON DISTURBED AREAS			Controlling surface and air movement of dust on construction site, roadways and similar sites.
Sd1	SEDIMENT BARRIER			A barrier to prevent sediment from leaving the construction site. It may be sandbags, bales of straw or hay, brush, logs and poles, gravel, or a silt fence.
Sd4	TEMPORARY SEDIMENT TRAP			A small temporary pond that drains a disturbed area so that sediment can settle out. The principle feature distinguishing a temporary sediment trap from a temporary sediment basin is the lack of a pipe or riser.

INDUSTRIAL ROUTE/SHAD
 S.R. 101
 HIGHWAY 61 EXTENSION
 SHAD LOT 16 (M)
 (PG. 79, PG. 81)

GSWCC GEORGIA SOIL AND WATER CONSERVATION COMMISSION
 ERIC M. HUFFINE, P.E.
 LEVEL II CERTIFICATION DESIGN PROFESSIONAL
 CERTIFICATION NUMBER: 0000015201
 ISSUED: 09/25/2019 EXPIRES: 09/25/2022

GEORGIA811
 www.Georgia811.com

Rochester & Associates, Inc.
 286 Highway 314, Suite A • Fayetteville, Georgia 30214
 (770) 716-8123 • www.rochester-assoc.com

EROSION CONTROL PLAN - INITIAL PHASE - PHASE 1
 FOR:
DOLLAR GENERAL VILLA RICA
 LAND LOT 195
 6TH DISTRICT
 CARROLL COUNTY, GA

REVISIONS

NO.	DATE	DESCRIPTION

ANY CHANGES OR ALTERATIONS MADE TO THESE CONSTRUCTION DRAWINGS WITHOUT THE WRITTEN APPROVAL OF THE SEAL SHOWN HEREON AND ANY LIABILITY ASSOCIATED WITH THIS DRAWING SHALL BE THE RESPONSIBILITY OF THE DESIGNER. KEEP THIS FILE FOR VERIFICATION OF ANY CHANGES.

GRAPHIC SCALE
 1" = 30'
 0' 30' 60'

GEORGIA REGISTERED PROFESSIONAL ENGINEER
 No. 28858
 ERIC M. HUFFINE

SHEET 9 OF 16
 DATE: 07/24/20
 SCALE: 1"=30'
 JOB NO.: G220052.DWG
 REV'D BY: JWH
 DRAWN BY: JRS