

LIFE SAFETY GENERAL NOTES:

DATA TYPE	CALCULATION / VALUE	RESULT
BUILDING DATA		
OCCUPANCY:		A-2
MIXED OCCUPANCY	Y/N - SEPARATION:	NO
CONSTRUCTION TYPE:		VB
MIXED CONSTRUCTION	Y/N	NO
SPRINKLERED	Y/N - TYPE	YES
FIRE DISTRICT	Y/N	NO
TOTAL GROSS TENANT OR BULD. AREA (SF)		3045(EXIST)
NOTE: SEE T1.2 FOR MORE INFORMATION ON BUILDING DATA.		
OCCUPANT LOAD		
KITCHEN	1405 SF/ 100	14
DINING AREA	FIXED SEATING	64
WAITING AREA	60 SF/5	12
TOTAL OCCUPANTS		90
EGRESS		
EXIT WIDTH REQUIRED	OCCUPANCY COUNT * 0.2	18'
EXIT WIDTH PROVIDED		18'0"
MAX DEAD-END CORRIDOR:		20'
MAX TRAVEL DISTANCE TO EXIT:		100'-0"
NOTE: EXTERIOR EGRESS DOORS ARE TO BE PROVIDED WITH PANIC HARDWARE WHERE REQUIRED AND / OR SPECIFIED.		

LIFE SAFETY LEGEND:

- ***** EGRESS PATHWAYS
- EX ACCESSIBLE EXITS
- FEC FIRE EXTINGUISHER CABINET
- ⊕ FIRE EXTINGUISHER
- ⊗ EXIT SIGNAGE
- [Cross-hatched] 44" WIDE EGRESS PATH
- [Diagonal lines] 36" WIDE EGRESS PATH (SEATING ON BOTH SIDES)

REQUIRED SIGNAGE:

- THE G.C. IS TO PROVIDE ALL REQUIRED TACTILE SIGNAGE AS DIRECTED BY LOCAL CODE OFFICIALS INCLUDING, BUT NOT LIMITED TO: RESTROOM, STAIR, RAMP, AND DIRECTIONAL SIGNS.
- SIGNS ARE TO BE PROVIDED AT ALL EXITS IN ACCORDANCE WITH THE ADA STANDARDS FOR ACCESSIBLE DESIGN.
- G.C. TO PROVIDE EXT. PIN-MOUNTED, 4" HIGH (MIN.), ALUM. ADDRESS PLATES. COLOR TO MATCH STOREFRONT WINDOWS. LOCATE AS APPROVED BY THE LANDLORD & JURISDICTION.

FIRE SUPPRESSION SYSTEM:

- FIRE SPRINKLER AND / OR REQUIRED ALARM SYSTEM(S) TO BE UPDATED AND MODIFIED BY THE G.C. THROUGH A LICENSED FIRE SUPPRESSION CONTRACTOR.
- FIRE SUPPRESSION CONTRACTOR IS TO PROVIDE, UNDER SEPARATE COVER FROM THESE PLANS, ALL REQUIRED DRAWINGS AND DOCUMENTATION FOR SPRINKLER AND / OR ALARM AND IS RESPONSIBLE FOR PLAN SUBMISSION, APPROVAL AND OBTAINING ANY PERMITS.
- SUPPRESSION SYSTEM CONTRACTOR IS RESPONSIBLE FOR COORDINATION OF ALL SPRINKLER HEADS AND ALARM DEVICES (STROBES, PULLS, BELLS, DETECTORS, ETC.) WITH THESE PLANS.
- THE SUPPRESSION CONTRACTOR IS ADVISED TO NOTIFY AND COORDINATE WITH THE LOCAL FIRE JURISDICTION (FIRE MARSHALL).
- THE SUPPRESSION CONTRACTOR IS ADVISED TO CONTACT THE ARCHITECT PRIOR TO SYSTEM INSTALLATION FOR ANY REQUIRED CAD PLANS AND / OR NECESSARY BUILDING INFORMATION FOR THEIR USE.

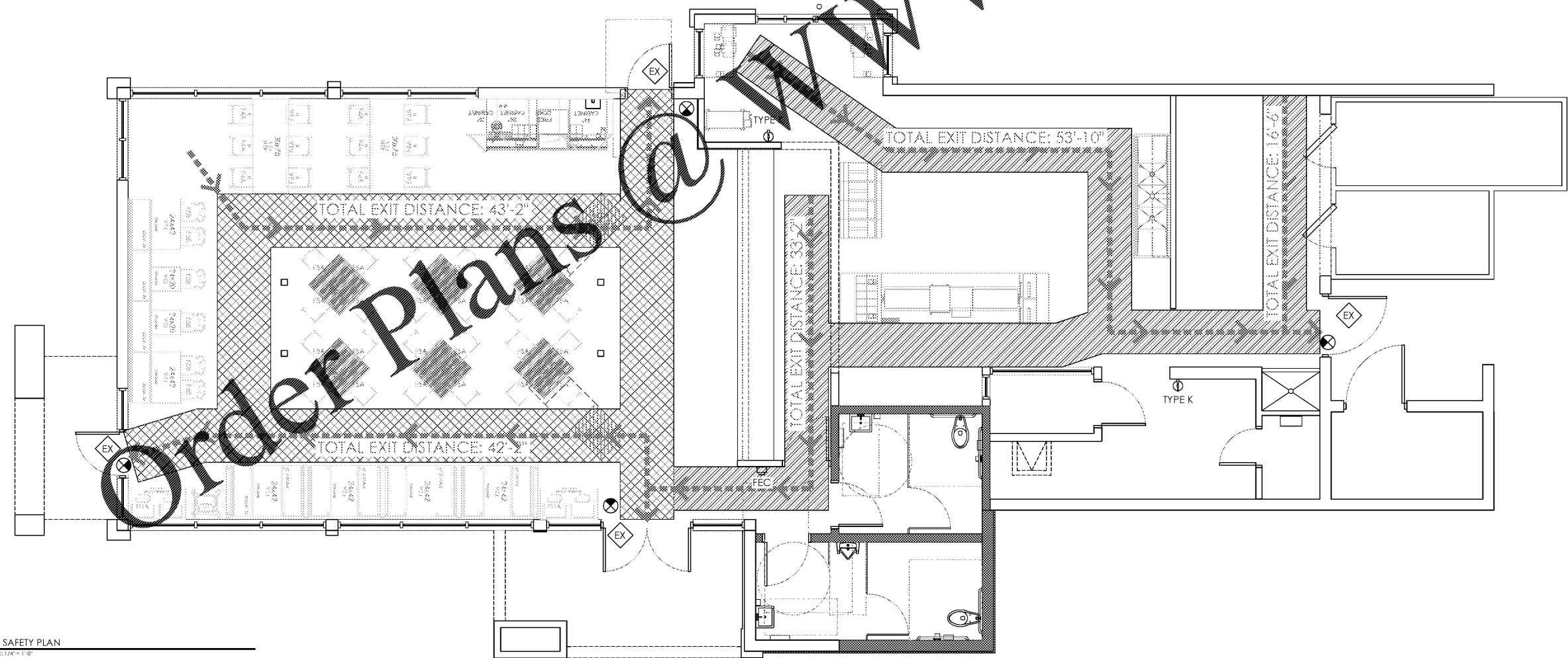

LIFE SAFETY PLAN
SCALE: 1/8" = 1'-0"

NO.	DATE	REVISION



PREMIER KINGS, INC.
5297 CARMICHAEL RD
MONTGOMERY, AL 36117
PHONE: (334) 312-0849

2124 Mont Avenue Birmingham, AL
35205
Phone: (205) 921-1751
Fax: (205) 921-1778
email: info@pkinc.com
www.pkinc.com

hendson huckestein architects, pc
architecture • planning • interior design



PROJECT # 2020-09
IMACE 2020 - DECEMBER 2014 STANDARDS
BURGER KING - RENOVATION
3092 Ross Clark Cir. S.W.
Dothan, Alabama 36301

LIFE SAFETY PLAN