



ISSUE DATES
 INITIAL ISSUE 05-27-20

JOB NO. 20-011 | DWN RJC | CK'D RJC

E5.0
 1ST FLOOR DEMO
 PLAN

ELECTRICAL NOTES

1. ALL WORK SHALL CONFORM TO THE NATIONAL ELECTRICAL CODE, TO NFPA 72, CURRENT EDITIONS, AND ALL STATE AND LOCAL CODES.
2. CONFIRM LOCATION OF ALL ELECTRICAL DEVICES WITH OWNER BEFORE INSTALLATION.
3. REMOVE ALL DEMO ELECTRICAL BACK TO THE PANEL.
4. REUSE EXISTING ELECTRICAL CIRCUITS AS NEEDED.

DEMOLITION NOTES

- DN-1 REMOVE PORTION OF EXISTING WALL.
- DN-2 CUT INTO EXISTING WALL FOR NEW DOOR.
- DN-3 REMOVE WALL.
- DN-4 REMOVE EXISTING BASE.
- DN-5 REMOVE VINYL WALL COVERING.
- DN-6 REMOVE EXISTING CEILING TILES AND GRID.
- DN-7 REMOVE EXISTING SOFFIT.
- DN-8 REMOVE EXISTING GLAZING, SALVAGE FOR REUSE.
- DN-9 REMOVE EXISTING FLOORING.
- DN-10 REMOVE EXISTING DOORS, FRAMES AND HARDWARE. SEE GENERAL DEMOLITION NOTES AND DOOR SCHEDULE. RE-USED AS DIRECTED.
- DN-11 REMOVE EXISTING CASEWORK. SEE GENERAL DEMOLITION NOTES.
- DN-12 REMOVE FILM ON EXISTING GLAZING.
- DN-13 REMOVE COLUMN SURROUND.
- DN-14 REMOVE EXISTING LIGHT FIXTURES.
- DN-15
- DN-16 REMOVE EXISTING PLUMBING FIXTURE. REFER TO PLUMBING DRAWINGS FOR SPECIFICS ON HANDLING TERMINATION OF LINES AND DRAINS.

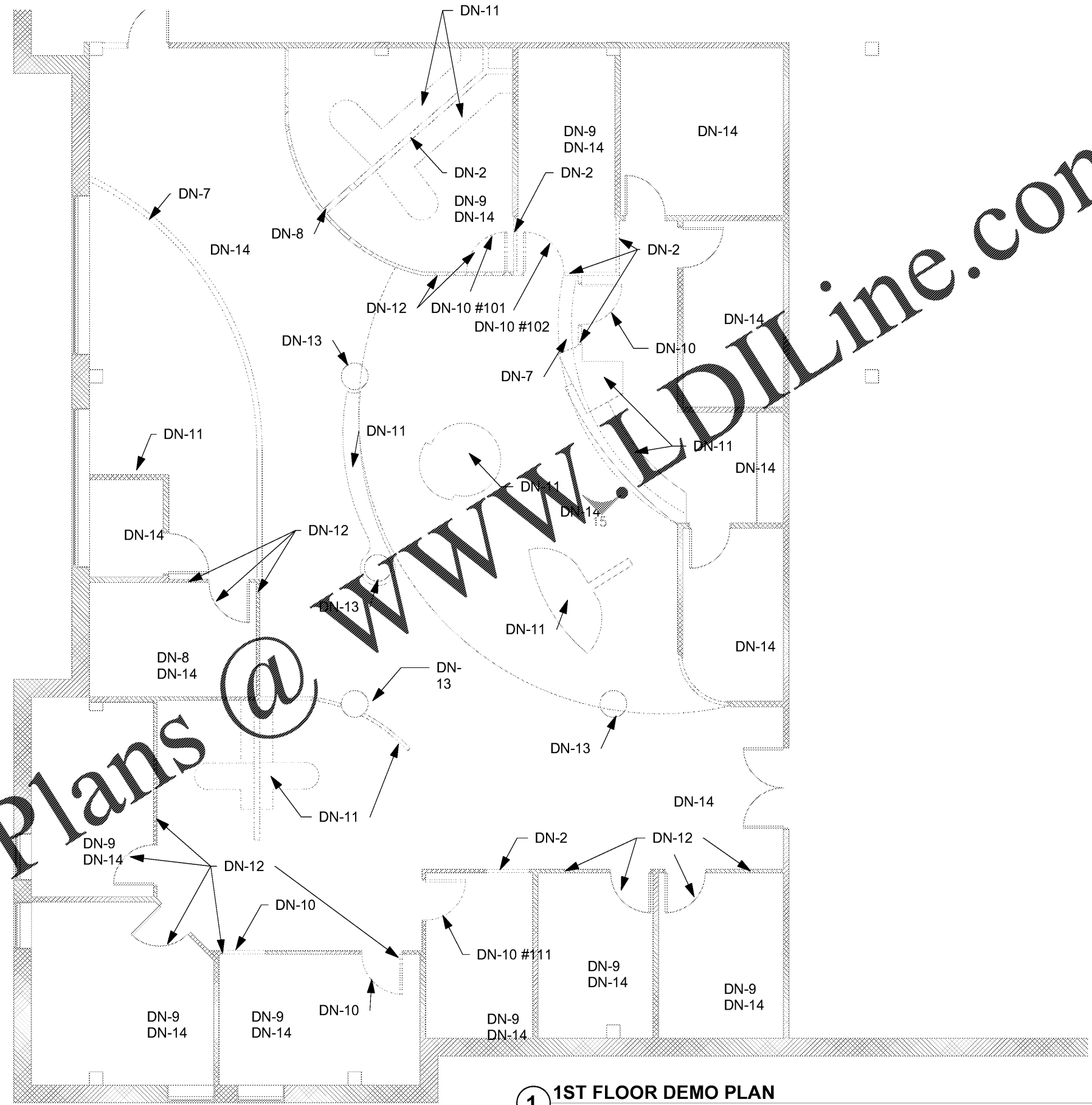

1 1ST FLOOR DEMO PLAN
 SCALE: 1/4" = 1'-0"

Order Plans @