

VERIZON STANDARD FURNITURE AND EQUIPMENT SCHEDULE

NO.	SYMBOL	NAME	QTY	UNIT	MANUFACTURER	FINISH	DETAILS	NOTES
COVER FLOOR	80	COVER FLOOR	1	SQ. YD.	VERIZON	COVER FLOOR		COVER FLOOR
COVER WALL	81	COVER WALL	1	SQ. YD.	VERIZON	COVER WALL		COVER WALL
COVER CEILING	82	COVER CEILING	1	SQ. YD.	VERIZON	COVER CEILING		COVER CEILING
COVER PARTITION	83	COVER PARTITION	1	SQ. YD.	VERIZON	COVER PARTITION		COVER PARTITION
COVER PARTITION	84	COVER PARTITION	1	SQ. YD.	VERIZON	COVER PARTITION		COVER PARTITION
COVER PARTITION	85	COVER PARTITION	1	SQ. YD.	VERIZON	COVER PARTITION		COVER PARTITION
COVER PARTITION	86	COVER PARTITION	1	SQ. YD.	VERIZON	COVER PARTITION		COVER PARTITION
COVER PARTITION	87	COVER PARTITION	1	SQ. YD.	VERIZON	COVER PARTITION		COVER PARTITION
COVER PARTITION	88	COVER PARTITION	1	SQ. YD.	VERIZON	COVER PARTITION		COVER PARTITION
COVER PARTITION	89	COVER PARTITION	1	SQ. YD.	VERIZON	COVER PARTITION		COVER PARTITION
COVER PARTITION	90	COVER PARTITION	1	SQ. YD.	VERIZON	COVER PARTITION		COVER PARTITION
COVER PARTITION	91	COVER PARTITION	1	SQ. YD.	VERIZON	COVER PARTITION		COVER PARTITION
COVER PARTITION	92	COVER PARTITION	1	SQ. YD.	VERIZON	COVER PARTITION		COVER PARTITION
COVER PARTITION	93	COVER PARTITION	1	SQ. YD.	VERIZON	COVER PARTITION		COVER PARTITION
COVER PARTITION	94	COVER PARTITION	1	SQ. YD.	VERIZON	COVER PARTITION		COVER PARTITION
COVER PARTITION	95	COVER PARTITION	1	SQ. YD.	VERIZON	COVER PARTITION		COVER PARTITION
COVER PARTITION	96	COVER PARTITION	1	SQ. YD.	VERIZON	COVER PARTITION		COVER PARTITION
COVER PARTITION	97	COVER PARTITION	1	SQ. YD.	VERIZON	COVER PARTITION		COVER PARTITION
COVER PARTITION	98	COVER PARTITION	1	SQ. YD.	VERIZON	COVER PARTITION		COVER PARTITION
COVER PARTITION	99	COVER PARTITION	1	SQ. YD.	VERIZON	COVER PARTITION		COVER PARTITION
COVER PARTITION	100	COVER PARTITION	1	SQ. YD.	VERIZON	COVER PARTITION		COVER PARTITION

DESIGNATION	DESCRIPTION	SIZE (L x W x H)	QUANTITY	COMMENTS
BPK	BILL PAXKOSK		1	
MNT	MONITOR		3	
MNT-BG	MONITOR BLADE SHELF (STANDARD)	84.9375" L x 8" W x 2" H	4	TOTAL LENGTH VARIES TO MATCH DEVICE RACK TOTAL LENGTH
	TICKER FILLER SHELF (4 BAY)	18.125" L x 8" W x 2" H	0	2 STANDARD SHELF AND 1 FILLER = 188"
	TICKER FILLER SHELF (5 BAY)	65.625" L x 8" W x 2" H	0	2 STANDARD SHELF AND 1 FILLER = 235.5"
	TICKER FILLER SHELF (6 BAY)	27.1675" L x 8" W x 2" H	1	3 STANDARD SHELF AND 1 FILLER = 282"
	TICKER FILLER SHELF (7 BAY)	73.6875" L x 8" W x 2" H	0	3 STANDARD SHELF AND 1 FILLER = 328.5"
	TICKER FILLER SHELF (8 BAY)	35.25" L x 8" W x 2" H	0	4 STANDARD SHELF AND 1 FILLER = 375"
	TICKER FILLER SHELF (9 BAY)	81.75" L x 8" W x 2" H	0	4 STANDARD SHELF AND 1 FILLER = 421.5"
	TICKER FILLER SHELF (10 BAY)	43.125" L x 8" W x 2" H	0	5 STANDARD SHELF AND 1 FILLER = 468"
	TICKER FILLER SHELF (11 BAY)	4.75" L x 8" W x 2" H	0	6 STANDARD SHELF AND 1 FILLER = 514.5"
DR (6-DF)	DEVICE RACK (6 BAY SETUP)	28.2" x 13.75" W x 60.25" H	1	6 BAY=28.2" LONG, END CABINETS=48" L / CENTER CABINETS = 46.5" L
BSTL	BAR STOOL	17.75" L x 16" W x 35.25" H	11	
BSTL-NB	BAR STOOL - NO BACK	17" L x 16" W x 23" H	2	
SPOT - N	NARROW SPOTLIGHT FIXTURE	67.50" L x 18" W x 46.67" H	1	FIXTURE SIZE FOR REFERENCE ONLY, GC TO COORDINATE WITH FIXTURE MANUF.
SPOT	SPOTLIGHT FIXTURE	90" L x 24" W x 50.675" H	0	FIXTURE SIZE FOR REFERENCE ONLY, GC TO COORDINATE WITH FIXTURE MANUF.
SPOT-WM	SPOTLIGHT WALL MOUNT	67.5" L x 10.5" W x 47.3/5" H	0	FIXTURE SIZE FOR REFERENCE ONLY, GC TO COORDINATE WITH FIXTURE MANUF.
ASBLE	4FT ASBLE FIXTURE	48" L x 24" W x 52" H	4	FIXTURE SIZE FOR REFERENCE ONLY, GC TO COORDINATE WITH FIXTURE MANUF.
ASBLE/GUV	4FT ASBLE FIXTURE	48" L x 24" W x 52" H	1	FIXTURE SIZE FOR REFERENCE ONLY, GC TO COORDINATE WITH FIXTURE MANUF.
4-POS	4FT POS	48" L x 24" W x 34" H	1	FIXTURE SIZE FOR REFERENCE ONLY, GC TO COORDINATE WITH FIXTURE MANUF.
5-POS	POS IN BOH	56" L x 30" W x 34" H	1	FIXTURE SIZE FOR REFERENCE ONLY, GC TO COORDINATE WITH FIXTURE MANUF.
ISPU	IN STROKE PICKUP UNIT (WITH TOPPER)	48" L x 24" W x 34" H (57-3/4" H WITH TOPPER)	1	FIXTURE SIZE FOR REFERENCE ONLY, GC TO COORDINATE WITH FIXTURE MANUF.
KC	KIDS CHAIR	18" L x 18" W x 18" H	0	FIXTURE SIZE FOR REFERENCE ONLY, GC TO COORDINATE WITH FIXTURE MANUF.
KT	KIDS TABLE	18" L x 18" W x 18" H	0	FIXTURE SIZE FOR REFERENCE ONLY, GC TO COORDINATE WITH FIXTURE MANUF.
PB-6	PARENTS BENCH 6FT	72" L x 18" W x 18" H	1	FIXTURE SIZE FOR REFERENCE ONLY, GC TO COORDINATE WITH FIXTURE MANUF.
PB-4	PARENTS BENCH 4FT	48" L x 18" W x 18" H	0	FIXTURE SIZE FOR REFERENCE ONLY, GC TO COORDINATE WITH FIXTURE MANUF.
CT-10	COLLABORATION TABLE 10FT	120" L x 34" W x 39" H	2	FIXTURE SIZE FOR REFERENCE ONLY, GC TO COORDINATE WITH FIXTURE MANUF.
CT-8	COLLABORATION TABLE 8FT	96" L x 34" W x 39" H	0	FIXTURE SIZE FOR REFERENCE ONLY, GC TO COORDINATE WITH FIXTURE MANUF.
CB-6	COLLABORATION BAR 6FT	72" L x 18" W x 39" H	1	FIXTURE SIZE FOR REFERENCE ONLY, GC TO COORDINATE WITH FIXTURE MANUF.
CB-6	COLLABORATION BAR 6FT	72" L x 18" W x 39" H	0	FIXTURE SIZE FOR REFERENCE ONLY, GC TO COORDINATE WITH FIXTURE MANUF.
EXP-LG	LARGE EXPERIENCE TABLE	96" L x 30" W x 39" H	1	FIXTURE SIZE FOR REFERENCE ONLY, GC TO COORDINATE WITH FIXTURE MANUF.
EXP-BAR	EXPERIENCE BAR	96" L x 30" W x 39" H	0	FIXTURE SIZE FOR REFERENCE ONLY, GC TO COORDINATE WITH FIXTURE MANUF.
BT	BUSINESS TABLE (WITH TOPPER)	48" L x 24" W x 34" H (57-3/4" H WITH TOPPER)	1	FIXTURE SIZE FOR REFERENCE ONLY, GC TO COORDINATE WITH FIXTURE MANUF.
2-56	2FT SHELF SET	23.75" L x 18.75" W x 93.75" H	1	
2-56-FB	2FT SHELF SET - FREE STANDING	23.75" L x 18.75" W x 93.75" H	0	MDP BACKER PANEL FOR FREE STANDING WALL BAYS (P-1)
2-5W	2FT SLAT WALL	23.75" L x 18.75" W x 93.75" H	3	FIXTURE SIZE FOR REFERENCE ONLY, GC TO COORDINATE WITH FIXTURE MANUF.
2-5W-FB	2FT SLAT WALL - FREE STANDING	23.75" L x 18.75" W x 93.75" H	0	MDP BACKER PANEL FOR FREE STANDING WALL BAYS (P-1)
2-IF	2FT INFILL	23.75" L x 18.75" W x 93.75" H	0	FIXTURE SIZE FOR REFERENCE ONLY, GC TO COORDINATE WITH FIXTURE MANUF.
2-IF-FB	2FT INFILL (FREE STANDING)	23.75" L x 18.75" W x 93.75" H	0	MDP BACKER PANEL FOR FREE STANDING WALL BAYS (P-1)
4-CD	4FT CASE DISPLAY	47.75" L x 18.75" W x 93.75" H	4	FIXTURE SIZE FOR REFERENCE ONLY, GC TO COORDINATE WITH FIXTURE MANUF.
4-CD-FB	4FT CASE DISPLAY - FREE STANDING	47.75" L x 18.75" W x 93.75" H	0	MDP BACKER PANEL FOR FREE STANDING WALL BAYS (P-1)
4-SW	4FT SLAT WALL	47.75" L x 18.75" W x 93.75" H	0	FIXTURE SIZE FOR REFERENCE ONLY, GC TO COORDINATE WITH FIXTURE MANUF.
4-SW-FB	4FT SLAT WALL - FREE STANDING	47.75" L x 18.75" W x 93.75" H	0	MDP BACKER PANEL FOR FREE STANDING WALL BAYS (P-1)
4-66	4FT SHELF SET	47.75" L x 18.75" W x 93.75" H	0	FIXTURE SIZE FOR REFERENCE ONLY, GC TO COORDINATE WITH FIXTURE MANUF.
4-66-FB	4FT SHELF SET - FREE STANDING	47.75" L x 18.75" W x 93.75" H	0	MDP BACKER PANEL FOR FREE STANDING WALL BAYS (P-1)
4-66-S	4FT SHELF SET w/SLOT	47.75" L x 18.75" W x 93.75" H	3	FIXTURE SIZE FOR REFERENCE ONLY, GC TO COORDINATE WITH FIXTURE MANUF.
4-66-S-FB	4FT SHELF SET w/SLOT - FREE STANDING	47.75" L x 18.75" W x 93.75" H	0	MDP BACKER PANEL FOR FREE STANDING WALL BAYS (P-1)
4-IF	4FT INFILL (FREE STANDING)	47.75" L x 18.75" W x 93.75" H	0	FIXTURE SIZE FOR REFERENCE ONLY, GC TO COORDINATE WITH FIXTURE MANUF.
4-IF-FB	4FT INFILL (FREE STANDING)	47.75" L x 18.75" W x 93.75" H	0	MDP BACKER PANEL FOR FREE STANDING WALL BAYS (P-1)
4-ETL (5G HUB)	4FT ENTERTAINMENT UNIT LARGE - FREE STANDING	47.75" L x 18.75" W x 93.75" H	1	FIXTURE SIZE FOR REFERENCE ONLY, GC TO COORDINATE WITH FIXTURE MANUF.
4-ETL-FB	4FT ENTERTAINMENT UNIT LARGE - FREE STANDING	47.75" L x 18.75" W x 93.75" H	0	MDP BACKER PANEL FOR FREE STANDING WALL BAYS (P-1)
DIGITAL-1	DIGITAL DISPLAY - SINGLE MONITOR	28-7/8" L x 6" W x 156" MAX. H	1	FIXTURE SIZE FOR REFERENCE ONLY, GC TO COORDINATE WITH FIXTURE MANUF.
DIGITAL-2	DIGITAL DISPLAY - DOUBLE MONITOR	28-7/8" L x 6" W x 156" MAX. H	0	FIXTURE SIZE FOR REFERENCE ONLY, GC TO COORDINATE WITH FIXTURE MANUF.
2' RED CHECK	CHECKMARK LOGO - 2FT	19-3/4" L x 24" W x 3" D (B.O. CHECK: 3'-11 1/2" A.F.F.)	2	FIXTURE SIZE FOR REFERENCE ONLY, GC TO COORDINATE WITH FIXTURE MANUF.
4' RED CHECK	CHECKMARK LOGO - 4FT	39-17/32" L x 48" W x 4" D (B.O. CHECK: 3'-11 1/2" A.F.F.)	0	FIXTURE SIZE FOR REFERENCE ONLY, GC TO COORDINATE WITH FIXTURE MANUF.
BWF	BRAND WALL FRAME - STARTER	VARIOUS	0	
BW	BRAND WALL (ATTACHED TO STORE WALL)	LENGTH VARIES PER FLOOR PLAN x 2" W x 83" H	0	
BW-FB	FREE STANDING BRAND WALL	LENGTH VARIES PER FLOOR PLAN x 2" W x 83" H CABINETS, APPLIANCES OR 4FT WIDE SECTIONS & THESE ARE MOUNTED TO WALL	0	
2x3 BWPW w/PLAQUE	PHOTO WALL - (2) PHOTO WIDE x (3) PHOTO HIGH	6'-0" W x 9'-0" H (PHOTO WALL) (B.O. PHOTO WALL: 2'-7" A.F.F.) 1'-10" W x 3'-3" H (PLAQUE) (T.O. PLAQUE = T.O. PHOTO WALL)	1	
3x3 BWPW w/PLAQUE	PHOTO WALL - (3) PHOTO WIDE x (3) PHOTO HIGH	6'-0" W x 9'-0" H (PHOTO WALL) (B.O. PHOTO WALL: 2'-7" A.F.F.) 1'-10" W x 3'-3" H (PLAQUE) (T.O. PLAQUE = T.O. PHOTO WALL)	0	
4x3 BWPW w/PLAQUE	PHOTO WALL - (4) PHOTO WIDE x (3) PHOTO HIGH	6'-0" W x 9'-0" H (PHOTO WALL) (B.O. PHOTO WALL: 2'-7" A.F.F.) 1'-10" W x 3'-3" H (PLAQUE) (T.O. PLAQUE = T.O. PHOTO WALL)	0	
4x4 BWPW w/PLAQUE	PHOTO WALL - (4) PHOTO WIDE x (4) PHOTO HIGH	6'-0" W x 9'-0" H (PHOTO WALL) (B.O. PHOTO WALL: 2'-7" A.F.F.) 1'-10" W x 3'-3" H (PLAQUE) (T.O. PLAQUE = T.O. PHOTO WALL)	0	
MBP	MBP BACKER PANEL - FREE STANDING DISPLAYS (P-1)	VARIOUS	NO	

GRANING CONTACTS:
 JUDY KEE GRANGER, INC. ACCOUNT MANAGER
 MOBILE: (609) 256-0922
 JUDY.KEE@GRANGER.COM
 819 EAST GATE DRIVE MOUNT LAUREL, NJ 08054
 LEVI BULGAR GRANGER, INC. ACCOUNT MANAGER
 MOBILE: (224) 268-6701
 LEVI.BULGAR@GRANGER.COM
 475 E. ALGONQUIN RD. ARLINGTON HEIGHTS, IL 60005

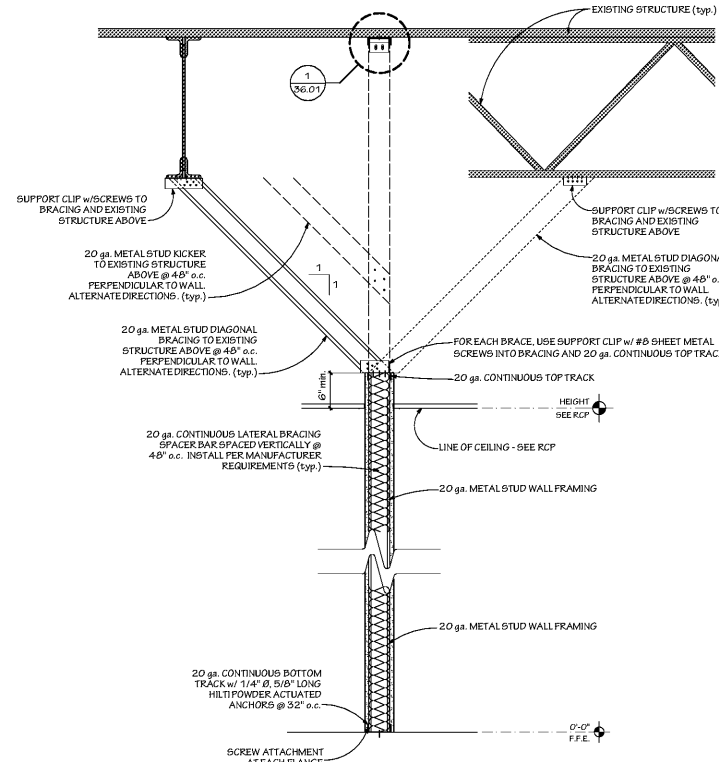

1 TYPICAL PARTITION CONNECTIONS
 SCALE: 1" = 1'-0"

MRA

Buildings Group

MRA ARCHITECTURAL SERVICES, INC.
 Architects, Planners, Urban Designers, Landscape Architects, Engineers and Surveyors
 1414 Key Highway, Suite M301
 Baltimore, Maryland 21230
 410-490-7201

TEI

TELEVENT ENGINEERING, INC.
 2216 COMMERCE ROAD
 FOREST HILL, MD 21050
 PHONE: 410-692-2616
 FAX: 410-692-2853
 WWW.TEI-ENG.COM

Client:
 Verizon
 David Yang
 3700 Arco Corporate Drive
 Charlotte, North Carolina 28273

Verizon
 Simpsonville
 NextGen

340 Harrison Bridge Road
 Simpsonville, SC 29680

© CONTENTS COPY RIGHT 2021
 MRA ARCHITECTURAL SERVICES, INC.

NO.	REVISION	DATE
FILE	17759x101	ISSUED
DRAWN	SKJ	06/19/2020

SHEET TITLE
Furn., Fixt., Equip. Schedules & Detail

SHEET NUMBER
38.03

Permit Documents